



Getting Started

Compaq Notebook Series

Document Part Number: 271247-002

October 2002

This guide explains how to set up your hardware and software, begin using the notebook, identify hardware components, and contact Compaq if you need assistance.

© 2002 Compaq Information Technologies Group, L.P.

Compaq, the Compaq logo, Evo, and Presario are trademarks of Compaq Information Technologies Group, L.P. in the U.S. and/or other countries. Microsoft and Windows are trademarks of Microsoft Corporation in the U.S. and/or other countries. All other product names mentioned herein may be trademarks of their respective companies.

Compaq shall not be liable for technical or editorial errors or omissions contained herein. The information is provided “as is” without warranty of any kind and is subject to change without notice. The warranties for Compaq products are set forth in the express limited warranty statements accompanying such products. Nothing herein should be construed as constituting an additional warranty.

Getting Started

Second Edition October 2002

First Edition June 2002

Reference Number: N1020v/1500

Document Part Number: 271247-002

Using This Guide

This preface explains how to interpret the symbols, text styles, and paths in your notebook documentation.

Warnings, Cautions and Notes

Warnings and cautions contain important information that can protect you, your work, and your system.

Notes contain additional information about a topic. Some notes provide basic information for inexperienced users. Others provide technical information for advanced users.

The following icons identify warnings, cautions, and notes.



WARNING: The information in a warning alerts you to potential bodily harm or loss of life.



CAUTION: The information in a caution alerts you to potential damage to your work, your notebook, or an optional external device.



The information in a note provides supplementary information.

Text Styles

Some text in your notebook documentation is styled typographically to help you interpret the information it contains. The following table explains other text styles used in your notebook documentation.

Style	Explanation
keys	<p>Identifies a key, such as the enter key, on the notebook keyboard or on an optional external keyboard.</p> <p>A plus sign (+) between 2 or more keys indicates that they are a key combination. To use most key combinations:</p> <ul style="list-style-type: none">■ Briefly press the first key, then briefly press each succeeding key.or■ Press and hold the first key, press and hold each succeeding key, then release all the keys simultaneously. <p>Unless you are instructed to do so, do not press keys simultaneously.</p>
commands	<p>Identifies characters you are asked to type. For example, to visit the Compaq Web site, you would type <code>http://www.compaq.com</code> into the address field on your Web browser.</p>
Initial Capital Letters	<p>Identify labels or options you can choose on the screen. For example, in a procedure for displaying an icon on the taskbar, you might be asked to select the Always show icon on the taskbar check box.</p>

Following a Path

Instructions in the documentation may direct you to the operating system, an application, or a utility where you can select settings. The greater than symbol (>) is used to direct you along the path to the destination settings.

The paths described in your notebook documentation are based on the notebook pointing device default functions:

- To select, press the left TouchPad button ❶ once.
- To double-click, press the left TouchPad button twice.
- To right-click, press the right TouchPad button ❷ once.

Most paths to Windows destinations begin with “Start >.” To select Start (and display the Windows Start menu), select the Start button in the lower left corner of your screen or press either of the Microsoft logo keys ❸ on the keyboard.

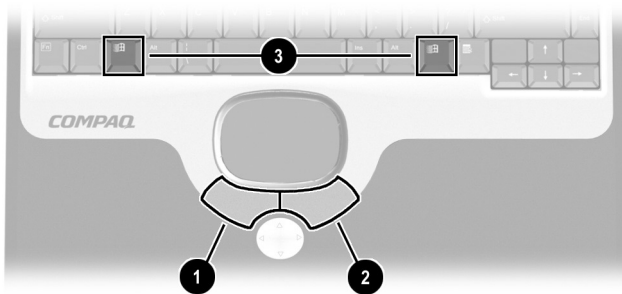

Identifying TouchPad buttons and Microsoft logo keys

Contents

Using This Guide

1 Setting Up the Notebook

Setting Up the Hardware	1-1
Installing the Battery Pack.	1-2
Connecting the Notebook to External Power	1-3
Opening the Notebook.	1-4
Turning On the Notebook	1-5
Setting Up the Software	1-6
Turning Off the Notebook	1-7
Using Emergency Shutdown Procedures	1-7
Using the Notebook Safely	1-8

2 Beginning to Use the Notebook

Selecting Regional Settings	2-1
Selecting Screen Settings	2-2
Protecting the Notebook Against Viruses	2-2
Installing Optional Software	2-3
Accessing Notebook Documentation.	2-4
Accessing the Documentation Library Menu	2-5
Using the Documentation Library CD	2-5
Selecting a Guide.	2-6
Finding a Topic Within a Guide	2-7
Contacting Compaq	2-8
Preparing to Call Technical Support	2-8
Taking the Notebook to a Service Provider.	2-9

3 Hardware Components

- Display Components 3-1
- Pointing Device Components 3-2
 - TouchPad Models 3-2
 - Dual-Device Models 3-3
- Top Components 3-4
 - Power Lights 3-4
 - Keyboard and Drive Lights 3-5
 - Power and Volume Controls 3-6
 - Easy Access Buttons and Keyboard Keys 3-7
 - Function and Keypad Keys 3-8
- Front Panel Components 3-9
- Rear Panel Components 3-10
 - Connectors 3-10
 - Jacks and Thermal Components 3-11
- Left Side Components 3-12
- Right Side Components 3-13
- Bottom Components 3-14
 - Memory and Mini PCI Compartments 3-14
 - Docking and Thermal Components 3-15
 - Labels 3-16
- Additional Standard Components 3-17
 - Software Restore and Documentation CDs 3-17
 - Cords and Cables 3-18
 - Adapters and Accessories 3-19

Index

Setting Up the Notebook

Setting Up the Hardware

To set up the notebook for the first time, you will need the notebook, the AC adapter ❶, the power cord ❷, and the battery pack ❸. During the hardware setup, you will install the battery pack, connect the computer to external power, open the display, and turn on the notebook.

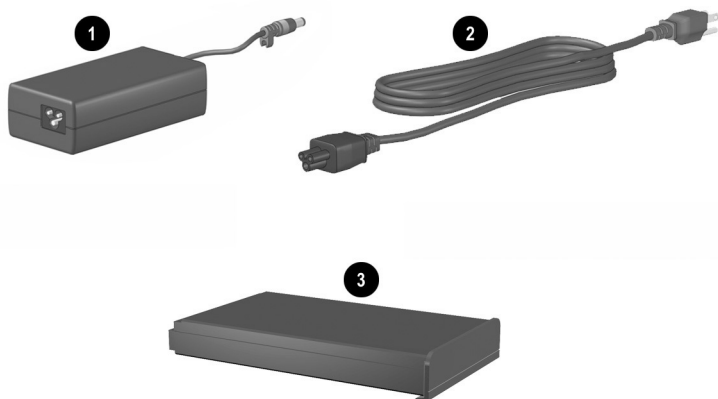

Identifying the AC adapter, the power cord, and the battery pack



AC adapters and power cords vary by region.

Installing the Battery Pack

To install the battery pack, place the notebook upside down on a flat surface and slide the battery pack into the battery bay until it is seated.

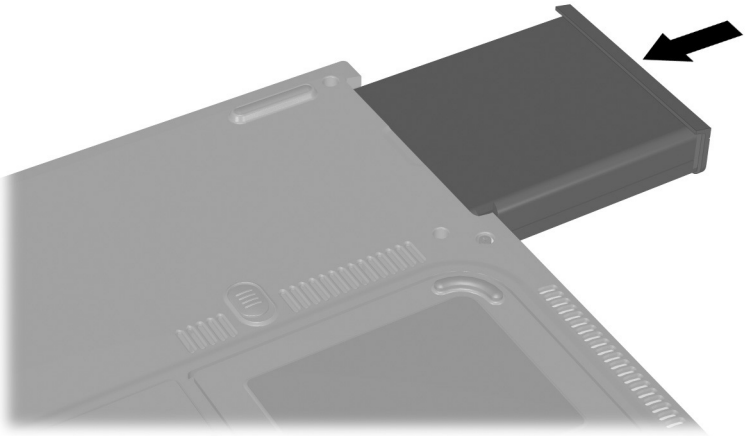

Installing the battery pack



CAUTION: Setup must begin by connecting the notebook to AC power. To ensure that the correct drivers load and to prevent file corruption or damage to the components during initial setup:

- Do not remove the battery pack until the notebook has been connected to external AC power.
 - Run the notebook on external AC power, not on battery power, throughout the initial setup.
 - Do not set up the notebook while it is docked in an optional Port Replicator.
-

Connecting the Notebook to External Power

To connect the notebook to external power:

1. Place the notebook on a flat surface near an electrical outlet.
2. Plug the AC adapter cable into the AC power connector **1**.
3. Plug the power cord into the AC adapter **2** and into an electrical outlet **3**.

When the notebook receives AC power, the AC adapter light **4** turns on.



Connecting the notebook to external power



AC adapters, power cords, and outlets vary by region.

Opening the Notebook

To open the notebook, briefly press the display release latch **1** as you raise the display **2**.

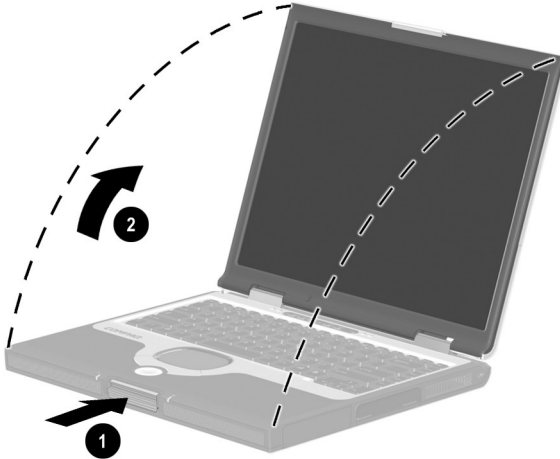

Opening the notebook

Turning On the Notebook

To turn on the notebook, press the power button **1**. When the notebook turns on, the power/standby light **2** turns on, and you are prompted to begin software setup.

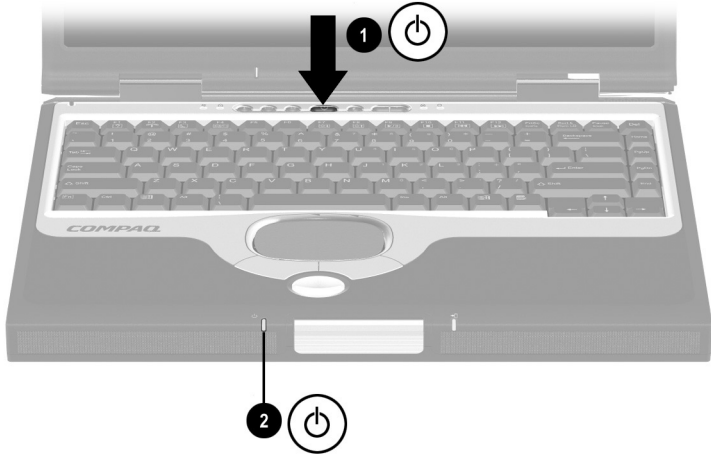

Turning on the notebook



If the notebook does not turn on, make sure that the battery pack is firmly seated and that the AC adapter is securely attached to a live electrical outlet.

Setting Up the Software

A prompt to set up the software is displayed on the screen when the notebook is turned on for the first time.

Before responding to the prompt and proceeding through the online instructions, read the following caution and other installation information.



CAUTION: To prevent file corruption and be sure that the correct device drivers install, during software setup:

- Do not unplug the notebook from the electrical outlet.
 - Do not shut down the notebook.
 - Do not remove or insert a drive.
-
- After beginning the software setup, you must complete the entire process without interruption. Setup time varies.
 - If you are prompted to select a language, choose carefully. The languages that you do not choose are deleted from the system and cannot be restored during the installation.
 - When you are prompted to accept the End User License Agreement, you must choose Accept to continue the software setup.

Turning Off the Notebook

When possible, shut down the notebook by following the Windows shutdown procedure provided for your operating system:

- **In Windows 2000 Professional**, select Start > Shut Down > What do you want the computer to do? > Shut Down, then select the OK button.
- **In Windows XP Professional or XP Home**, select Start > Turn Off Computer > Turn Off.

If the notebook does not respond to a Windows shutdown procedure, try the steps described in the next section.

Using Emergency Shutdown Procedures

If you are unable to use normal Windows shutdown procedures, try one of these additional emergency procedures:

- Press and hold down the power button for at least 4 seconds to completely turn off the system.
- Press **Fn+power**.

If you are unable to shut down the notebook with the power procedures described above, disconnect the notebook from external power and remove the battery pack.

Using the Notebook Safely

To protect the notebook from the power surges that may be caused by an uncertain power supply or an electrical storm:

- Plug the notebook power cord into an optional, high-quality surge protector, available at computer or electronics retailers.
- Provide surge protection on the cable that connects the modem to the telephone line.
- During an electrical storm, run the notebook on battery power or shut down the notebook and disconnect the power cord.

To learn more about protecting yourself, your work, and your notebook from electrical and other risks read the ergonomic and safety information included with the notebook.



WARNING: This is a Class B digital device, pursuant to Part 15 of the FCC Rules. For more Class B information, refer on the *Documentation Library* CD to *Regulatory and Safety Notices*. To reduce the risk of personal injury, electric shock, fire, or damage to the equipment:

- Do not disable the power cord grounding plug. It is an important safety feature.
 - Plug the equipment into a grounded (earthed) electrical outlet that is easily accessible at all times.
 - Disconnect power from the equipment by unplugging the power cord from the electrical outlet.
 - Do not place anything on power cords or cables. Arrange them so that no one can accidentally step on or trip over them.
 - Do not pull on a cord or cable. When unplugging a cord from an electrical outlet, grasp the cord by the plug.
 - Disconnect the modem from a telephone line when you are not using the modem.
 - Do not use the modem during an electrical storm without an optional surge protector.
-

Beginning to Use the Notebook

Selecting Regional Settings

Keyboard language and other regional preferences, such as time, date, and currency format, are set in the operating system.

To access regional settings:

- **In Windows 2000 Professional**, select Start > Settings > Control Panel > Regional Options.
- **In Windows XP Home or Windows XP Professional**, select Start > Control Panel > Date, Time, Language and Regional Options.

For information about selecting regional settings, open the Regional Options window, then use context-sensitive Help. To use context-sensitive Help, select the question mark button in the upper right corner of the window, then select an item. A definition, explanation, or procedure is displayed.

Selecting Screen Settings

If you want to change the appearance of your desktop, see the items on your screen displayed in a larger size, or change the screen resolution on your display:

- **In Windows 2000 Professional**, select Start > Settings > Control Panel > Display icon, and select the task you want to perform.
- **In Windows XP Home or Windows XP Professional**, select Start > Control Panel > Appearance and Themes icon, and select the task you want to perform.

Protecting the Notebook Against Viruses

When you use the notebook for email, network, or Internet access, you expose the notebook to computer viruses. Computer viruses can disable the operating system, your applications, or your utilities or cause them to function abnormally.

Antivirus software can detect most viruses, destroy them, and, in most cases, repair damage they have caused.

Compaq strongly recommends that you install optional antivirus software before using the modem or a network connection.

Antivirus software is available from most computer or electronics retailers.

Installing Optional Software

Step-by-step instructions for installing and using many of the applications and utilities included with the notebook are provided on the *Documentation Library* CD included with the notebook. Instructions for using the CD are provided next.

If you prefer to install optional software now, without referring to the *Documentation Library* CD, the following information may be helpful:



CAUTION: To prevent file corruption, ensure that the correct drivers are installed, and install software only when the notebook is connected to external power through the AC adapter. (Do not install software while the notebook is docked in an optional Port Replicator or while the notebook is running on battery power.) During the installation:

- Do not unplug the notebook from external power.
 - Do not shut down the notebook.
 - Do not remove or insert a drive.
-
- To install an application or a utility from a CD, refer to the documentation included with the CD. In most cases, installation instructions are included in the CD package or are displayed on the screen when the CD is inserted.
 - To install a preloaded Compaq utility select Start > Software Setup. A setup wizard loads, and you will see a list of applications available for installation. Select one or more applications you want to install and follow the instructions on the screen.
 - To view the descriptions and space requirements of preloaded Compaq utilities without installing them, select a utility and select Next. After viewing the information, select the Cancel button.

Accessing Notebook Documentation

Information about using the notebook can be found on the *Documentation Library* CD included with the notebook.

To insert the *Documentation Library* CD:

1. Turn on the notebook.
2. Press the release button ❶ on the drive bezel to release the media tray, then pull the tray out until it is fully extended ❷.
3. Position the CD over the tray, label side up.
4. Gently press the disc near the hole onto the tray spindle ❸ until the disc snaps into place. If the media tray is not fully extended, tilt the disc to position it over the tray spindle, then press it down into position. Handle the disc by the edges, not the flat surfaces.
5. Close the media tray ❹.

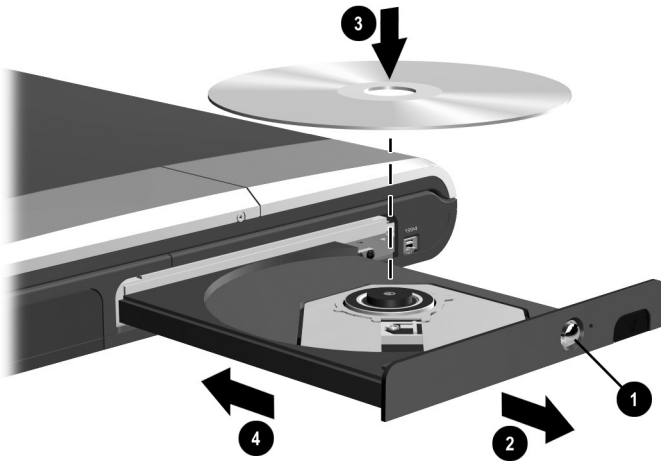

Inserting the Documentation Library CD into an optical drive

Accessing the Documentation Library Menu

When the *Documentation Library* CD is inserted into a drive, the CD menu is displayed on the screen after a pause of up to several seconds.

If Autoplay is disabled and the menu is not displayed, you can display the menu manually:

1. Select Start > Run.
2. In the Open field, type:
X: (where X = the drive containing the *Documentation Library* CD)
3. Press **enter**.



To display the drive designation of your CD drive, double-click the My Computer icon on the desktop.

Responding to an Acrobat Reader Prompt

Adobe Acrobat Reader is an application that displays the notebook documentation on the screen.

If messages about Acrobat Reader are displayed on the screen as you open the *Documentation Library* CD:

- Choose to install Acrobat Reader.
- Choose to accept the Acrobat Reader license agreement.

Using the Documentation Library CD

This section describes how to select a guide and find a specific topic within a guide.

For information about using documentation symbols, text styles, and paths, see the introduction in this guide, “Using This Guide.”

Selecting a Guide

Information about the notebook is provided in the guides described in the following table.

For Information About These Topics	Select This Guide
<ul style="list-style-type: none">■ Using the external hardware features identified in Chapter 3 of this guide■ Running the notebook on a battery pack■ Upgrading memory■ Power and environmental specifications	<i>Hardware Guide</i>
<ul style="list-style-type: none">■ Playing CDs or DVDs■ Using Standby and Hibernation and selecting power preferences■ Using security features, such as passwords, to protect against unauthorized access to the notebook■ Updating or restoring Compaq software■ Using the Diagnostics, Setup, and Intelligent Manageability utilities	<i>Software Guide</i>
<ul style="list-style-type: none">■ Using the modem■ Using a network connection	<i>Modem and Networking</i>
<ul style="list-style-type: none">■ Using modem AT commands■ Accessing the command sets for your notebook	<i>Modem Command Guidelines (Advanced Users Only)</i>
<ul style="list-style-type: none">■ Caring for the notebook and drives■ Preparing the notebook for transport■ Traveling with the notebook internationally	<i>Maintenance, Shipping and Travel</i>
<ul style="list-style-type: none">■ Solving notebook problems yourself■ Getting help from Compaq	<i>Troubleshooting</i>
<ul style="list-style-type: none">■ Governmental and safety information■ Protecting the notebook from static electricity	<i>Regulatory and Safety Notices</i>

Finding a Topic Within a Guide

To find specific information within a guide:

- Use the bookmarks or search features in Acrobat Reader.
 - Select any plus sign (+) in the left pane of the Acrobat Reader window to display subheadings.
 - Select Edit > Find or Edit > Search to search quickly for a topic. Select the Help button for additional information on Acrobat Reader search, navigation, or print topics.
- Use the Index in this guide.
 - Indexes list specific items under group headings, such as “buttons,” or “jacks,” that may be helpful if you do not know the name of an item.
 - Index listings direct you to the first page of a topic. You may find more information about the topic by scrolling through a few of the pages that follow.

Contacting Compaq

If you encounter a notebook problem that you cannot resolve with the information provided, you may need to contact Compaq.

- If the notebook is connected to the Internet, visit the Compaq Web site.
 - For home, home office, and small business help and support, type the following in your Web browser address field:

<http://www.compaq.com/athome/support>

This area of the Compaq Web site is available in English worldwide. Other languages are offered in some regions.
 - For commercial business support in English only, visit:

<http://www.compaq.com/support/files>
- If you cannot access information in your language, or if the notebook is not connected to the Internet, refer to the *Worldwide Telephone Numbers* booklet. Included with the notebook, this booklet provides contact information for support technicians, and Compaq authorized dealers, resellers, and service providers worldwide.

Preparing to Call Technical Support

To provide the fastest possible resolution of your problem, have the following items available when you call:

- The notebook
- Serial number and model description of the notebook, which are provided on the serial number label on the underside of the notebook
- Product family name and series number, which are printed in the lower left corner of the display bezel
- Purchase date on the invoice
- Conditions under which the problem occurred

- Error messages that have been displayed.
- Operating system version number and registration number.

To display the operating system version number and registration number:

- ❑ **In Windows 2000 Professional**, select Start > Settings > Control Panel > System > General tab.
- ❑ **In Windows XP Home or Windows XP Professional**, select Start > Control Panel > Performance and Maintenance > System > General tab.
- Brand and model of an optional printer.
- Reports from any tests you have run in Compaq Diagnostics.

For information about using Compaq Diagnostics to report configuration or diagnostic information, refer to the “Setup and Diagnostics Utilities” chapter in the *Software Guide* on the *Documentation Library* CD included with the notebook.

Taking the Notebook to a Service Provider

In addition to providing the items listed in the preceding section, “Preparing to Call Technical Support,” be sure to:

- Delete all passwords, or
- Disclose all passwords to the service provider.

For information about using passwords, refer to the “Security” chapter in the *Software Guide* on the *Documentation Library* CD.

Hardware Components

Display Components

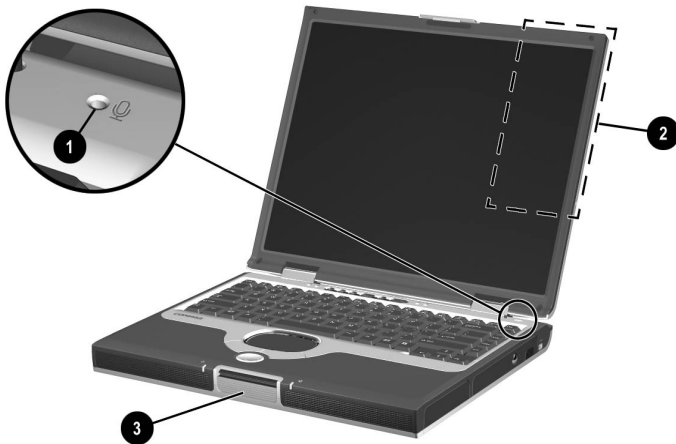

Display Components

❶	Microphone	Inputs monaural sound.
❷	MultiPort	Supports an optional USB-enabled wireless device such as a Bluetooth MultiPort, 802.11b Wireless LAN MultiPort, and future wireless technologies.
❸	Display release latch	Opens the notebook.

Pointing Device Components

TouchPad Models

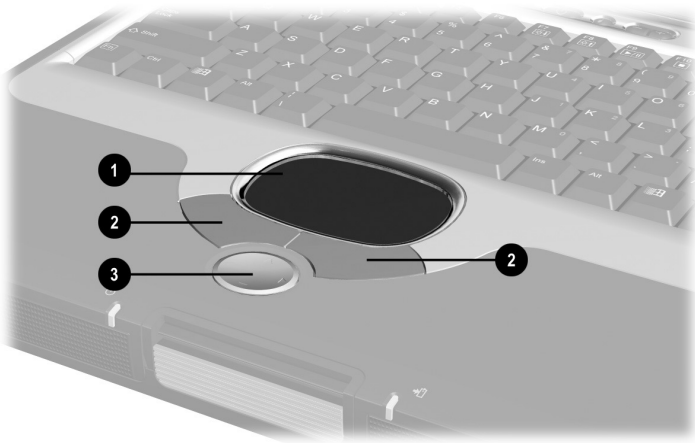

Pointing Device Components: TouchPad Models

① TouchPad	Moves the pointer and selects or activates items on the screen. Can be set to perform additional mouse functions, such as scrolling, selecting, and double-clicking.*
② Left and right TouchPad buttons	Function like the left and right buttons on an external mouse.
③ Scroll button	Scrolls up, down, left, or right through most application and Internet browser windows.

*For information about changing pointing device functions, refer to the “Pointing Devices and Keyboard” chapter, in the *Hardware Guide* on the *Documentation Library* CD.

Dual-Device Models

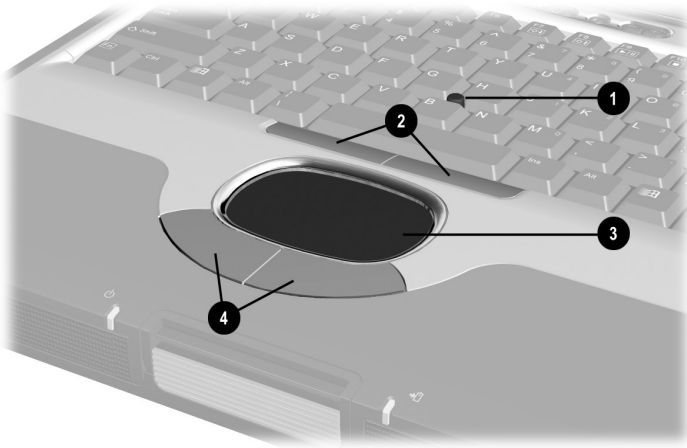

Pointing Device Components: Dual-Device Models

① Pointing stick	Moves the pointer and selects and activates items on the screen.
② Left and right pointing stick buttons	Function like the left and right buttons on an external mouse.
③ TouchPad	Moves the pointer and selects or activates items on the screen. Can be set to perform additional mouse functions such as scrolling, selecting, and double-clicking.
④ Left and right TouchPad buttons	Function like the left and right buttons on an external mouse.

Top Components

Power Lights



Top Components: Power Lights

❶	AC adapter light	On: AC power is being supplied through the AC adapter.
❷	Power/standby light	On: Power is turned on. Blinking: Notebook is in Standby or has reached a critical low-battery condition.
❸	Battery light	On: A battery pack is charging. Blinking: A battery pack, which is the only available power source, has reached a low-battery condition.

Keyboard and Drive Lights



Top Components: Keyboard and Drive Lights

❶	Num lock light	On: Num lock or the internal keypad is on.*
❷	Caps lock light	On: Caps lock is on.
❸	IDE (Integrated Drive Electronics) drive light	On: The internal hard drive, CD, or DVD drive is being accessed.

*For information about using num lock, the internal keypad, or an external keypad, refer to the “Pointing Devices and Keyboard” chapter, in the *Hardware Guide* on the *Documentation Library CD*.

Power and Volume Controls

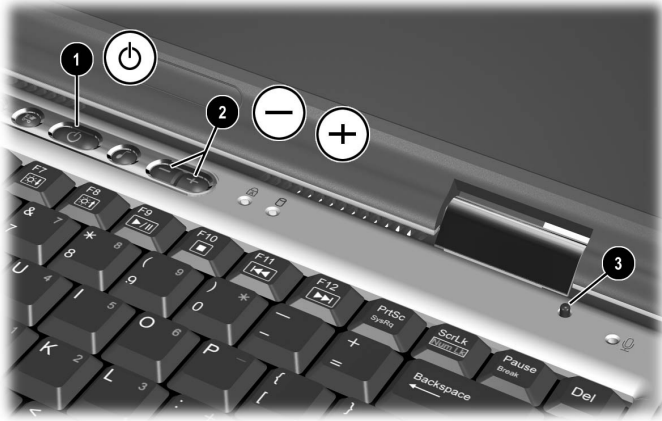

Top Components: Power and Volume Controls

- | | |
|----------------------|--|
| ❶ Power button* | When the notebook is: <ul style="list-style-type: none">■ Off, press to turn on the notebook.■ On, briefly press to initiate Hibernation.■ In Standby, briefly press to resume from Standby.■ In Hibernation, briefly press to resume from Hibernation. <p> If the system has stopped responding and Windows shutdown procedures cannot be used, press and hold for at least 4 seconds to turn off the notebook.</p> |
| ❷ Volume buttons (2) | Adjust, mute, or restore system volume. To mute or restore volume, press both buttons at the same time. |
| ❸ Display switch* | Turns off the notebook display if the notebook is closed while the power is on. |

*This table describes default settings. For information about changing the function of the power button or display switch, refer to the “Power” chapter, in the *Software Guide* on the *Documentation Library CD*.

Easy Access Buttons and Keyboard Keys

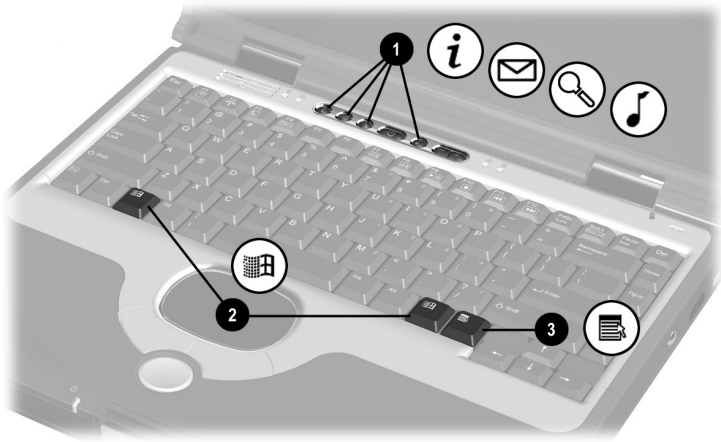

Top Components: Easy Access Buttons and Keyboard Keys

- | | |
|---|---|
| <p>1 Easy Access buttons (4)</p> | <p>Provide quick access to Internet or network destinations, to applications, or to data files on a drive.</p> <p>The icon on each button represents the default destination. Buttons can be reset to point to other locations.</p> <p> See the “Pointing Devices and Keyboard” chapter in the <i>Hardware Guide</i> on the <i>Documentation Library</i> CD for instructions on changing the destination of Easy Access buttons.</p> |
| <p>2 Microsoft logo keys (2)</p> | <p>Display the Windows Start menu.</p> |
| <p>3 Applications key</p> | <p>Displays a shortcut menu for items beneath the pointer.</p> |
-

Function and Keypad Keys

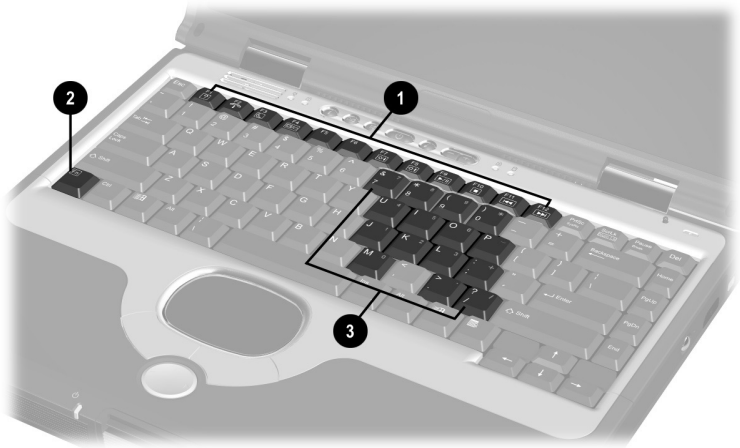

Top Components: Function and Keypad Keys

❶	Function keys (12)	Perform system and application tasks. When combined with the Fn key, the function keys F2 through F4 and F7 through F12 perform additional tasks as hotkeys.*
❷	Fn key	Combines with other keys to perform system tasks. For example, pressing the Fn+F7 hotkeys decreases screen brightness and pressing the Fn+F8 hotkeys increases screen brightness.
❸	Keypad keys (15)*	Can be used like the keys on an external numeric keypad.

*For details about using hotkeys or keypad keys, see the “Pointing Devices and Keyboard” chapter in the *Hardware Guide* on the *Documentation Library* CD.

Front Panel Components

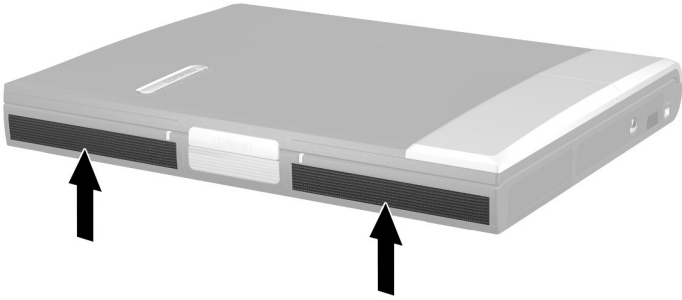

Front Panel Components

Stereo speakers (2)

Produce stereo sound.

Rear Panel Components

Connectors

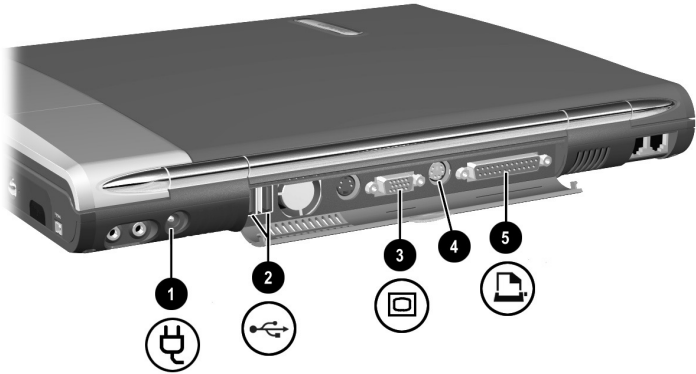



Rear Panel Components: Connectors

①	AC power connector	Connects an AC adapter.
②	USB connectors (2)	Connect optional USB devices.
③	External monitor connector	Connects an optional external monitor or overhead projector.
④	Keyboard/mouse connector	Connects an optional PS/2 keyboard or mouse.  To connect a mouse and keyboard at the same time, use an optional Y-adapter.
⑤	Parallel connector	Connects an optional parallel device such as a printer.

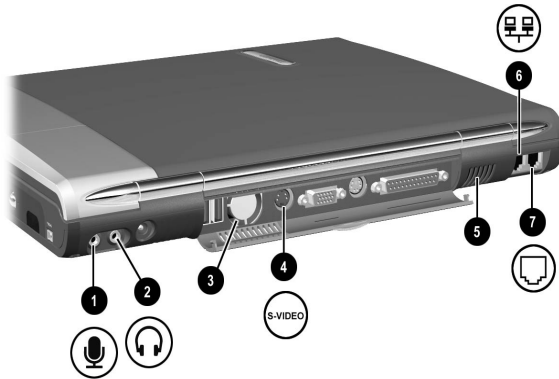
Jacks and Thermal Components



Rear Panel Components: Jacks and Thermal Components

①	Microphone jack	Connects an optional single-sound channel microphone.
②	Audio-out jack	Connects optional headphones, headset, or powered stereo speakers. Also connects the audio function of an audio/video device, such as a television or VCR.
③	Fan	Cools internal components.
④	S-video-out jack	Connects an optional S-video device, such as a television, VCR, camcorder, overhead projector, or video capture card.
⑤	Vent	The internal fan and vent allow airflow to cool internal components. <div style="text-align: center;">  </div> To prevent overheating, do not obstruct vents. Do not allow a hard surface, such as an adjoining printer, or a soft surface, such as bedding or clothing, to block airflow.
⑥	RJ-45 network jack	Connects a network cable. <div style="text-align: center;">  </div> A network cable is included with some models.
⑦	RJ-11 telephone jack	Connects the modem cable.

Left Side Components

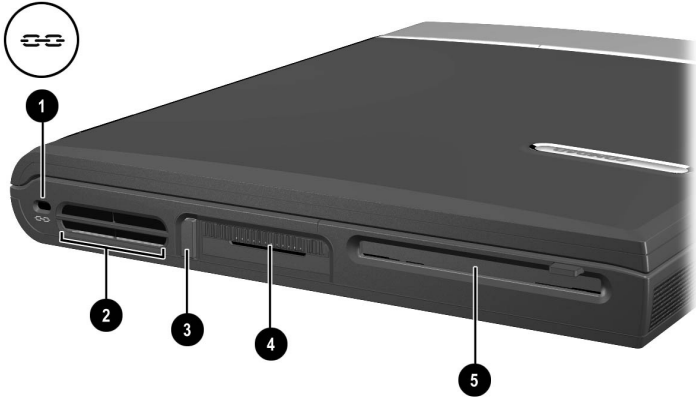

Left Side Components		
1	Security cable slot	Attaches an optional security cable to the notebook.
2	Vent	Allows airflow to cool internal components.  To prevent overheating, do not obstruct the vent. Do not allow a hard surface, such as an adjoining printer, or a soft surface, such as bedding or clothing, to block airflow.
3	PC Card eject button	Ejects an optional PC Card from the PC Card slot.
4	PC Card slot	Supports an optional Type I or Type II 32-bit (CardBus) or 16-bit PC Card.
5	Diskette drive (on select models)	Enables read/write operations to a standard 3.5-inch diskette.

Right Side Components

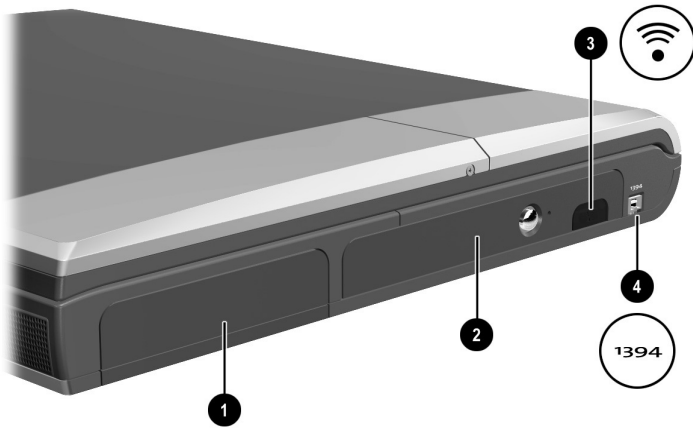

Right Side Components

①	Battery bay	Holds the battery pack.
②	Optical drive bay	Holds CD-ROM, CD-RW, DVD, or DVD/CD-RW drives.
③	Infrared port	Provides wireless communication between the notebook and an optional IrDA-compliant device.
④	1394 connector	Connects an optional 1394 device, such as a camcorder.

Bottom Components

Memory and Mini PCI Compartments

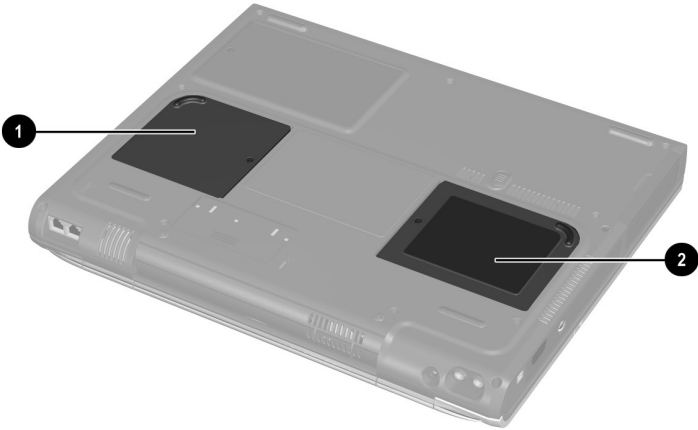

Bottom Components: Memory and Mini PCI Compartments

- | | |
|--|--|
| ❶ Mini PCI (Peripheral Component Interconnect) compartment | Contains the mini PCI modem card. |
| ❷ Memory compartment | Contains 2 memory slots for PC2100-compliant memory boards. The memory compartment may contain one or two memory boards, depending on the model. |
-

Docking and Thermal Components

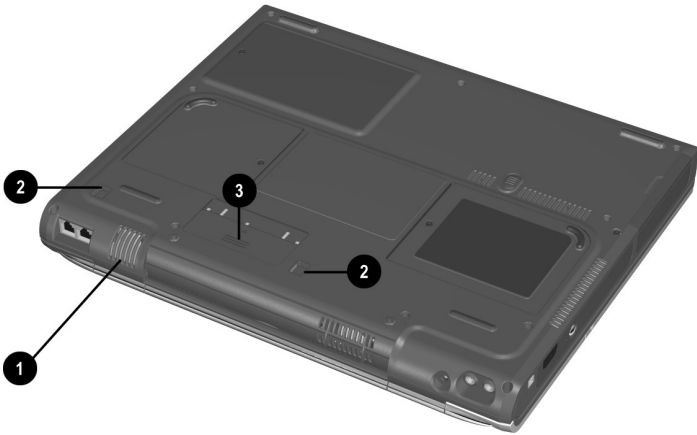

Bottom Components: Docking and Thermal Components

1 Vent

Allows airflow to cool internal components.

 To prevent overheating, do not obstruct vents. Do not allow a hard surface, such as an adjoining printer, or a soft surface, such as bedding or clothing, to block airflow.

2 Docking latch recesses (2)

Help secure the notebook to an optional Port Replicator.

3 Docking connector



Connects the notebook to an optional Port Replicator.

 The docking connector has a plastic cover that must be opened before docking.

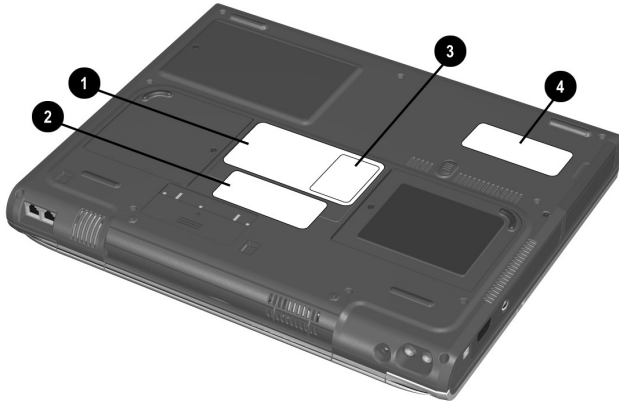
Labels



Bottom Components: Labels

❶	System label	Provides regulatory information about the notebook.
❷	Microsoft Certificate of Authenticity label	Contains your Product Key number.  You may need this information to update or troubleshoot the operating system.
❸	Optional MultiPort agency approvals label (only on models that ship with a wireless device)	Lists the countries in which this optional wireless device has been approved for use.  You may need this information to use the wireless device while traveling.
❹	Serial number	Identifies the notebook.  You will need this number if you call Compaq customer support or download software from the Compaq Web site.

 The appearance and position of labels vary by model.

Additional Standard Components

The components included with the notebook vary by geographic region and the PC hardware ordered. The following illustrations and tables identify the standard external components included with most notebook models.

Software Restore and Documentation CDs

Your notebook includes the following CDs for restoring software and accessing product documentation:



- *Compaq QuickRestore CD* contains preinstalled software that allows you to restore your notebook to the factory image. To install or restore one or more applications without reformatting the hard drive, select Start > Software Setup and follow the instructions on the screen.
- The *Documentation Library CD*, which includes the following guides:
 - ❑ *Hardware Guide*
 - ❑ *Software Guide*
 - ❑ *Modem Command Guidelines (Advanced Users Only)*
 - ❑ *Lucent/Agere Command Set (Advanced Users Only)*
 - ❑ *Conexant Command Set (Advanced Users Only)*
 - ❑ *Maintenance, Shipping and Travel*
 - ❑ *Regulatory and Safety Notices*
 - ❑ *Safety & Comfort Guide*
 - ❑ *Troubleshooting*

For information about using the *Documentation Library CD*, see Chapter 2, “Beginning to Use the Notebook.”

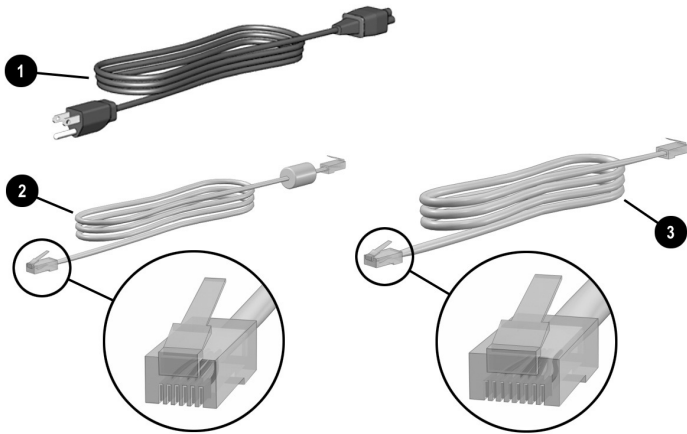
Cords and Cables



Additional Standard Components: Cords and Cables

❶	Power cord*	Connects the AC adapter to an AC electrical outlet.
❷	Modem cable	Connects the modem to an RJ-11 telephone jack or to a country-specific modem adapter.  The modem cable has a 6-pin, RJ-11 telephone connector at each end.
❸	Network cable (included with select models only)	Connects the notebook to an Ethernet network jack.  The network cable has an 8-pin, RJ-45 network connector at each end.

*Power cords vary in appearance by region.

Adapters and Accessories

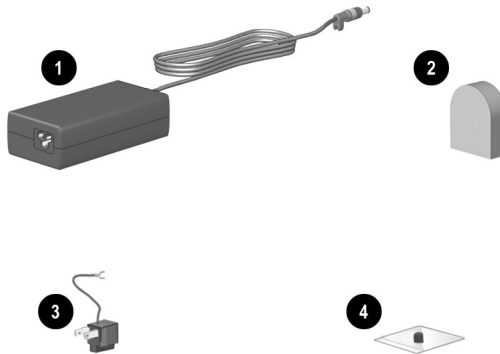

Additional Standard Components: Adapters and Accessories

①	AC adapter*	Converts AC power to DC power.
②	Country-specific modem adapter (included by region as required)	Adapts the modem cable to a non-RJ-11 telephone jack.
③	Japan-specific outlet adapter (Japan only)	Connects the AC adapter to a 2-prong electrical outlet.
④	Spare pointing stick cap (dual-device models only)	Replaces a worn pointing stick cap.

*AC adapters vary by region.

Index

A

- AC adapter
 - connecting 1-2, 1-3
 - identifying 3-19
 - light 3-4
- Acrobat Reader 2-5, 2-7
- applications. *See* software
- audio-out jack 3-11
- AutoPlay, autorun 2-5

B

- battery bay 3-13
- battery light 3-4
- battery, power 1-8
- buttons
 - Easy Access 3-7
 - PC Card eject 3-12
 - power 3-6
 - volume 3-6
- See also* keys; latches

C

- cable
 - AC adapter 1-2, 1-3
 - modem 3-11, 3-18
 - network 3-18
 - surge protection 1-8

- caps lock light 3-5
- CDs
 - displaying contents of 2-5
 - inserting 2-4
- Compaq customer support 2-6, 2-8
- Compaq utilities, installing 2-3
 - See also* software
- Compaq Web site 2-8
- compartments
 - memory 3-14
 - mini PCI (peripheral component interconnect) 3-14
- connectors
 - 1394 3-13
 - AC power 1-3, 3-10
 - docking 3-15
 - external monitor 3-10
 - infrared port 3-13
 - keyboard/mouse 3-10
 - parallel 3-10
 - USB 3-10
- See also* jacks
- cord, power
 - connecting 1-2, 1-3
 - surge protection 1-8
- currency formats, setting 2-1
- customer support 2-6, 2-8

D

- date, setting 2–1
- diskette drive, identifying
 - 3–12
- display (internal)
 - opening 1–4
 - screen resolution settings
 - 2–2
- display release latch 3–1
- docking components 3–15
- Documentation Library CD*
 - 2–5, 2–7
- drive light 3–5
- drives
 - designations 2–5
 - diskette 3–12

E

- Easy Access buttons 3–7
- emergency shutdown steps
 - 1–7
- external hardware
 - adapters and accessories
 - 3–19
 - bottom components 3–16
 - cords and cables 3–18
 - display components 3–1
 - dual pointing device
 - models 3–3
 - front components 3–9
 - left side components 3–12
 - rear panel components
 - 3–10, 3–11

- right side components 3–13
- top components 3–4, 3–5
- TouchPad models 3–2

F

- fan, vents 3–11, 3–12
- function keys 3–8

H

- hard drive, IDE drive light 3–5
- help
 - contacting Compaq 2–8
 - Documentation Library CD*
 - 2–5
- Hibernation
 - exiting 3–6
 - initiating 3–6

I

- IDE (Integrated Drive Electronics) light 3–5
- identifying components
 - adapters and accessories
 - 3–19
 - bottom 3–14, 3–15
 - cords and cables 3–18
 - display 3–1
 - dual pointing device
 - models 3–3
 - front 3–9
 - labels 3–16
 - left side 3–12
 - rear panel 3–10, 3–11
 - right side 3–13
 - top 3–4, 3–5, 3–6, 3–7, 3–8
 - TouchPad models 3–2
- infrared port 3–13

J

- jacks
 - audio-out 3–11
 - microphone 3–11
 - RJ-11 3–11
 - RJ-45 3–11
 - S-video-out 3–11
 - See also* connectors
- Japan-specific modem adapter 3–19

K

- keyboard language 2–1
- keyboard light 3–5
- keyboard/mouse connector 3–10
- keypad keys 3–8
- keys
 - Easy Access 3–7
 - function 3–8
 - keypad 3–8
 - Microsoft logo 3–7
 - Windows applications 3–7
 - See also* buttons; latches

L

- labels 3–16
- language
 - choosing during setup 1–6
 - selecting keyboard 2–1
- latches
 - display release 3–1
 - docking 3–15

lights

- AC adapter 3–4
- battery 3–4
- caps lock 3–5
- IDE drive 3–5
- keyboard 3–5
- num lock 3–5
- power/standby 3–4
- locked system, emergency shutdown steps 1–7

M

- memory compartment 3–14
- microphone jack 3–11
- microphone, internal 3–1
- Microsoft logo keys 3–7
- modem
 - cable 3–18
 - country-specific adapter 3–19
 - identifying RJ-11 jack 3–11
 - surge protection 1–8
- MultiPort, identifying 3–1

N

- network cable 3–18

O

- opening notebook 1–4
- operating system, Product Key number 3–16
- optical drive bay 3–13
- overhead projector (optional), connecting 3–10

P

- parallel connector, identifying 3–10
- PC Card eject button 3–12
- pointing devices
 - dual-device models 3–3
 - replacing pointing stick cap 3–19
 - TouchPad models 3–2
- port replicator (optional), docking connector 3–15
- power cord
 - connecting 1–2, 1–3
 - surge protection 1–8
- power features
 - emergency shutdown 1–7
 - power button 3–6
 - power/standby light 3–4
- Product Key number 3–16

R

- regional settings 2–1
- RJ-11 telephone jack 3–11
 - identifying 3–11
 - modem cable 3–18
- RJ-45 network jack
 - identifying 3–11
 - network cable 3–18

S

- screen resolution, setting 2–2
 - serial number 3–16
 - service provider, preparing for 2–9
 - shutdown, emergency 1–7
 - software
 - Acrobat Reader 2–5
 - antivirus protection 2–2
 - initial setup 1–6
 - installing Compaq 2–3
 - installing optional 2–3
 - regional settings 2–1
 - speakers, internal stereo 3–9
 - Standby
 - exiting 3–6
 - power/standby light 3–4
 - surge protection 1–8
 - S-video-out jack 3–11
- T**
- technical support
 - contacting Compaq 2–8
 - notebook documentation 2–6
 - telephone (RJ-11) jack 3–18
 - telephone numbers, Compaq 2–8
 - time, setting 2–1

traveling with the notebook
 regional settings 2-1
 serial number 3-16
troubleshooting, contacting
 Compaq 2-8
turning notebook on/off 1-5

U

unresponsive system,
 emergency shutdown steps
 1-7
USB connectors 3-10

V

vents, fan 3-11, 3-12
viruses, computer 2-2

W

Web site, Compaq 2-8
Windows applications key 3-7
*Worldwide Telephone Num-
bers* booklet 2-8