

hp photosmart
240 series



reference guide
reference guide
reference guide



1	welcome	1
	find more information	1
	what's in the box	2
	printer overview	3
	front of the printer	3
	back of the printer	4
	indicator lights	4
	control panel	5
	printer menu	5
	printer menu structure	6
	paper information	8
	load paper	8
	print cartridge information	9
	install or replace the print cartridge	9
	remove the print cartridge	10
2	print photos from a memory card	11
	supported memory cards	11
	insert a memory card	12
	decide which photos to print	13
	view photos on the printer's LCD screen	13
	print a photo index	13
	select photos to print	14
	select a photo	14
	deselect a photo	15
	deselect all photos	15
	print photos	15
	print individual photos	15
	print more than one copy of a photo	16
	print different photo layouts	16
	print a continuous range of photos	17
	print all photos	17
	print new photos	18
	print borderless photos	18
	print video clips	19
	print camera-selected photos	19
	enhance your photos	20
	crop a photo	20
	adjust the photo brightness	21
	add frames to your photos	22
	change the photo color effect	22
	change printer preferences	23

solve printing problems	24
maintain your printer	24
clean the print cartridge	24
3 installation troubleshooting	25
Windows PC	25
4 support and specifications	27
support	27
hp support by phone	28
specifications	30
system requirements	30
printer specifications	31
hardware services	32
software services	33
software updates	33
software distribution centers	33
limited warranty statement	33
regulatory notices	35
environmental statements	35
protecting the environment	35
plastics	35
material safety data sheets	35
recycling program	35
copyrights and trademarks	36

Thank you for purchasing an HP Photosmart 240 Series printer! With your new, compact photo printer, you can print beautiful photos quickly and easily with or without a computer. Because it is portable and lightweight, you can even take your printer with you on vacations and to family gatherings and social events to instantly print and share photos with family and friends.

find more information

Your new printer comes with the following documentation to help you get started and get the most out of your printer:

- **Setup Guide** — The *HP Photosmart Setup Guide* contains quick and easy instructions to help you set up your printer and print your first photo.
- **Reference Guide** — The *HP Photosmart 240 Series Reference Guide* is the booklet you are reading. The Reference Guide provides an overview of your printer, selected installation troubleshooting information, selected printer specifications, warranty information, and support information.
- **HP Photosmart Printer Help** — The HP Photosmart Printer Help describes in detail how to use each feature of your new printer. The Printer Help includes information about printer care and maintenance, transporting your printer, printing and saving photos using your computer, advanced troubleshooting, and error messages.

After you have installed the HP Photosmart printer software on your computer, you can view and print the HP Photosmart Printer Help.

view the hp photosmart printer help

- **Windows PC:** From the **Start** menu, select **Programs** (in Windows XP, select **All Programs**); **Hewlett-Packard; Photosmart 140, 240, 7200, 7600, 7700, 7900 series; Photo & Imaging Director**. From the **Photo & Imaging Director**, click **Help**.
- **Macintosh:** Insert the HP Photosmart CD. In the **User Docs** folder, select your **language**, then double-click the **photosmart 240 series.html** file.

print the hp photosmart printer help

- **Windows PC:** Click **Print** in the top navigation bar of the HP Photosmart Printer Help window.
- **Macintosh:** Click in the frame you want to print. From the **File** menu, select **Print**, or click **Print** in the top navigation bar of the browser.

what's in the box

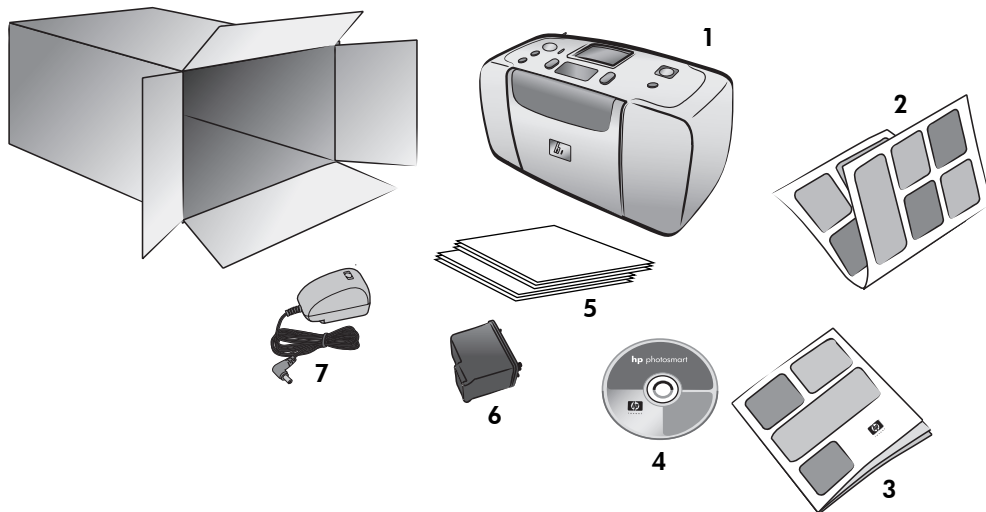

Your printer box contains the following items:

- 1 The HP Photosmart 240 Series printer
- 2 The *HP Photosmart 240 Series Setup Guide*
- 3 The *HP Photosmart 240 Series Reference Guide*
- 4 The HP Photosmart 240 Series printer software CD (some countries/regions may have more than one CD)
- 5 Sample photo paper and index cards
- 6 The HP #57 tri-color print cartridge
- 7 A power supply (power supplies may vary in appearance or have an additional power cord)

Note: Contents may vary by country and region.

printer overview

front of the printer

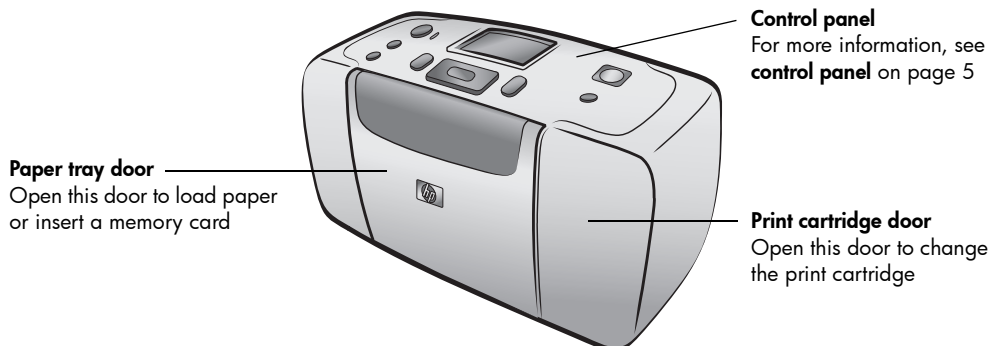

back of the printer

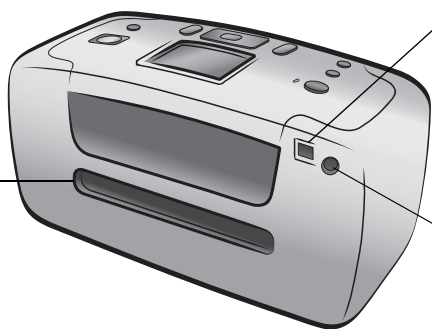

Rear paper slot

During printing, the printer pushes the paper partially through this slot and then pulls it back through to the front of the printer

USB port

Use this port to connect the printer to your computer or to an HP direct-printing digital camera

Power cord connection

Use this port to connect the power cord included with the printer

Note: Place the printer on a flat, stable surface with the back of the printer at least 10 inches (250 mm) away from any obstruction to allow space for the paper to move through the printer during printing. Make sure the power cord and USB cable do not block the rear paper path.

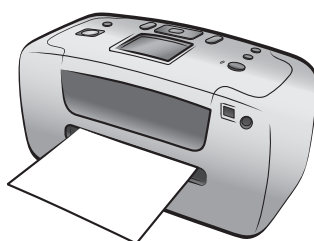

indicator lights

On/Attention light

On (Green)

The power is on

Off

The printer is in power-save mode

Blinking (Green)

The printer is busy

Blinking (Red)

The printer requires attention



Memory card light

On

The memory card is inserted correctly

Off

No memory card is inserted

Blinking

Information is being transmitted between the memory card and the printer or computer

control panel

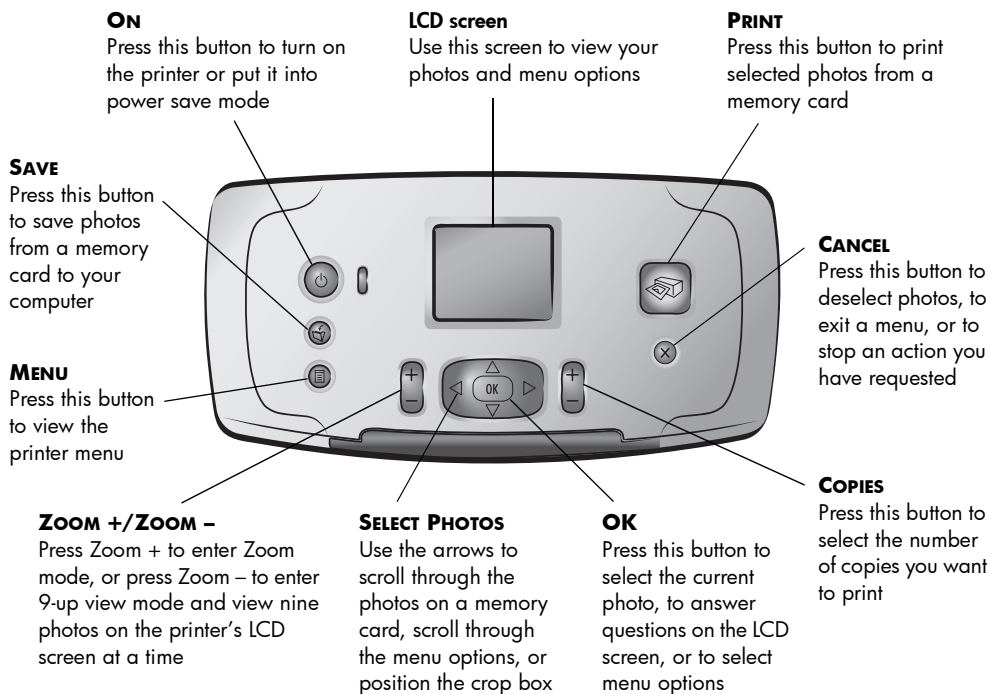

printer menu

Press the **MENU** button on the printer's control panel to access the printer menu.

To navigate the printer menu:

- Press the **SELECT PHOTOS** **▲** or **▼** button to scroll through the menu options displayed on the printer's LCD screen.
- Press the **OK** button to open a menu or select an option.
- Press the **CANCEL** button to return to the previous menu.

printer menu structure

Top level menu	Submenus/options	Additional submenus/options
Change layout	Select Layout: <ul style="list-style-type: none"> • 1 photo • 2 photos • 4 photos 	
Print special	Print all	
	Print range	Select beginning of range: Select end of range:
	Print new	
	Print index	
Enhance image	Photo brightness	(select -3 to +3; no change is 0)
	Add frame	Select pattern: Select color:
	Add color effect	Choose color effect: <ul style="list-style-type: none"> • Black & white • Sepia • Antique • No effect (default)
Tools	Slide show	
	Print quality	Print quality: <ul style="list-style-type: none"> • Best (default) • Normal
	Print test page	
	Clean cartridge	Continue to second level cleaning?
		Continue to third level cleaning?
Calibrate printer		
Preferences	After printing	After printing, deselect all photos: <ul style="list-style-type: none"> • Always • Never • Ask (default)
	# of copies	Set default number of copies: (select 1 to 99; default is 1)

Top level menu	Submenus/options	Additional submenus/options
Preferences (continued from previous page)	Photo layout	Set default photo layout: <ul style="list-style-type: none"> • Ask (default) • 1 photo • 2 photos • 4 photos
	Video print	Set default video print frames: <ul style="list-style-type: none"> • 9 per page (default) • 16 per page • 25 per page
	Add date/time	Date/time stamp: <ul style="list-style-type: none"> • Date and time • Date only • Off (default)
	Borderless	Turn borderless printing: <ul style="list-style-type: none"> • On (default) • Off
	Exif printing	Turn Exif printing: <ul style="list-style-type: none"> • On (default) • Off
	Improve contrast	Turn improve contrast: <ul style="list-style-type: none"> • On (default) • Off
	Extend colors	Turn extend colors: <ul style="list-style-type: none"> • On • Off (default)
	Camera selections	Unmark camera selected photos: <ul style="list-style-type: none"> • Always • Never • Ask (default)
	Restore defaults	Restore original factory preferences: <ul style="list-style-type: none"> • Yes • No
	Language	Select language: Select country/region:

For detailed information about each of the options listed in the printer menu, see the HP Photosmart Printer Help. For information about viewing the Printer Help, see **view the hp photosmart printer help** on page 1.

paper information

You can print on photo paper, plain paper, or index cards. Your printer supports the following paper types and sizes:

Type	Size	Purpose
Photo paper	4 x 6 inches (10 x 15 cm)	Printing photos
Photo paper with tab	4 x 6 inches with 0.5 inch tab (10 x 15 cm with 1.25 cm tab)	Printing borderless photos
Index cards	4 x 6 inches (10 x 15 cm)	Printing drafts, calibration pages, and test pages
Hagaki cards	4 x 5.5 inches (100 x 140 mm)	Printing photos
A6 cards	4.13 x 5.8 inches (105 x 148 mm)	Printing photos
L-size cards	3.5 x 5 inches (90 x 127 mm)	Printing photos
L-size cards with tab	3.5 x 5 inches with 0.5 inch tab (90 x 127 mm with 12.5 mm tab)	Printing borderless photos

load paper

- 1 Open the paper tray door.
- 2 Place a stack of paper on the paper tray and slide it underneath the output guide.
 - The printer prints on the side of the paper that is facing up. If you are using photo paper, load the paper with the **glossy side up**. If you are using tabbed paper, load the paper into the paper tray so the **tab feeds into the printer first**.
 - Load 10 to 20 sheets of photo paper or index cards.
 - Use one type and size of paper at a time. Do not mix paper types or sizes in the paper tray.
- 3 Move the paper width guide on the paper tray to fit close to the left edge of the paper without bending the paper. This helps the paper feed straight into the printer.

Tip: With paper other than HP premium plus photo paper, you may experience paper feeding or ejecting problems. Try loading fewer sheets of paper at a time and make sure the edges of the paper stack are lined up.

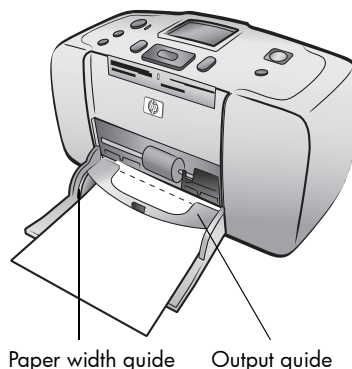

print cartridge information

Your HP Photosmart 240 Series printer can print color and black and white photos. HP provides two types of print cartridges so you can choose the best print cartridge for your project.

For the highest quality photos, follow these guidelines:

To print...	Use...
Color photos	HP #57 (C6657A) tri-color print cartridge
Black and white photos	HP #59 (C9359A) photo gray print cartridge (available Fall 2003)

Caution! Check that you are using the correct print cartridge. Also, note that HP does not recommend modifying or refilling HP print cartridges. Damage that results from modifying or refilling HP print cartridges is not covered by HP's warranty.

install or replace the print cartridge

1 If the printer is off, press the **ON** button on the printer's control panel.

2 Take the new print cartridge out of its package and pull the **tab** to remove the **plastic tape**. Be sure to install the print cartridge immediately after removing the tape; ink nozzles exposed longer than one minute may dry out and cause printing problems later. Once the tape is removed, do not attempt to replace it.

Copper contacts

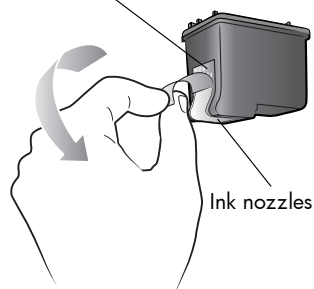

Caution! Do **not** touch the ink nozzles or the copper contacts on the print cartridge. Touching these parts may cause the print cartridge to fail.

3 Open the print cartridge door.

Note: For instructions on removing a print cartridge, see **remove the print cartridge** on page 10.

Note: The red On/Attention light flashes when the print cartridge door is open.

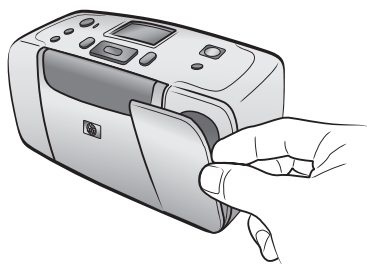

- 4 Place the print cartridge in the print cartridge cradle with the copper contacts facing toward the inside of the printer and the ink nozzles facing down.
- 5 Push the print cartridge into the print cartridge cradle until you feel it snap into place.
- 6 Close the print cartridge door.

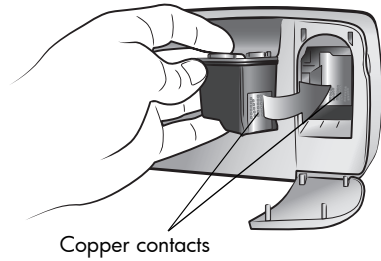

After you install a new print cartridge, a message appears on the printer's LCD screen asking you to load plain paper. Load an index card in the paper tray, then press the **OK** button. The printer automatically calibrates the new print cartridge and prints a calibration page.



Calibration page

- The check marks verify that the print cartridge is installed correctly and functioning properly.
- If an "x" appears to the left of any of the bars, calibrate the print cartridge again using the **Calibrate Printer** option under **Tools** in the printer menu. If the "x" still appears, replace the print cartridge.



remove the print cartridge

- 1 Open the print cartridge door.
- 2 Push down and pull outward on the top of the print cartridge to unsnap it from the print cartridge cradle.

Remove the print cartridge from the printer.

- 3 If there is ink in the print cartridge, place the cartridge in a print cartridge protector for storage. If the print cartridge is empty, discard or recycle the print cartridge. For information about recycling print cartridges, go to www.hp.com/recycle.

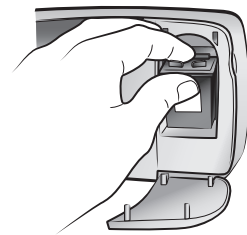

It's easy to print high-quality photos for yourself, family, and friends. If your digital camera uses a memory card to store photos, you can insert the memory card into the printer to print your photos. Messages on the printer's LCD screen guide you through the process—you don't have to turn on your computer or even have your printer connected to a computer!

Note: You can also print photos using your computer. For more information, see the HP Photosmart Printer Help. For information about viewing the Printer Help, see **view the hp photosmart printer help** on page 1.

supported memory cards

Your HP Photosmart printer can read the following memory cards:

- CompactFlash™ Association (CFA) certified Type I and II
- MultiMediaCard™
- Secure Digital™
- SmartMedia™
- Sony® Memory Sticks
- xD-Picture Card™

These cards are manufactured by several vendors and are available in a variety of storage capacities. You can purchase memory cards where you purchased your digital camera or at most computer supply stores.

Caution! Using any other type of memory card may damage the memory card and the printer.

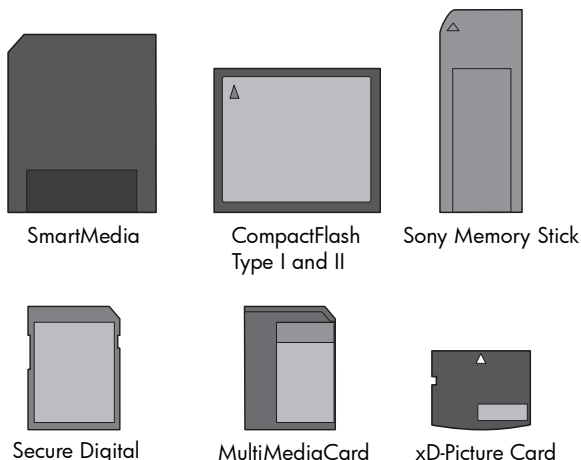

supported image file formats

You can print photos from JPEG and uncompressed TIFF image files directly from the memory card. If your digital camera supports other file formats, save the files to your computer and print them using a software application. For more information, see the HP Photosmart Printer Help. For information about viewing the Printer Help, see **view the hp photosmart printer help** on page 1.

insert a memory card

After you take pictures with your digital camera, remove the memory card from the camera and insert it into your printer. When the memory card is inserted correctly, the memory card light blinks and then remains solid.

Caution! Do not pull out the memory card while the memory card light is blinking. Removing a memory card while it is being accessed may damage the printer or the memory card, or corrupt the information on the memory card.

To insert a memory card:

- 1 Remove any memory cards that are already inserted into any of the memory card slots.
- 2 Find the correct slot for your memory card.

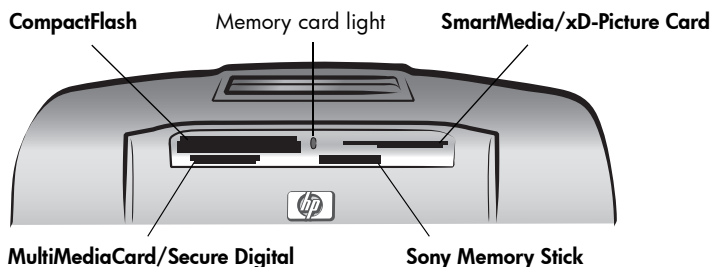

Note: If you are using a Sony Memory Stick Duo memory card, attach the adapter that came with the memory card before you insert it into the printer's memory card slot.

- 3 Insert the memory card into the appropriate memory card slot with the copper contacts down or the metal pinholes facing toward the printer.

Caution! Inserting the memory card any other way may damage the memory card or the printer.

Note: If you insert a SmartMedia memory card upside down, the red On/Attention light will begin blinking. Remove the memory card and reinsert it properly.

- 4 Gently push the memory card into the printer until it stops. The memory card may not insert all the way into the printer. Forcing the memory card into the printer too far may damage the memory card or the printer.

The printer reads the memory card and briefly displays how many photos and video clips were found on the card.

Note: If you used your digital camera to select photos on the memory card, a message appears on the printer's LCD screen asking if you want to print camera-selected photos. For more information, see **print camera-selected photos** on page 19.

decide which photos to print

You can decide which photos to print by viewing the photos on the printer's LCD screen or by printing a photo index.

view photos on the printer's LCD screen

- 1 Insert a memory card into the printer's memory card slot. For more information, see **insert a memory card** on page 12.
- 2 If you have not changed the default photo layout in the printer preferences, you will be asked to select a layout for your photos. Press the **SELECT PHOTOS** ▲ or ▼ button to highlight the photo layout you want to print—1, 2, or 4 photos per page—then press the **OK** button. For more information about changing the printer preferences, see **change printer preferences** on page 23.

The first photo on the memory card appears on the printer's LCD screen.

- 3 You can view the photos on the memory card in two ways:
 - **To view the photos one at a time** — Press the **SELECT PHOTOS** ◀ or ▶ button to navigate through the photos.
 - **To view nine photos at a time** — Press the **ZOOM –** button to enter 9-up view mode. Use the arrows on the **SELECT PHOTOS** button to navigate through the photos. To exit 9-up view mode and return to viewing one photo at a time, press the **ZOOM +** button.

Tip: To move quickly through the photos, press and hold the arrows on the **SELECT PHOTOS** button. When you reach the last photo in either direction, the printer cycles back to the first or last photo and continues.

print a photo index

A photo index shows thumbnail views and index numbers for all the photos stored on the memory card, up to a maximum of 2000 photos. The photos print in the order in which they are stored on the memory card, with up to 28 photos per page. For information about printing a photo index, see the HP Photosmart Printer Help. For information about viewing the Printer Help, see **view the hp photosmart printer help** on page 1.

select photos to print

You can select one or more photos to print using the printer's control panel.

select a photo

- 1 Insert a memory card into the printer's memory card slot. For more information, see **insert a memory card** on page 12.
- 2 Press the **SELECT PHOTOS** ▲ or ▼ button to highlight the photo layout you want to print—1, 2, or 4 photos per page—then press the **OK** button.

The first photo on the memory card appears on the printer's LCD screen.

- 3 Press the **SELECT PHOTOS** ◀ or ▶ button to navigate to the photo you want to select.

Tip: To move quickly through the photos, press and hold the **SELECT PHOTOS** ◀ or ▶ button.

- 4 When the photo you want to select appears on the printer's LCD screen, press the **OK** button to select it.

A small printer icon appears on the printer's LCD screen in the bottom left corner of the photo to indicate that the photo has been selected. The default number of copies and an icon showing the current photo layout also appear at the bottom of the photo. In addition, a green crop box is displayed around the photo to indicate the portion of the photo that will be printed.



- 5 To select additional photos to print, repeat steps 3 and 4.

To select a photo in 9-up view mode:

- 1 Press the **ZOOM -** button to enter 9-up view mode. (In 9-up view mode, 9 photos appear on the printer's LCD screen at a time.)
- 2 Use the arrows on the **SELECT PHOTOS** button to navigate through the photos.

Tip: To move quickly through the photos, press and hold the arrows on the **SELECT PHOTOS** button.

- 3 When the photo you want to select appears highlighted on the printer's LCD screen, press the **OK** button to select it.

A small printer icon appears on the printer's LCD screen in the bottom left corner of the photo to indicate that the photo has been selected.

- 4 To select additional photos to print, repeat steps 2 and 3.

Note: To exit 9-up view mode and return to viewing one photo at a time, press the **ZOOM +** button.

deselect a photo

- Press the **SELECT PHOTOS** ◀ or ▶ button to display the photo you want to deselect, then press the **CANCEL** button.
- In 9-up view mode, use the arrows on the **SELECT PHOTOS** button to highlight the photo you want to deselect, then press the **CANCEL** button.

The printer deselects the photo and discards any changes you made to that photo's print settings—number of copies, cropping, brightness, decorative frame, or color effect.

Note: Deselecting photos does not delete them from the memory card.

deselect all photos

- 1 To deselect all selected photos, press the **CANCEL** button until the printer asks if you want to deselect all photos.
- 2 Press the **SELECT PHOTOS** ▼ button to highlight **Yes**, then press the **OK** button.

print photos

You can print the photos stored on a memory card using your printer's control panel. Printing photos from a memory card is easy—just insert the memory card into the printer, make your selections, and press the **PRINT** button.

print individual photos

- 1 Insert a memory card into the printer's memory card slot. For more information, see **insert a memory card** on page 12.
- 2 Press the **SELECT PHOTOS** ▲ or ▼ button to highlight the photo layout you want to print—1, 2, or 4 photos per page—then press the **OK** button.
The first photo on the memory card appears on the printer's LCD screen.
- 3 Press the **SELECT PHOTOS** ◀ or ▶ button to navigate through the photos.
- 4 When a photo you want to print appears on the printer's LCD screen, press the **OK** button to select it.
- 5 To select additional photos, press the **SELECT PHOTOS** ◀ or ▶ button until another photo you want to print appears on the printer's LCD screen. Press the **OK** button to select the photo.
- 6 When you have selected all the photos you want to print, press the **PRINT** button to begin printing.

Note: If you press the **CANCEL** button during printing, the printer stops printing, but retains your photo selections and print settings.

print more than one copy of a photo

- 1 Insert a memory card into the printer's memory card slot. For more information, see **insert a memory card** on page 12.
- 2 Press the **SELECT PHOTOS** ▲ or ▼ button to highlight the photo layout you want to print—1, 2, or 4 photos per page—then press the **OK** button.
The first photo on the memory card appears on the printer's LCD screen.
- 3 Press the **SELECT PHOTOS** ◀ or ▶ button to navigate to the photo you want to print.
- 4 When the photo you want to print appears on the printer's LCD screen, press the **COPIES** + or – button to change the number of copies to print.
- 5 Press the **OK** button when the desired number of copies appears on the printer's LCD screen.
- 6 Press the **PRINT** button to begin printing.

Note: You can print a different number of copies of each selected photo by using the **COPIES** + or – button as described in this section. If you do not change the number of copies for a selected photo, the default number of copies will print. The factory default for number of copies is one. For information about changing the default number of copies, see **change printer preferences** on page 23.

print different photo layouts

The photo layout is a global setting—it applies to all the photos you print. When you view a selected photo on the printer's LCD screen, the current photo layout—1, 2, or 4 photos per page—is indicated by an icon in the bottom right corner of the LCD screen.

When you first insert a memory card into the printer's memory card slot, a message appears on the printer's LCD screen asking you to select the photo layout. You can also change the photo layout at any time by using the **MENU** button on the printer's control panel.

To change the photo layout:

- 1 Press the **MENU** button on the printer's control panel.
- 2 Press the **SELECT PHOTOS** ▼ button until **Change layout** is highlighted on the printer's LCD screen. Press the **OK** button.
- 3 Press the **SELECT PHOTOS** ▲ or ▼ button to highlight the photo layout you want to print—1, 2, or 4 photos per page—then press the **OK** button.

The changed photo layout will apply to all photos you print until you choose a different photo layout by using the printer menu or until you remove the memory card from the printer. When the memory card is removed, the photo layout returns to the printer's default photo layout. The printer's factory setting for the default photo layout is to ask you to select a layout each time you insert a memory card. For information about changing the default photo layout, see **change printer preferences** on page 23.

print a continuous range of photos

You can print a continuous range of the photos stored on the memory card.

- 1 Insert a memory card into the printer's memory card slot. For more information, see **insert a memory card** on page 12.
- 2 Press the **SELECT PHOTOS** ▲ or ▼ button to highlight the photo layout you want to print—1, 2, or 4 photos per page—then press the **OK** button.
- 3 When the first photo on the memory card appears on the printer's LCD screen, press the **MENU** button on the printer's control panel.
- 4 Press the **SELECT PHOTOS** ▼ button until **Print special** is highlighted on the printer's LCD screen. Press the **OK** button.
- 5 Press the **SELECT PHOTOS** ▼ button until **Print range** is highlighted on the printer's LCD screen. Press the **OK** button.
- 6 Press the **SELECT PHOTOS** ◀ or ▶ button until the first photo you want to print appears in the left box on the printer's LCD screen. Press the **OK** button to select this photo as the beginning of the range of photos you want to print.

The arrows move to the photo in the right box on the printer's LCD screen and you are asked to select the photo at the end of the range.

- 7 Press the **SELECT PHOTOS** ◀ or ▶ button until the last photo you want to print appears in the right box on the printer's LCD screen. Press the **OK** button to select this photo as the end of the range of photos you want to print.

The printer's LCD screen displays the selected range of photos.

- 8 Press the **PRINT** button to begin printing.

print all photos

You can choose to print all the photos on your memory card at once.

- 1 Insert a memory card into the printer's memory card slot. For more information, see **insert a memory card** on page 12.
- 2 Press the **SELECT PHOTOS** ▲ or ▼ button to highlight the photo layout you want to print—1, 2, or 4 photos per page—then press the **OK** button.
- 3 When the first photo on the memory card appears on the printer's LCD screen, press the **MENU** button on the printer's control panel.
- 4 Press the **SELECT PHOTOS** ▼ button until **Print special** is highlighted on the printer's LCD screen. Press the **OK** button.
- 5 Press the **SELECT PHOTOS** ▼ button until **Print all** is highlighted on the printer's LCD screen. Press the **OK** button.

The first and last photos stored on the memory card appear on the printer's LCD screen.

- 6 Press the **PRINT** button to begin printing all photos, or press the **CANCEL** button to cancel the operation and return to the previous menu.

print new photos

You can choose to print all the “new” photos on your memory card. “New” photos are photos that haven’t previously been printed from the printer’s control panel.

Each time you insert a memory card into the printer’s memory card slot and print photos using the printer’s control panel, the printer tags the photos so that the next time you insert the same memory card, the printer will remember that the photos have already been printed. If you take new photos and store them on that same memory card, when you insert the memory card into the printer’s memory card slot you will have the option to select the new photos you have taken since you last inserted the memory card.

Note: If you print or modify your photos using a computer, the tags placed by the printer might be removed, causing previously printed photos to be selected as new photos.

To print the new photos on a memory card:

- 1 Insert a memory card into the printer’s memory card slot. For more information, see **insert a memory card** on page 12.
- 2 Press the **SELECT PHOTOS** ▲ or ▼ button to highlight the photo layout you want to print—1, 2, or 4 photos per page—then press the **OK** button.
- 3 When the first photo on the memory card appears on the printer’s LCD screen, press the **MENU** button on the printer’s control panel.
- 4 Press the **SELECT PHOTOS** ▼ button until **Print special** is highlighted on the printer’s LCD screen. Press the **OK** button.
- 5 Press the **SELECT PHOTOS** ▼ button until **Print new** is highlighted on the printer’s LCD screen. Press the **OK** button.

The printer’s LCD screen displays the number of new photos found on the memory card and asks if you want to continue.

- 6 Press the **PRINT** button to begin printing the new photos, or press the **CANCEL** button to cancel the operation and return to the previous menu.

print borderless photos

Your printer’s factory default setting is for borderless printing. Photos print all the way to the edges of the paper on three sides, and the fourth side prints with a 0.5 inch (12.5 mm) white border that you can trim off. For truly borderless photos, use photo paper with a 0.5 inch (12.5 mm) tear-off tab, such as HP premium plus photo paper.

You can set the printer to print your photos with white borders on all four sides by turning off the borderless printing option in the printer preferences. For more information, see **change printer preferences** on page 23.

print video clips

Your printer can display and print frames from video clips recorded on a memory card. Your printer recognizes the following video file formats: Motion JPEG AVI, Motion JPEG Quicktime, and MPEG-1. Video clips recorded in other formats will be ignored.

Note: Not all digital cameras allow you to record video clips.

When you insert a memory card containing a video clip into one of the printer's memory card slots, the printer uses the first frame of the video clip to represent the clip on the printer's LCD screen and in the photo index. A small video camera icon in the top right corner of the image indicates that the image is the first frame of a video clip rather than a photo.



You can select video clips for printing the same way that you select photos. For more information, see **select photos to print** on page 14. When you print a selected video clip, you get a video action print—9 frames from throughout the video clip printed on one page. You can change the default number of frames on your video action prints to 16 or 25 by changing the printer preferences. For more information, see **change printer preferences** on page 23.

Note: When you select a combination of photos and video clips for printing, the video action prints will print after the photos.

print camera-selected photos

Camera-selected photos are photos you marked for printing using your digital camera. When you select photos using your camera, the camera creates a Digital Print Order Format (DPOF) file that identifies which photos have been selected for printing.

Your printer can read the DPOF file from the memory card so you do not have to reselect the photos to print. Review the documentation that came with your digital camera to see if it supports camera-selected photos. Your printer supports DPOF file format 1.1.

Note: Not all digital cameras allow you to mark your photos for printing.

When you print camera-selected photos, the printer's control panel settings do not apply; the settings in the DPOF file for photo layout and number of copies override the printer's control panel.

To print camera-selected photos from a memory card:

- 1 Use your digital camera to select the photos you want to print. For more information, see the documentation that came with your camera.
- 2 Insert a memory card into the printer's memory card slot. For more information, see **insert a memory card** on page 12.

The printer automatically recognizes the camera-selected photos on the memory card and displays a message asking if you want to print them.

- 3 To print all camera-selected photos, press the **SELECT PHOTOS** ▾ button to highlight **Yes**, then press the **OK** button. To ignore the selections made with the camera, press the **SELECT PHOTOS** ▾ button to highlight **No**, then press the **OK** button.

- 4 After printing the camera-selected photos, the printer asks whether you want to unmark the camera-selected photos and delete the DPOF file. To unmark the photos, press the **SELECT PHOTOS** ▾ button to highlight **Yes**, then press the **OK** button. To keep your selections so you can print the same set of camera-selected photos again, press the **SELECT PHOTOS** ▾ button to highlight **No**, then press the **OK** button.

Note: Unmarking photos does not delete the photos from the memory card.

For information about changing the printer's default setting for unmarking camera-selected photos after printing, see **change printer preferences** on page 23.

If you have an HP direct-printing digital camera, you can also print camera-selected photos by connecting the camera directly to the printer. For more information, see the HP Photosmart Printer Help. For information about viewing the Printer Help, see **view the hp photosmart printer help** on page 1.

enhance your photos

The control panel on your printer is designed to make photo projects fun and easy. You can crop your photos, adjust the brightness of your photos, and add decorative frames and special color effects to your photos. The affordable projects you can create are endless—just use your imagination!

Note: All of the print settings described in this section are applied to individual photos and are discarded when you deselect the photo.

crop a photo

When you print from a memory card, you can use the printer's control panel to crop a photo so only your favorite portion of the photo prints.

- 1 Insert a memory card into the printer's memory card slot. For more information, see **insert a memory card** on page 12.
- 2 Press the **SELECT PHOTOS** ▲ or ▼ button to highlight the photo layout you want to print—1, 2, or 4 photos per page—then press the **OK** button.
- 3 When the first photo on the memory card appears on the printer's LCD screen, press the **SELECT PHOTOS** ◀ or ▶ button to navigate to the photo you want to crop. When the photo you want to crop appears on the printer's LCD screen, press the **OK** button to select it.
- 4 Press the **ZOOM +** button on the printer's control panel.

Four arrows on the printer's LCD screen blink briefly to indicate that you are entering Zoom mode. The print settings at the bottom of the display are replaced by the Zoom icon and magnification level.



Note: Make sure to press the **ZOOM +** button first. If you press the **ZOOM -** button first, the printer will exit Zoom mode and go to 9-up view mode. (In 9-up view mode, 9 photos appear on the printer's LCD screen at a time.) To return to Zoom mode for the selected photo, press the **ZOOM +** button twice.

- 5 Press the **ZOOM +** button to increase the magnification level by 0.25x. The maximum magnification level is 5.0x.

Note: The crop box changes from green to yellow if printing at the selected magnification noticeably reduces the print quality.

Note: If you increase the magnification beyond 3.0x, the photo will no longer be magnified on the printer's LCD screen. Instead, the crop box will shrink to indicate that a smaller portion of the photo is being selected.

Press the **ZOOM –** button to decrease the magnification level by 0.25x. The minimum magnification level is 1.0x.

Note: If you press the **ZOOM –** button when the magnification level is at 1.0x, the printer will exit Zoom mode and go to 9-up view mode. (In 9-up view mode, 9 photos appear on the printer's LCD screen at a time.) To return to Zoom mode for the selected photo, press the **ZOOM +** button twice.

- 6 At any magnification level, use the arrows on the **SELECT PHOTOS** button to move the crop box left, right, up, or down.
- 7 Press the **OK** button when the portion of the image you want to print is inside the crop box.
- 8 Press the **PRINT** button to begin printing.

adjust the photo brightness

When you print from a memory card, you can adjust the photo brightness to print your photos lighter or darker than the originals. The brightness setting ranges from –3 to +3. Normal brightness is 0.

- 1 Insert a memory card into the printer's memory card slot. For more information, see **insert a memory card** on page 12.
- 2 Press the **SELECT PHOTOS ▲** or **▼** button to highlight the photo layout you want to print—1, 2, or 4 photos per page—then press the **OK** button.
- 3 When the first photo on the memory card appears on the printer's LCD screen, press the **SELECT PHOTOS ◀** or **▶** button to navigate to the photo for which you want to adjust the photo brightness. Press the **OK** button.
- 4 Press the **MENU** button on the printer's control panel.
- 5 Press the **SELECT PHOTOS ▼** button until **Enhance image** is highlighted on the printer's LCD screen. Press the **OK** button.
- 6 Press the **SELECT PHOTOS ▼** button until **Photo brightness** is highlighted on the printer's LCD screen. Press the **OK** button.
- 7 Use the arrows on the **SELECT PHOTOS** button to adjust the photo brightness:
 - Press the **SELECT PHOTOS ▶** or **▲** button to increase the brightness.
 - Press the **SELECT PHOTOS ◀** or **▼** button to decrease the brightness.
- 8 Press the **OK** button when you are satisfied with the brightness.
- 9 Press the **PRINT** button to begin printing.

add frames to your photos

When you print from a memory card, you can select decorative borders in various patterns and colors and add them to print as frames around your photos.

- 1 Insert a memory card into the printer's memory card slot. For more information, see **insert a memory card** on page 12.
- 2 Press the **SELECT PHOTOS** ▲ or ▼ button to highlight the photo layout you want to print—1, 2, or 4 photos per page—then press the **OK** button.
- 3 When the first photo on the memory card appears on the printer's LCD screen, press the **SELECT PHOTOS** ◀ or ▶ button to navigate to the photo to which you want to add a frame. Press the **OK** button.
- 4 Press the **MENU** button on the printer's control panel.
- 5 Press the **SELECT PHOTOS** ▼ button until **Enhance image** is highlighted on the printer's LCD screen. Press the **OK** button.
- 6 Press the **SELECT PHOTOS** ▼ button until **Add frame** is highlighted on the printer's LCD screen. Press the **OK** button.
- 7 Use the arrows on the **SELECT PHOTOS** button to highlight the frame pattern you want to use, then press the **OK** button to select it.
- 8 Use the arrows on the **SELECT PHOTOS** button to highlight the frame color you want to use, then press the **OK** button to select it.

The printer displays the frame around the selected photo. If you cropped the photo before adding a frame, the frame automatically shrinks to fit around the cropped photo.

- 9 Press the **PRINT** button to begin printing.

change the photo color effect

When you print from a memory card, you can set the printer to change the color effect of your prints to black and white, sepia, or antique. Photos printed in sepia print in brown tones and look similar to photos produced in the early 1900s. Photos printed in antique print in the same brown tones as sepia but with some pale colors added to give the appearance that they are hand colored.

Note: These effects work best on photos taken in color using your digital camera.

- 1 Insert a memory card into the printer's memory card slot. For more information, see **insert a memory card** on page 12.
- 2 Press the **SELECT PHOTOS** ▲ or ▼ button to highlight the photo layout you want to print—1, 2, or 4 photos per page—then press the **OK** button.
- 3 When the first photo on the memory card appears on the printer's LCD screen, press the **SELECT PHOTOS** ◀ or ▶ button to navigate to the photo for which you want to change the photo color effect. Press the **OK** button.
- 4 Press the **MENU** button on the printer's control panel.
- 5 Press the **SELECT PHOTOS** ▼ button until **Enhance image** is highlighted on the printer's LCD screen. Press the **OK** button.

- 6 Press the **SELECT PHOTOS** ▼ button until **Add color effect** is highlighted on the printer's LCD screen. Press the **OK** button.
- 7 Press the **SELECT PHOTOS** ▼ button until the photo color effect you want to use is highlighted on the printer's LCD screen, then press the **OK** button to select it. You may choose from the following color effects:
 - Black & white
 - Sepia
 - Antique
 - No effect (default)

The printer displays the photo with the selected photo color effect applied.
- 8 Press the **PRINT** button to begin printing.

change printer preferences

You can change the printer's factory default settings to your own personal preferences using the printer menu on the printer's control panel. Printer preferences are global settings—they apply to every photo you print from the printer's control panel. You can change the default photo layout and default number of copies, set the printer to print borderless photos or photos with a white border, add date/time stamps to your photos, set the printer to automatically improve contrast and color saturation in your photos, and choose whether to adjust your photos using Exif Print information. A complete list of available printer preferences and their factory default settings can be found under **Preferences** in **printer menu structure** on page 6.

You can change the printer preferences by using the following general procedure:

- 1 Press the **MENU** button on the printer's control panel.
- 2 Press the **SELECT PHOTOS** ▼ button until **Preferences** is highlighted on the printer's LCD screen. Press the **OK** button.
- 3 Press the **SELECT PHOTOS** ▼ button until the printer preference you want to change is highlighted on the printer's LCD screen. Press the **OK** button.
- 4 Press the **SELECT PHOTOS** ▼ button until the desired setting is highlighted on the printer's LCD screen. Press the **OK** button.

For more information about printer preferences, see the HP Photosmart Printer Help. For information about viewing the Printer Help, see **view the hp photosmart printer help** on page 1.

solve printing problems

Your HP Photosmart printer is designed to be reliable and easy to use. For comprehensive troubleshooting information about printing photos, see the HP Photosmart Printer Help. For information about viewing the Printer Help, see **view the hp photosmart printer help** on page 1.

maintain your printer

Your HP Photosmart printer requires very little maintenance. For information about cleaning, maintaining, storing, and transporting your printer and supplies, see the HP Photosmart Printer Help. For information about viewing the Printer Help, see **view the hp photosmart printer help** on page 1.

clean the print cartridge

If you notice white lines or single-color streaks on your photos, the print cartridge may need to be cleaned.

- 1 Press the **MENU** button on the printer's control panel.
- 2 Press the **SELECT PHOTOS** ▾ button until **Tools** is highlighted on the printer's LCD screen. Press the **OK** button.
- 3 Press the **SELECT PHOTOS** ▾ button until **Clean cartridge** is highlighted on the printer's LCD screen. Press the **OK** button.
- 4 When the printer's LCD screen prompts you to load plain paper, load paper in the paper tray and press the **OK** button. To conserve photo paper, use plain paper or index cards. For more information, see **load paper** on page 8.

The message **CLEANING PRINT CARTRIDGE...** appears on the printer's LCD screen and the On/Attention light begins blinking. When the printer has finished cleaning the print cartridge, it prints a test page.

- 5 If the test page has streaks or missing colors, the print cartridge needs to be cleaned again. When the printer's LCD screen displays a message asking if you want to continue to a second level of cleaning, press the **SELECT PHOTOS** ▾ button to highlight **Yes** on the printer's LCD screen, then press the **OK** button. If the print quality of the test page looks good, press the **SELECT PHOTOS** ▾ button to highlight **No**, then press the **OK** button.

You can clean the cartridge up to three times. Each successive cleaning is more thorough and uses more ink.

This chapter provides answers to frequently asked questions about installing your HP Photosmart printer software on a Windows PC. For comprehensive troubleshooting information about all aspects of your printer, including error messages and Macintosh troubleshooting, see the HP Photosmart Printer Help. For information about viewing the Printer Help, see **view the hp photosmart printer help** on page 1.

Windows PC

Problem	Possible cause	Solution
When I connected the printer to my computer, the Found New Hardware Wizard opened but did not recognize the printer.	You connected the printer to your computer before inserting the HP Photosmart CD.	<ol style="list-style-type: none"> 1 Disconnect the USB cable from the printer. 2 Close the Found New Hardware Wizard. 3 Insert the HP Photosmart CD into your computer and install the printer software.
During installation, the system requirements dialog box appears, indicating that my computer monitor's display resolution does not meet the minimum system requirements.	Your monitor's display resolution is set below minimum system requirements. For more information, see system requirements on page 30.	<ol style="list-style-type: none"> 1 Click Cancel in the system requirements dialog box. 2 Right-click on the Desktop and select Properties. 3 Click the Settings tab. 4 Move the slider to the right until the resolution is 800 x 600 or higher. 5 Click OK. A Monitor Settings message appears. 6 Click Yes to accept the changes. 7 Reinstall the printer software.
The software did not install correctly on my computer. OR I need to reinstall the printer software.	There may be a conflict with your virus protection program. OR There may be a conflict with another software program.	<ol style="list-style-type: none"> 1 Uninstall the printer software. To do this, insert the HP Photosmart CD into your computer, click Uninstall, then follow the instructions on your computer screen. 2 When the uninstall is complete, restart your computer. 3 Pause or disable any active virus protection programs. 4 Reinstall the printer software.

Problem	Possible cause	Solution
<p>Windows 98 only When I connect a USB cable between the printer and my computer, the Add New Hardware Wizard appears once, but the printer driver does not install completely. The Add New Hardware Wizard does not appear again.</p>	<p>Installation was cancelled, was not completed, or there was an error.</p>	<ol style="list-style-type: none"> 1 Turn off the printer and disconnect the USB cable from the printer. 2 Unplug the power cord from the printer. 3 Wait about 10 seconds. 4 Plug the power cord into the printer and turn on the printer. 5 Uninstall the printer software. To do this, insert the HP Photosmart CD into your computer, then follow the instructions on your computer screen. 6 When the uninstall is complete, restart your computer. 7 Reinstall the printer software.
<p>Windows 98 only When I connect a USB cable between the printer and my computer, the Add New Hardware Wizard does not appear.</p>	<p>Your USB cable may not be working or may not be connected properly.</p>	<ol style="list-style-type: none"> 1 Turn off the printer and disconnect the USB cable from the printer. 2 Unplug the power cord from the printer. 3 Wait about 10 seconds. 4 Plug the power cord into the printer and turn on the printer. 5 Reconnect the USB cable to the printer. If you are still having problems, try using another USB cable. <p>OR</p> <ol style="list-style-type: none"> 1 Click Start, Settings, Control Panel. 2 Double-click the System icon. 3 Click the Device Manager tab. 4 Click the (+) icon next to the Universal Serial Bus controllers option. If you see a USB host controller and a USB root hub listed, USB is probably enabled. If you do not see these devices listed, refer to your computer's documentation or contact the computer manufacturer for more information about enabling and setting up USB.

This chapter contains the following information about your HP Photosmart printer:

- **support** on page 27
- **specifications** on page 30
- **hardware services** on page 32
- **software services** on page 33
- **limited warranty statement** on page 33
- **regulatory notices** on page 35
- **environmental statements** on page 35
- **copyrights and trademarks** on page 36

Note: For a complete list of printer specifications and system requirements, see the HP Photosmart Printer Help. For information about viewing the Printer Help, see **view the hp photosmart printer help** on page 1.

support

If you have a problem, follow the steps below:

- 1 Go to the HP Photosmart Printer Help for detailed information about how to use your printer and troubleshoot problems. For information about viewing the HP Photosmart Printer Help, see **view the hp photosmart printer help** on page 1.
- 2 If you are unable to solve the problem using the information in the HP Photosmart Printer Help:
 - Go to **www.hp.com/support** to access online support pages or send HP an E-mail message for one-on-one answers to your questions.
 - Go to **www.hp.com** to check for software updates.

Web and E-mail support are available in the following languages:

- Dutch
- English
- French
- German
- Italian
- Portuguese
- Spanish
- Swedish

- 3 If you are unable to solve the problem using the HP Photosmart Printer Help or HP Web sites, call HP support using the number for your country or region. For a list of country and region phone numbers, see **hp support by phone** on page 28.

If you are experiencing printer hardware failure, take the printer to your local HP dealer (or wherever you purchased the printer) for service. Service is free during your printer's limited warranty period. After the limited warranty period, service charges will apply. For more information, see **limited warranty statement** on page 33.

hp support by phone

Your printer comes with a limited time of free support. For more information, see **limited warranty statement** on page 33, or go to www.hp.com/support to check the duration of your free support.

After the free phone support period, help is available from HP at an additional cost. Contact your HP dealer or call the support phone number for your country or region for support options.

To receive HP support by phone, call the appropriate support phone number for your location. Standard phone company charges apply.

Note: Customers in Western Europe should go to www.hp.com/support to access phone support numbers in their country or region.

Country	Phone number
Algeria	(+212) 22404747
Bahrain	800 728
Czech Republic	42 (0)2 6130 7310
Egypt	02 532 5222
Greece	+ 30 1 60 73 603
Hungary	+ 36 (0)1 382 1111
Israel	972 (0) 9 830 4848
Morocco	(+212) 22404747
Poland	+ 48 22 865 98 00
Romania	01 315 44 42
Russia, Moscow	7 095 923 50 01
Russia, St. Petersburg	7 812 346 7997

Country	Phone number
Saudi Arabia	800 897 14440
Slovakia	+ 421-2-68208080
South Africa	086 000 1030 inside RSA + 27-11 258 9301 outside RSA
Tunisia	+ 216 1 891 222
Turkey	1 216 579 71 71
Ukraine	+ 7 (380-44) 490-3520
United Arab Emirates	971 4 883 8454

place a call

Call HP support while you are near the computer and printer. Be prepared to provide the following information:

- Printer model number (located on the front of the printer).
- Printer serial number (located on the bottom of the printer).
- Computer operating system.
- Version of printer driver:
 - **Windows PC** — To see the printer driver version, right-click the memory card icon in the Windows taskbar and select **About**.
 - **Macintosh** — To see the printer driver version, use the Print dialog box.
- Messages displayed on the printer's LCD screen or on the computer's monitor.
- Answers to the following questions:
 - Has the situation you are calling about happened before? Can you recreate the situation?
 - Did you install any new hardware or software on your computer around the time that the situation occurred?

specifications

This section lists the minimum system requirements for installation of the HP Photosmart printer software and provides selected printer specifications.

Note: For a complete list of printer specifications, see the HP Photosmart Printer Help. For information about viewing the Printer Help, see **view the hp photosmart printer help** on page 1.

system requirements

Component	Windows PC minimum	Macintosh minimum
Operating system	Microsoft® Windows® 98, 2000 Professional, ME, XP Home, and XP Professional	Mac® OS 9 v9.1 or later, OS X v10.1 through v10.2
Processor	Intel® Pentium® II (or equivalent) or higher	G3 or greater
RAM	64 MB (128 MB recommended)	Mac OS 9.1 and OS 9.2: 64 MB RAM (128 MB recommended) Mac OS X v10.1 and OS X v10.2: 128 MB RAM
Free disk space	500 MB	500 MB
Video display	800 x 600, 16-bit or higher	800 x 600, 16-bit or higher
CD-ROM drive	4x	4x
Connectivity	USB: Microsoft Windows 98, 2000 Professional, ME, XP Home, and XP Professional	USB: Mac OS 9 v9.1 or later, OS X v10.1 through v10.2
Browser	Microsoft Internet Explorer 5.5 or higher	Not required for installation

printer specifications

Connectivity	USB: Microsoft Windows 98, 2000 Professional, ME, XP Home, and XP Professional; Mac OS 9 v9.1 or later, OS X v10.1 through v10.2
Image file formats	JPEG Baseline TIFF 24-bit RGB uncompressed interleaved TIFF 24-bit YCbCr uncompressed interleaved TIFF 24-bit RGB packbits interleaved TIFF 8-bit gray uncompressed/packbits TIFF 8-bit palette color uncompressed/packbits TIFF 1-bit uncompressed/packbits/1D Huffman
Margins	Borderless printing: <ul style="list-style-type: none"> • Top 0.0 inch (0.0 mm) • Bottom 0.50 inch (12.5 mm) • Left/Right 0.0 inch (0.0 mm) Bordered printing: <ul style="list-style-type: none"> • Top 0.16 inch (4 mm) • Bottom 0.50 to 0.66 inch (12.5 to 16.8 mm) • Left/Right 0.16 inch (4 mm)
Media sizes	Photo paper (4 x 6 inches, 10 x 15 cm) Photo paper with tab (4 x 6 inches with 0.5 inch tab, 10 x 15 cm with 1.25 cm tab) Index cards (4 x 6 inches, 10 x 15 cm) Hagaki cards (4 x 5.5 inches, 100 x 140 mm) A6 cards (4.13 x 5.8 inches, 105 x 148 mm) L-size cards (3.5 x 5 inches, 90 x 127 mm) L-size cards with tab (3.5 x 5 inches with 0.5 inch tab, 90 x 127 mm with 12.5 mm tab)
Media types	Paper (plain, photo) Cards (index, Hagaki, A6, L-size)
Memory cards	CompactFlash™ type I and II MultiMediaCard™ Secure Digital™ SmartMedia™ Sony® Memory Sticks xD-Picture Card™

Memory card-supported file formats	Printing: Supported image and video file formats Saving: All file formats
Operating temperature	32 – 113 °F (0 – 45 °C) [Optimum 59 – 95 °F (15 – 35 °C)]
Paper tray	One 4 x 6 inch (10 x 15 cm) photo paper tray
Paper tray capacity	20 sheets, maximum thickness 11.5 mil (292 μm) per sheet
Power consumption	Printing: 8.1 W Idle: 2.1 W Off: 2.0 W
Print cartridge	1 tri-color HP #57 (C6657A) OR 1 photo gray HP #59 (C9359A) (available Fall 2003)
USB support	Microsoft Windows 98, 2000 Professional, ME, XP Home, and XP Professional; Mac OS 9 v9.1 or later, OS X v10.1 through v10.2 HP recommends that the USB cable be less than 10 feet (3 meters) in length
Video file formats	Motion JPEG AVI Motion JPEG Quicktime MPEG-1

hardware services

If you think your printer needs service, call HP support to help you determine if service is required. HP support will direct you to a service site if necessary. For more information, see **support** on page 27. Otherwise, contact the store where you purchased your printer. Or, go to www.hp.com/cpso-support/guide/psd/repairhelp.html for the nearest sales and service office.

Service is free of charge during the warranty period. Beyond the warranty period, a service fee will be charged.

software services

software updates

HP periodically provides updates to the printer software. You can download these updates by going to www.hp.com/support or by using the software that came with your printer. Updates for the HP Photo & Imaging software are available on CD only.

To receive printer software updates using the software that came with your printer, follow these steps:

- **Windows PC** — From the **Start** menu, select **Programs** (in Windows XP, select **All Programs**); **Hewlett-Packard**; **HP Software Update**.
- **Macintosh** — From the HP Inkjet Utility, select **Support** from the pop-up menu, then click **Support**.

software distribution centers

You can also contact HP directly to order software updates on CD, including the HP Photo & Imaging software. For contact information, see the Web site: www.hp.com/cpso-support/guide/psd/fulfilinfo.html

limited warranty statement

Region	Europe, Middle East, Africa
Software warranty	90 days
Printer warranty	1 year

A. Extent of Limited Warranty

- 1 Hewlett-Packard (HP) warrants to the end-user customer that the HP products specified above will be free from defects in material and workmanship for the duration specified above, which duration begins on the date of purchase by the customer.
- 2 For software products, HP's limited warranty applies only to a failure to execute programming instructions. HP does not warrant that the operation of any product will be uninterrupted or error free.
- 3 HP's limited warranty covers only those defects which arise as a result of normal use of the product, and does not cover any other problems, including those which arise as a result of:
 - Improper maintenance or modification;
 - Software, media, parts, or supplies not provided or supported by HP; or
 - Operation outside the product's specifications.
- 4 For HP printer products, the use of a non-HP ink cartridge or a refilled ink cartridge does not affect either the warranty to the customer or any HP support contract with the customer. However, if printer failure or damage is attributable to the use of a non-HP or refilled ink cartridge, HP will charge its standard time and materials charges to service the printer for the particular failure or damage.
- 5 If HP receives, during the applicable warranty period, notice of a defect in any product which is covered by HP's warranty, HP shall either repair or replace the defective product, at HP's option.
- 6 If HP is unable to repair or replace, as applicable, a defective product which is covered by HP's warranty, HP shall, within a reasonable time after being notified of the defect, refund the purchase price for the product.
- 7 HP shall have no obligation to repair, replace, or refund until the customer returns the defective product to HP.
- 8 Any replacement product may be either new or like-new, provided that it has functionality at least equal to that of the product being replaced.
- 9 HP products may contain remanufactured parts, components, or materials equivalent to new in performance.

- 10** HP's limited warranty is valid in any country or region where the covered HP product is distributed by HP. Contracts for additional warranty services, such as on-site service, are available from any authorized HP service facility in countries or regions where the product is distributed by HP or by an authorized importer. For phone support in Europe please check for the details and conditions of phone support in your country or region by consulting the following Web site: <http://www.hp.com/support>. Alternatively, you can ask your dealer or call HP at the phone number indicated in this booklet. As part of our constant efforts to improve our phone support service, we advise you to check our Web site on a regular basis for new information regarding service features and delivery.

B. Limitations of Warranty

TO THE EXTENT ALLOWED BY LOCAL LAW, NEITHER HP NOR ITS THIRD PARTY SUPPLIERS MAKE ANY OTHER WARRANTY OR CONDITION OF ANY KIND, WHETHER EXPRESS OR IMPLIED, WITH RESPECT TO THE HP PRODUCTS, AND SPECIFICALLY DISCLAIM THE IMPLIED WARRANTIES OR CONDITIONS OF MERCHANTABILITY, SATISFACTORY QUALITY, AND FITNESS FOR A PARTICULAR PURPOSE.

C. Limitations of Liability

- 1** To the extent allowed by local law, the remedies provided in this Warranty Statement are the customer's sole and exclusive remedies.
- 2** TO THE EXTENT ALLOWED BY LOCAL LAW, EXCEPT FOR THE OBLIGATIONS SPECIFICALLY SET FORTH IN THIS WARRANTY STATEMENT, IN NO EVENT SHALL HP OR ITS THIRD PARTY SUPPLIERS BE LIABLE FOR DIRECT, INDIRECT, SPECIAL, INCIDENTAL, OR CONSEQUENTIAL DAMAGES, WHETHER BASED ON CONTRACT, TORT, OR ANY OTHER LEGAL THEORY AND WHETHER ADVISED OF THE POSSIBILITY OF SUCH DAMAGES.

D. Local Law

- 1** This Warranty Statement gives the customer specific legal rights. The customer may also have other rights which vary from state to state in the United States, from province to province in Canada, and from country to country or region to region elsewhere in the world.
- 2** To the extent that this Warranty Statement is inconsistent with local law, this Warranty Statement shall be deemed modified to be consistent with such local law. Under such local law, certain disclaimers and limitations of this Warranty Statement may not apply to the customer. For example, some states in the United States, as well as some governments outside the United States (including provinces in Canada), may:
 - Preclude the disclaimers and limitations in this Warranty Statement from limiting the statutory rights of a consumer (e.g. the United Kingdom);
 - Otherwise restrict the ability of a manufacturer to enforce such disclaimers or limitations; or
 - Grant the customer additional warranty rights, specify the duration of implied warranties which the manufacturer cannot disclaim, or not allow limitations on the duration of implied warranties.
- 3** FOR CONSUMER TRANSACTIONS IN AUSTRALIA AND NEW ZEALAND, THE TERMS IN THIS WARRANTY STATEMENT, EXCEPT TO THE EXTENT LAWFULLY PERMITTED, DO NOT EXCLUDE, RESTRICT, OR MODIFY, AND ARE IN ADDITION TO, THE MANDATORY STATUTORY RIGHTS APPLICABLE TO THE SALE OF THE HP PRODUCTS TO SUCH CUSTOMERS.

regulatory notices

For regulatory identification purposes, your product is assigned a Regulatory Model Number. The Regulatory Model Number for your product is SDGOA-0324. This regulatory number should not be confused with the marketing name (hp photosmart 240 series printer) or product number (Q3046A).

environmental statements

protecting the environment

Hewlett-Packard Company is committed to providing quality products in an environmentally sound manner.

This printer has been designed with several attributes to minimize impact on our environment. Please go to HP's Commitment to the Environment Web site at <http://www.hp.com/hpinfo/globalcitizenship/environment/index.html> for more information.

plastics

Plastic parts over 0.88 ounces (25 grams) are marked according to international standards that enhance the ability to identify plastics for recycling purposes at the end of the printer's life.

material safety data sheets

Material Safety Data Sheets (MSDS) can be obtained from the HP Web site at <http://www.hp.com/go/msds>. Customers without Internet access should contact HP support.

recycling program

HP offers an increasing number of product return and recycling programs in many countries, as well as partners with some of the largest electronic recycling centers throughout the world. HP conserves resources by reselling some of its most popular products.

This HP product contains lead in the solder, which may require special handling at the end of its life.

copyrights and trademarks

© Copyright 2003 Hewlett-Packard Company

All rights are reserved. No part of this document may be photocopied, reproduced, or translated to another language without the prior written consent of Hewlett-Packard Company.

The information contained in this document is subject to change without notice. Hewlett-Packard shall not be liable for errors contained herein or for consequential damages in connection with the furnishing, performance, or use of this material.

HP, the HP logo, and Photosmart are property of Hewlett-Packard Company.

The Secure Digital logo is a trademark of the SD Association.

Microsoft and Windows are registered trademarks of Microsoft Corporation.

CompactFlash, CF, and the CF logo are trademarks of the CompactFlash Association (CFA).

Sony Memory Stick is a registered trademark of Sony Corporation.

MultiMediaCard is a trademark of Infineon Technologies AG of Germany, and is licensed to the MMCA (MultiMediaCard Association).

SmartMedia is a trademark of Toshiba Corporation.

Mac, the Mac logo, and Macintosh are registered trademarks of Apple Computer, Inc.

Pentium is a registered trademark of Intel Corporation.

Other brands and their products are trademarks or registered trademarks of their respective holders.

The embedded software in your printer is based in part on the work of the Independent JPEG Group.

The copyrights to certain photos within this document are retained by the original owners.



Printed on recycled paper
Printed in U.S., 5/03

Printed on recycled paper
Printed in U.S., 5/03

Printed on recycled paper
Printed in U.S., 5/03



ENERGY STAR® is a U.S. registered mark.
As an ENERGY STAR® partner,
Hewlett-Packard Company has determined that
this product meets the ENERGY STAR® guidelines
for energy efficiency.

ENERGY STAR® is a U.S. registered mark.
As an ENERGY STAR® partner,
Hewlett-Packard Company has determined that
this product meets the ENERGY STAR® guidelines
for energy efficiency.

ENERGY STAR® is a U.S. registered mark.
As an ENERGY STAR® partner,
Hewlett-Packard Company has determined that
this product meets the ENERGY STAR® guidelines
for energy efficiency.



www.hp.com

©2003 Hewlett-Packard Company



i n v e n t



Q3046-90191

v1.0.0