

# Start Here



## Thank you for purchasing an HP PL4245N 42" Plasma HDTV

Your setup time may vary.

- Identify the type of connectors your home entertainment equipment uses, then go to the corresponding step on this poster and follow those directions. (Example: To connect a cable or satellite set-top box which connects via S-video cabling, refer to step 7, "Connect an S-video device.")
- Refer to the user documentation for advanced connections.
- Apply power to all components and then to the TV.
- Finally, refer to the section titled "Setting Up Your Channels" in your user documentation to finalize your TV setup.

### Contents

- HP plasma TV
- TV stand
- Speakerbars (2)
- Documentation kit
- Remote control with AA batteries (2)
- Speaker cables (2)
- Antenna cable
- AC power cable

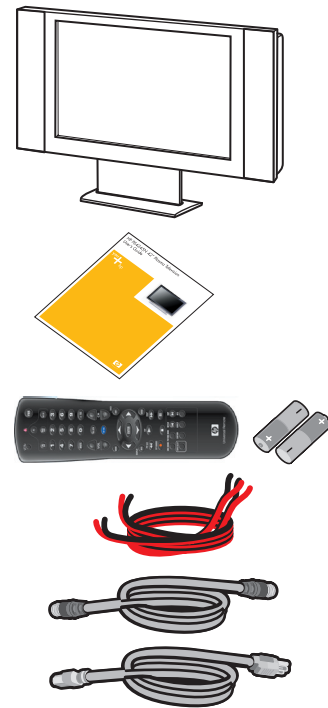

The information in this document is subject to change without notice.

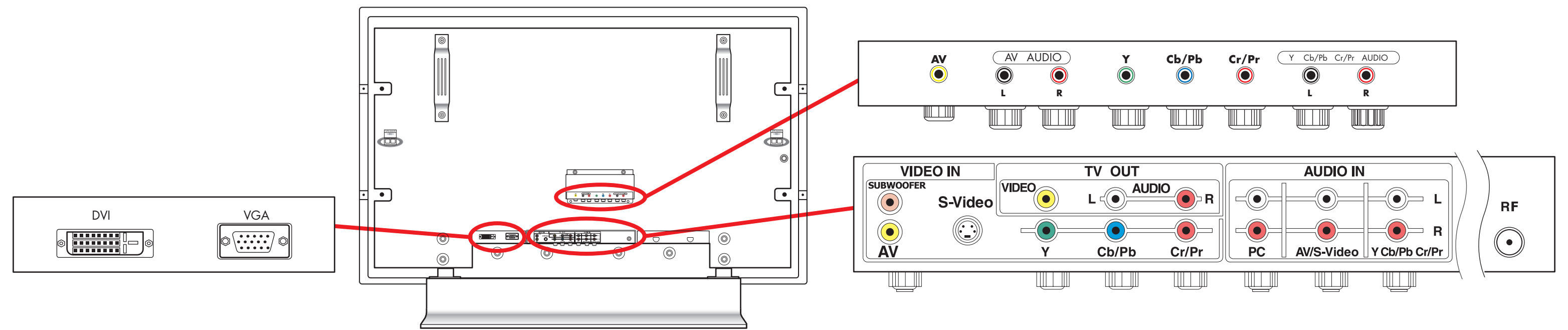

Connectors are located on the back of the TV, under the back panel.

### 1 Attach Brackets to Speakers

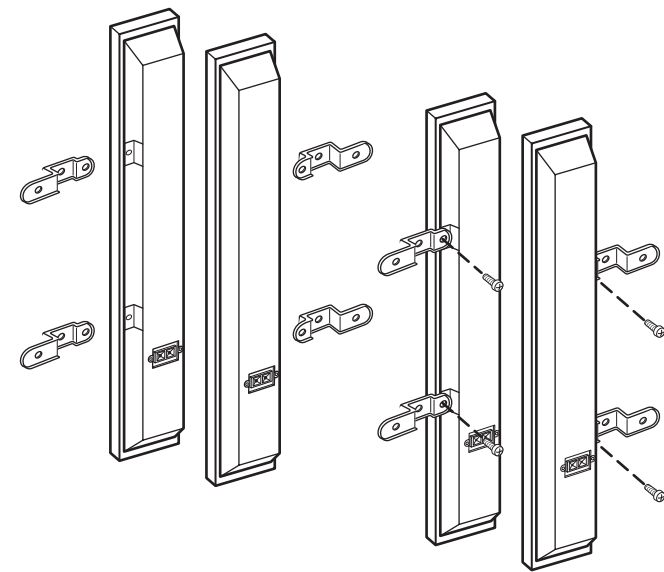

### 2 Attach Speakers to TV

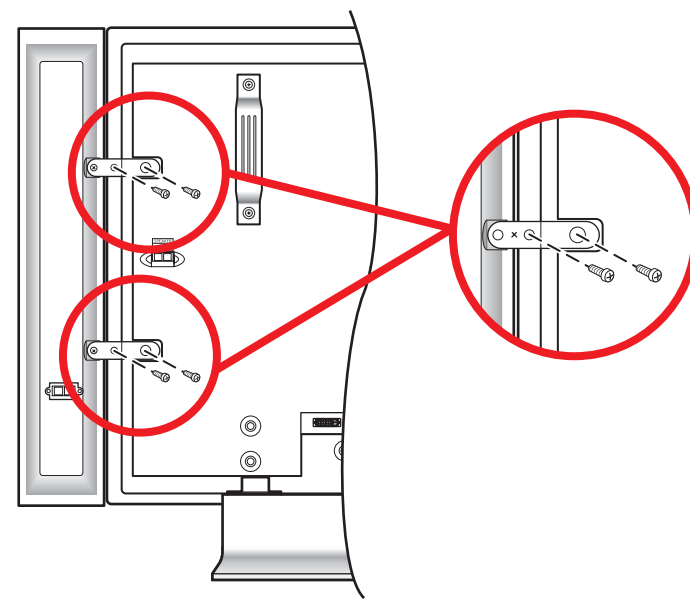

### 3 Connect Speaker Cables to TV

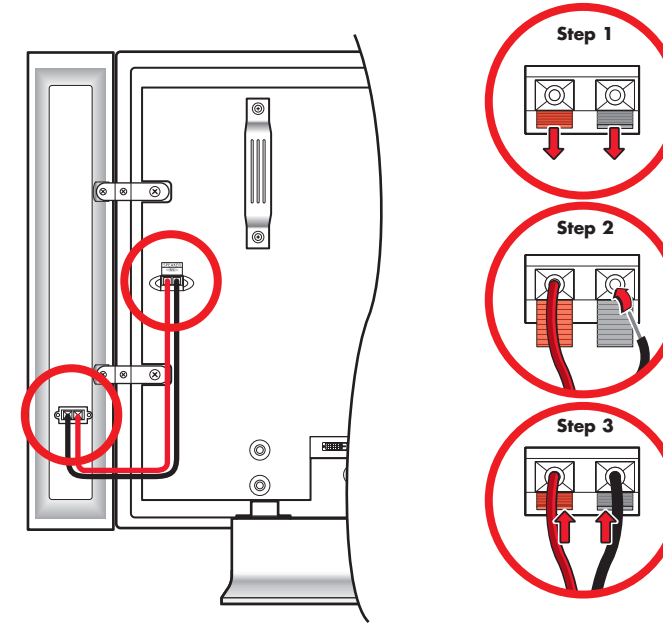

### 4 Connect Subwoofer (optional)

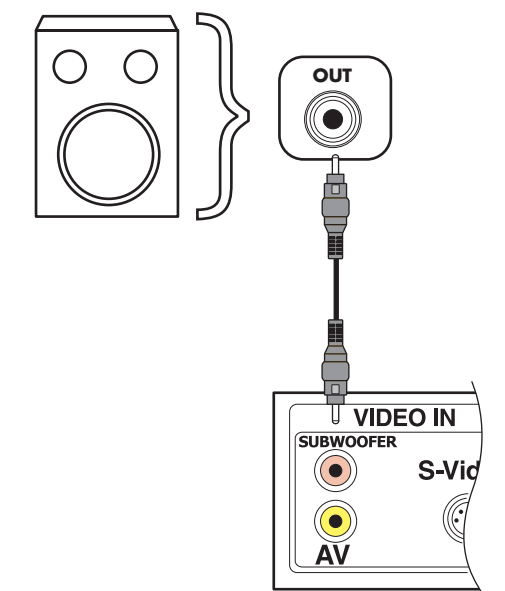

### 5 Connect a PC or an HP HD Tuner by DVI

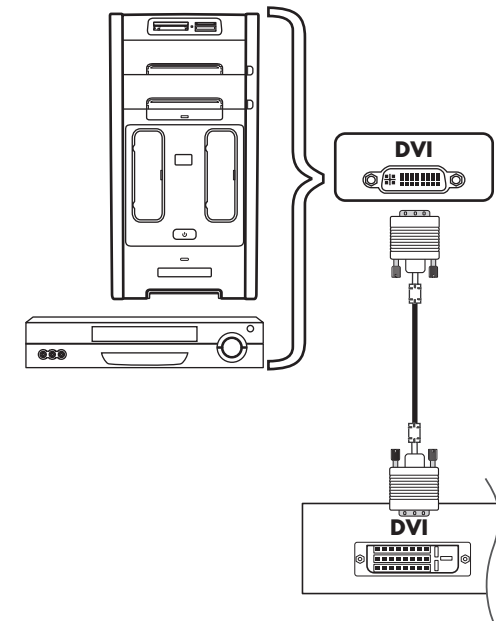

### 6 Connect a Component (YPbPr) Device

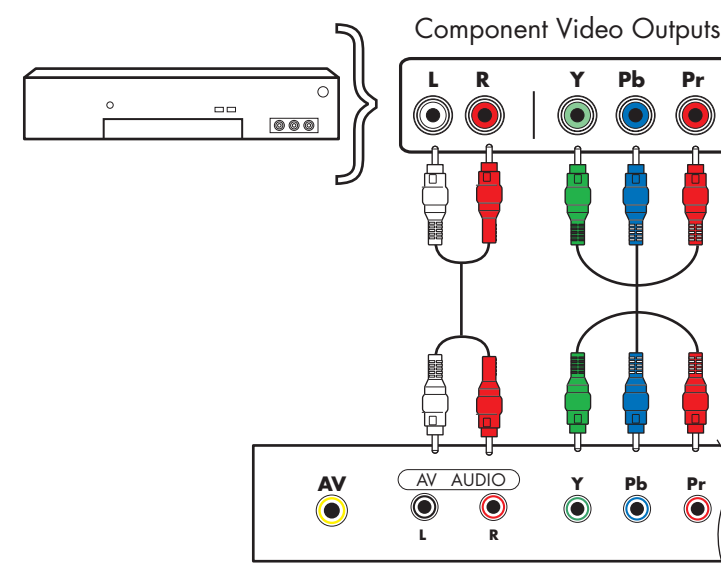

### 7 Connect an S-video Device

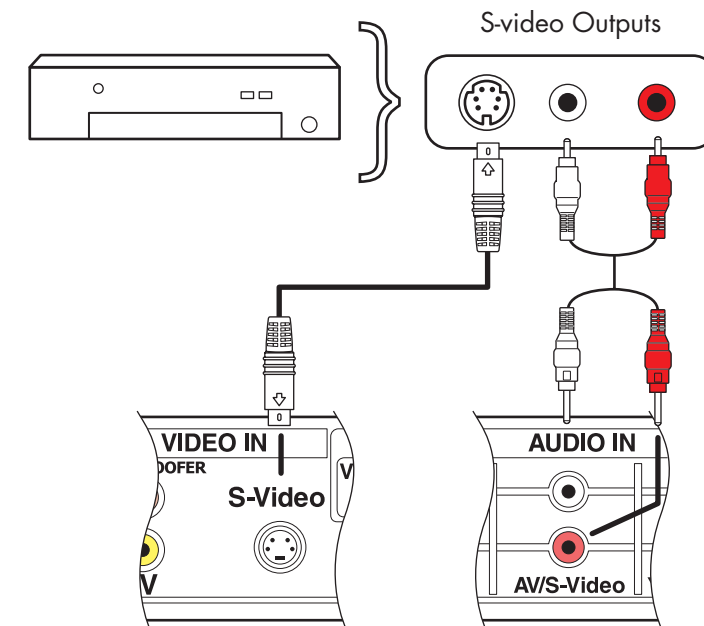

### 8 Connect a Composite Device

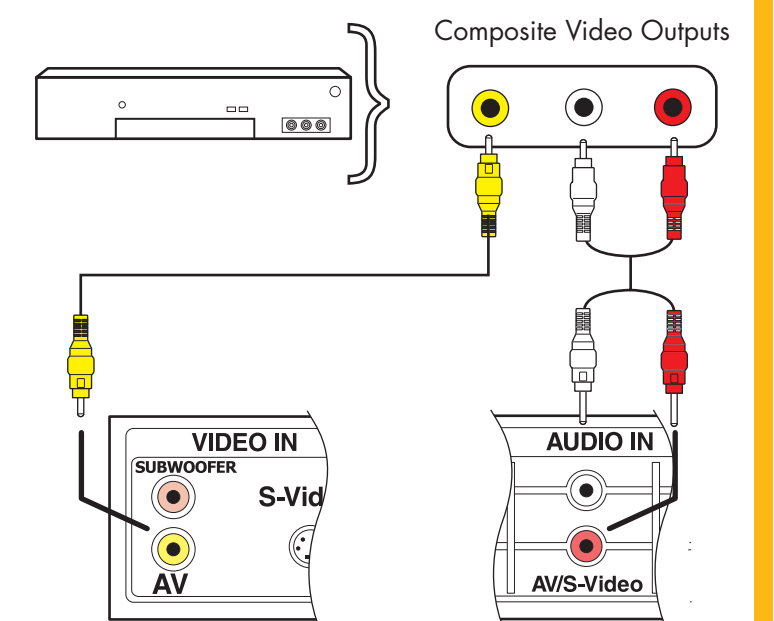

### 9 Analog Video from PC

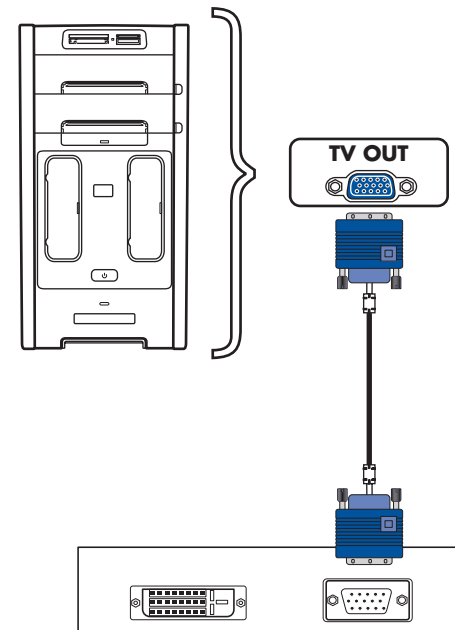

### 10 Outdoor Antenna Connection

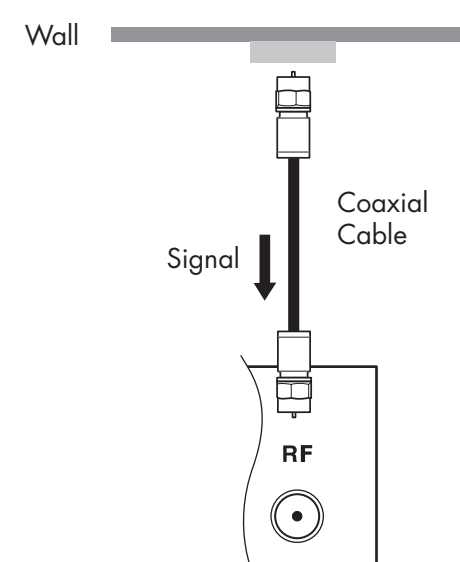

### 11 Remote Control

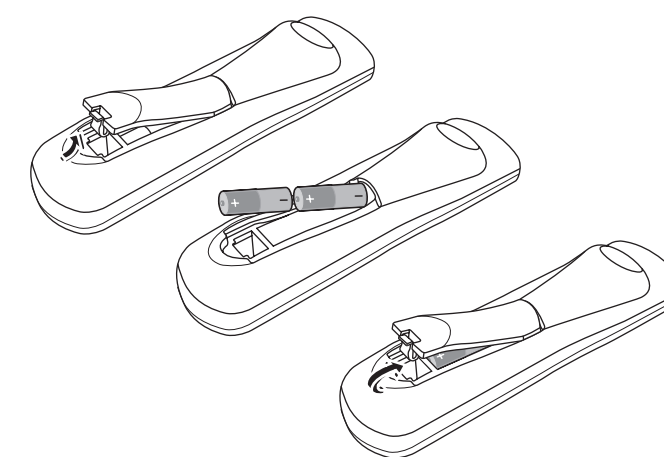

### 12 Power On

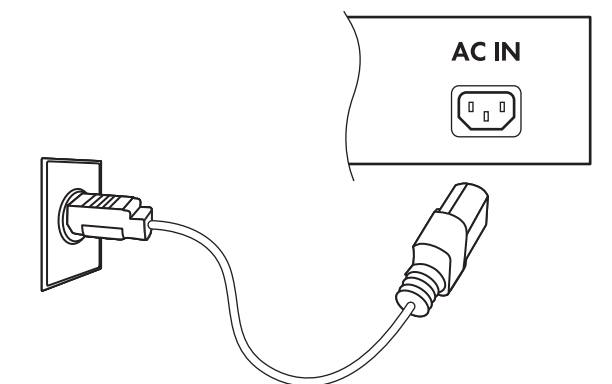

Once the power cable is connected, power on TV by pressing PWR on the remote control.  
Refer to the section in the user documentation titled "Setting Up Your Channels" to complete TV setup.  
Refer to the user documentation for advanced connections.



© 2004 Hewlett-Packard Development Company, L.P.  
Printed in  
www.hp.com

