

HP Compaq dx6120 Business PC Series - EMEA only

Illustrated Parts Map
Microtower

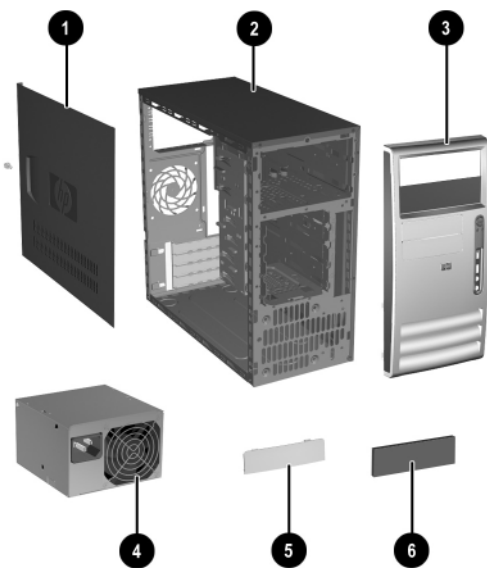

System Unit		
1	Access panel	395969-001
2	Chassis	not spared
3	Front bezel with 5.25" ODD bezel blank and lower 3.5" bezel blank, painted	368085-001
4	Power supply, PFC, 300W, ATX	405872-001
5	3.5" bezel blank, top bay, painted	335938-005
6	5.25" bezel blank, carbonite	335937-005

Mass Storage Devices (not illustrated)	
40 GB/7200 RPM SATA hard drive	365555-001
80 GB/7200 RPM SATA hard drive	345713-005
160 GB/7200 RPM SATA hard drive	345712-005
250GB/7200 RPM SATA hard drive	393303-001
48X CD-ROM drive with mounting screws	397130-001
48X/32X/48X +16X DVD/CD-RW drive	405425-001
16X DVD+R/RW drive	405760-001
16/48X DVD ROM drive	405761-001

© 2006 Hewlett-Packard Development Company, L.P.
HP and the HP logo are trademarks of Hewlett-Packard Development Company, L.P.
All other product names mentioned herein may be trademarks of their respective companies.

HP shall not be liable for technical or editorial errors or omissions contained herein. The information in this document is provided "as is" without warranty of any kind and is subject to change without notice. The warranties for HP products are set forth in the express limited warranty statements accompanying such products. **Nothing herein should be construed as constituting an additional warranty.**

3rd Edition, June 2006
1st Edition, January 2005

Document Number
376217-003

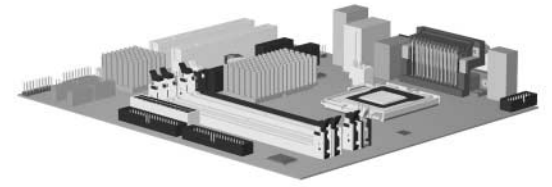

Standard and Optional Boards		
1	System board with alcohol pad and thermal grease	419303-001
Memory Modules		
*	256 MB/533 MHz FSB, DDR2, PC2-4200	393392-001
*	512 MB/533 MHz FSB, DDR2, PC2-4200	393393-001
Intel Celeron D Processors with thermal grease and alcohol pad		
*	2.8 GHz/533 MHz FSB, 256 KB cache	391941-001
*	3.06 GHz/533 MHz FSB, 256 KB cache	405693-001
*	3.2 GHz/533 MHz FSB, 256 KB cache	382503-001
Intel Pentium 4 Processors with thermal grease and alcohol pad		
*	2.8 GHz/800 MHz FSB, 1 MB cache	394643-001
*	3.0 GHz/800 MHz FSB, 2 MB cache	419651-001
*	3.06 GHz/533 MHz FSB, 1 MB cache	412985-001
*	3.2 GHz/800 MHz FSB, 2 MB cache	384786-005
*	3.4 GHz/800 MHz FSB, 2 MB cache	384787-005
Other Cards		
*	PCI Modem, ATX	398661-001
*	Intel Gigabit NIC	398332-001
Graphics Solution		
*	ATI RV515 VGA graphics, 256M, ATX bracket	413023-001

FH = Full Height mounting bracket
* Not shown

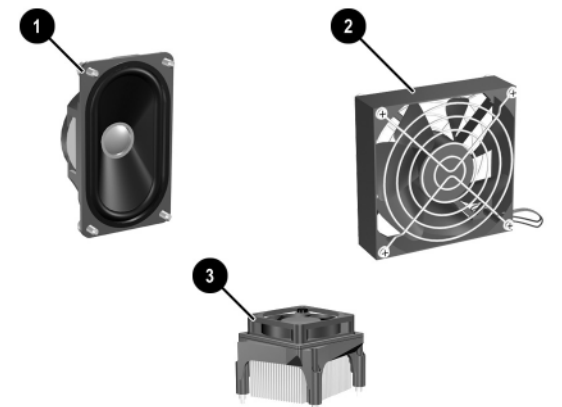

Miscellaneous Parts			
1	Speaker	399871-001	
2	Chassis fan	392412-001	
3	Heatsink with fan, alcohol pad, and thermal grease	418841-001	
*	Real-time clock battery	153099-001	
*	Rubber foot (4 ea)	370708-001	
*	Media card reader, 3.5-inch	407187-001	
Mouse			
*	2-Button, PS/2, with scroll wheel	390937-001	
*	2-Button, USB, optical with scroll wheel	390938-001	
*	2-Button, PS/2, optical with scroll wheel	417966-001	
Miscellaneous screw kit, includes:			
*	M3 x 5mm hi top, taptite, (4 ea) (247348-001)		
*	#6-32 x 1/4 Hi top, taptite, T15 (4 ea) (192308-001)		
*	#6-32 x 5/16 Hi top, taptite, T15 (2 ea) (192308-002)		
*	#6-32 x 3/16 Hi top, taptite, T15 (4 ea) (192308-003)		
*	Countersunk, flat head plastite (4 ea) (247481-001)		
*	Thumbscrew (1 ea) (368224-002)		
Modem Cable Adapters (not illustrated) (use with 198220-005)			
Belgium	316904-181	Italy	316904-065
Cameroon	316904-AR1	Macedonia	419652-001
Czech	234963-225	Netherlands	316920-335
Germany	316904-045	Poland/Russia	316904-241
Greece	316904-151	Scandinavia	382848-DH1
France	316904-051	Switzerland	304398-115
Hungary	234963-215	Turkey	316904-141
Israel	316904-BB1	U.K.	158593-035

*Not shown

Cables		
1	SATA hard drive cable, 13-inch	391738-001
2	IDE UATA dual device, Optical Disk Drive data cable, 14-inch	395964-001
3	RJ-11 telephone cable	198220-005
4	Power/LED cable with switch and switch holder	395965-001
*	USB+audio front I/O panel cable	395966-001

*Not shown

Keyboard (not illustrated)			
PS/2, Basic		382925-xxx	
USB, Basic		382926-xxx	
PS/2, Basic[1]		396215-xxx	
USB, Basic[1]		396217-xxx	
Belgian	-181	International	-B31
BHCSY	-B41	Italian	-061
Czech	-221	Norwegian	-091
Danish	-081	Portuguese	-131
Finnish	-351	Romanian	-271
French	-051	Slovakian	-231
French Arabic	-DE1	Spanish	-071
German	-041	Swedish	-101
Greek[1]	-151	Swiss	-111
Hebrew	-BB1	Turkish	-141
Hungarian	-211	U.K.	-031

[1] 396215, 396217 - Greek (-151) only

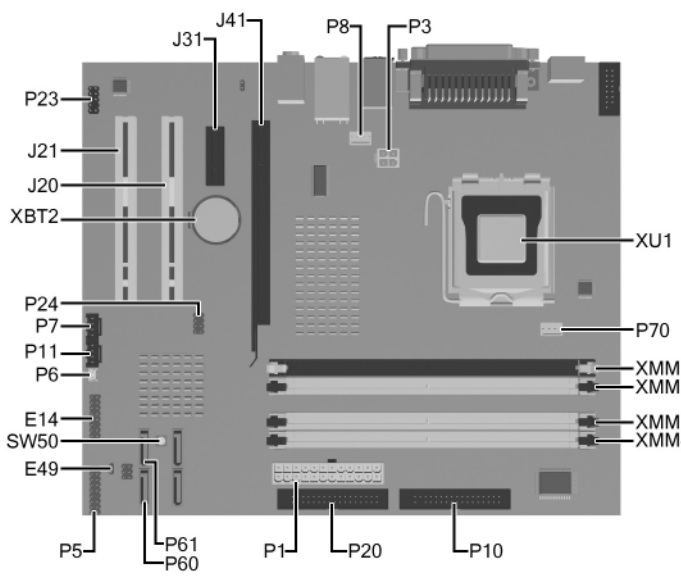

System Board Connectors and Jumpers (position of some untitled components may vary in location)

E49	Password jumper	P20	Primary IDE
J20	PCI slot 1	P23	Front audio/USB
J21	PCI slot 2	P24	Front USB header
J31	PCI Express x1	P60	Primary Serial ATA (SATA) connector
J41	PCI Express x16	P61	Second Serial ATA (SATA) connector
P1	Main power (20 pin)	P70	CPU fan
P3	VCCP 12 volt header	SW50	CMOS button
P5	Front power button, LED header	XBT2	Battery
P6	Internal chassis speaker	XMM1	Memory socket
P7	CD audio in	XMM2	Memory socket
P8	Chassis fan	XMM3	Memory socket
P10	Diskette drive	XMM4	Memory socket
P11	Aux audio in	XU1	Processor socket
E14	Boot Block		

System Hardware Interrupts

IRQ	System Function	IRQ	System Function
0	Timer Interrupt	8	Real-Time Clock
1	Keyboard	9	Unused
2	Interrupt Controller Cascade	10	Unused, available for PCI
3	Serial Port (COM B)	11	Unused, available for PCI
4	Serial Port (COM A)	12	Mouse
5	Unused, available for PCI	13	Coprocessor
6	Diskette Drive	14	Primary ATA (IDE) Controller
7	Parallel Port (LPT 1)		

Computer Diagnostic LEDs (on front of computer)

LED	Color	LED/Beep Activity	State/Message
Power	Green	On	(S0) Computer on
Power	Green	1 blink every 2 seconds	(S1) Suspend Mode
Power	Red*	2 blinks and beeps 1 second apart	CPU thermal shutdown
Power	Red*	3 blinks and beeps 1 second apart	CPU not installed
Power	Red*	4 blinks and beeps 1 second apart	Power supply failure
Power	Red*	5 blinks and beeps 1 second apart	Pre-video memory error
Power	Red*	6 blinks and beeps 1 second apart	Pre-video graphics adapter error
Power	Red*	7 blinks and beeps 1 second apart	System board failure
Power	Red*	8 blinks and beeps 1 second apart	Invalid ROM checksum
Power	Red*	9 blinks and beeps 1 second apart	Wrong power supply input voltage
Power	Red*	10 blinks and beeps 1 second apart	Bad option card
Power	None	None	System unable to power on.
Hard Drive	Green	Blinking	Hard drive activity

*Beeps will occur only for 5 iterations and then stop. LEDs will continue to blink until corrective action is taken.

Keyboard Light Combinations Used by Boot Block ROM

Failsafe Boot Block ROM	Keyboard LED Color	LED Activity	State/Message
Num, Caps, Scroll Lock	Green	On	ROMPaq diskette not present, is bad, or drive not ready.*
Caps Lock	Green	On	Enter password.
Num, Caps, Scroll Lock	Green	Blink On in sequence, one at a time - N, C, SL	Keyboard locked in network mode.
Num, Caps, Scroll Lock	Green	On	Boot Block ROM Flash successful. Turn power off, then on to reboot.

* Diagnostic lights do not flash on USB keyboards

Clearing CMOS

The computer's configuration (CMOS) may occasionally be corrupted. If it is, it is necessary to clear the CMOS memory using switch SW50. To clear and reset the configuration, perform the following procedure:

1. Prepare the computer for disassembly.

CAUTION: The power cord must be disconnected from the power source before pushing the Clear CMOS Button (NOTE: All LEDs on the board should be OFF). Failure to do so may damage the system board.

2. Remove the access panel.
3. Press the CMOS button located on the system board and keep it depressed for 5 seconds.
4. Replace the access panel.
5. Turn the computer on and run F10 Computer Setup (Setup utility) to reconfigure the system. You will receive POST error messages after clearing CMOS and rebooting advising you that configuration changes have occurred.

Disabling or Clearing the Power-On and Setup Passwords

1. Turn off the computer and any external devices, and disconnect the power cord from the power outlet.
2. With the power cord disconnected, press the power button again to drain the system of any residual power.
3. Remove the access panel.
4. Locate the header and jumper labeled E49.
5. Remove the jumper from pins 1 and 2. Place the jumper over pin 2 only to avoid losing it.
6. Replace the access panel.
7. Plug in the computer and turn on power. Allow the operating system to start.
NOTE: Placing the jumper on pin 2 clears the current passwords and disables the password features.
8. To re-enable the password features, repeat steps 1-4, then replace the jumper on pins 1 and 2.
9. Repeat steps 6-7, then establish new passwords.

Refer to the Computer Setup (F10 Setup) instructions to establish new passwords.

Computer Setup (F10) Utility Features (features may vary)

File	System Information About Set Time and Date	Replicated Setup Default Setup Apply Defaults and Exit	Ignore Changes and Exit Save Changes and Exit
Storage	Device Configuration Storage Options	DPS Self-Test Boot Order	
Security	Setup Password Power-On Password Password Options Smart Cover Embedded Security	Drivelock Security Data Execution Prevention Master Boot Record Security Save Master Boot Record Restore Master Boot Record	Device Security Network Service Boot System IDs
Power	OS Power Management	Hardware Power Management	Thermal
Advanced	Power-On Options BIOS Power On Onboard Devices	PCI Devices Bus Options	Device Options PCI VGA Configuration