

**Welcome to the next generation of computers.**

## Copyright Information

The only warranties for Hewlett-Packard products and services are set forth in the express statements accompanying such products and services. Nothing herein should be construed as constituting an additional warranty. HP shall not be liable for technical or editorial errors or omissions contained herein.

HP assumes no responsibility for the use or reliability of its software on equipment that is not furnished by HP.

This document contains proprietary information that is protected by copyright. No part of this document may be photocopied, reproduced, or translated to another language without the prior written consent of HP.

Hewlett-Packard Company  
P.O. Box 4010  
Cupertino, CA 95015-4010  
USA

Copyright © 2008 Hewlett-Packard Development Company, L.P.

This product incorporates copyright protection technology that is protected by U.S. patents and other intellectual property rights. Use of this copyright protection technology must be authorized by Macrovision, and is intended for home and other limited viewing uses only unless otherwise authorized by Macrovision. Reverse engineering or disassembly is prohibited.

Microsoft and Windows Vista are U.S. registered trademarks of Microsoft Corporation. The Windows logo and Windows Vista are trademarks or registered trademarks of Microsoft Corporation in the United States and/or other countries/regions.

HP supports lawful use of technology and does not endorse or encourage the use of our products for purposes other than those permitted by copyright law. The information in this document is subject to change without notice.

# Table of Contents

Finding HP TouchSmart PC Information .....	vi
<b>Getting to Know the HP TouchSmart PC .....</b>	<b>1</b>
HP TouchSmart PC Features .....	1
Front and right side of the HP TouchSmart PC .....	2
Left side of the HP TouchSmart PC .....	4
Removing the Connector Cover .....	5
Back of the HP TouchSmart PC .....	5
Activity LED indicator lights .....	7
Connecting the power source .....	8
Cable Management .....	8
Adjust the Angle of the Computer Stand .....	10
Using the Wireless Keyboard or Mouse .....	10
Synchronizing the wireless keyboard or mouse .....	11
Turning the HP TouchSmart PC On and Off .....	12
Turning on the HP TouchSmart PC .....	12
Turning off the HP TouchSmart PC .....	12
Changing Power Settings .....	13
Connecting to the Internet .....	13
Setting up a wireless home network .....	14
Setting up a wired home network .....	15
Using Bluetooth Devices .....	16
Adjusting Screen Brightness .....	16
Adjusting the Ambient Light .....	17
Adding Hardware and Software .....	17
Upgrading your HP TouchSmart PC hardware .....	17
Updating your HP TouchSmart software .....	17
Using the Optical Disk Drive .....	18
Using the TV Tuner to Watch and Record TV Programs on the HP TouchSmart PC .....	18
Connecting the TV signal source to the computer .....	19
Setting up the HP TouchSmart PC with a set-top box .....	20
Completing the Windows Media Center setup wizard .....	21
Using the remote control with Windows Media Center .....	21

Sound Options.....	22
Connecting analog speakers .....	22
Connecting and enabling digital speakers or an audio receiver .....	23
Speaker volume .....	24
Configuring sound for Windows Media Center .....	25
Using headphones.....	25
Using the microphone array .....	25
Using a headset .....	25
Connecting MP3 players .....	25
Connecting a Printer .....	26
Installing a Security Lock .....	26
Cleaning the HP TouchSmart PC Screen .....	27
Using the Computer with Safety and Comfort.....	28
Preparing the Computer for Shipping.....	28
Recycling Your Old Computer Hardware .....	29
<b>HP TouchSmart Software Overview .....</b>	<b>31</b>
What Is HP TouchSmart Software? .....	31
Opening HP TouchSmart Software .....	31
Opening HP TouchSmart Automatically.....	31
Navigating HP TouchSmart .....	32
Touch Techniques for the Windows Desktop and Non-HP TouchSmart Software .....	34
Tablet Input Panel (Onscreen Keyboard) .....	34
HP TouchSmart Tiles .....	35
HP TouchSmart Browser .....	35
HP TouchSmart Photo.....	36
HP TouchSmart Music .....	36
HP TouchSmart Video .....	36
Webcam and Microphone .....	36
Capturing webcam video and snapshots .....	37
HP TouchSmart Calendar .....	37
Synchronizing Your HP TouchSmart Calendar with Windows Vista Mail Calendar .....	37
HP TouchSmart Notes .....	38
HP TouchSmart Weather .....	38
HP TouchSmart Clock .....	38
Software Quick Reference Table .....	39

<b>HP TouchSmart FAQs .....</b>	<b>41</b>
How do I add tiles (shortcuts) to my HP TouchSmart homepage view? .....	42
How do I add a tile of a favorite Web site link? .....	42
How can I see all the tiles in my homepage view? .....	43
How do I temporarily hide a tile? .....	43
How do I delete a tile from the HP TouchSmart homepage? .....	43
How do I change the icons designating my tiles? .....	43
What is an RSS Feed? .....	43
How do I set up an RSS feed? .....	44
How do I get photos into my HP TouchSmart Photo library? .....	44
How do I create a slideshow of my photos? .....	45
How do I hide some of my photos? .....	45
How do I get my music files into HP TouchSmart Music? .....	45
Why can't I see all my music in HP TouchSmart Music? .....	46
How do I get my songs from iTunes into HP TouchSmart Music? .....	46
How do I find album art for my music? .....	46
How do I create and edit a playlist of my songs? .....	47
How do I delete songs? .....	47
How do I create (burn) a CD or DVD of my music or photos? .....	48
How do I make a video with HP TouchSmart? .....	48
How do I make a video playlist? .....	49
How do I transfer my videos to my computer? .....	49
How do I upload my videos to YouTube? .....	49
How do I record my home movies? .....	49
Where are my webcam and microphones? .....	50
What is the time limit of my video recordings? .....	50
What is the resolution of the HP TouchSmart webcam? .....	50
How do I make a video chat or a conference call? .....	50
How do I create and save a handwritten or typed note? .....	51
How do I create a voice note? .....	51
How do I delete a text or voice note? .....	51
How do I display the temperature and forecast for a city? .....	52
Can I connect an old printer to my HP TouchSmart computer? .....	52
How can I tell if my HP TouchSmart computer is 64-bit or 32-bit? .....	52
What can I do if my HP TouchSmart media programs are crashing? .....	53
<b>Index .....</b>	<b>55</b>

# Finding HP TouchSmart PC Information

Type of information		Where to find
<ul style="list-style-type: none"> <li>Set up your HP TouchSmart PC.</li> </ul>		Setup poster
<ul style="list-style-type: none"> <li>How-to videos about using HP TouchSmart features.</li> </ul>		Visit <a href="http://hp.com/go/learntouchsmart">hp.com/go/learntouchsmart</a> (English only)
<ul style="list-style-type: none"> <li>Find features of the computer hardware.</li> <li>Connect to the Internet.</li> <li>Learn about HP TouchSmart and other software.</li> <li>Connect a television signal.</li> </ul>		<i>HP TouchSmart PC Getting Started</i> guide (this guide)
<ul style="list-style-type: none"> <li>Watch and record TV programs on the computer.</li> <li>Use the Windows Media Center remote control (select models only).</li> </ul>		<i>Watching and Recording TV</i> guide Tap the <b>Windows Vista start button™</b> , tap <b>Help and Support</b> , and then tap the <b>User Guides</b> icon.
<ul style="list-style-type: none"> <li>Learn how to use the Microsoft® Windows Vista® operating system.</li> <li>Troubleshoot the most common computer hardware and software issues.</li> </ul>		Help and Support Tap the <b>Windows Vista start button</b> , and then tap <b>Help and Support</b> .
<ul style="list-style-type: none"> <li>Find electronic user guides and specifications for your computer model.</li> <li>Order parts and find additional troubleshooting help.</li> </ul>		HP Support Web site: <a href="http://www.hp.com/support">http://www.hp.com/support</a> Tap the <b>Windows Vista start button</b> , tap <b>Help and Support</b> , and then tap the <b>Online Help</b> icon.
<ul style="list-style-type: none"> <li>Upgrade or replace components of your computer.</li> </ul>		<i>Upgrading and Servicing Guide</i> <b>NOTE:</b> If this guide is not included with your printed documentation, tap the <b>Windows Vista start button</b> , tap <b>Help and Support</b> , and then tap the <b>User Guides</b> icon.
<ul style="list-style-type: none"> <li>Recover factory settings.</li> <li>Find computer warranty information.</li> <li>Get technical support.</li> </ul>		<i>Limited Warranty, Support, and System Recovery Guide</i>

# Getting to Know the HP TouchSmart PC

## HP TouchSmart PC Features

The HP TouchSmart PC is a fun and engaging touch-enabled high-performance computer built into a high-definition\* 56-cm (22-in) diagonal widescreen display. The slim computer comes with features like webcam (Internet access required and not included), CD/DVD and Blu-ray (select models only) player and burner (actual speeds may vary; do not copy copyright-protected material), HP Pocket Media Drive bay, software-controlled ambient lighting, USB ports, FireWire® (IEEE 1394), media card reader, Brightview display, Wireless 802.11n networking, and high-quality speakers.

(The specifications for the 802.11n wireless LAN (WLAN) are draft specifications and are not final. If the final specifications differ from the draft specifications, it may affect the ability of the computer to communicate with other 802.11n WLAN devices.)

Using your fingertips, you can listen to your favorite music, edit your digital photos, or watch your favorite home video.

Features and configurations vary by model. Your computer may not exactly match the illustrations and descriptions in this guide.





---

\* High-definition (HD) content is required to view HD images.

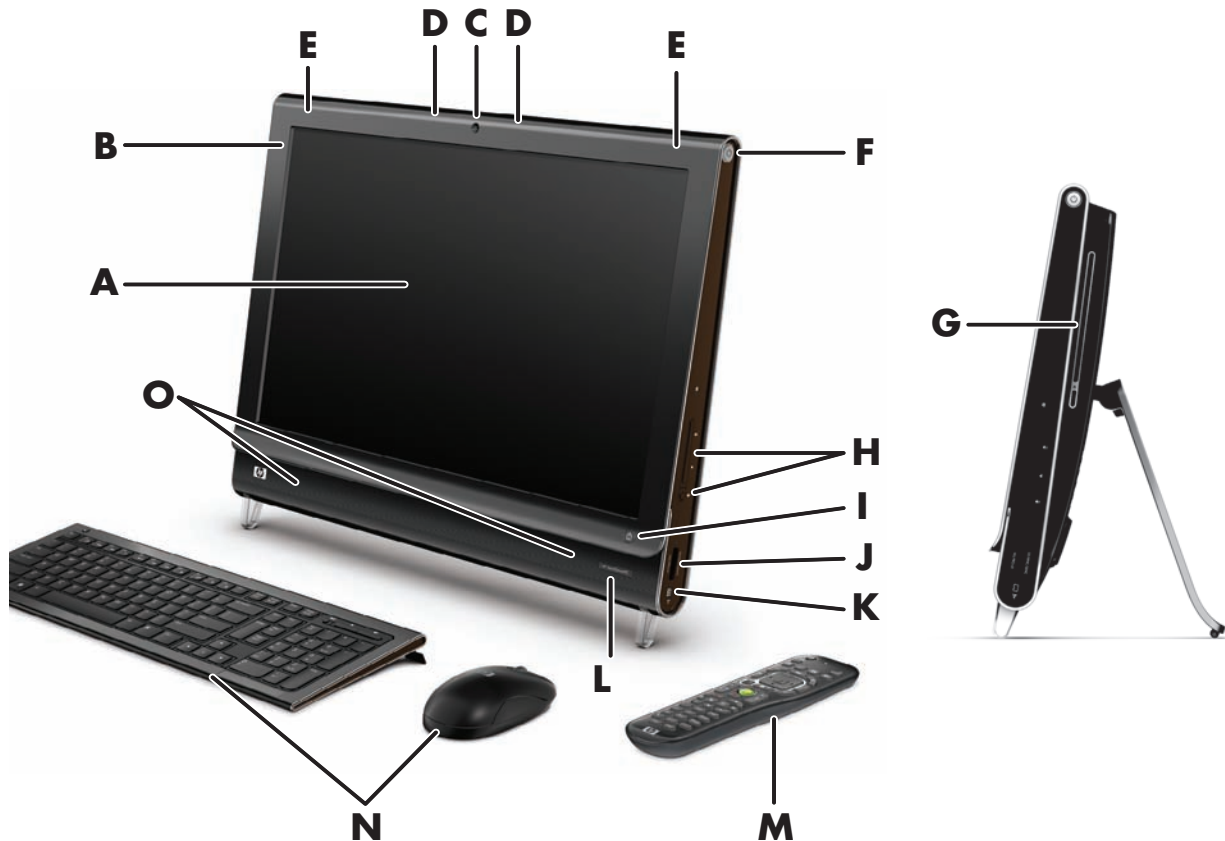

## Front and right side of the HP TouchSmart PC

Features and configurations vary by model



Item	Description
<b>A</b>	<p>LCD display optimized for touch</p> <p>The HP TouchSmart PC integrates a state-of-the-art 56-cm (22-in) diagonal widescreen high-definition display with HP BrightView technology.* The HP BrightView technology improves the contrast and clarity of your display, so that colors are brighter and images come to life. In addition, it boasts a high resolution of 1680 x 1050 and a fast response time of 5 ms.**</p> <p>The display is optimized for an elegant touch experience. Your fingertip is all you need to interact with the HP TouchSmart. The durable glass panel is sturdy and delightfully responsive. Experience the ease of managing your digital life by touch with the HP TouchSmart software. </p> <p>* High definition (HD) content is required to view HD images. Most current DVDs do not provide HD images.</p> <p>**All specifications represent the typical specifications provided by Hewlett-Packard's component manufacturers; actual performance may vary either higher or lower.</p>
<b>B</b>	<p>Bluetooth (select models only)</p> <p>Use Bluetooth to connect to Bluetooth-enabled devices. The diagram shows the internal location of Bluetooth (not visible externally).</p>
<b>C</b>	<p>Webcam</p> <p>Create videos and snapshots that you can view, send by e-mail, and upload to video sharing sites. Use the built-in webcam and microphone array to have video chats with friends and family.*</p> <p>* Internet access required.</p>



Item	Description (continued)
<b>D</b> Microphone array	Use the built-in digital microphone array to record sound for your webcam videos, and to use instant messenger or chat software to have video chats online. The microphone is designed to filter out ambient noise in your environment, to provide a cleaner sound. It is designed to record from a distance of up to one-half meter (2 feet) away from the computer.
<b>E</b> Built-in wireless LAN	Use the built-in wireless LAN to connect to the Internet through your existing wireless network. The diagram shows the internal location of the wireless LAN (top left and right, not visible externally).  The wireless LAN supports IEEE 802.11 b/g/n (pre-n).
<b>F</b> Power/Sleep button  	Press the Power/Sleep button to turn on your HP TouchSmart PC, or put it in Sleep mode. To turn off your computer, tap the <b>Windows Vista start button</b> , tap the <b>Arrow</b> button next to the Lock icon, and then select <b>Shut Down</b> . 
<b>G</b> Slot-loading CD/DVD drive (located on back side panel)	Watch your favorite DVD or Blu-ray (select models only) disc, or listen to your CD collection. Burn CDs and DVDs, and Blu-ray discs.*  Read and write DVD-RAM, CD-R/RW, and DVD+/-R/RW.  Read and play CD-ROM, DVD-ROM, CD Audio, DVD+/-R dual layer (DL), DVD-Video, and Video CD.  * HP supports the lawful use of technology and does not endorse or encourage the use of our products for purposes other than those permitted by copyright law.
<b>H</b> Volume and mute controls	Adjust the sound level up or down, or mute.
<b>I</b> HP TouchSmart button  	Turn your HP TouchSmart PC on and open your HP TouchSmart software. Or, if the computer is already turned on, press the button to open the HP TouchSmart software for quick access to your music, photos, videos, or the Web. The HP TouchSmart button cannot turn the computer off.
<b>J</b> Memory card reader	Use the built-in memory card reader to easily access photos and other files directly from a memory card.  Supported formats include xD media (xD), Secure Digital (SD), Secure Digital High Capacity (SDHC), MultiMediaCard (MMC), Memory Stick (MS), and Memory Stick Pro (MS-Pro) memory cards.  Your memory card reader also supports adapters for the following memory cards: Mini SD, RS MMC, Micro SD, MS-Duo, and MS Duo Pro.
<b>K</b> FireWire (IEEE 1394)	Transfer videos from your digital video camcorder (4-pin connector).
<b>L</b> IR receiver window	Infrared (IR) receiver window, located on the lower right side of the computer. Works with a remote control and TV tuner (select models only).
<b>M</b> Remote control (select models only)	Point the remote control at the lower right-side of the computer, where the IR receiver is located, and then navigate to all of your Windows Media Center options, such as watching and recording your favorite TV shows. A remote control is included with select models only.  Refer to the <i>Watching and Recording TV</i> guide. To locate, tap the <b>Windows Vista start button</b> , tap <b>Help and Support</b> , and then tap <b>User Guides</b> .

Item	Description (continued)
<b>N</b> Wireless keyboard and mouse	Sleek wireless keyboard and mouse fit under the HP TouchSmart PC.
<b>O</b> Internal Speakers	Use the built-in, high-quality stereo speakers for a powerful media experience when listening to music, or when watching your home videos and DVDs.

## Left side of the HP TouchSmart PC

Features and configurations vary by model

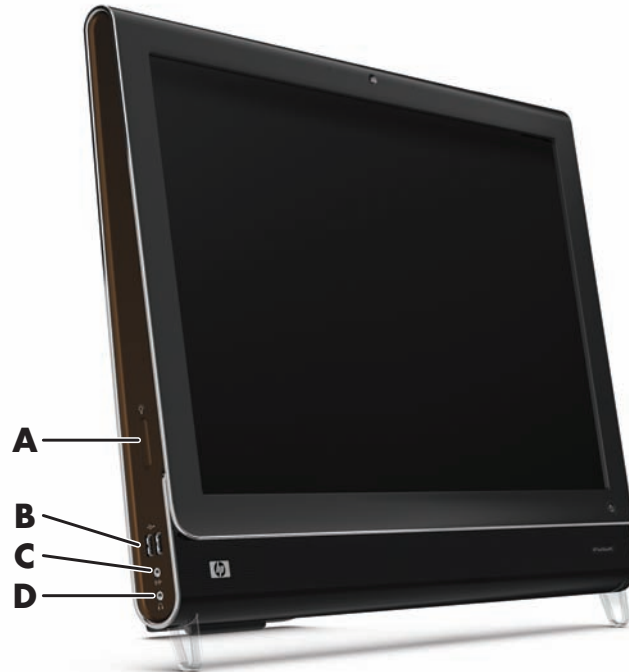

Connector	Function
<b>A</b> Ambient Light button	The HP TouchSmart Ambient Light casts a cool white glow from base of the computer.
<b>B</b> USB 2.0	Connect USB devices (USB 2.0) such as printers, external hard disk drives, digital cameras, and MP3 players.
<b>C</b> Audio Line In	Connect MP3 players or other audio players.
<b>D</b> Headphones	Listen to music without disturbing anyone, by connecting your headphones to the port.

## Removing the Connector Cover

To remove the connector cover on the back of the computer, insert your finger under the gap on the bottom-left side of the cover, and pull gently. Replace the connector cover by aligning the hooks on the right edge of the cover with the slots on the computer, and then pressing it until it snaps into place.

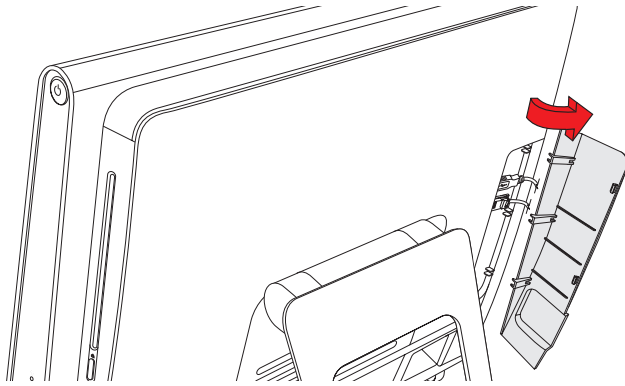

## Back of the HP TouchSmart PC

Features and configurations vary by model

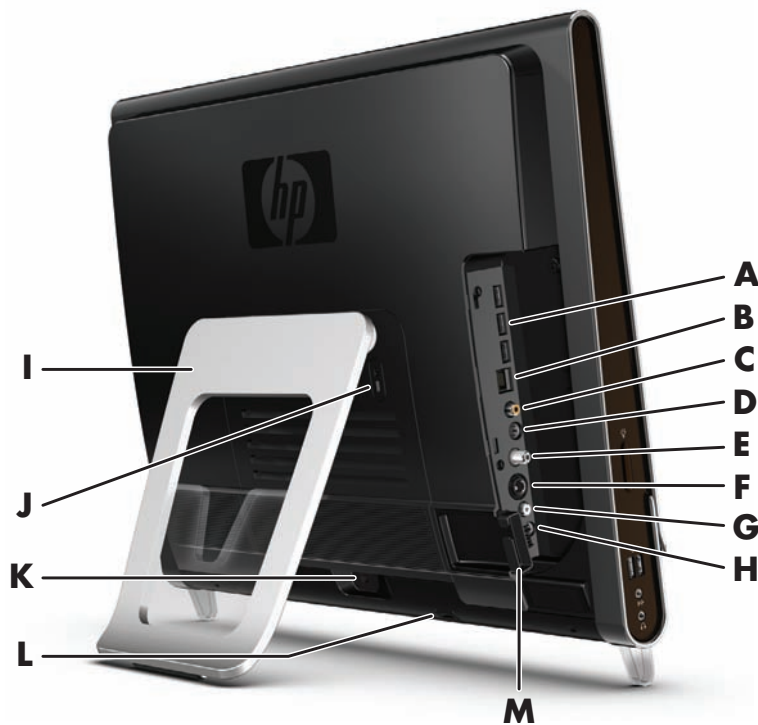

Connector	Function
<b>A</b> USB 2.0 ports (3)	Connect USB devices (USB 2.0) such as printers, external hard disk drives, digital cameras, and MP3 players.
<b>B</b> Gigabit Ethernet LAN (10/100/1G)	Connect to the Internet through your wired network.

<b>Connector</b>		<b>Function (continued)</b>
<b>C</b>	Digital audio port (SPDIF Out)	Connect to your home theater system or your surround sound digital speakers. Supports 3.1, 4.1, and 5.1 speakers.
<b>D</b>	Audio Line Out	Connect external 2.0 and 2.1 powered speakers.
<b>E</b>	TV In	Connect your TV signal source to watch, record, and pause live TV. This is an F-type coaxial TV input signal connector.
<b>F</b>	S-Video In	Capture analog video from a video camera, or connect to a set-top box for TV input.
<b>G</b>	Stereo Audio In	Connect audio for A/V input from a set-top box, digital video camera, or other video device.
<b>H</b>	IR Emitter (blaster) (select models only)	Adhere to your TV set-top box IR receiver area to receive the remote control signal for watching and recording TV programs. This is not required if you do not use a set-top box. A remote control is included with select models only.
<b>I</b>	Computer stand	Slide stand for stability and best viewing angle. The stand supports an adjustable tilt angle between 10 and 40 degrees from the vertical.  To assure that the computer is in a stable position on your desktop, pull the computer stand open until you hear it snap into place.
<b>J</b>	Security lock slot	Insert a security lock (sold separately), which enables you to secure your computer from theft and unwanted changes.
<b>K</b>	Power connector	Plug the power adapter into the computer.
<b>L</b>	Wireless keyboard and mouse receiver	Preinstalled receiver for using a wireless keyboard and mouse.
<b>M</b>	Cable clip	Route your cables through the clip, close the connector cover, and then route the cables through the notch in the computer stand.

## Activity LED indicator lights

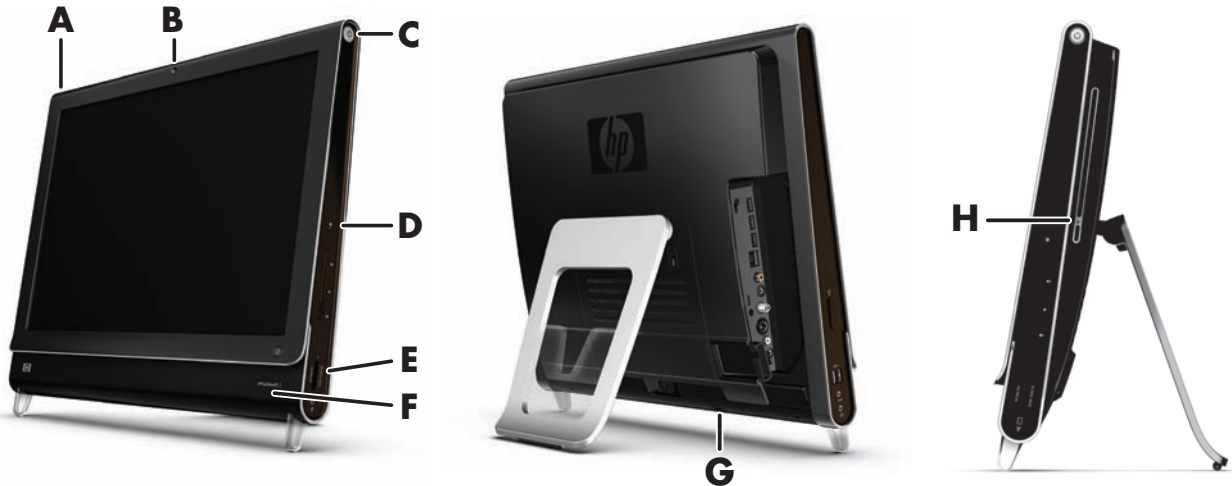

The following are the activity indicator light-emitting diodes (LEDs) on your HP TouchSmart PC:

LED	What it does
<b>A</b> Event	Indicates an event reminder notification has been set from a software application. Setting of the event reminder is available in select software applications only.
<b>B</b> Webcam	Indicates webcam activity.
<b>C</b> Power	Indicates the power state; blue indicates power on, and amber indicates Sleep mode.
<b>D</b> Hard disk drive	Indicates hard disk drive activity.
<b>E</b> Memory card reader	Indicates memory card reader activity. When the LED is flashing, do not remove your memory card.  When the LED is off, no card is inserted. A solid LED indicates that a card is inserted with no read or write capacity. A flashing LED indicates that there is memory card activity, and that a card has read/write capacity.
<b>F</b> Remote control IR receiver	Indicates that your computer is working with your remote control to navigate windows, record TV shows, and perform other activities in Windows Media Center. A remote control is included with select models only.
<b>G</b> Wireless keyboard and mouse receiver	Indicates wireless signals received from the wireless keyboard and mouse. The LED is visible from the back of the computer.
<b>H</b> Optical Disc Drive Activity	Indicates Optical Disc Drive is in use.

## Connecting the power source

Plug the power cord into the AC adapter (brick), and the power adapter cord into the back of the computer. Route the power cord through the notch in the computer stand, and then plug the power cord into an AC power source through a surge protector/uninterruptible power supply (UPS).

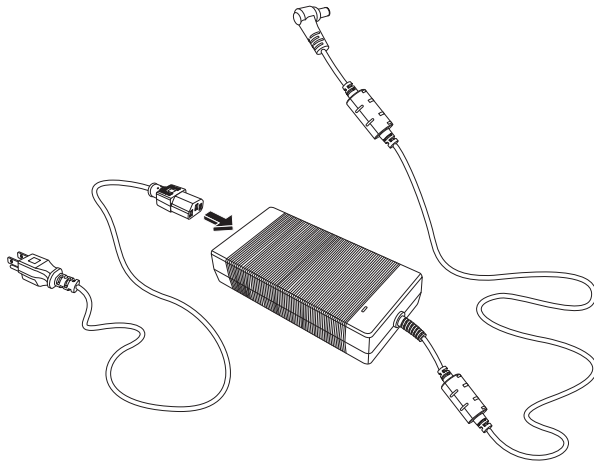

## Cable Management

The HP TouchSmart PC includes a cable-management feature that is located behind the back connector cover. To use the cable routing clip feature:

- 1 To remove the connector cover on the back of the computer, insert your finger under the gap on the bottom-left side of the cover, and pull gently.

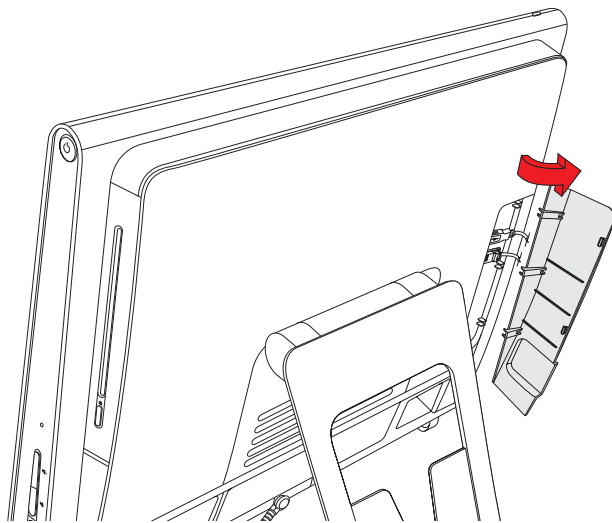

- 2 Route your cables through the cable routing clip (**A**), and out of the back of the computer.



- 3 Replace the connector cover by aligning the hooks on the right edge of the cover with the slots on the computer, and then pressing it until it snaps into place. Then, route the cables through the notch (**B**) in the computer stand.



## Adjust the Angle of the Computer Stand

The HP TouchSmart PC is shipped with the computer stand collapsed against the back of the computer. To assure that the computer is in a stable position on your desktop, pull the computer stand open until it snaps into place. Then, if you want to change the angle of HP TouchSmart PC, hold each side of the computer, and tilt it back to an angle of between 10 and 40 degrees from the vertical.

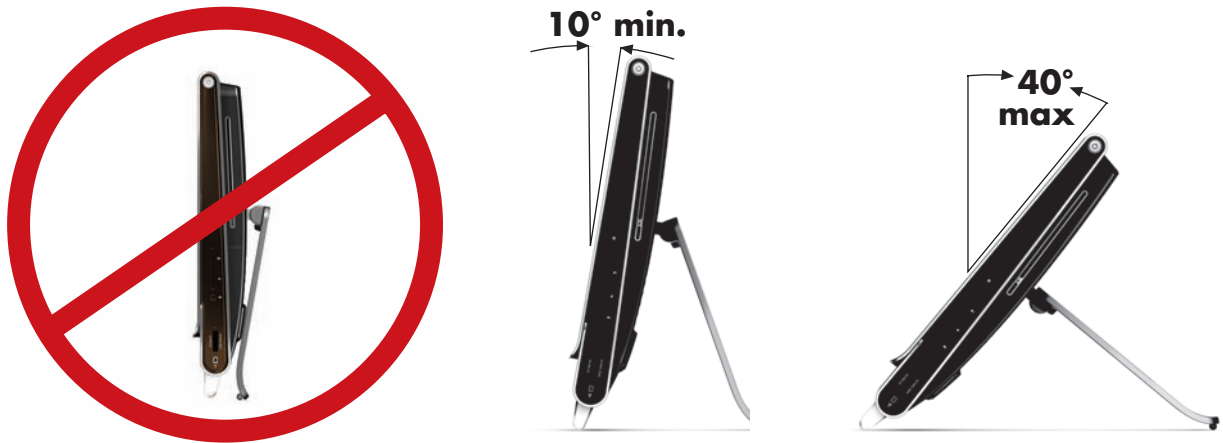

**CAUTION:** Make sure the angle of the computer is at least 10 degrees from the vertical; otherwise the computer will be unstable and could fall over.

## Using the Wireless Keyboard or Mouse

Your wireless keyboard and mouse are easy to set up. All you need to do is remove the battery tabs on both the keyboard and the mouse. Also, make sure the Power switch on the bottom of the mouse is in the On position (the keyboard does not have a Power switch). Then, turn on the computer. If you have trouble using the keyboard and mouse, manually synchronize them as explained in the next procedure.





## Synchronizing the wireless keyboard or mouse

The wireless keyboard and mouse are pre-synchronized for your convenience, to work with your HP TouchSmart PC. They should work immediately after pulling the battery tabs, which activate the pre-installed batteries, and turning the mouse switch on **(B)**.

You may need to manually synchronize the wireless keyboard or mouse if they are not functioning.

To synchronize them:

- Make sure the keyboard and mouse are next to the HP TouchSmart PC, within 30 cm (1 foot) and away from interference from other devices.
- **Keyboard:** Press the connect button on the bottom of the keyboard **(A)** for five seconds. The blue activity LED in the bottom rear of the HP TouchSmart PC will illuminate when the synchronization command has been received and will go off when synchronization is complete.
- **Mouse:** Press the connect button on the bottom of the mouse **(C)** for five seconds. The blue activity LED in the bottom rear of the HP TouchSmart PC will illuminate when the synchronization command has been received and will go off when synchronization is complete.



If this does not work, remove and then re-insert the wireless keyboard and mouse receiver from the back of the computer and then synchronize the keyboard and mouse again.

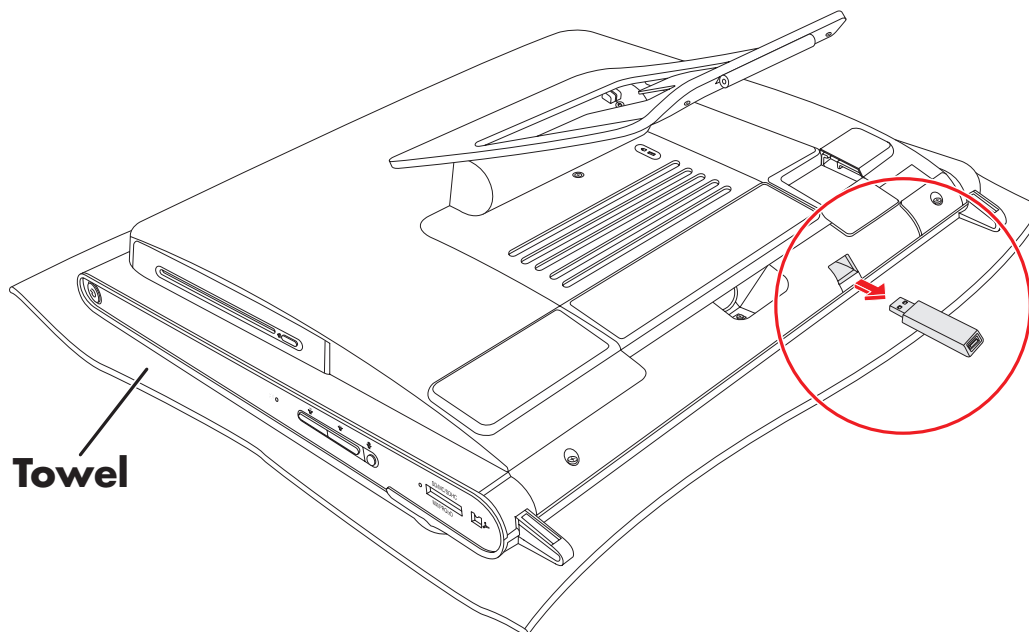

# Turning the HP TouchSmart PC On and Off

## Turning on the HP TouchSmart PC

After you finish setting up your HP TouchSmart PC, press the Power/Sleep button **(A)** on the top-right side of the computer to turn it on. Complete the initial setup by following the onscreen instructions. Please be patient while the setup process completes; it may take several minutes.



You can also turn on the HP TouchSmart PC or put it into Sleep mode by pressing the Power/Sleep button on the keyboard or the remote control. A remote control is included with select models only.

After you have turned on the computer for the first time, and gone through all the setup wizards, you can use the HP TouchSmart button **(B)** to turn on the computer and open the HP TouchSmart software. If the computer is already turned on, you can press this button to open the HP TouchSmart window.



## Turning off the HP TouchSmart PC

Tap the **Windows Vista start button**, tap the **Arrow** button next to the Lock icon, and then select **Shut Down**.



## Changing Power Settings

Basic power settings help conserve energy or enhance computer performance. You can also customize power settings for your computer hardware. For example, you can set your computer to go to sleep after a specified period of inactivity.

What used to be called Standby is now called Sleep in Microsoft Windows Vista. In Sleep mode, your work is saved to memory, and then the computer enters a power-saving state.

To put the computer in Sleep mode, tap the **Windows Vista start button**, tap the **Arrow** button next to the Lock icon, and then select **Sleep**.



To change power settings:

- 1 Tap the **Windows Vista start button**, and then tap **Control Panel**.
- 2 Tap **Hardware and Sound**.
- 3 Tap **Power Options**.
- 4 Choose a power option.

There are many to choose from, including when the computer sleeps, and what ratio you want of energy savings versus performance.

## Connecting to the Internet

Your HP TouchSmart PC is designed to support a wireless or wired LAN that connects your computer to other devices, such as printers and other PCs. The network connection to the Internet is usually through a broadband modem (digital subscriber line [DSL] or cable), which requires a separate subscription.

- For a wireless LAN, the HP TouchSmart PC includes a built-in wireless LAN antenna, which you can use to access your wireless home network.
- For a wired LAN, connect an Ethernet cable (sold separately) to the Ethernet connector on the back of the computer, and then connect the other end to the network router or broadband modem.

## Setting up a wireless home network

Wireless access point and Internet service required and not included. Availability of public wireless access points limited.

First-time wireless network installation requires that you:

- 1 Purchase high-speed Internet service from an Internet service provider (ISP).
- 2 Purchase a broadband modem (DSL or cable). This may be provided by the ISP.
- 3 Purchase and install a wireless router (sold separately), if one is required.

---

**NOTE:** Broadband modem and router installation procedures vary, depending on the manufacturer. Follow the manufacturer's instructions.

---

- 4 Connect your computer to the network.

---

**NOTE:** A DSL wall connection is shown here. If you have a cable modem, the connection from the wall to the modem will be with a coaxial cable.

---

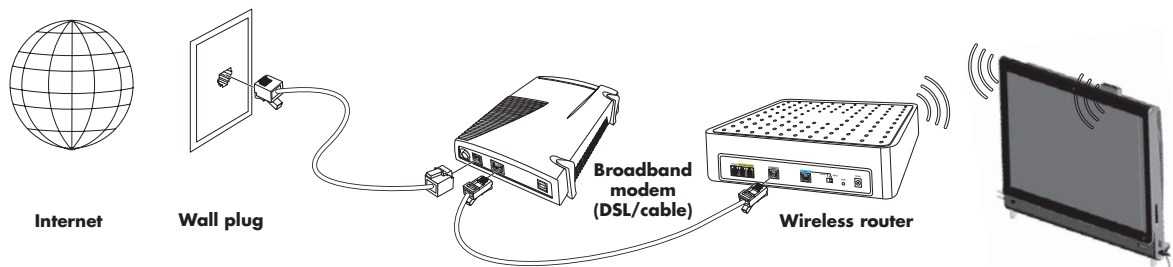

- 5 Configure the HP TouchSmart PC to connect to the wireless network.

- a Turn on your HP TouchSmart PC.
- b Connect your HP TouchSmart PC to the wireless network:
  - Right-click the **Network** icon on the taskbar, and then select **Connect to a network**. When the window opens, select the network, and then click **Connect**.



Or

- Right-click the **Network** icon on the taskbar, and then select **Network and Sharing Center**. When the window opens, select **Setup a wireless router or access point**, and then follow the onscreen instructions.
  - c Test the wireless network by opening your Web browser and accessing any Web site.
- 6 Add wireless devices to the network (optional).



## Setting up a wired home network

First-time wired network installation requires that you:

- 1 Purchase high-speed Internet service from an Internet service provider (ISP).
- 2 Purchase a broadband modem (DSL or cable). This may be provided by the ISP.
- 3 Purchase and install a wired router (sold separately), if one is required.

---

**NOTE:** Broadband modem and router installation procedures vary, depending on the manufacturer. Follow the manufacturer's instructions.

---

- 4 Connect the DSL cable (shown) or coaxial cable (not shown) from the wall to the modem.
- 5 Connect the modem to the computer Ethernet port with an Ethernet cable. If you want to connect multiple devices to the network, connect a router or hub (not shown) to the modem with an Ethernet cable, and then connect the computer to the router with an Ethernet cable.

If you have an actual wired network in your home with Ethernet connectors in the wall, connect directly from your computer Ethernet port to the Ethernet wall connector with an Ethernet cable.

The Ethernet port on the HP TouchSmart PC is located on the back of the computer, behind the connector cover. For clean cable management, route the cable through the cable router clip on the back of the PC (shown), then route the cable through the notch in the back stand (not shown), then close the back connector cover.

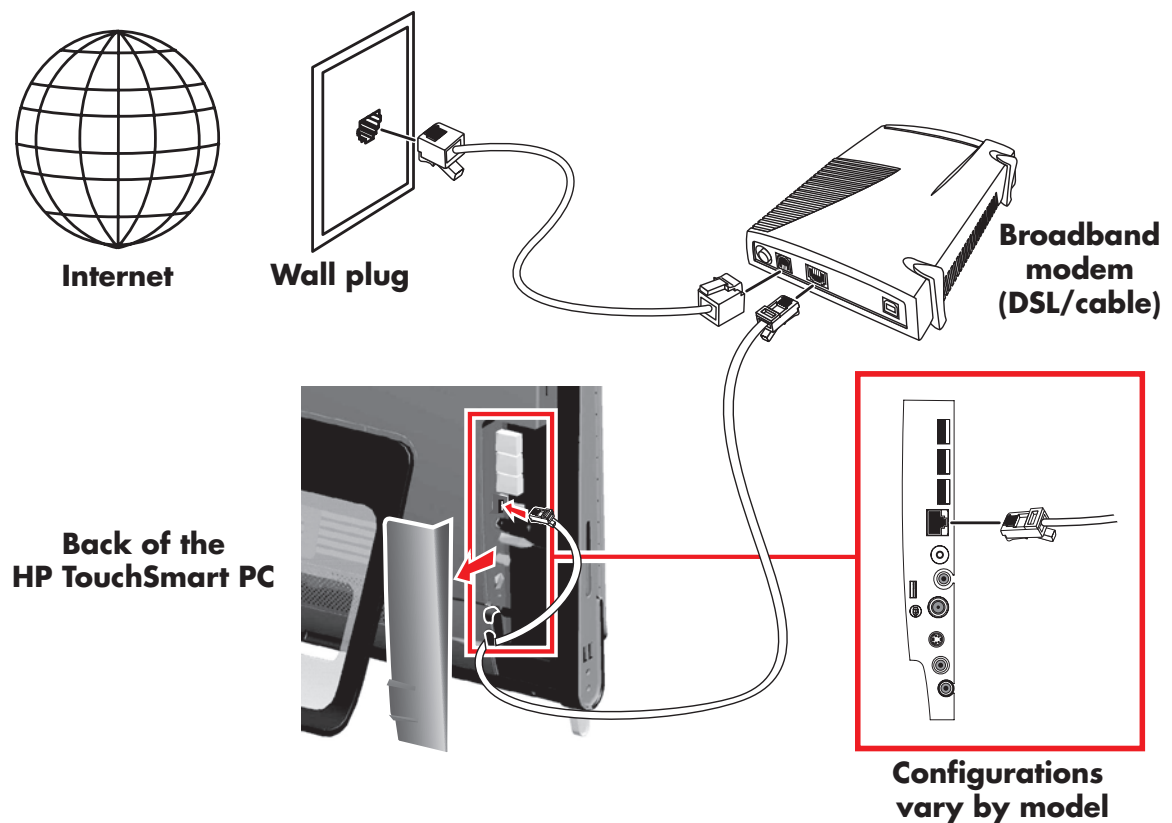

- 6 Add other computers or devices to your wired network:
  - a Disconnect power from the broadband modem and the router, and then shut down your HP TouchSmart PC and the computers you want to add to your network.
  - b For each wired computer, connect one end of an Ethernet cable to the LAN connector on the computer, and then connect the other end of the cable to any available Ethernet connector on the router.
  - c Reconnect power to the modem, and wait until the modem has completed its startup cycle. Reconnect power to the router. Then, turn on the wired computers and your HP TouchSmart PC.
  - d Test the network connection for each wired computer by opening your Web browser and accessing any Web site.

## Using Bluetooth Devices

### Select models only

Some models of the HP TouchSmart PC are Bluetooth-enabled, so that you can connect all kinds of Bluetooth-enabled wireless devices. Bluetooth devices create a personal area network (PAN), which connects other Bluetooth devices, such as computers, phones, printers, headsets, speakers, and cameras. In a PAN, each device communicates directly with the other devices, and the devices must be relatively close together.

To enable a Bluetooth device:

- 1 Refer to your Bluetooth device's instructions to make it "discoverable" (sends out a radio signal).
- 2 Click the **Windows Vista start button, Control Panel**, and then click **Hardware and Sound**. Click **Bluetooth Devices**. Click **Add**. Follow onscreen instructions.
- 3 If your Bluetooth device is a printer, click the **Windows Vista start button, Control Panel**, and then click **Hardware and Sound**. Click **Printers**. Click **Add a printer**.

## Adjusting Screen Brightness

Adjust screen brightness either with the keyboard that came with your computer, or through the Control Panel.

With your keyboard:

- Press the Function (Fn) key on the keyboard, and simultaneously press the F10 key to reduce screen brightness.
- Press the Fn key, and simultaneously press the F11 key to increase brightness.

Through the Control Panel:

- 1 Tap the **Windows Vista start button, Control Panel**, and then tap **Hardware and Sound**.
- 2 Tap **Power Options**.
- 3 In the left panel of the Power Options window, tap **Adjust the display brightness**.
- 4 Move the slider to the left to reduce brightness, and to the right to increase brightness.

# Adjusting the Ambient Light

The HP TouchSmart Ambient Light casts a cool white glow from the base of the computer. By default, the Ambient Light is turned off when you turn on the computer.

To control the Ambient Light:

- Press the Ambient Light button on the left side of the computer to turn the Ambient Light on.
- Continue pressing the button to cycle through low intensity, medium intensity, high intensity, off, and on.

---

**NOTE:** The Ambient Light will dim when the computer goes into sleep mode.

---

# Adding Hardware and Software

Some HP TouchSmart PCs feature a Windows Vista 64-bit system, and may not be compatible with all of the software you install or all of the hardware you add. Make sure your hardware and software are compatible with the operating system.\*

## Upgrading your HP TouchSmart PC hardware

To find detailed instructions on removing and replacing the memory and the hard disk drive for your HP TouchSmart PC, refer to the *Upgrading and Servicing Guide* that came with your computer.

## Updating your HP TouchSmart software

Check [www.hp.com/go/touchsmart](http://www.hp.com/go/touchsmart) for updated software and new software features.

---

\* Certain Windows Vista product features require advanced or additional hardware. See [www.microsoft.com/windowsvista/getready/hardwarereqs.mspx](http://www.microsoft.com/windowsvista/getready/hardwarereqs.mspx) and [www.microsoft.com/windowsvista/getready/capable.mspx](http://www.microsoft.com/windowsvista/getready/capable.mspx) for details. Windows Vista Upgrade Advisor can help you determine which features of Windows Vista will run on your computer. To download the tool, visit [www.windowsvista.com/upgradeadvisor](http://www.windowsvista.com/upgradeadvisor)

## Using the Optical Disk Drive

You can use your CD/DVD drive to play and record CDs and DVDs, and Blu-ray (select models only) discs. The slim-slot CD/DVD drive does not have a disc tray. To insert a disc, turn the data side toward the back of the computer (label side forward) and slide the disc into the drive slot.

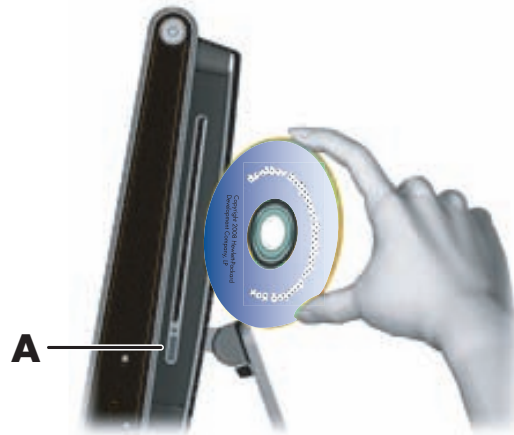

To eject a disc, make sure the power is turned on and then press the eject button (**A**) on the side of the disc drive. You can also tap the **Windows Vista start button**, tap **Computer**, press and hold (or with the mouse, right-click) the CD drive, and then tap **Eject**.

If the disc gets stuck, refer to the *Limited Warranty, Support, and System Recovery Guide* for the telephone number to contact HP Support.

## Using the TV Tuner to Watch and Record TV Programs on the HP TouchSmart PC

### Select models only

You can watch and record your favorite TV programs by using Windows Media Center. All of the menus in Windows Media Center are accessible through touch, as well as your remote control, keyboard, and mouse. TV tuners and remote controls are included in select models only.

To watch and record TV programs on your HP TouchSmart PC:

- 1 Connect the TV signal source to the TV tuner on the computer. See “Connecting the TV signal source to the computer” on page 19.
- 2 Set up your computer for use with a set-top box (optional). See “Setting up the HP TouchSmart PC with a set-top box” on page 20.
- 3 Complete the Windows Media Center setup wizard to configure your TV tuner and your program guide. See “Completing the Windows Media Center setup wizard” on page 21.
- 4 Point the remote control at the IR receiver on the lower-right side of the HP TouchSmart PC to start Windows Media Center, and navigate through this program to watch and record TV shows. See “Using the remote control with Windows Media Center” on page 21.

For more information about how to watch and record TV programs, refer to the *Watching and Recording TV* guide. To locate, tap the **Windows Vista start button**, tap **Help and Support**, and then tap **User Guides**.



# Connecting the TV signal source to the computer

## Select models only



**WARNING:** Please read "Additional Safety Information" in the *Limited Warranty, Support, and System Recovery Guide* before installing and connecting your HP TouchSmart PC to the electrical power system.

To connect a TV signal to the computer, your computer needs a TV tuner, which is included with select models only. You also may need to purchase some cables separately. (Availability of signals is limited by the strength and accessibility of the originating TV signal, location and other factors. Performance issues may arise, and do not constitute defects in the product.)

Your TV tuner requires that you use a TV tuner isolator (adapter) (purchased separately) with your computer to connect a coaxial cable to the TV signal source. Using the TV tuner adapter helps prevent personal injury and computer damage from surges on the coaxial line.

Norway and Sweden: Cable grounding notice for products with a TVB tuner.



**WARNING:** To reduce potential safety issues, use a galvanic isolator when connecting to a cable distribution system.

- 1 Connect the coaxial cable from your TV antenna or TV cable provider to the TV In (**A**) connector located on the back of the computer behind the connector cover.

Or

Connect an S-Video cable to the S-Video In connector (**B**), located on the back of the computer behind the connector cover. Connect the other end of the cable to your set-top box.



You may need a composite video to S-Video adaptor (sold separately) from the set-top box Video Out to the S-Video In connector (**B**).



- 2 For S-Video, connect audio cable from your set-top box to the Audio Line In (**C**) connector on the back of the computer. Use with a Y cable to combine RCA left and right channels (white and red).



- 3 If you are using a set-top box, connect the IR emitter cable to the IR emitter connector (**D**) on the back of the computer, in order to use the remote control. The IR emitter cable is shown in the following illustration. You must adhere the IR blaster onto the set-top box IR receiver window. Point the remote control at the computer (not the set-top box).

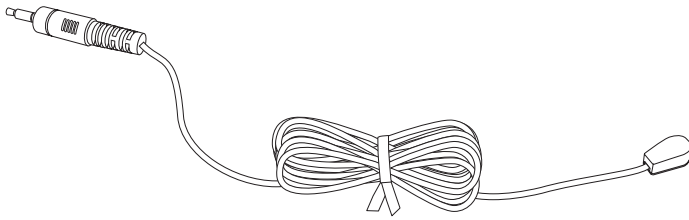

## Setting up the HP TouchSmart PC with a set-top box

### Select models only

If your TV signal requires a cable TV set-top box, a satellite set-top box, or another set-top box, you must connect the IR emitter cable to the computer and your set-top box to use the remote control properly. TV tuners and remote controls are included in select models only.

The IR emitter cable is a remote control sensing device that connects to the computer and covers the remote sensor on a set-top box. When you are selecting TV channels in Windows Media Center, it enables the remote control to work with your set-top box.

To use a set-top box with Windows Media Center:

- 1 Connect the IR emitter cable (**A**) to the IR Out connector (**D**) on the back of the computer.
- 2 Remove the paper from the backing tape on the end of the cable (**B**), and then press the end of the cable over the remote IR sensor (receiver) window on the set-top box (**C**). To locate the remote infrared sensor window, shine a flashlight through the plastic on the front of the set-top box.
- 3 When you use the remote control, point it at the front of the HP TouchSmart PC (**E**), not at the set-top box.

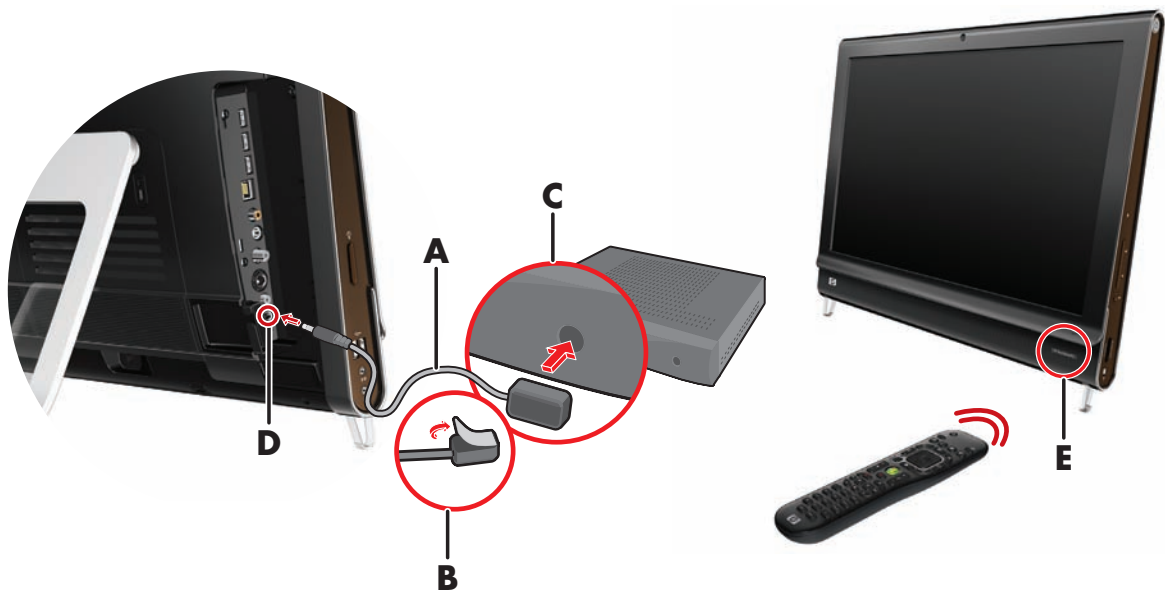

## Completing the Windows Media Center setup wizard

### Select models only

- 1 Open Windows Media Center. Tap the **Windows Vista start button** , tap **All Programs**, and then tap **Windows Media Center**.

Or

To open Windows Media Center from HP TouchSmart, open HP TouchSmart, and tap the **Windows Media Center** tile.



- 2 Scroll to the Tasks menu, and select **settings, General**, and then select **Windows Media Center Setup**.
- 3 Follow the onscreen instructions to set up your TV tuner and Windows Media Center TV program guide.

For more information about setting up and using Windows Media Center, go to:

<http://www.microsoft.com>

## Using the remote control with Windows Media Center

### Select models only

You can use the remote control within Windows Media Center to watch and record TV programs, and to perform many other activities. TV tuners and remote controls are included in select models only. Press the arrow buttons to select a shortcut, and then press the OK button to activate the selected shortcut.

To navigate within the Windows Media Center program, point the remote control at the remote control IR receiver on the lower-right side of the HP TouchSmart PC, and then press a button on the remote control.

Pressing the Power/Sleep button on the remote control turns on the HP TouchSmart PC or puts it into Sleep mode.



For more information about how to watch and record TV programs, refer to the *Watching and Recording TV* guide. To locate, tap the **Windows Vista start button**, tap **Help and Support**, and then tap **User Guides**.

# Sound Options

Your HP TouchSmart PC supports the following speaker options:

- Built-in analog stereo speakers
- Analog 2.0 or 2.1 powered speakers
- Digital 3.1, 4.1, or 5.1 powered speakers
- Audio receiver

---

## NOTES:

- The HP TouchSmart PC supports powered speaker systems only. Powered speakers require a separate power supply.
  - When the Audio Line In connector is being used, the following are affected: the output to the internal speakers, the Audio Line Out connector, and the headphones connector. For example, if you are playing sound through your internal speakers and then you connect an MP3 device through your Audio Line In connector, you will hear both sounds.
  - By default, the internal speakers are on, and the digital speakers are off.
- 

## Connecting analog speakers

For 2.0 powered speakers, connect the speaker cable to the Audio Line Out connector on the back of the computer behind the connector cover.

For 2.1 powered speakers, connect the Audio Line Out connector on the back of the computer behind the connector cover to the subwoofer, and then connect the left and right speakers to the subwoofer. Turn on the computer and then the speaker system. If necessary, refer to the documentation that came with your speakers.

---

**NOTE:** When an Audio Line Out connector (such as headphones or external speakers) are connected the internal speakers are muted.

---

## Connecting and enabling digital speakers or an audio receiver

Connect 3.1, 4.1, or 5.1 digital speakers or an audio receiver to the SPDIF Line Out (orange) connector on the back of the computer behind the connector cover, and then use the following procedure to enable the speakers or audio receiver. If necessary, refer to the instructions that came with your speakers or audio receiver.

---

**NOTE:** When SPDIF is connected, you can switch to the internal speakers without unplugging the SPDIF Line Out.

---

To enable digital speakers or an audio receiver, use the SoundMAX software that came with the computer.

- 1 Tap the **SoundMAX** icon on the taskbar.
- 2 Tap the **Volume** button.
- 3 In the *SPDIF Interface* area, select the **Default** button.

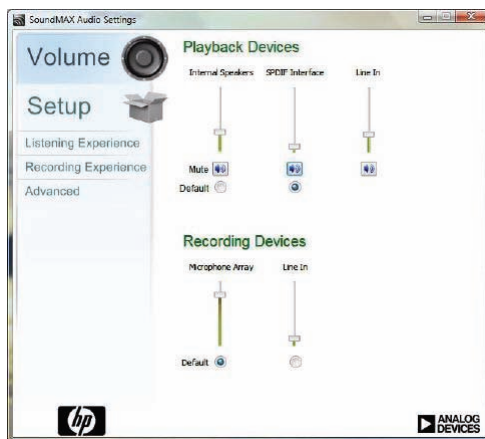

---

**NOTE:** To switch back to the internal speakers after the digital speakers are enabled, select the **Default** button in the *Internal Speakers* area. Simply turning off the external speakers does not enable the internal speakers; the internal speaker setting must be selected.

---

- 4 Configure the sound to your preferences by using the SoundMAX **Listening Experience**, **Recording Experience**, and **Advanced** buttons.

## Speaker volume

- Use the Volume buttons on the right side of the computer.



- Use the Microsoft Volume icon on the taskbar:
  - Press and hold (or with the mouse, right-click) the **Volume** icon, and then select **Open Volume Mixer**. The Volume Mixer window opens.

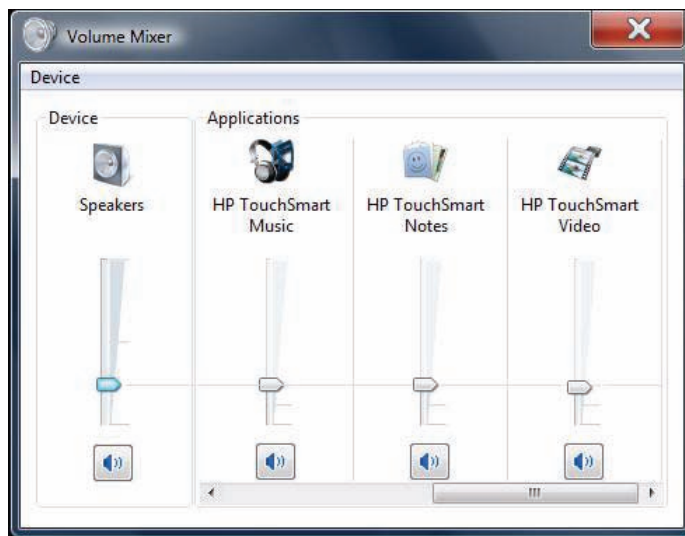

- To adjust the volume for HP TouchSmart programs (Notes, Music, and Video), be sure to adjust both the speaker volume, and the HP TouchSmart program volume. Scroll to the right in the Applications area to see all choices.
  - When you are satisfied with the sound level, tap the **Close** button (the **X** in the upper-right corner) to close this window.
- If you have digital speakers, you can also use SoundMAX to adjust the volume and perform sound balance testing:
    - Tap the **SoundMAX** icon on the taskbar.
    - Adjust the slider for the speaker setup that you have.



---

**NOTE:** You also adjust the volume for the built-in microphone array in this window.

---

## Configuring sound for Windows Media Center

After you have installed, connected, and configured the speakers, use the following procedure to configure audio output for Windows Media Center:

- 1 Tap the **Windows Vista start button**.
- 2 Tap **Windows Media Center**.
- 3 Scroll to the Tasks menu, tap **settings, General**, and then tap **Windows Media Center Setup**.
- 4 Tap **Set Up Your Speakers**, and then tap **Next**.
- 5 Select the type of cable that connects your speakers or audio receiver to your computer, and then tap **Next**.
- 6 Select the number of speakers, and then tap **Next**.
- 7 Tap **Test** to test the speakers.
- 8 Tap **Next** when the test has completed.
- 9 Tap **Finish**.

## Using headphones

You can also use your headphones (purchased separately) by connecting them to the headphones connector on the left side of the computer. When the headphones connector is being used, the internal speakers and Line Out are muted.

## Using the microphone array

Your HP TouchSmart PC comes with a built-in microphone array near the webcam on the front of the computer. The array is designed to filter out ambient noise in your environment to provide a cleaner sound. You can use the microphone from a distance of up to one-half meter (2 feet) from the HP TouchSmart PC.

To adjust the volume:

- 1 Tap the **SoundMAX** icon on the taskbar.
- 2 Adjust the slider.



## Using a headset

You cannot use a headset with two connectors (one for headphones and one for microphone). The HP TouchSmart PC does include a built-in microphone array and a headphones connector.

## Connecting MP3 players

You can connect a media player, such as an MP3 player, to the Line In connector on the left side of the computer and play it through the internal speakers or added external speakers.

# Connecting a Printer

You can connect a printer by using the USB connectors on the sides or back of the HP TouchSmart PC, or you can use a wireless printer.

---

**NOTE:** The HP TouchSmart PC does not support printers that require a parallel printer connector.

---

# Installing a Security Lock

A security lock (sold separately) enables you to secure your computer from theft and unwanted changes. A security lock is a key lock device that has a wire cable attached. You attach one end of the cable to your desk (or other stationary object) and the other to this slot on the computer. Secure the security lock with the key.

When moving the computer or opening the memory cover, you must remove the security lock from the computer.

To install a security lock:

- 1 Place the computer face-down on a soft flat surface **(A)**. HP recommends that you set down a blanket, towel, or other soft cloth to protect the touch screen surface from scratches or other damage.
- 2 Using force, lift the computer stand as far as it will go to an upright position, at least 90 degrees **(B)** from the computer, and then move the stand latch to the left until it is in the locked position **(C)**.

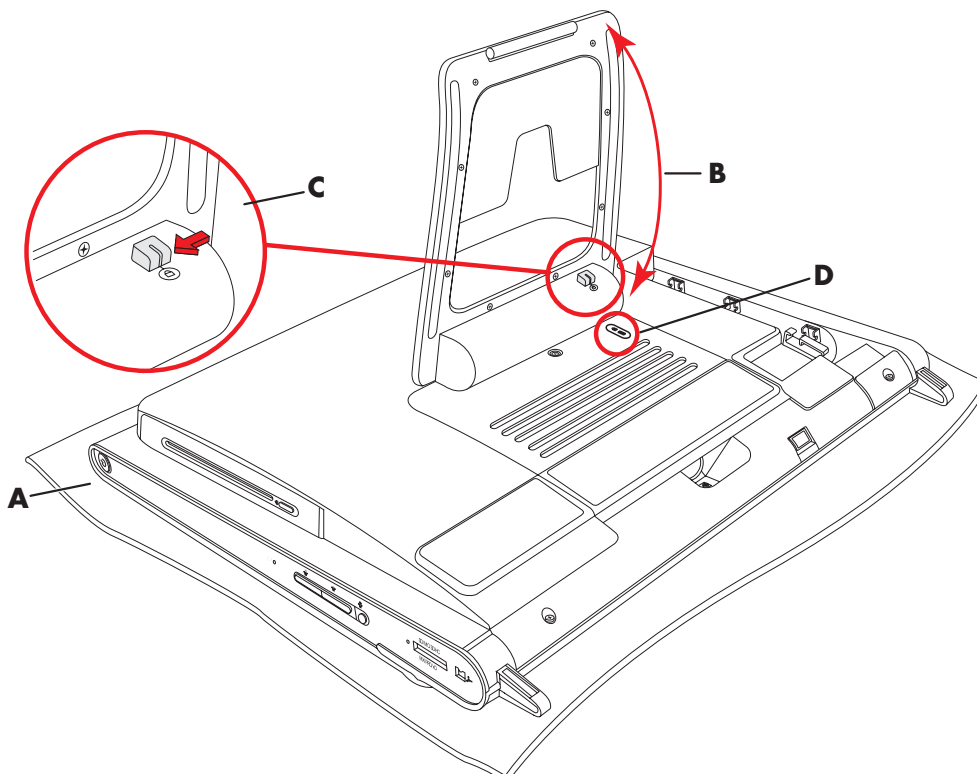

- 3 Insert your security lock into the lock slot **(D)** by following the lock manufacturer's instructions.
- 4 Move the stand slightly beyond 90 degrees and hold it with one hand while the other hand moves the lock latch on the stand to the right until it is in the unlocked position. You need to apply additional pressure to release the lock latch.



# Cleaning the HP TouchSmart PC Screen

Before cleaning the touch screen, you must disable it by turning off the computer. If the computer is not turned off, the touch screen is enabled, and you could lose data while cleaning it.

For optimal touch performance, the HP TouchSmart PC screen requires periodic cleaning to remove any particles on the sides and surface of the screen. The touch screen has a glass surface that can be cleaned by using the cleaning cloth that came with your HP TouchSmart PC. You can also use a soft cloth or paper towel dampened with a typical household glass cleaner to clean the touch screen.

To achieve the best touch sensitivity, keep the screen clean from foreign objects. Avoid excessive dust accumulation on all sides and edges of the screen.

To clean the touch screen:

- 1 Turn off the computer. Tap the **Windows Vista start button**, tap the **Arrow** button  next to the Lock icon, and then tap **Shut Down**.
- 2 Disconnect the power cord from the wall.
- 3 Spray a small amount of a mild glass cleaner onto the cleaning cloth that came with your HP TouchSmart PC. You can also use a soft cloth or paper towel dampened with a typical household glass cleaner to clean the touch screen.
- 4 Wipe the surface and each side of the touch screen to remove any dirt, fingerprints, or other debris that could hinder the touch recognition of the screen.



**CAUTION: Do not spray or place the cleaner directly on the screen; spray the cleaner into the cloth, and then wipe the sides and surface of the touch screen.**

**Do not use an abrasive cleaner or cloth when cleaning the sides or the surface of the screen, because this could cause damage to the touch screen.**



# Using the Computer with Safety and Comfort



**WARNING:** To reduce the risk of serious injury, read the *Safety & Comfort Guide*. It describes proper workstation setup, posture, and health and work habits for computer users. It also provides important electrical and mechanical safety information.

Before you begin using the computer, arrange the computer and your work area to maintain your comfort and productivity. Refer to the *Safety & Comfort Guide* for important ergonomic information:

- Tap the **Windows Vista start button**, tap **Help and Support, User Guides**, and then tap **Safety & Comfort Guide**.

Or

- Type  
<http://www.hp.com/ergo>  
into the Web browser address box, and then press the Enter key on the keyboard.

## Preparing the Computer for Shipping

In the event you need to ship the computer, use this procedure to place the computer stand in its shipping position. Never put the stand in shipping position when in use; it can tip over and cause damage.

- 1 Shut down the computer.
- 2 Remove the power cord from the back of the computer.
- 3 Remove all peripherals, discs, and cables (such as USB drives, CDs or DVDs, and security cables).
- 4 Place the computer face-down on a soft cloth.
- 5 Position yourself so you can easily reach the plastic security latch on the side of the computer stand.
- 6 With one hand on the latch and the other on the stand itself, slightly move the stand up just enough to release and pull out the latch.

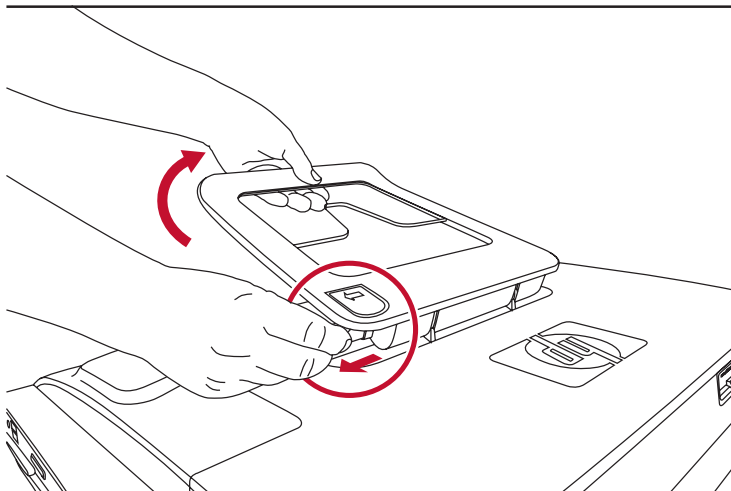

- 7 With the latch pulled out, lower the stand toward the computer.

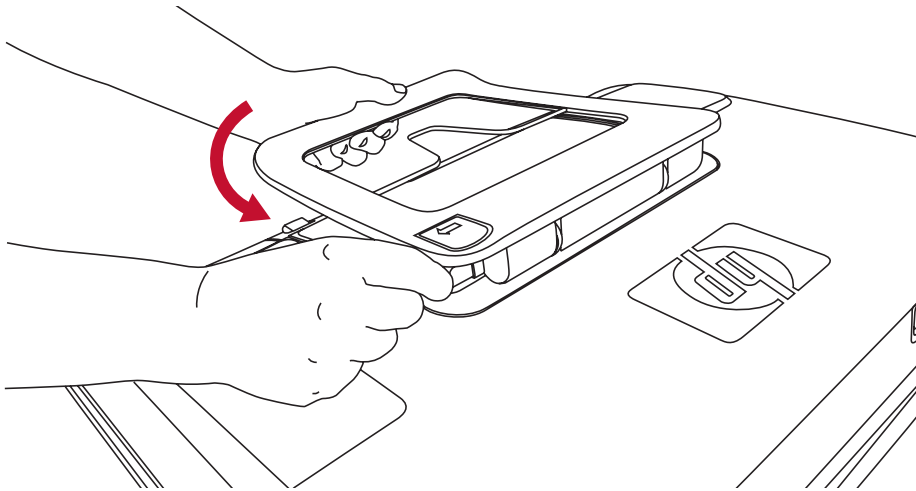

- 8 Leave the computer stand in the down position for shipping.

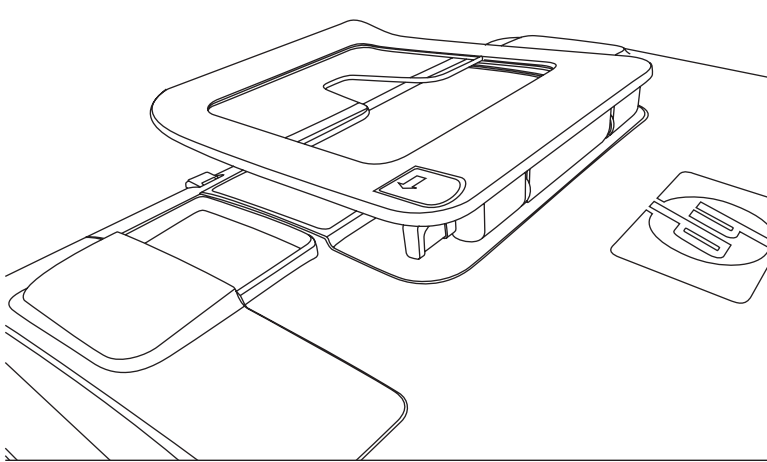

## Recycling Your Old Computer Hardware

HP offers computer equipment recycling programs in certain countries/regions. To learn about the options, go to [www.hp.com/recycle](http://www.hp.com/recycle), and select your country/region in the drop-down list.

There are also computer trade-ins and other programs for some countries/regions. Go to the following Web sites:

North America and Asia Pacific English:

[www.hp.com/hpinfo/globalcitizenship/environment/return/index.html](http://www.hp.com/hpinfo/globalcitizenship/environment/return/index.html)

Europe/Middle East/Africa (select your country/region in the drop-down list):

[h41201.www4.hp.com/tradein/welcome.asp](http://h41201.www4.hp.com/tradein/welcome.asp)

The recycling option is not available in all countries/regions.



# HP TouchSmart Software Overview

## What Is HP TouchSmart Software?

The HP TouchSmart software suite comes preinstalled on your new computer. HP TouchSmart is made to maximize the touch features on your new computer. You can personalize HP TouchSmart for quick access to your favorite online programs, the Web, and RSS feeds. From the HP TouchSmart homepage, quickly view your photos, watch videos, play music, or search the Internet with a few taps.

View the TouchSmart tutorials at [hp.com/go/learntouchsmart](http://hp.com/go/learntouchsmart) (English only); just a few minutes will help you navigate through all the software features.

## Opening HP TouchSmart Software

When you first turn on your computer, the Windows Vista desktop opens. To open the touch-friendly HP TouchSmart software, press the HP TouchSmart button on the lower right side of the computer,

Or

double-tap the **HP TouchSmart shortcut** icon on the desktop.



## Opening HP TouchSmart Automatically







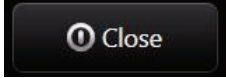

You can set up HP TouchSmart to open automatically when you start the computer.

- 1 Open HP TouchSmart and tap the **Personalize** button.
- 2 Tap the **TouchSmart Settings** button.
- 3 Place a check mark next to **Auto-Start** and **Quick-Launch**.

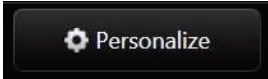
Auto-Start will start the HP TouchSmart program when you start your computer, and Quick-Launch will keep it running when you close HP TouchSmart. To free up computer resources for other uses, deselect these options.

# Navigating HP TouchSmart

Use touch or the wireless keyboard and mouse to select and deselect items in HP TouchSmart. Within HP TouchSmart, additional ways to access and navigate programs are shown here.

Action		Description
Go to HP TouchSmart homepage		Tap the <b>House</b> icon to go to the HP TouchSmart homepage.
Close HP TouchSmart		Tap the <b>Close</b> button on the HP TouchSmart homepage.
Go back to a previous window		Tap the <b>Back Arrow</b> button.
Personalize your HP TouchSmart homepage		Tap the <b>Personalize</b> button on the HP TouchSmart homepage.
Control music (Play, Pause, Skip or Back)		Tap the music controls at the top right of the window.
Go to the Windows desktop		Tap the <b>Windows Vista</b> icon in the upper-left corner to minimize HP TouchSmart and go to the Microsoft Windows desktop.
Scroll browsing		To quickly scroll left and right, or up and down, you can touch and drag your finger across the screen in the direction you want to scroll.  There must be enough items for scrolling to work. In the homepage, you need at least 5 items in the top row of tiles, and 13 items in the bottom row.
Tile View browsing		Drag your finger across the tiles to browse through them, and then tap a tile to open it.  There must be enough items for scrolling to work.
Fan View browsing		You can browse your photo, music, and video collections by using the Fan View. From the HP TouchSmart media views, tap the <b>Fan</b> icon in the bottom-right corner, drag the fan left or right, and then tap an item to open it.

## Action

Move an HP TouchSmart tile to a new location



## Description (continued)

Press and drag a tile up or down, and then left or right, to move it to a new location on the HP TouchSmart window.

Drag and drop songs to create a playlist

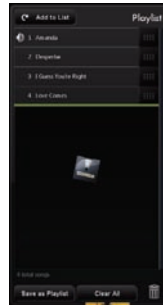

You cannot drag in a straight line to the drop location. Press and then drag an item first up or down at a right angle and then over to the playlist area. You know when the item is selected when a disc icon appears.

Scrollbar with blue light; use your finger to scroll left or right to scroll the view, or touch the scrollbar anywhere for accelerated scroll action



Use this feature toward the bottom of your screen just like a scrollbar on your Windows desktop.

Use Windows Input Panel (onscreen keyboard)

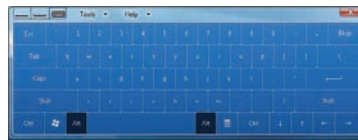

Tap inside a text box and the onscreen keyboard appears. If a pencil and pad icon appears, tap the icon. Then use the onscreen keyboard to enter text.



**CAUTION:** Because the HP TouchSmart touch screen uses a sensitive touch technology, to avoid damaging the touch screen, do not apply pressure on the front of the display bezel or around the screen borders.



**CAUTION:** To achieve the best touch sensitivity, keep the screen clean from foreign objects. Avoid excessive dust accumulation on all sides of the screen.



**CAUTION:** Like any other home electronic product, keep the HP TouchSmart PC away from liquids or a harsh environment that contains excessive dust, heat, or humidity.

# Touch Techniques for the Windows Desktop and Non-HP TouchSmart Software

To use software and navigate the Windows desktop, you can use the touch screen, keyboard, mouse, or remote control (included with select models only).

Some tasks, such as HP TouchSmart programs, browsing the Internet, or accessing your favorite programs, are better suited to the touch screen. Other tasks, such as typing search text, are better suited to the keyboard. When you use the Windows Media Center program to watch and record TV programs, the remote control is the best choice.

---

**NOTE:** Software that you purchase and install separately is accessible by the touch screen, but some programs may be easier to use with a keyboard or mouse.

---

## Tablet Input Panel (Onscreen Keyboard)

Use the Windows Input Panel (onscreen keyboard) to enter text using touch. It can also recognize your handwriting and convert it to typewritten text.

Access an Input Panel by tapping inside an input dialog, and then tapping the keypad icon to open the handwriting, touch, and text input tool. If you do not see the Input Panel or if you want to adjust your touch settings, tap the **Windows Vista start button**, tap **Control Panel, Mobile PC**, and then tap **Pen and Input Devices**. Select the setting to enable the Input Panel.

You can also tap the **Windows Vista start button, All Programs, Accessories, Tablet PC**, and then tap **Tablet PC Input Panel**.

---

**NOTE:** Handwriting recognition is not available in all languages. If your language is not available, you can use the onscreen keyboard to enter text.

---



## HP TouchSmart Tiles

When you open HP TouchSmart software, you see a row of large tiles and a row of small tiles below that. Tiles are shortcuts to either software programs, features in HP TouchSmart, or links to Web sites. Use the large tile area for programs you use often, and use the small tiles for the rest of your program shortcuts.

Move these tiles around by dragging a tile up and out of a row and dropping it to a new location. The tile appears as a transparent image as it moves. You can move the large tiles down to the small tile area or the small tiles up to the large tile area.

See the FAQ chapter for information on how to add, change, or delete tiles.



## HP TouchSmart Browser

HP TouchSmart Browser is a simple viewer for displaying live content in your HP TouchSmart homepage. Its interface is different from that of Internet Explorer<sup>®</sup>, and can be more useful. Use it in a large tile to monitor your favorite Web sites as they change content throughout the day.

The HP TouchSmart Browser supports only standard HTML pages. It does not support other display formats, such as RSS Feeds. To view RSS Feeds, use the HP TouchSmart RSS Feed tile.

If you are doing heavy Web surfing, and using sites with a lot of pop-ups, or downloading files with secondary dialog boxes, use Internet Explorer or another standard browser. Internet Explorer is a default tile in HP TouchSmart.

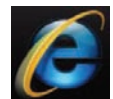

## HP TouchSmart Photo

View and edit your photos, create slideshows, and print photos with HP TouchSmart Photo. If you have an Internet connection and a Snapfish account, you can upload your photos to share with others. The Upload button in TouchSmart Photo links to the Snapfish Web site. (Snapfish is not available in some countries/regions.)

Use your thumb and forefinger to make a photo larger or smaller. Start at the center of the photo and make a spreading motion toward opposite corners to make the photo larger. To make it smaller, start with the corners and move fingers toward the center of the picture.

To rotate a photo, enlarge it by placing your thumb and forefinger at the center of the photo, and use a spreading motion. Tap the rotate arrow at the bottom of the photo. You can also use the Rotate button on the right pane. When you make a slideshow of your photos, you will want to rotate your photos to be the same orientation as all the others.

From HP TouchSmart, you can access photos stored anywhere on your hard drive.

HP TouchSmart Photo supports the .jpg file format.

## HP TouchSmart Music

HP TouchSmart Music lets you organize and play your music easily. Browse your music collection by album, artist, genre, song, or playlist. You can also play CDs, view song titles and album art, and create editable playlists.

HP TouchSmart accesses your music from the Music folder on your hard drive (you can access this folder by tapping the **Windows Vista start button**, and then **Music**). If you have downloaded iTunes and have an iTunes account (not included), the iTunes folder resides in this Music folder also.

Using the Settings button, choose to access your music from either your Music folder on your hard drive, or from your iTunes folder. You cannot view both libraries at once. The iTunes choice is disabled if you have not downloaded iTunes.

HP TouchSmart Music supports the following music file formats: .mp3, .wma, .wav, .aac, .m4p, and .m4a.

---

**NOTE:** You must install iTunes (not included) and create an account for HP TouchSmart to support .m4p and .m4a file formats.

---

## HP TouchSmart Video

With HP TouchSmart Video, make your own videos using the built-in webcam, play the videos, and then upload them to YouTube (not available in some countries/regions). YouTube requires an Internet connection.

HP TouchSmart Video also allows you to play videos from your own video camera, and upload them to YouTube or burn them onto a CD or DVD to share. You can access videos stored anywhere on your hard drive.

HP TouchSmart Video supports the following video file formats: .mpg, .mpeg, .dvr-ms, .wmv, .asf, and .avi.

## Webcam and Microphone

A built-in webcam and array microphone are located at the top of your computer. Use them to capture videos and have video chats and conference calls with instant messaging software (download the instant messaging software of your choice; it is not included with HP TouchSmart).

The optimal distance for recording with the microphone is about one-half meter (2 feet) from the computer.

## Capturing webcam video and snapshots

Use HP TouchSmart to record video and take snapshots. Use the YouTube button to upload videos. (The YouTube Web site is not available in all countries/regions. YouTube requires Internet connection, and you must set up an account.)

Outside HP TouchSmart software, you can also use CyberLink YouCam software (select models only) to capture webcam video and snapshots. CyberLink YouCam allows you to add special effects to your videos, e-mail videos to your friends, and upload your videos to YouTube.

To use CyberLink YouCam:

Tap the **Windows Vista start button, All Programs, CyberLink YouCam, CyberLink YouCam;** then tap **Tutorials**, or tap the **Help** icon (?) to access the Help menu.



## HP TouchSmart Calendar

HP TouchSmart Calendar is a calendar where you manage your (and your family's) schedule. You can view scheduled events for today and tomorrow.

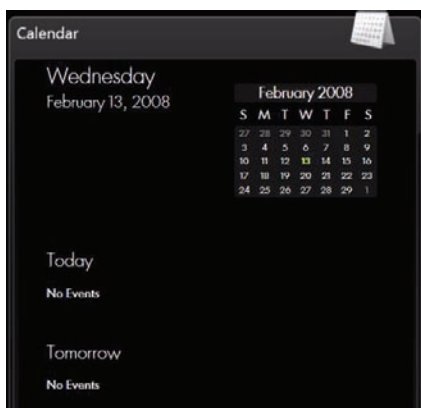

## Synchronizing Your HP TouchSmart Calendar with Windows Vista Mail Calendar

Open HP TouchSmart, and tap the **Calendar** tile. The HP TouchSmart Calendar automatically synchronizes with the calendar that is a part of Windows Vista Mail.

## HP TouchSmart Notes

With HP TouchSmart Notes, you can create text notes and voice notes using touch, the keyboard, a video, photos, or by recording your own voice. This is such a fun way to make notes to yourself or your family.

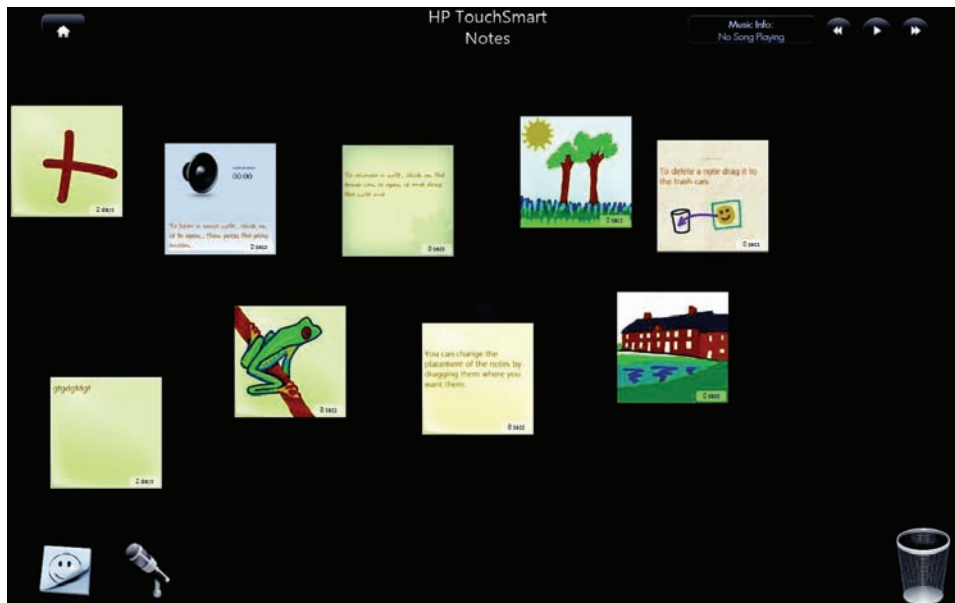

## HP TouchSmart Weather

Through the Settings button, you can set up a tile to give a two-day forecast for any city or zip code. (Not available in all countries/regions.)

## HP TouchSmart Clock

Personalize your TouchSmart clock to show the time for one, two, or three different time zones.



# Software Quick Reference Table

In addition to the HP TouchSmart software suite, you may have the following programs installed. Some of the software listed in the following table is included with select models only. This is not a complete list of all the software included with your computer.

To open any of these programs, tap the **Windows Vista start button, All Programs**, select the program folder (for example, **DVD Play**), and then tap the program name to open the software.

With this program:	You can:
DVD Play 	<ul style="list-style-type: none"><li>■ Play DVD movies, video CDs (VCDs), and Blu-ray discs.</li><li>■ Use the Zoom and Pan features.</li><li>■ Create viewing bookmarks.</li></ul>
muvee autoProducer 	<ul style="list-style-type: none"><li>■ Add your own style to your movies, with music, pictures, titles, scene transitions, and captions.</li><li>■ Edit your home movies.</li><li>■ Save and record multiple movie files to DVD.</li><li>■ Use the magicSpot feature to control the motion effects applied to your pictures.</li></ul>
CyberLink DVD Suite 	<ul style="list-style-type: none"><li>■ Includes various programs, such as: Power2Go, YouCam (select models only), LabelPrint, and PowerDirector. See the programs listed in this table for more details about the program features.</li></ul>
CyberLink Power2Go 	<ul style="list-style-type: none"><li>■ Record data and music files.</li><li>■ Record a copy of an existing music or data CD for use on your computer.</li><li>■ Create customized music CDs from CDs in your collection, or from .wav, .mp3, or .wma files. You can play these CDs on your home or car stereo.</li><li>■ Copy and share data files.</li><li>■ Create archive CDs or DVDs from files on your computer.</li><li>■ Copy video files.</li><li>■ Verify that the disc has been created without errors.</li></ul>
CyberLink YouCam (Select models only) 	<ul style="list-style-type: none"><li>■ Capture and edit webcam video and snapshots.</li><li>■ Upload your videos to YouTube. (The YouTube Web site is not available in all countries/regions).</li><li>■ Start a video chat.</li><li>■ Send your videos to friends and family.</li></ul>
CyberLink LabelPrint 	<ul style="list-style-type: none"><li>■ Print labels to attach directly to a disc.</li><li>■ Create song title inserts for your CD cases.</li></ul>

## With this program: You can: (continued)

CyberLink PowerDirector



- Record movie files to create VCDs and DVDs that you can play on some DVD players.
- Copy and share video files.
- Capture video files.
- Edit video files.

HP Total Care Advisor



- Quickly organize the Web links you want to keep available to you on your desktop.
- Comparison-shop by using the convenient shopping search engine.
- Get HP software and driver updates.
- Get important messages from HP.
- Access PC Health and Security and PC Help tools.

Microsoft Windows  
Movie Maker



- Import audio, video, and other media files from videotape, audiotape, webcams, or television broadcasts.
- Record audio and video files to create a video project that becomes a Microsoft Windows Media source file with a .wmv extension.
- Edit and preview files.
- Send a movie in an e-mail or upload it to a Web server.
- Add music files (.mp3 format).
- Import audio files such as .mp3, .asf, or .wma; video files such as .wmv, .asf, .avi, or .mpg; or image files such as .jpg or .gif.
- Create .avi and .wmv (Windows Media Video) files.

# HP TouchSmart FAQs

“How do I add tiles (shortcuts) to my HP TouchSmart homepage view?” on page 42

“How do I add a tile of a favorite Web site link?” on page 42

“How can I see all the tiles in my homepage view?” on page 43

“How do I temporarily hide a tile?” on page 43

“How do I delete a tile from the HP TouchSmart homepage?” on page 43

“How do I change the icons designating my tiles?” on page 43

“What is an RSS Feed?” on page 43

“How do I set up an RSS feed?” on page 44

“How do I get photos into my HP TouchSmart Photo library?” on page 44

“How do I create a slideshow of my photos?” on page 45

“How do I hide some of my photos?” on page 45

“How do I get my music files into HP TouchSmart Music?” on page 45

“Why can't I see all my music in HP TouchSmart Music?” on page 46

“How do I get my songs from iTunes into HP TouchSmart Music?” on page 46

“How do I find album art for my music?” on page 46

“How do I create and edit a playlist of my songs?” on page 47

“How do I delete songs?” on page 47

“How do I create (burn) a CD or DVD of my music or photos?” on page 48

“How do I make a video with HP TouchSmart?” on page 48

“How do I make a video playlist?” on page 49

“How do I transfer my videos to my computer?” on page 49

“How do I upload my videos to YouTube?” on page 49

“How do I record my home movies?” on page 49

“Where are my webcam and microphones?” on page 50

“What is the time limit of my video recordings?” on page 50

“What is the resolution of the HP TouchSmart webcam?” on page 50

“How do I make a video chat or a conference call?” on page 50

“How do I create and save a handwritten or typed note?” on page 51

“How do I create a voice note?” on page 51

“How do I delete a text or voice note?” on page 51

“How do I display the temperature and forecast for a city?” on page 52

“Can I connect an old printer to my HP TouchSmart computer?” on page 52

“How can I tell if my HP TouchSmart computer is 64-bit or 32-bit?” on page 52

“What can I do if my HP TouchSmart media programs are crashing?” on page 53

## How do I add tiles (shortcuts) to my HP TouchSmart homepage view?

- 1 Open the HP TouchSmart homepage by clicking the HP TouchSmart icon.
- 2 Tap the **Personalize** button.
- 3 Select **Add a tile**.
- 4 Select **Website**, **Program**, or **RSS Feed**, and then tap **Next**.
- 5 Enter the target address for a website, or select **Choose from a list** to show a list of all software programs in your Programs folder.
- 6 Select the software to add and then tap **OK**.
- 7 In the **Tile Name** box enter a name for the tile. Usually, the program name automatically appears.
- 8 Place a check mark in the **Icon** check box to display the program icon in the tile, and then tap **OK**. Your program shortcut appears as a small tile on the bottom of the HP TouchSmart homepage.
- 9 Tap **OK** to return to the HP TouchSmart homepage.



## How do I add a tile of a favorite Web site link?

To make your touch views more efficient, add some often-visited Web sites to either the large tile or the lower small tile area. You can also add RSS feeds after you subscribe to them from a Web site.

- 1 Open HP TouchSmart, and tap the **Personalize** button.
- 2 Select **Add a tile**.
- 3 Select **Web site**, and then tap **Next**.
- 4 Type in the URL for the Web site of your choice, starting with `www` or the equivalent (for example, `www.hp.com/go/touchsmart`). Or select **Choose** from a list to select a Web site from the list of Internet Explorer favorites.
- 5 The option to check the box to display the Web icon may be grayed out if one is not available. You can choose an icon from those displayed below the check box instead. Otherwise, it will display a sample Web page. Your Web site link appears as a small globe in the small tile area on the bottom of the HP TouchSmart homepage.
- 6 Tap **OK** to return to the HP TouchSmart homepage.
- 7 Drag it to the top row, if you want.

Your Web site link will display in the HP TouchSmart Browser.



## How can I see all the tiles in my homepage view?

To view a hidden tile:

- 1 From the HP TouchSmart homepage, tap the **Personalize** button.
- 2 In the list of tiles, tap a tile that is disabled to enable it.
- 3 Tap **OK** to save your changes and return to the HP TouchSmart homepage.  
The tile you enabled is now visible.

## How do I temporarily hide a tile?

To temporarily hide a tile:

- 1 From the HP TouchSmart homepage, tap the **Personalize** button.
- 2 In the list of tiles, tap a tile that is enabled to disable it.
- 3 Tap **OK** to save your changes and return to the HP TouchSmart homepage.  
The tile you disabled is now hidden from view.

## How do I delete a tile from the HP TouchSmart homepage?

- 1 Open HP TouchSmart, and tap the **Personalize** button.
- 2 Select the **Pencil** icon next to the shortcut you want to change.
- 3 Select **Delete the tile**, and then tap **Yes**.
- 4 Tap **OK**.



Only the shortcut is deleted from the Tile View. The program itself is not deleted.

## How do I change the icons designating my tiles?

- 1 Open HP TouchSmart, and tap the **Personalize** button.
- 2 Select the **Pencil** icon next to the shortcut you want to change.
- 3 Enter your changes:
  - In the **Enter Target Location** box, enter a URL or path, and then enter the tile name of the program or Web site by using the touch keyboard or your physical keyboard.
  - Select the program icon or browse to select another icon.
- 4 Tap **OK**.



## What is an RSS Feed?

RSS is a more efficient way of getting information from Web sites and blogs. Instead of you searching for updated news and information, it comes to you in the form of a live feed, called an RSS (really simple syndication) feed. Some RSS feeds distribute other types of digital content, including pictures, audio files, videos, or updates to view when you choose.

HP TouchSmart includes an RSS Feed Reader where you view feeds from Web sites. You can add an RSS Feed tile by adding a new tile and choosing **RSS Feed**.

## How do I set up an RSS feed?

To subscribe to an RSS feed in Internet Explorer:

- 1 Tap the **Windows Vista start button**, and then tap **Internet Explorer**.
- 2 Tap the **Feeds** button to discover feeds on the Web page.
- 3 Tap a feed.
- 4 Tap the **Subscribe to this Feed** button .
- 5 Type a name for the feed, and then select the folder where you want to create the feed.
- 6 Tap **Subscribe**.
- 7 Open HP TouchSmart, and tap the **RSS feeds** tile to view your RSS feeds.  
You might have to add a tile and choose **RSS Feed** if you do not already have an RSS tile.
- 8 Tap the feed title to display it in the RSS reader window. If you tap the arrow button on the feed window, it opens in Internet Explorer outside of HP TouchSmart. When you close the feed, the HP TouchSmart RSS feed window opens.



Keep in mind, RSS feeds do take up resources. If you are performing a task and you find you are getting a slower response from the computer, you might try turning off the RSS feeds.

## How do I get photos into my HP TouchSmart Photo library?

You can view any photos you have on your hard drive with HP TouchSmart Photos. To get photos from your camera:

- 1 Remove the memory card from your camera, and insert it into the memory card reader on the lower right side of the computer. (Alternatively, use the USB cable that came with the camera, and connect the cable to the camera and then to a USB port in the computer.)  
The HP TouchSmart view minimizes automatically and a Microsoft dialog appears.
- 2 Tap **Open folder to view files**.
- 3 Tap the **Windows Vista start button**.
- 4 Tap **Pictures**.
- 5 Use an existing folder, or create a new folder, and then with your fingertip, drag and drop the pictures you want into the folder.
- 6 Return to the HP TouchSmart view by tapping the house icon in the taskbar.
- 7 Tap **Folders** in the top menu, and select the folder you dropped your photos into.
- 8 View your photos.

To preview your photos from your camera memory card directly from the HP TouchSmart homepage (but not download them):

- 1 Tap the up arrow in the upper-left corner of the HP TouchSmart window.
- 2 Tap **Removable Disc**.
- 3 View your photos directly from the memory card.

## How do I create a slideshow of my photos?

Be sure you name your slideshow and then tap **Save**, or the slide show will not be saved. To make a slideshow:

- 1 From the HP TouchSmart homepage, tap the **Photo** tile.
- 2 Choose from where you want to create a slideshow: **Dates**, **Folders**, **All Photos**, or **Removable Drive**.
- 3 If you want specific photos in your slideshow, create a folder of those photos only.
- 4 Tap the **Play Slideshow** button.  
As you watch the slideshow, onscreen controls disappear. Tap the screen to make them reappear.
- 5 Adjust slideshow settings by tapping the **Settings** button, and select your settings.  
Examples of HP TouchSmart Photo settings include a feature that fades or moves the photo while transitioning to the next photo, and timing between photos (the default is 5 seconds).
- 6 Name the slideshow in the text box.
- 7 Tap **Save**.

## How do I hide some of my photos?

You can hide some of your photos so they do not show up in HP TouchSmart Photo.

- 1 From your Windows desktop, browse to the photo or folder you do not want to show in the Photos tile in HP TouchSmart Photo.
- 2 Right-click the photo, and click **Properties**.
- 3 Click the **General** tab, and **Attributes**, click **Hidden**.

You can still see hidden folders in Windows Vista if you want, by following this procedure:

- 1 Click the **Windows Vista start button**.
- 2 Click **Control Panel**, and then click **Appearance and Personalization**.
- 3 Click **Folder Options**.
- 4 Click the **View** tab.
- 5 Under **Advanced settings**, click **Show hidden files and folders**, and then click **OK**.

## How do I get my music files into HP TouchSmart Music?

First, put music files on your hard drive in your Music folder:

- 1 Click the **Windows Vista start button**, and click **Music**.
- 2 Navigate to the library where you want your music stored—either the **Music** folder or the **iTunes** folder within the Music folder—and open the library.
- 3 Put music into the Music folder or the iTunes folder within the Music folder in several ways:
  - Buy or download free music off the Internet
  - Transfer music from CDs you own (drag and drop, or cut and paste)
  - Transfer music from an existing library on another computer (transfer your music to an external USB drive, connect the USB drive to the computer, and then drag and drop the files into the Music folder).

Next, choose from where HP TouchSmart Music will show music files:

- 4 From the HP TouchSmart homepage, tap **Music**.
- 5 Tap **Settings**, and then tap either **Use HP TouchSmart Media library** (which is the Music folder on your hard drive) or **Use my iTunes library**.  
iTunes does not come preinstalled. You have to have access to the Internet, download and set up an account with iTunes.

You can see all files from the music folder you chose in HP TouchSmart Music.

## Why can't I see all my music in HP TouchSmart Music?

All music files that HP TouchSmart accesses must be stored in the Music folder. If you have an iTunes account (not included), the iTunes library must be located in the Music folder.

HP TouchSmart can access only one library at a time; they cannot be merged.

## How do I get my songs from iTunes into HP TouchSmart Music?

HP TouchSmart can play music from only one music library at a time. HP TouchSmart Media Library is the default library. To access songs from iTunes (not preinstalled, downloaded separately) and add them to your music library:

- 1 Download iTunes to your hard drive from **www.apple.com/downloads**
- 2 Set up an account (you must have Internet access to do so).
- 3 Open the TouchSmart Music window by tapping the **Music** tile.
- 4 Tap **Settings**, and select **Use my iTunes library**.
- 5 Tap **Save**.

## How do I find album art for my music?

Sometimes album art or other album information does not transfer during the music transfer process. In this case, you can find the missing album information. You need the Internet for this procedure.

To find album art when it is missing:

- 1 Go to the Windows desktop.
- 2 Tap (or click) the **Windows Vista start button**, tap **Windows Media library** or **iTunes**.  
The albums appear in the library.
- 3 Search for the album that did not have artwork.
- 4 Place your cursor over the blank CD and right-click.
- 5 In the pull-down menu, click **Find Album Info**.  
The application goes to the Internet to find the album.
- 6 Press **Finish** when the album is identified, and wait while the album information is downloaded (cover art, date of production, and more).

You can also create your own art:

- 1 Open the Internet to find a piece of art, or identify a piece of art you downloaded to your hard drive (right-click on the art to find options).  
You might find the artwork of the original CD cover, and choose that.
- 2 Download the art to your desktop.
- 3 Open your music folder to find the album that does not have artwork.
- 4 Drag and drop, or cut and paste, the art to the blank CD icon (the album with no cover art) in your music folder.

To find album art for music stored in the iTunes library:

- 1 Navigate to the iTunes store and sign in.
- 2 From the **Advanced** menu, select **Get Album Artwork** and follow the directions.

## How do I create and edit a playlist of my songs?

Create a playlist by simply dragging your songs to the Playlist window.

- 1 Open HP TouchSmart, and select the **Music** tile.
- 2 Select **Album**, and then select an album to add songs to your playlist.
- 3 You can drag an entire album into the playlist on the right. Or, tap on the album to open it, and then drag individual songs into the playlist.
- 4 To quickly add several selections, tap **Add to List**. Green circles with a + (plus sign) appear next to each song in song list view, and next to each album in album tile view.
- 5 Tap the + (plus sign) next to a song to add it to the playlist. Repeat until the playlist is complete.
- 6 To rearrange songs in the playlist, drag the song out of the list, and drop it into a different position.
- 7 To delete a song from the playlist, touch and drag it to the **Trash** icon.
- 8 Tap **Save as Playlist**.
- 9 Name the playlist.
- 10 Tap **Save**.

Your playlist opens. You can close it, delete it, or edit it.

---

**IMPORTANT:** Be sure you save your playlist if you want to keep it.

---

- 11 After you create a playlist and save it, you can clear the playlist window by tapping **Clear All**.

---

**NOTE:** 500 songs can be added to a playlist. If you try to add more than 500, a message appears: *Maximum number of songs in Playlist. Delete one or more items in Playlist before adding new songs.* You can either delete songs, or start another playlist.

---

## How do I delete songs?

To delete a song from your music library, go to your hard drive (from the Windows desktop), open the Music folder where you added your music, and delete it from there.

## How do I create (burn) a CD or DVD of my music or photos?

To record, or *burn*<sup>\*</sup>, a CD of your songs, you must use a CD recording program, such as CyberLink Power2Go or Windows Media Player, which you access through your Windows desktop.

To create CDs and DVDs of your music or photos using CyberLink software:

- 1 Tap the **Windows Vista start button**, tap **All Programs**, and then tap **CyberLink DVD Suite Deluxe**.
- 2 Select the type of media you are using.
- 3 Under **Select Source**, navigate to your music or photos folder (wherever you store your music or photos on your hard drive).
- 4 Add music or photos by selecting each, and then click the red **plus/add** icon to add the file.  
The file is added to the lower pane.
- 5 After you added at least one file to put on your CD or DVD, the **Burn a Disc** icon is enabled at the top icon bar. Tap that icon when you have added all the files you want.
- 6 In the dialog that opens, choose the media settings you want, and select **Burn**.  
A message appears if you have not inserted a writable disc, telling you to do so now.
- 7 Insert a CD or DVD.

The burning process starts.

## How do I make a video with HP TouchSmart?

- 1 To access the webcam, tap the **Video** tile to start.
- 2 At the bottom of the window, tap the **Webcam** button.
- 3 A viewing box opens on the screen and displays what the webcam sees; tilt the screen or move yourself to get a better view.
- 4 If you need time to set up, tap the **3 Second Delay** check box. Tap it again if you want to turn off the feature.
- 5 Tap **Record**.
- 6 When the video is finished, tap **Stop Recording**. To review the video, tap the **Play** video.
- 7 On the right of the screen, tap **Keep** or **Discard** to keep or discard the video.
- 8 If you tapped **Keep**, tap **Cancel** to exit the webcam feature.
- 9 Find your new video.  
The file name reflects the date and time of recording.
- 10 You can rename the file either in Windows Vista or in HP TouchSmart Video.

---

\* HP supports the lawful use of technology and does not endorse or encourage the use of our products for purposes other than those permitted by copyright law.

## How do I make a video playlist?

You can organize your videos by creating video playlists, much like you might with music.

---

**NOTE:** You must save your playlist if you want to keep it. Name it first, and then the **Save** button is enabled, according to this procedure.

---

- 1 From the HP TouchSmart homepage, tap the **Video** tile.
- 2 At the bottom of the screen, tap **Create Playlists**.
- 3 Open a video folder from which you want to select videos to add to the playlist.
- 4 Drag and drop each video you want into the **Create Playlist** pane, or tap on the green plus sign at the top of each video to add it.
- 5 If you want to use multiple folders from which to select videos, tap the return arrow and select another folder.
- 6 When you are done, tap the text field toward the bottom of the playlist pane to enable it.
- 7 Type a playlist name.
- 8 Tap **Save**.

## How do I transfer my videos to my computer?

HP TouchSmart Video shows videos stored anywhere on your hard drive.

- 1 Connect your camcorder to the computer by using a USB or FireWire (IEEE 1394) connector, and follow the onscreen instructions to transfer videos to your hard drive.  
Or  
Download videos from the Internet.
- 2 After you add your videos to the computer, view them in HP TouchSmart Video.

## How do I upload my videos to YouTube?

The YouTube Web site is not available in all countries/regions.

You must create an account with YouTube before you can upload your videos to YouTube (select models only). You can set up an account with YouTube from HP TouchSmart Video.

- 1 Open HP TouchSmart, and select the **Video** tile.
- 2 Select **Dates** or **Folders**.
- 3 Tap the video you want to upload to YouTube.
- 4 Tap **Upload to YouTube**.
- 5 Follow the onscreen instructions to create a YouTube account, or you can enter your name and password of an existing YouTube account.
- 6 Follow the onscreen instructions to name your video and complete the process of uploading your video to YouTube.

## How do I record my home movies?

You can use the CyberLink DVD to record videos to disc. Tap the **Windows Vista start button, All Programs, CyberLink DVD Suite**, select the **Video** icon to start the recording program, tap the **Help** menu, and then tap **Help**.

## Where are my webcam and microphones?

The webcam (**A**) and microphones (**B**) are at the top center of the computer. To adjust the viewing angle of the webcam shot, tilt the screen, or move your physical position to be in site. For optimal sound recording, you should be within one-half meter (2 feet) from the HP TouchSmart computer.

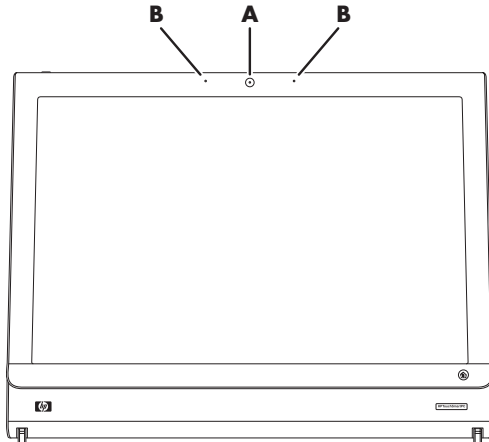

## What is the time limit of my video recordings?

The video recording time is limited to 10 minutes if you plan to upload your video to YouTube.

## What is the resolution of the HP TouchSmart webcam?

The webcam is VGA 640 x 480 resolution.

## How do I make a video chat or a conference call?

To set up a video chat, you must have a connection to the Internet, an ISP, and software that enables you to make video calls over the Internet. As with chat or instant messenger software, you can use this kind of software to chat with one or more people at a time. The software may require a separate subscription, and may not be included with HP TouchSmart.

Before you can set up a video chat:

- 1 Download and set up an account with an Internet messenger or video phone call program (or set up an account with Windows Live Messenger—MSN Hotmail, MSN Messenger, or Passport—which are included in select models of HP TouchSmart). The person you are calling must have the same video calling software.
- 2 Open your video phone calling program, for example Windows Live Messenger.
- 3 Find the **Audio and Video setup**, which is usually in the **Tools** menu (in Windows Live Messenger, find the Tools menu by clicking **Show menu**).  
The Show menu button is in the upper right corner of the window, and is a small down-arrow icon.
- 4 Click **Next** when prompted, and if you do not have external speakers, choose **SoundMAX Integrated speakers**.
- 5 Set your volume, and click **Next**.



- 6 Select your microphone; if you do not have an external microphone, choose **SoundMAX Integrated microphone**, and click **Next**.
- 7 Choose **HP Webcam** as your video, and follow the rest of the instructions.
- 8 Click **Finish**.
- 9 Open the client and follow the directions to start a video chat.

## How do I create and save a handwritten or typed note?

Written notes can be typed or handwritten by touch. Use this feature like you would sticky notes to your family or yourself.

- 1 Open HP TouchSmart, and select the **Notes** tile.
- 2 Select the **Notepad** icon at the bottom of the window.
- 3 Select a paper color by selecting the **Paper** icon on the left, and then select a font color by selecting one of the pen colors on the right.
- 4 Select a tool to enter your text and graphics:
  - Select the **Pen** icon to use your finger.
  - Select the **ABC** icon to use your keyboard, and then press the drop-down arrow to select a font.
  - Select the **Eraser** tool to erase a handwritten message and start over.
- 5 Enter your text by using the tool you selected. You can use more than one tool to create each note. For example, you can type a message and then draw something on the same note.
- 6 When you are finished, tap **Done**. Your note appears on the Notes bulletin board.



## How do I create a voice note?

- 1 Open HP TouchSmart, and select the **Notes** tile.
- 2 Select the **Microphone** icon at the bottom of the screen.
- 3 Tap the **Record** button to record a short message.
- 4 Tap the **Stop** button to stop recording your message.
- 5 Tap the **Play** button to review your message.
- 6 Tap **Keep** or **Cancel**. Tap **Done** to save the voice note.



## How do I delete a text or voice note?

To delete a note:

- 1 Open HP TouchSmart, and select the **Notes** tile.
- 2 Press and drag the note you want to delete into the Recycle Bin in the bottom right corner of the window.
- 3 Tap the **Recycle Bin** icon to open it, tap to select the items you want to delete, and then tap the **Delete Selected** button.
- 4 Tap **Done**.

To restore a note (you can do this only if you have not deleted files in the Recycle Bin):

- 1 Open the Recycle Bin.
- 2 Select the note you want to restore (by tapping it).
- 3 Tap the **Restore Selected** button.

## How do I display the temperature and forecast for a city?

- 1 From the HP TouchSmart homepage, select the **Weather** tile.
- 2 Tap the **Settings** button.
- 3 Tap in the **Set Location box**, and then use your keyboard or the onscreen keyboard to enter a city, state, ZIP, or postal code.
- 4 Tap the **Search** button. Choose the city to display in the **Select Your City** box.
- 5 Select **Fahrenheit** or **Celsius**.
- 6 Tap **OK** to confirm the settings.
- 7 Tap the **House** icon to return to the HP TouchSmart homepage.



## Can I connect an old printer to my HP TouchSmart computer?

HP TouchSmart supports USB and wireless printer connections. If your printer has a parallel port, you must buy a USB parallel printer adapter.

Also, you will need to download a printer driver that works with Windows Vista. Most HP TouchSmart computers run Windows Vista 64-bit, so make sure you get a 64-bit driver (if you have a 64-bit system).

## How can I tell if my HP TouchSmart computer is 64-bit or 32-bit?

- 1 Tap the **Windows Vista start button**, and then tap **Help and Support**.
- 2 Tap **Troubleshooting Tools**, and then tap **System Information**.
- 3 Tap **Touch here to open System Information**.

After the System Information displays, view **Operating System, Name**. It will appear as either (x86 64-bit) or (x86 32-bit).

## What can I do if my HP TouchSmart media programs are crashing?

When you are in an HP TouchSmart media program, and the application is crashing, there are a few things you can try.

---

**NOTE:** HP TouchSmart media includes the Photo, Music, and Video programs.

---

- Within HP TouchSmart software, tap **Personalize**. Turn off the application that crashes, and then turn it back on.
- If that does not work, close and restart HP TouchSmart.
- If that does not work, restart your computer.
- If that does not work, perform an application recovery. First, uninstall the program:
  - a From the Windows Vista desktop, click the **Windows Vista start button**, **Control Panel**, click **Programs**, and then click **Uninstall a program**.
  - b Select the program you are having trouble with.
  - c Click **Uninstall** in the menu above the program list.
  - d Respond to any messages that open while the software is being removed.

Next, reinstall the program:

- e From the Windows Vista desktop, click the **Windows Vista start button**, click **All Programs**, and then click **PC Help & Tools**.
- f Click **Recovery Manager**.
- g Click **Advanced Options**, and then click **Reinstall software program that came with your computer**. Click **Next**.
- h Select the program to reinstall, and click **Next**.
- i Click **Finish**.



## A

- adaptor, composite video-to-S-Video 19
- Ambient Light
  - adjusting 17
  - button 4
- Audio Line In connector 4
- Audio Line Out connector 6
- Auto-Start 31

## B

- Bluetooth
  - antenna features 2
  - using Bluetooth devices 16
- button
  - Ambient Light 4
  - computer power/sleep 3
  - DVD control 3
  - HP TouchSmart 3

## C

- cable management 8
- cable router clip 6
- calendar
  - using HP TouchSmart Calendar 37
- camera
  - position 50
- carpal tunnel syndrome 28
- CD
  - creating music CD 48
  - using the CD/DVD drive 18
- cleaning touch screen 27
- composite video adaptor 19
- computer
  - connecting the IR emitter 20
  - recycling old hardware 29
  - turning on 12
- computer stand 6
  - adjusting the angle 10
- connecting
  - TV signal 19
- CyberLink
  - LabelPrint, features 39
  - Power2Go, features 39
  - PowerDirector, features 40
  - YouCam, features 39

## D

- digital audio connector 6
- DVD drive, using 18
- DVD Play, features 39

## F

- FireWire (IEEE 1394) 3

## H

- hard disk drive
  - LED 7
- Headphones 4
- HP TouchSmart
  - adding a shortcut 42
  - adding a Web site link 42
  - cleaning touch screen 27
  - deleting a tile 43
  - finding information vi
  - navigating 32
  - opening 31
  - personalizing 35
  - start button 3
  - turning off the computer 12
  - turning on the computer 12
  - updating the computer software 17
  - upgrading the computer hardware 17
  - using the software 31
  - what is HP TouchSmart software 31
- HP TouchSmart Browser
  - using 35
- HP TouchSmart Calendar
  - synchronizing with Microsoft Windows Vista calendar 37
  - using 37
- HP TouchSmart Clock, setting 38
- HP TouchSmart Media Library 46
- HP TouchSmart Music
  - creating a playlist 47
  - using 36
- HP TouchSmart Notes
  - using 38
- HP TouchSmart Photo
  - using 36

HP TouchSmart RSS Reader  
setting up RSS feeds 44  
HP TouchSmart Video  
supported file formats 36  
using 36

## I

instant messenger, making a video call 50  
IR emitter  
cable connecting to a set-top box 20  
cable, connecting 20  
connector 6  
IR receiver, remote control 3  
iTunes, using with HP TouchSmart 46

## K

keyboard  
features 4  
receiver 6  
keyboard and mouse receiver  
LED function 7

## L

LAN (local area network) 13  
antenna features 3  
connecting to the Internet 5  
local area network (LAN) 13  
lock  
security 6

## M

memory card reader  
card types 3  
features 3  
LED 7  
microphone array 25  
adjusting volume 25  
features 3  
range 25  
microphones  
position 50  
mouse  
features 4  
receiver 6  
muvee autoProducer  
features 39

## N

network  
wired 5  
wireless 3  
note  
creating a voice note 51  
deleting a note 51

## O

onscreen keyboard, using 34

## P

playlist  
creating 47  
power adapter connector 6  
Power, LED 7  
Power/Sleep button 3

## Q

Quick-Launch 31

## R

receiver, wireless keyboard and mouse 7  
recycling old computer hardware 29  
remote control  
features 3  
IR receiver LED 7  
Power/Sleep button 21  
sensor 21  
using with HP TouchSmart 21  
repetitive strain injury (RSI), see *Safety & Comfort Guide*  
router installation 14, 15  
RSS feeds  
setting up 44

## S

*Safety & Comfort Guide* 28  
safety warnings 28  
screen brightness, adjusting 16  
security lock slot 6  
set-top box  
connecting to computer 20  
remote emitter cable for 20  
using with HP TouchSmart PC 20  
slideshow, viewing 45  
software  
updating 17  
software programs  
CyberLink DVD Suite 39  
CyberLink LabelPrint 39  
CyberLink Power2Go 39  
CyberLink PowerDirector 40  
CyberLink YouCam 39  
DVD Play 39  
HP Total Care Advisor 40  
HP TouchSmart 31  
muvee autoProducer 39  
Windows Movie Maker 40  
speakers 4  
features 4  
Stereo Audio In connector 6  
S-Video adaptor 19  
S-Video In connector 6  
synchronize  
keyboard and mouse 11

## T

- television, watch and record TV programs 18
- touch screen
  - accessing software, performing tasks, navigating the computer 34
  - cleaning 27
  - features 2
- turning on the computer 12
- TV In connector 6

## U

- USB connector 5

## V

- videos
  - setting up a video chat 50
  - uploading to YouTube 49
- voice message, creating 51
- volume
  - controls 3
  - Volume Mixer 24

## W

- webcam
  - capturing video and snapshots 37
  - features 2
  - LED 7
  - position 50
  - using with the microphone 36
  - viewing angle 50
- webcam microphones
  - position 50
- Windows Media Center
  - setup wizard 21
  - using the remote control 21
  - using to watch and record TV programs 18
- Windows Movie Maker, features 40
- wired home network
  - LAN connection 5
  - setting up 15
- wireless home network
  - LAN connection 3
  - setting up 14
- working in comfort 28

Part number: 579963-001