

HP Compaq Business Desktop dx2310/dx2318

Microtower Models Illustrated Parts Map

Intel® Core™ 2 processors, Intel Pentium® processors, or Intel Celeron® processors



System Unit

1	Front bezel (carbonite) with diskette drive bezel and 2 - 5.25" bezel. (See Miscellaneous parts for kit contents) for dx2310 MT model	480726-001
2	Front bezel (carbonite and silver) with diskette drive bezel and 2- 5.25" bezel blanks for dx2318 MT models	480727-001
3	Power supply, 250W PFC, MT	480723-001
*	Power supply, 300W PFC, MT	480724-001
4	Access panel used on Alamo, MT	480725-001
5	Chassis	not spared

* Not shown

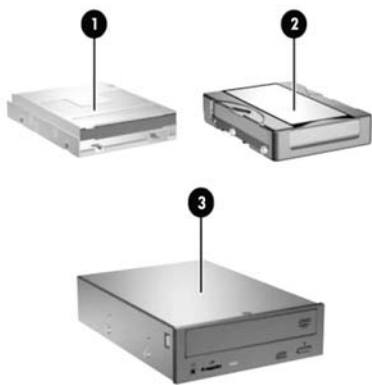

Mass Storage Device

1	Diskette drive, 3.5-inch	435420-001
2	80GB, SATA 3.0Gb	449978-001
*	160GB, SATA 3G	449979-001
*	250GB, SATA 3G	449980-001
*	500GB, SATA 3G	457909-001
3	DRV, DVDROM, SATA, 16X	419496-001
*	DRV, COMBO, SATA, ODD, 48/32	419497-001
*	DRV, ODD, SATA, 16X, LS, SM, DVDRW bPC	447310-001

* Not shown

dx2310/dx2318 © 2008 Hewlett-Packard Development Company, L.P.
HP and the HP logo are trademarks of Hewlett-Packard Development Company, L.P.

Intel and Celeron are US registered trademarks of Intel Corporation. All other product names mentioned herein may be trademarks of their respective companies.

HP shall not be liable for technical or editorial errors or omissions contained herein. The information in this document is provided "as is" without warranty of any kind and is subject to change without notice. The warranties for HP products are set forth in the express limited warranty statements accompanying such products. **Nothing herein should be construed as constituting an additional warranty**

April 2008

Document Part Number 490779 -001

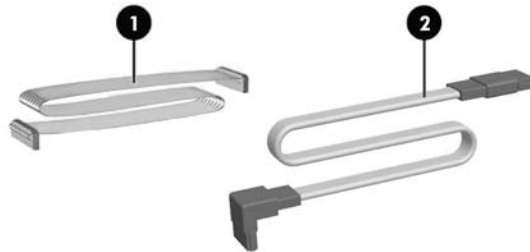

Blanks Cables

Cable kit		480731-001
1	Diskette drive cable	
2	SATAII 3G, 180mm, RoHS, .ST-ST, black	
*	SATAII 3G, 180mm, RoHS, .ST-ST, blue	
*	RJ11 cable	198220-005
*	PORT 2ND SERIAL	392414-001

Keyboards (not illustrated)

KYBD, PS/2, BASIC, VISTA		435302-xxx
*	International	-B31
*	Peoples Republic of China	-AA1
*	Taiwanese	-AB1
*	Thai	-281

KYBD USB, Basic, Vista		435382-xxx
*	International	-B31
*	Peoples Republic of China	-AA1
*	Taiwanese	-AB1
*	Thai	-281

* Not shown

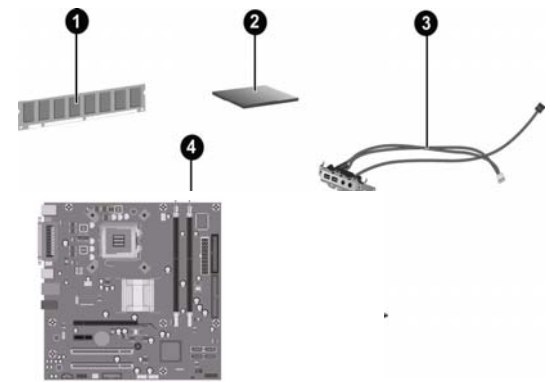

Standard and Optional Boards

Memory modules		
1	MEM DIMM 1GB PC2-6400, CL6	418951-001
*	MEM DIMM 512MB PC2-6400 CL6	418952-001
*	DIMM, MEMORY, 2GB, PC2-6400, CL6	457624-001
Intel Processors with alcohol pad and thermal grease		
*	SPS-PROC, CEL-L 420, 1.6GHZ, 512K, A-1	449164-001
*	SPS-PROC, CEL-L 430, 1.8GHZ, 512K, A-1	449165-001
2	SPS-PROC, CEL-L 440, 2.0GHZ, 512K, A-1	449166-001
*	SPS-PROC IC, Conroe-E4500, 2.2GHZ, 2M, M-0	449452-001
*	SPS-PROC, IC, uP, Conroe-E4600, 2.4GHZ, 2M, M-0	462569-001
	SPS-PROC, ICuP, WolfDale-E8400, 3.0GHZ, 6M, C0	466169-001
	SPS-PROC, ICuP, WolfDale-E8500, 3.16GHZ, 6M, C0	466170-001
	SPS-PROC, ICuP, WolfDale-E8200, 2.66GHZ, 6M, C0	466171-001
	SPS-PROC, ICuP, Yorkfld-Q9450, 2.66GHZ, 12M, C0	466173-001
	SPS-PROC Yorkfld-Q9550, 2.83GHZ, 12M, C-0	465758-001
*	SPS-PROC, IC, uP, PentiumE2160, 1.8GH, 1M, M-0	457622-001
*	SPS-PROC Pentium E2180, 2.0GHZ, 1M, M-0	457656-001
*	SPS-PROC, uP, Pentium E2200, 2.2GHZ, 1M, M-0	465216-001
*	SPS-PROC Celeron E1200, 1.6GHZ, 512K, M-0	468589-001
*	SPS-PROC Core2Duo-E4600 2.2G 800DC (C)77	466619-001
*	SPS-PROC, ICuP, Yorkfld-Q9300, 2.5GHZ, 6M, C-0	466172-001
*	SPS-PROC Pentium E2220, 2.4GHZ, 1M, M-0	480714-001
3	CA, USB, W/PCB BD, MT	480728-001
System board with alcohol and thermal grease		
4	BD, SYS dx231x	481630-001
Other boards		
*	Broadcom Gb NIC PCIe, FH	430654-001
*	Intel Gb NIC PCIe, FH	398754-001
*	MDM, PCI modem, V92, FH	398661-001
*	BD, 1394 3-PORT PCI CARD	441448-001
*	PCA, GRAF, PCIx16, DMS59, 256MB, ATIX2400	462477-001
*	CARD, GRAFX, X16, DL-DVII/TV, 256, G86	445743-001

* Not shown

Spared with alcohol wipe and thermal grease

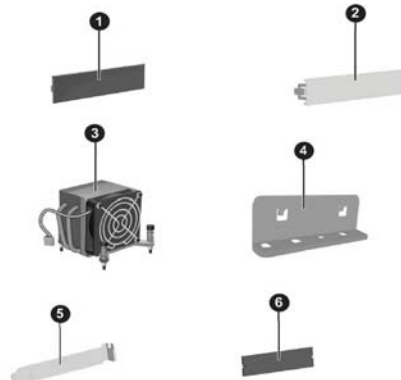

Miscellaneous Parts

Miscellaneous hardware kit. Includes:		480730-001
1	5.25" drive bezel blank without metal shield (1 ea)	
2	Diskette drive bezel without metal shield, silver (1 ea)	
*	IO SHIELD ASSY, KUNLUNSHAN (1 ea)	
*	Rubber foot (2 ea)	
3	Heatsink with alcohol pad and thermal grease	480732-001
4	Cover slot lock (1 ea)	
5	Cover slot (2 ea)	
6	3.5" diskette drive bezel without metal shield (carbonite) (1 ea)	
*	System Fan	440992-001
*	Media Card Reader	407187-001
*	USB optical mouse carbonite	390938-001
*	PS/2 scroll mouse	390937-001
*	PS/2 optical Mouse	417966-001
*	Internal speaker	480733-001
*	PWR-LED SWITCH, MT	481012-001

Miscellaneous screw kit, includes		480729-001
*	#6-32 x 0.25 lg pan head (10 ea, for power supply, cover slot lock and motherboard.)	
*	#6-32 x 0.187 lg hi top (6 ea)	
*	SCR GG M3, TT, HI/TOP, S15IPX5MM SPARE, RoHS (4 ea)	
*	SCR_6-32_T15 Lock (1 EA)	

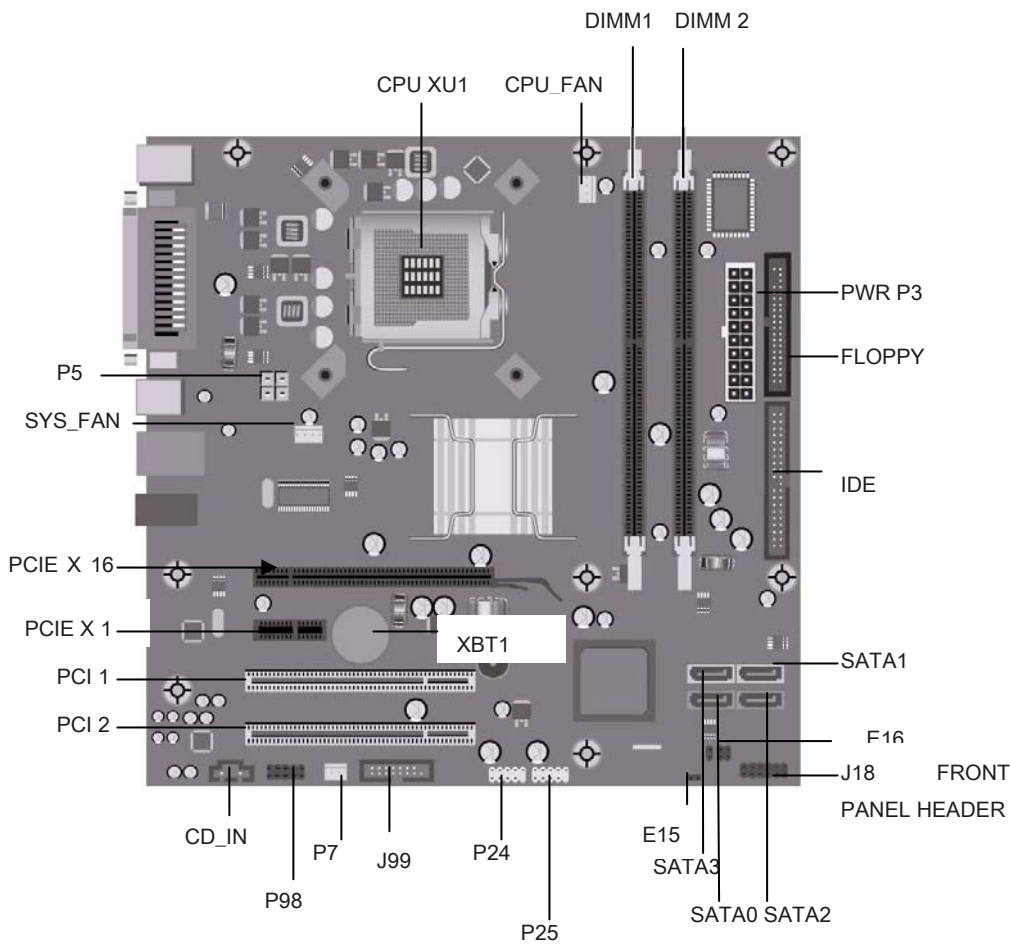

System Board Connectors and Jumpers (position of some untitled components may vary in location)

Label	Component	Label	Component
XU1	Processor socket	E15	Clear CMOS jumper
CPU_FAN	CPU fan	J18	Front panel header
DIMM1	Memory socket 1	XBT1	Real-time-clock battery
DIMM2	Memory socket 2	P98	Front audio header
IDE	IDE drive connector	CD_IN	CD in audio
FLOPPY	Diskette drive connector	PCI 1	PCI 1 connector
PWR P3	ATX main power	PCI 2	PCI 2 connector
SATA0	SATA connector 0	PCIE X 16	PCI-E X 16 connector
SATA1	SATA connector 1	PCIE X 1	PCI-E x1 connector
SATA2	SATA connector 2	SYS_FAN	System fan
SATA3	SATA connector 3	P5	CPU 4 pin power connector
P24	FRONT USB 1	J99	2 ND SERIAL PORT HEADER
P25	FRONT USB 2	P7	Internal speaker header
		E16	BOOT BLOCK HEADER

Clear CMOS*	CMOS
Clear CMOS	1-2
Normal (Default)	2-3

*: clear CMOS function only can be available when system is power off (power cord is disconnected)

System Hardware Interrupts

IRQ	System Function	IRQ	System Function
0	Host controller	10	VGA Controller
1	Keyboard	10	UHCI(D29:F3)
3	Serial port 1	10	HDA controller
4	Serial Port 2	11	LAN controller
4	Parallel Port (LPT 1)	12	Mouse
5	UHCI(D29:F2)	14	IDE Controller
6	FDC controller	15	UHCI(D29:F1)
9	UHCI(D29:F0)	15	SATA controller
9	EHCI(D29:F7)	15	SMBUS Controller
9	ACPI Controller		

Establishing a Password

1. Turn on or restart the computer. If you are in Windows, click Start > Shut Down > Restart the computer.
2. When the F10 Setup message appears in the lower-right corner of the screen, press the F10 key. Press Enter to bypass the title screen, if necessary. If you do not press F10 when prompted, a restart will be necessary.
3. Select supervisor password and press enter key, and follow the instructions on the screen. You may also want to establish the Password check at this time. This will allow you to specify when the password will be required.
4. Before exiting, click Save Settings and Exit.

Changing a Password

1. Turn on or restart the computer. If you are in Windows, click Start > Shut Down > Restart the Computer. To change the setup password, run Computer Setup.
2. When the key icon appears, type your current password, a slash (/) or alternate de-limiter character, your new password, another slash (/) or alternate delimiter character, and your new password again as shown:
current password/new password/new password.
NOTE: Type the new password carefully since the actual characters do not appear on the screen..
3. Press the enter key.
4. The new password will take effect the next time the computer is restarted.

Deleting a Password

1. Turn on or restart the computer. If you are in Windows, click Start > Shut Down > Restart the Computer. To delete the setup password, run Computer Setup (F10).
2. When the key icon appears, type your current password followed by a slash (/) or alternate delimiter character as shown. Example: currentpassword/
3. Press the Enter key.

Clearing CMOS*

The computer's configuration (CMOS) may occasionally be corrupted. If it is, it is necessary to clear the CMOS memory using by performing the following procedure::

CAUTION: The power cord must be disconnected from the power source before changing the jumper setting. (NOTE: All LEDs on the board should be OFF). Failure to do so may damage the system board

1. Turn off the computer and any external devices, then disconnect the power cord from the power outlet.
2. Remove the access panel.
3. Clear CMOS with header E17.
4. Replace the access panel.
5. Connect the power cord to the power outlet.
6. Turn on the computer, allow it to start.

NOTE: Clearing CMOS clears all passwords.

Diagnostic LEDs and Beeps

LED	Color	LED/Beep Activity	State/Message
Power	Green	On	(S0) Computer on
Power	Green	1 blink every 2 seconds	(S1) Normal Suspend Mode
Power	Green	1 blink every 2 seconds	(S3) Suspend to RAM
Power	Clear	Off	(S4) Suspend to Disk (if applicable)
Power	Clear	Off	(S5) Computer off
Power	Green	Green when flashing ROM	Boot block recovery w/Embedded Video
Power	Red	CPU Fan weak (RPM < 1000) or not turning, Display Warning message and Long Beep for 5 sec and shut down.	CPU thermal shutdown (Weak CPU fan speed or not running)
Power	Red	Power LED flashes 5 seconds every 1 second, followed by 2 seconds pause, and meanwhile, 5 beeps are heard	No memory installed / Pre-Video memory error
Power	Red	Power LED flashes 6 seconds every 1 second, followed by 2 seconds pause, and meanwhile, 6 beeps are heard	Graphics card error (Pre-Video graphics error)
Power	Red	Power LED flashes 8 seconds every 1 second, followed by 2 seconds pause, and meanwhile, 8 beeps are heard	System board failure or invalid ROM basing on checksum.
Hard Drive	Green	Blinking	Hard drive activity

Computer Setup (F10) Utility Features (not all features may be available)

System Information	System S/N Product Name Ownership TAG BIOS Version BIOS Release Date System Chipset Type Processor Type Processor Speed CPU ID	Cache Size Memory DIMM1 Memory DIMM2 DDR2 Memory Size UUID Chassis Serial Number Asset TAG Number Integrated MAC
Standard CMOS Features	System Date System Time Floppy Drive A PATA Port0 Master PATA Port0 Slave PATA Port1 Master	PATA Port1 Slave SATA Port 0 SATA Port 1 SATA Port 2 SATA Port 3 Halt On
Advanced BIOS Features	F11 Prompt Quick Power On Self Test POST Delay Time (seconds) Removable device Priority Hard Disk Boot Priority CD-ROOM Boot Priority Network Boot Priority First Boot Device Second Boot Device	Third Boot Device Fourth Boot Device Boot Other Device Load Boot Menu Selectable APIC Mode Hyper-Threading Technology System Keyboard Option ROM select Security Option
Advanced Chipset Features	On-Chip Frame Buffer Size Disable MCHBAR MMIO PEG/Onchip VGA control DVMT Mod	DVMT/Fixed Memory Size Init Display First Spread Spectrum
Integrated Peripherals	USB Controller USB Legacy support Azalia/AC97 Audio Select Onboard Lan Controller Onboard Lan Boot ROM Onboard FDC Controller Serial Port 1 Serial Port 2	Parallel Port Parallel Port Mode ECP Mode Use DMA On-Chip Serial ATA SATA PORT Speed Settings PATA IDE Mode SATA Port
Power Management Setup	PCI-E Wake on PME ACPI Function ACPI Suspend Type Resume On PME Resume On Ring Resume by Alarm Date(of Month) Alarm	Resume Time(hh:mm:ss) Alarm HPET Support HPET Mode WDRT Support WDRT Run/Stop WDRT Count Restore on AC/Power Loss
PnP/PCI Configurations	Reset Configuration Data Resources Controlled By	IRQ Resources
Hardware Monitor Setup	FAN Controller System Temperature CPU Fan Speed	System Fan Speed CPU Fan Fault Detect SYS Fan Fault Detect
Load Defaults Setting		
Set Supervisor Password		
Set User Password		
Save Setting and Exit		
Exit Without Saving		

Note: See Computer Setup (F10) Utility Guide on the Library CD.