

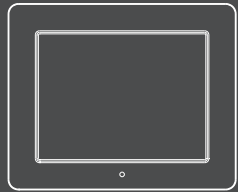

Quick Start Guide

What's inside the box...



Digital Picture Frame

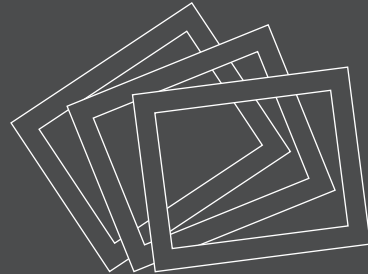

Three Interchangeable Mats



Remote Control

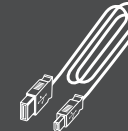

USB Cable

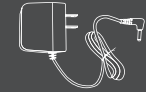

Power Adapter



DOC Letter



Warranty Card



User Manual

Getting Started

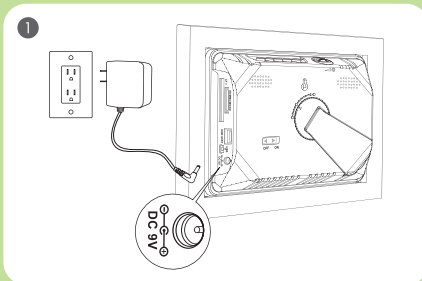

1 Connect the power adapter

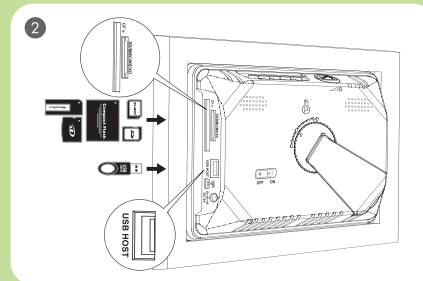

2 Insert memory card or USB storage device (external)

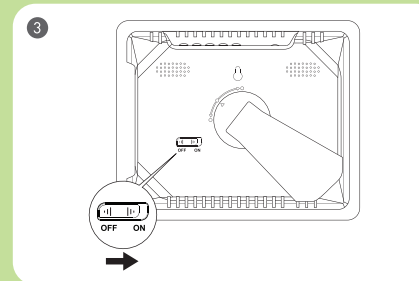

3 Move the power switch to the ON position

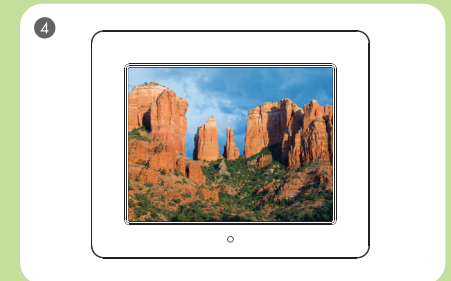

4 Enjoy! A slideshow of your pictures will begin in a few seconds

How to Change the Mat

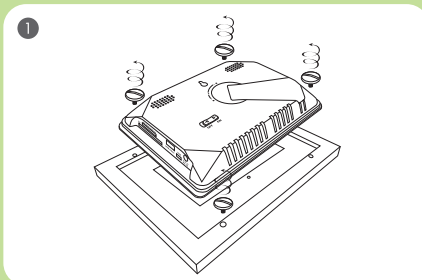

1 Place frame face down on table. Remove the four screws and lift up the digital picture frame.
Note: use caution when handling glass panel to avoid possible breakage.

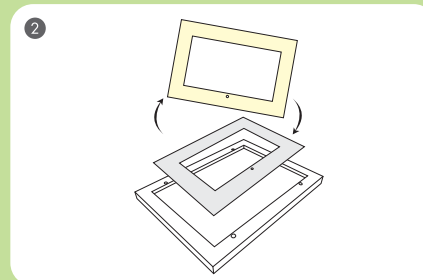

2 Replace the mat with different color mat to match your décor.

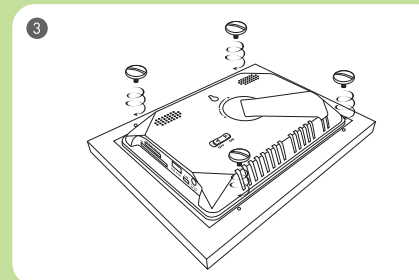

3 Put all the screws back and make sure the digital picture frame is firmly fastened.

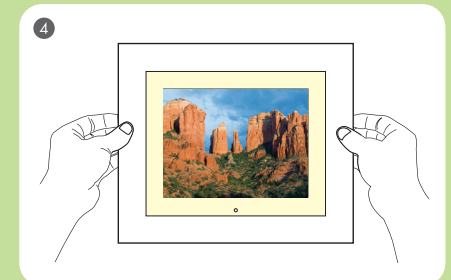

4 Enjoy the new look.