



### Identifying accessory kit contents

In addition to the documentation CD, which contains this guide, the following items are included in the headphone accessory kit:

- 1 Headphones
- 2 HP Bluetooth adapter (provided with select models only)
- 3 Travel pouch
- 4 Dual-head USB charging cable
- 5 Audio line-in cable
- 6 AC adapter (provided with select models only)

### Identifying accessory kit contents IS

In addition to the documentation CD, which contains this guide, the following items are included in the headphone accessory kit:

- 1 Headphones
- 2 HP Bluetooth adapter (provided with select models only)
- 3 Travel pouch
- 4 Dual-head USB charging cable
- 5 Audio line-in cable
- 6 AC adapter (provided with select models only)

### Identifying accessory kit contents FR

In addition to the documentation CD, which contains this guide, the following items are included in the headphone accessory kit:

- 1 Headphones
- 2 HP Bluetooth adapter (provided with select models only)
- 3 Travel pouch
- 4 Dual-head USB charging cable
- 5 Audio line-in cable
- 6 AC adapter (provided with select models only)



### Left-side components

- 1 Bluetooth switch
- 2 Charging light
- 3 Audio-out (headphone) jack
- 4 Active Noise cancellation switch

### Left-side components IS

- 1 Bluetooth switch
- 2 Charging light
- 3 Audio-out (headphone) jack
- 4 Active Noise cancellation switch

### Left-side components FR

- 1 Bluetooth switch
- 2 Charging light
- 3 Audio-out (headphone) jack
- 4 Active Noise cancellation switch

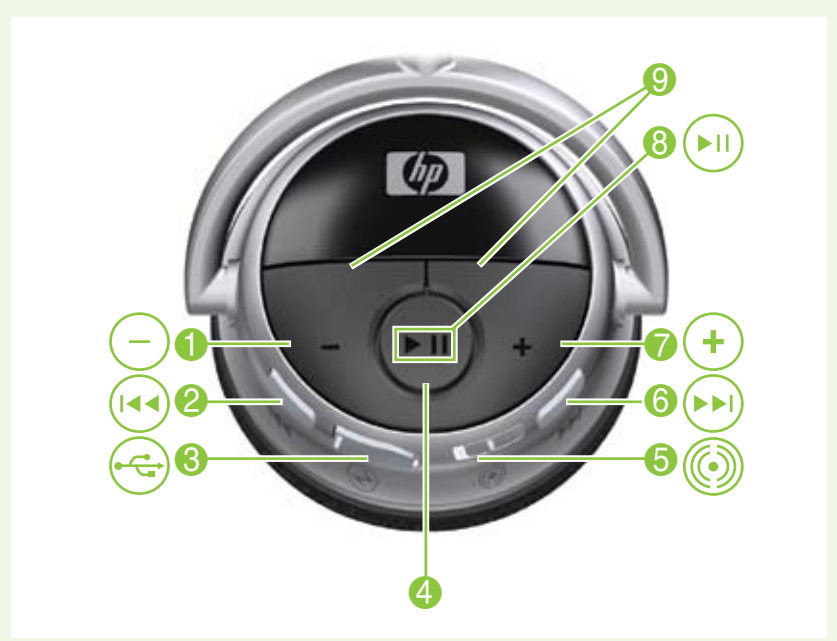

### Right-side components

- 1 Volume down button
  - 2 Previous/rewind button
  - 3 Mini-USB port
  - 4 Headphone status light
  - 5 Pairing switch
  - 6 Next/fast forward button
  - 7 Volume up button
  - 8 Play/pause button
  - 9 SRS WOW Audio Technology on/off buttons
- NOTE:** SRS WOW Audio Technology is available only when the headphones are used with a wireless Bluetooth connection.

### Right-side components IS

- 1 Volume down button
  - 2 Previous/rewind button
  - 3 Mini-USB port
  - 4 Headphone status light
  - 5 Pairing switch
  - 6 Next/fast forward button
  - 7 Volume up button
  - 8 Play/pause button
  - 9 SRS WOW Audio Technology on/off buttons
- NOTE:** SRS WOW Audio Technology is available only when the headphones are used with a wireless Bluetooth connection.

### Right-side components FR

- 1 Volume down button
  - 2 Previous/rewind button
  - 3 Mini-USB port
  - 4 Headphone status light
  - 5 Pairing switch
  - 6 Next/fast forward button
  - 7 Volume up button
  - 8 Play/pause button
  - 9 SRS WOW Audio Technology on/off buttons
- NOTE:** SRS WOW Audio Technology is available only when the headphones are used with a wireless Bluetooth connection.

## Step 1

### Charging the headphones and Bluetooth adapter (select models only)

Before you can use the headphones with the provided Bluetooth adapter (select models only), you must charge both the headphones and the Bluetooth adapter. The headphones can be charged from the USB port on your computer or the provided AC adapter (select models only).

To charge the headphones, complete the following steps:

**CAUTION:** When removing the USB charging cable from a device, prevent damage to cable connectors by grasping each connector and then pulling gently. Do not pull on the cable to remove it from the device.

1. Be sure that the Bluetooth switch and the noise cancellation switch are in the off position, with no red indicator visible at the open end of the switch.
2. Plug one of the two Mini-USB connectors into the Mini-USB port on the headphones. The charging light will turn on while the headphones are charging.
3. Plug the other Mini-USB connector into the Mini-USB port on the Bluetooth adapter. The Bluetooth light will turn on while the adapter is charging.
4. Plug the USB connector into the USB port on the AC adapter or computer.



5. If you are using the AC adapter, plug the AC adapter into an AC outlet.

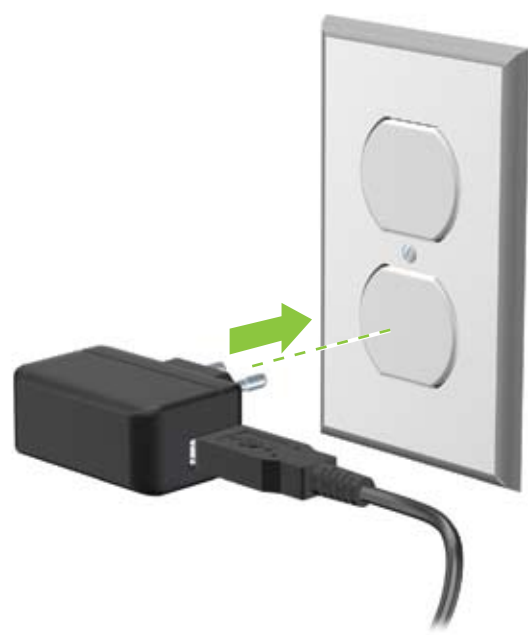

**WARNING!** To reduce the risk of electric shock or damage to the equipment, plug the AC adapter into an AC outlet that is easily accessible at all times.

The charging light on the left ear cup and on the Bluetooth adapter will turn on while the devices are charging and will turn off upon full charge. After the charging lights turn off, the headphones and Bluetooth adapter are fully charged and ready to use.

While the headphones and Bluetooth adapter are charging through the USB port on your computer, you can use the audio line-in cable with the headphones to listen to computer audio.

For instructions on using the headphones this way, see the Chapter 4, "Using the headphones with the audio line-in cable."

**NOTE:** For safety and regulatory information, refer to the Regulatory, Safety and Environmental Notices.

## Step 2

### Using the headphones with the audioline-in cable

To use the headphones with the audio line-in cable, follow these steps:

1. Make sure that the Bluetooth switch and the noise cancellation switch are in the off position, with no red indicator visible at the open end of the switch.
2. Plug one end of the audio line-in cable into the audio-out (headphone) jack on the left ear cup.



3. Plug the other end of the audio line-in cable into the audio-out (headphone) jack of your audio device, such as a computer, mobile phone, or MP3 player.

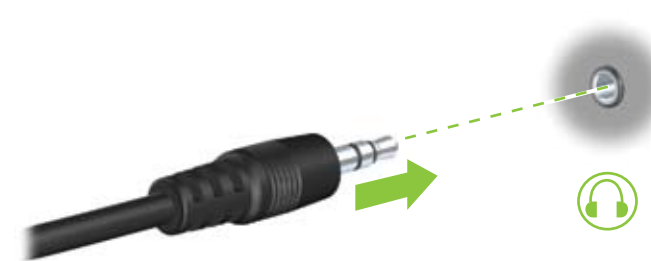

4. Open your media player software, if necessary. You can begin listening to music or watching a video.

## Step 3

### Using the headphones with the enclosed Bluetooth adapter (provided with select models only)

Before using the headphones, be sure that the headphones and provided Bluetooth adapter (select models only) are charged.

To use the headphones with the Bluetooth adapter, follow these steps:

1. Slide the Bluetooth switch located on the left ear cup to turn on the headphones and activate Bluetooth. A red indicator is visible, indicating that the headphones are turned on.



2. When the headphones and Bluetooth adapter are being used for the first time, slide the pairing switch to turn on pairing. In subsequent uses, pairing does not need to be turned on.



3. Plug the Bluetooth adapter into the audio-out (headphone) jack of your audio device, such as a computer, mobile phone, or MP3 player.
4. Slide the power switch to turn on the Bluetooth adapter. A red indicator is visible when the Bluetooth adapter is turned on.
5. Slide the Pairing switch to make the adapter discoverable by your headphones. The Bluetooth light turns on to indicate that the adapter is in Pairing mode.

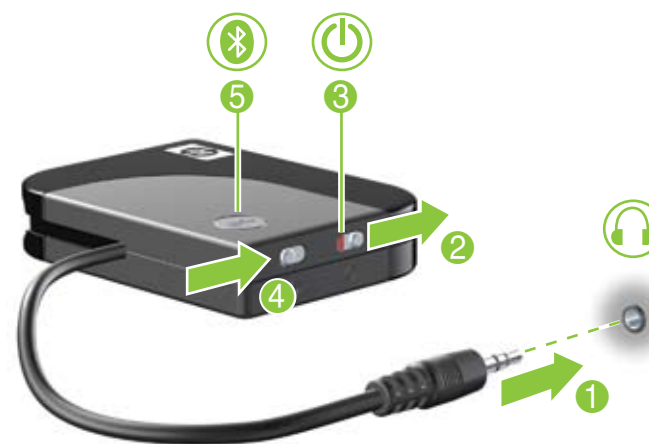

You are now ready to use the headphones. Open your media player software and begin listening to music, or watching a video.

## Step 4

### Using the headphones with a Bluetooth-enabled computer

**NOTE:** To determine whether your computer is Bluetooth-enabled, look for the Bluetooth icon in the notification area at the far right of the taskbar on the computer screen.

Before using the headphones, be sure that the following conditions are met:

- The headphones are charged.
- Your computer battery is fully charged.
- Your computer is turned on.
- Your computer is a Bluetooth-enabled device.

Before you can use the headphones, you must establish a Bluetooth wireless connection with your computer, a process called *pairing*. Choose one of the following two sections, depending on the operating system on your computer, and follow the steps.

#### Pairing using Windows Vista

**NOTE:** Be sure that the computer Bluetooth device is on and enabled. For more information, select **Start > Help and Support > User Guides**.

To pair the headphones using Windows Vista®, follow these steps:

1. Slide the Bluetooth switch located on the left ear cup to turn on the headphones and activate Bluetooth. A red indicator is visible indicating that the headphones are on.



2. Slide the pairing switch on the right ear cup of the headphones to make the headphones discoverable by your computer.



3. Select **Start > Control Panel > Hardware and Sound > Bluetooth Devices**. The Add Bluetooth Device Wizard opens.
4. On the **Devices** tab, click **Add**.
5. Click **My device is set up and ready to be found**, and then click **Next**.
6. When the headphones icon is displayed on the screen, click **HP Bluetooth Audio Enthusiast Headphone**, and then click **Next**.
7. Click **Don't use a passkey**, and then click **Next**.
8. When the Add Bluetooth Device Wizard completes connecting the headphones, click **Finish** to close the wizard.

The headphones are now ready for use.

#### Pairing using Windows XP

**NOTE:** Be sure that the computer Bluetooth device is on and enabled. For more information, select **Start > Help and Support > User Guides**.

To pair the headphones using Windows® XP, follow these steps:

1. Slide the Bluetooth switch located on the left ear cup to turn on the headphones and activate Bluetooth. A red indicator is visible indicating that the headphones are on.



2. Slide the pairing switch on the right ear cup of the headphones to make the headphones discoverable by your computer.



3. Open the Bluetooth Devices dialog box by completing either of the following steps:
  - Double-click the Bluetooth icon in the notification area, at the far right of the taskbar on the computer screen.
  - or–
  - Select **Start > Control Panel > Bluetooth Devices**.
4. Under **Bluetooth Places**, click **View Devices in Range** in the Bluetooth Tasks section.
5. Right-click the **HP Bluetooth Audio Enthusiast Headphone** icon.
6. Click **Pair** to pair the device.
7. Type **0000** as the code to pair the device.
8. Right-click the **HP Bluetooth Audio Enthusiast Headphone** icon.
9. Click **Connect**.

The headphones are now ready for use.

