

Fig1

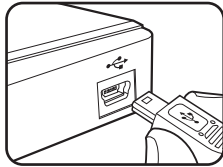

Fig2

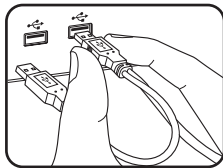

Fig3

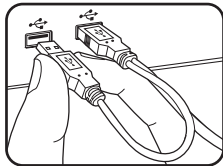

Fig4

### Hardware Installation:

1. Power on your computer. (See Fig1)
2. Connect the mini-B USB connector of the DATA cable to the back of the drive. (See Fig2)
3. Connect the Type-A connector on the DATA cable to one of your PC's USB ports. (See Fig3)
4. Your computer should automatically detect the new drive and install the driver for it, then display the message: "Your new hardware is installed and ready to use".

- This drive is designed to operate with power from just one USB port. However, computer configurations can vary, so if the drive is not getting enough power, you can always connect the auxiliary power plug into a second USB port to boost the power. (see fig4)

### Software Installation:

1. Insert the software installation disc which comes with the original package.
2. The installation user interface should automatically launch. Once displayed, follow the on-screen guidance to complete the installation.
3. If the installation interface did not automatically launch, please click on "My Computer", double click on the CD/DVD drive icon and select "setupX" to manually start the installation process.
4. The detailed user's manual for the drive can be found on the software installation disc under the manual folder.