



LASERJET PRO 200 COLOR MFP M275nw



Clear jams

Jam locations

Jams can occur in these locations:

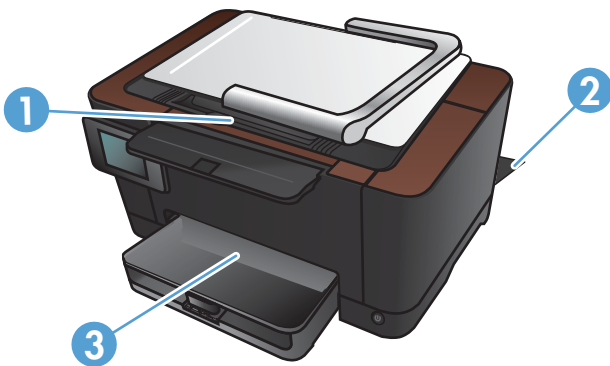

1	Output bin
2	Rear door
3	Input tray

Loose toner might remain in the product after a jam. This problem typically resolves itself after a few sheets have been printed.

Clear jams from the input tray

1. Remove the paper from the input tray.



2. With both hands, grasp the paper, and carefully pull it free from the product.

NOTE: If the sheet tears, remove all fragments before continuing. Do not use sharp objects to remove fragments.

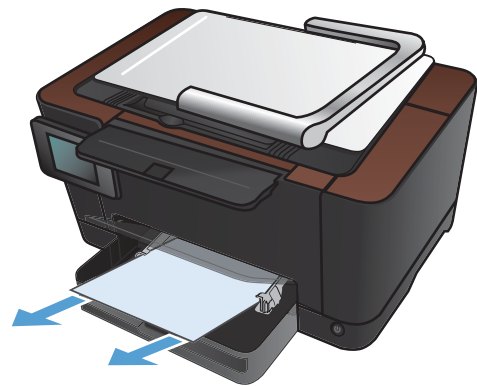

3. Raise the camera arm to the fully open position.



4. Remove the capture stage and set it aside.

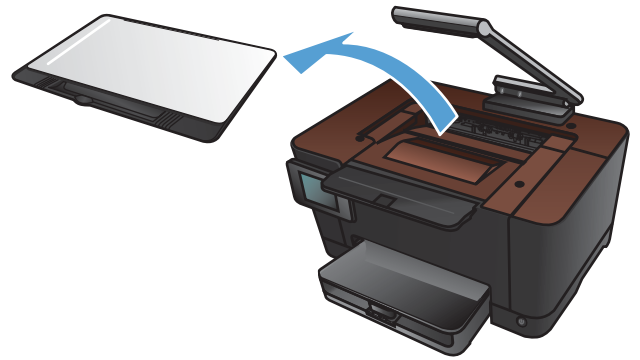

5. Open and close the print cartridge door to reset the product.

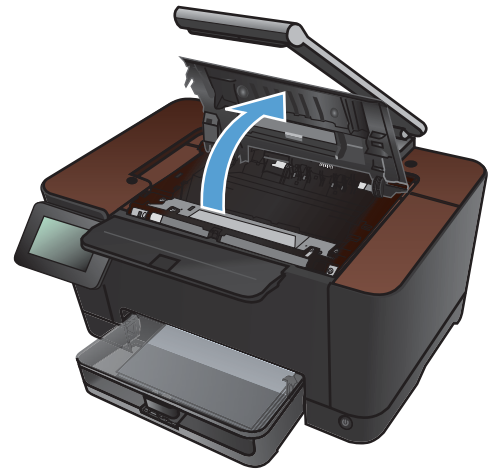

6. Reinstall the capture stage.

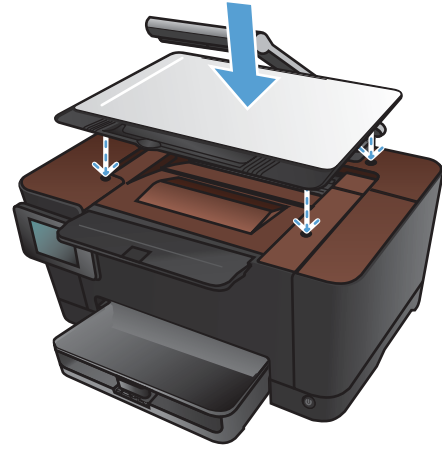

7. Lower the camera arm.

NOTE: Lower the camera arm to protect the camera lens cover from damage.



Clear jams from the output bin

1. Raise the camera arm to the fully open position.



2. Remove the capture stage and set it aside.

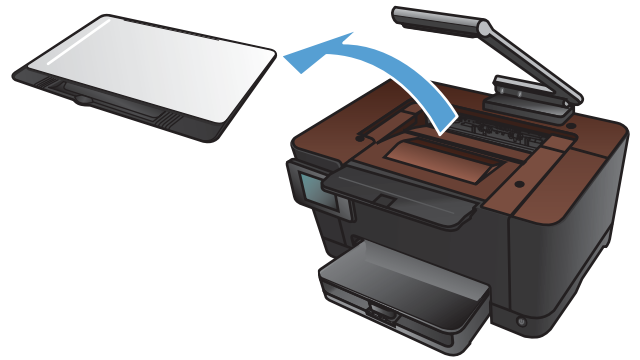

3. With both hands, grasp the paper, and carefully pull it free from the product.

NOTE: If the sheet tears, remove all fragments before continuing. Do not use sharp objects to remove fragments.



4. Reinstall the capture stage.

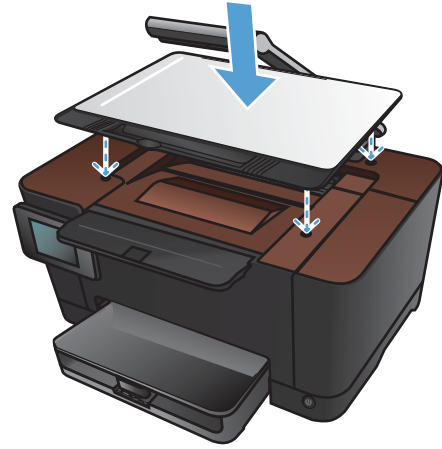

5. Lower the camera arm.

NOTE: Lower the camera arm to protect the camera lens cover from damage.



Clear jams from the rear door

1. Open the rear door.

CAUTION: The fuser is located above the rear door, and it is hot. Do not attempt to reach into the area above the rear door until the fuser is cool.

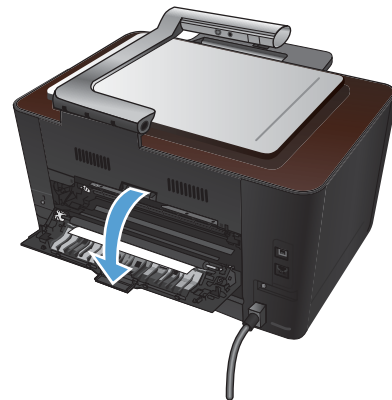

2. With both hands, grasp the paper, and carefully pull it free from the product.

NOTE: If the sheet tears, remove all fragments before continuing. Do not use sharp objects to remove fragments.

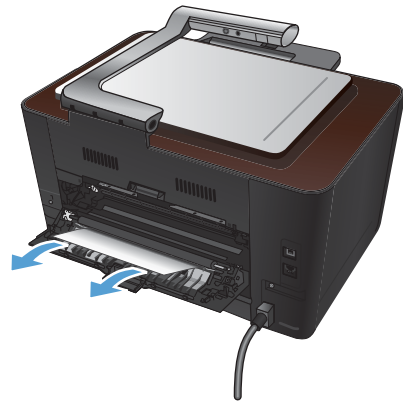

3. Close the rear door.

