



LaserJet Pro P1100 series 入门指南 Getting Started Guide

ZHCN

4. 在控制面板上进行初始设置.....	2
5. 选择一种连接方式并准备安装软件	2
6. 找到或下载软件安装文件	2
7. 安装软件	3
8. 移动和无线打印（可选）	3
9. 设置通过电子邮件的 HP ePrint（可选）	4
故障排除	4

EN

4. Initial setup at the control panel	5
5. Select a connection method and prepare for software installation.....	5
6. Locate or download the software installation files	6
7. Install the software.....	6
8. Mobile and wireless printing (optional)	6
9. Set up HP ePrint via email (optional)	7
Troubleshooting	7

! 重要信息:

执行打印机硬件设置海报上的**步骤 1-3**，然后执行下一页上的**步骤 4**。

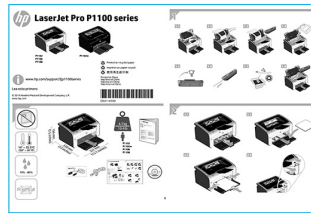

4. 在控制面板上进行初始设置

在打印机控制面板上，检查 LED 指示灯状态，然后再开始安装软件。

5. 选择一种连接方式并准备安装软件

USB 直接连接打印机和计算机

请使用 A 接 B 型的 USB 电缆。

Windows

1. 对于 Windows 7 或更低版本，安装软件之前请勿连接 USB 电缆。安装过程将适时提示连接电缆。如果已连接电缆，则安装过程提示连接电缆时，重新启动打印机。
2. 继续执行“6. 找到或下载软件安装文件。”

 注：在安装软件期间，选择“使用 USB 电缆直接连接此计算机”选项。

Mac

1. 在安装软件之前，使用 USB 电缆连接计算机和打印机。
2. 继续执行“6. 找到或下载软件安装文件。”

执行无线安装（仅限无线型号）

在开始安装之前，确认无线接入点正常工作。确保打印机、路由器和计算机全部打开电源，并且计算机与打印机连接到同一无线网络。

如果打印机顶部的蓝色指示灯不常亮，则转至过程 A。

如果打印机顶部的蓝色指示灯常亮，则转至过程 B。

过程 A

1. 将 CD 放入 CD-ROM 驱动器，然后单击“安装”。显示“打印机连接”对话框时，选择“配置为通过无线网络进行打印”。
2. 按照屏幕上的说明进行操作。

过程 B

1. 将 CD 放入 CD-ROM 驱动器，然后单击“安装”。显示“打印机连接”对话框时，选择“连接到已配置的无线网络打印机”。
2. 按照屏幕上的说明进行操作。
3. 选择软件检测到的打印机。如果安装程序检测不到打印机，则手动输入打印机的 IP 地址以继续安装。

 注：打印配置页以查找打印机的 IP 地址。在打印机控制面板上，按住“取消”×按钮 5 秒，然后松开“取消”×按钮以打印配置页。配置页上的“网络信息”部分中列出该 IP 地址。

手动配置 IP 地址

有关如何手动配置 IP 地址的信息，请参阅打印机《用户指南》，网址为 www.hp.com/support/ljp1100series。

6. 找到或下载软件安装文件

从打印机 CD 安装

对于 Windows，在打印机附带的 CD 上提供软件安装文件。

对于 OS X，CD 上的安装程序文件含有 DMG 文件。

安装说明

有关打印机软件的更多详细信息，请参阅打印机 CD 上的安装说明文件。

从 Web 下载

1. 访问 www.hp.com/support/ljp1100series。
2. 从列表中选择打印机或类别，然后单击“驱动程序”。
3. 从下拉列表中选择操作系统，然后单击“下一步”。
4. 依次单击“驱动程序”、“下载”。
5. 按照屏幕上的说明进行操作。

7. 安装软件

Windows 完整解决方案

1. 将软件 CD 插入计算机的 CD 托盘中。
2. 按照屏幕上的说明进行操作。提示选择连接类型时，选择相应的选项：
 - 配置为通过无线网络进行打印
 - 配置为使用 USB 进行打印**注意：**直到安装程序出现提示，再连接 USB 电缆。
- 连接到已配置的无线网络打印机

仅限无线型号

3. 安装完毕后，打印配置页以确保打印机具有 SSID 名称。（按住“取消”(X)按钮，直至“就绪”指示灯闪烁，然后松开该按钮以打印配置页。）
4. 安装完毕后，拔下 USB 电缆。要从手机或平板电脑进行打印，请将设备与打印机连接到同一无线网络。

Windows 基本安装

1. 打开打印机电源。
2. 从打印机和计算机上拔下 USB 电缆（如果已连接它）。如果打印机连接到您的网络，则保持连接即可。
3. 访问 www.hp.com/support/lj1100series。
4. 从列表中选择打印机或类别，单击“驱动程序”，然后下载适用于打印机的安装软件。

OS X 完整解决方案

1. 启动从 Web 下载的软件安装 .dmg 文件。
2. 软件安装程序检测操作系统语言，然后以相同语言显示安装程序的主菜单。
3. “安装选项”屏幕详细介绍要安装的软件。单击“安装”按钮。
4. 按照屏幕上的说明安装软件。
5. 在安装软件过程结束时，使用 **HP Utility** 设置助手配置打印机选项。

OS X 基本安装

要安装基本打印驱动程序，但不运行 CD 上或从 hp.com 下载的 HP 完整解决方案软件，请执行以下步骤：

1. 将打印机连接到计算机或网络。
2. 从“系统偏好设置”中，单击“打印机与扫描仪”。
3. 单击左下角的加号 [+] 按钮，然后选择 **P1100**，并使用名为“AirPrint”或“HP 打印机”的驱动程序。

8. 移动和无线打印（可选）

8.1 将设备连接到无线网络

要从手机或平板电脑进行打印，请将设备与打印机连接到同一无线网络。

Apple iOS 设备 (AirPrint) 打开要打印的项，然后选择“操作”按钮。依次选择“打印”、本打印机、“打印”。

较新的 Android 设备（4.4 或更高版本） 打开要打印的项，然后选择“菜单”按钮。依次选择“打印”、本打印机、“打印”。

某些设备需要从 Google Play 商店下载“HP Print Service 插件”应用程序。

较早的 Android 设备（4.3 或更低版本） 从 Google Play 商店下载“HP ePrint”应用程序。

Windows Phone 从 Windows 应用商店下载“HP AiO Remote”应用程序。

详细了解移动打印

要详细了解其他移动打印选项（包括其他 ePrint 解决方案），请扫描二维码或参阅《用户指南》的“移动打印”一节。



8.2 HP Wireless Direct（仅限无线型号）

通过 HP Wireless Direct，智能手机、平板电脑或计算机等支持 Wi-Fi 的设备可直接与打印机建立无线网络连接，而不必使用无线路由器或接入点。连接到打印机的 HP Wireless Direct 信号与将支持 Wi-Fi 的设备连接到新的无线网络或热点的方式相同。

启用 HP Wireless Direct

通过以下步骤在 HP 嵌入式 Web 服务器 (EWS) 中启用 HP Web 服务：

1. 将打印机连接到网络，然后打印配置页以获取打印机 IP 地址。

 **注：**要手动设置 IP 地址或自动配置它，请参阅《用户指南》中的“配置网络产品”，

2. 打开 Web 浏览器，然后在地址行中输入打印机 IP 地址。**IP 地址示例：** 192.168.0.1



9. 设置通过电子邮件的 HP ePrint (可选)

使用通过电子邮件的 HP ePrint 打印文档只需从任何支持电子邮件的设备 (甚至可从不在同一网络上的设备) 将这些文档作为电子邮件附件发送到产品的电子邮件地址即可。

要使用通过电子邮件的 HP ePrint, 打印机必须满足以下这些要求:

- 打印机必须连接到无线网络并可访问 Internet。
- 打印机上必须启用 HP Web 服务, 并且打印机必须注册到 HP Connected。

启用 HP Web 服务 (仅限无线型号)

1. 在打印机连接到 HP 内嵌式 Web 服务器 (EWS) 之后, 打印配置页并找出打印机 IP 地址。
2. 在计算机上打开 Web 浏览器, 然后在地址行中输入打印机 IP 地址。随后将打开 HP EWS。
3. 单击 **“HP Web 服务”** 选项卡。如果网络使用代理服务器, 则执行以下操作:
 - 选择 **“代理设置”** 选项卡。
 - 选中 **“如果网络使用代理服务器访问 Internet, 则选中此框”** 复选框。
 - 在 **“代理服务器”** 字段中, 输入代理服务器地址和端口号, 然后单击 **“应用”** 按钮。
4. 选择 **“HP Web 服务”** 选项卡, 然后单击 **“启用”** 按钮。打印机配置 Internet 连接, 然后显示一条消息, 指示将打印信息表
5. 单击 **OK** 按钮。随后将打印 ePrint 页。在 ePrint 页上, 查找自动分配给打印机的电子邮件地址。

使用 HP ePrint

1. 访问 www.hpconnected.com 以创建 HP ePrint 帐户并完成设置过程。
2. 从列表中选择打印机, 或单击 **“+ 添加打印机”** 以添加它。要添加打印机, 需要使用打印机代码, 即打印机电子邮件地址中 @ 符号之前的部分。

 **注:** 该代码有效时间只有 24 小时, 从您启用 HP Web 服务算起。如过期, 请按以下说明重新启用 HP Web 服务, 获取新的代码。

3. 单击 **“设置”** 按钮。随后将显示 **“HP ePrint 设置”** 对话框。有三个选项卡可用:
 - **允许的发送方:** 要阻止产品打印非预期文档, 请单击 **“允许的发送方”** 选项卡。单击 **“仅允许的发送方”**, 然后添加要允许执行 ePrint 作业的电子邮件地址。
 - **打印选项:** 要配置发送到本打印机的所有 ePrint 作业的默认设置, 请单击 **“打印选项”** 选项卡, 然后选择要使用的设置。
 - **高级:** 要更改打印机的电子邮件地址, 请单击 **“高级”** 选项卡。

故障排除

用户指南

《用户指南》中含有打印机使用和故障排除信息。可在打印机 CD 和 Web 上找到它:

从网上获得《用户指南》

1. 访问 www.hp.com/support/lj1100series。
2. 从列表中选择打印机或类别, 然后单击 **“用户指南”**。

从打印机 CD 获得《用户指南》

对于 Windows, 在安装推荐的软件期间, 将《用户指南》复制到计算机。

Windows® XP、Windows Vista® 和 Windows® 7

单击 **“开始”**, 依次选择 **“程序”** 或 **“所有程序”**、**“HP”**、HP 打印机对应的文件夹、**“帮助”**。

Windows® 8

在 **“开始”** 屏幕上, 右键单击屏幕上的空白区域, 在应用栏上单击 **“所有应用”**, 单击具有打印机名称的图标, 然后选择 **“帮助”**。

检查固件更新

1. 访问 www.hp.com/support/lj1100series。
2. 从列表中选择打印机或类别, 然后单击 **“驱动程序”**。
3. 选择操作系统, 然后单击 **“下一步”** 按钮。
4. 选择 **“固件”**, 然后单击 **“下载”** 按钮。

其他支持资源

有关 HP 对打印机的全方位帮助, 请访问 www.hp.com/support/lj1100series:

- 解决问题
- 查找高级配置说明
- 下载软件更新
- 加入支持论坛
- 查找保修和监管信息
- 移动打印资源

无线网络连接(仅限无线型号)

- 确认打印机和无线路由器均已开启且通电。还要确保无线开关已开启。
- 确认打印机在无线网络的覆盖范围内。对于大多数网络, 打印机与无线接入点 (无线路由器) 的距离必须在 30 米 (100 英尺) 以内。
- 确认计算机上装有打印驱动程序。
- 确认计算机与打印机连接到同一无线网络。
- 对于 Mac, 确认无线路由器支持 Bonjour。
- 重新启动无线路由器。

IMPORTANT:

Follow **Steps 1 - 3** on the printer hardware setup poster, then continue with **Step 4** on the following page.

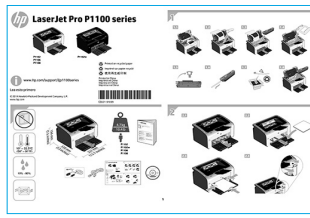

4. Initial setup at the control panel

At the printer control panel, check the LED status before beginning software installation.

5. Select a connection method and prepare for software installation

USB connection directly between the printer and the computer

Use an A-to-B type USB cable.

Windows

1. For Windows 7 or lower, do not connect the USB cable before installing the software. The installation process prompts to connect the cable at the appropriate time. If the cable is already connected, restart the printer when installation prompts to connect the cable.
2. Continue to “**6. Locate or download the software installation files.**”

 **NOTE:** During software installation, select the option to **Directly connect this computer using a USB cable.**

Mac

1. Connect the USB cable between the computer and the printer before installing the software.
2. Continue to “**6. Locate or download the software installation files.**”

Perform a wireless installation (wireless models only)

Before starting the installation, verify that the wireless access point is working correctly. Make sure that the printer, router, and computer are all turned on and that the computer is connected to the same wireless network you want to connect the printer to.

If there is not a solid blue light on the top of the printer, go to **Process A.**

If there is a solid blue light on the top of the printer, go to **Process B.**

Process A

1. Place the CD in the CD-ROM drive, and then click **Install**. When the **Printer connections** dialog appears, choose **Configure to print over the Wireless Network**.
2. Follow the onscreen instructions.

Process B

1. Place the CD in the CD-ROM drive, and then click **Install**. When the **Printer connections** dialog appears, choose **Connect to a configured Wireless Network printer**.
2. Follow the onscreen instructions.
3. Select the printer detected by the software. If the printer cannot be detected by the installer, manually input the printer's IP address to continue the installation.

 **NOTE:** Print a Configuration page to find the printer's IP address. At the printer control panel, press and hold the cancel **X** button for 5 seconds, and then release the cancel **X** button to print the Configuration page. The IP address is listed on the Configuration page in the Network Information section.

Manually configure the IP address

See the printer User Guide for information on how to manually configure the IP address www.hp.com/support/ljp1100series.

6. Locate or download the software installation files



Install from the printer CD

For Windows, the software installation files are provided on the CD that came with the printer.

For OS X, the installer file on the CD includes a DMG file.

Install notes

For more details about the software for the printer, see the Install notes file on the printer CD.



Download from the Web

1. Go to www.hp.com/support/ljp1100series.
2. Select a printer or category from the list, and then click **Drivers**.
3. Select the operating system from the drop-down menu, and click **Next**.
4. Click **Driver**, and then click **Download**.
5. Follow the on-screen instructions.

7. Install the software

Windows full solution

1. Insert the software CD into the computer CD tray.
2. Follow the on-screen instructions. When prompted to select a connection type, select the appropriate option:
 - Configure to print over the Wireless Network
 - Configure to print using USB**CAUTION:** Do not connect the USB cable until the installation program prompts you.
- Connect to a configured Wireless Network Printer

For wireless models only

3. When the installation is complete, print a configuration page to make sure that the printer has a SSID name. (Press and hold the **Cancel (X)** button until the ready light blinks, and then release it to print a configuration page).
4. When installation is complete, disconnect the USB cable. To print from a phone or tablet, connect the device to the same wireless network as the printer.

Windows basic installation

1. Turn on the printer.
2. Disconnect the USB cable from the printer and the computer (if you already have it connected). If the printer is connected to your network, leave it connected.
3. Go to www.hp.com/support/ljp1100series.
4. Select a printer or category from the list, then click **Drivers**, and then download the installation software for the printer.

OS X full solution

1. Launch the software installation .dmg file that you downloaded from the Web.
2. The software installer detects the language of the operating system, and then it displays the main menu of the installation program in the same language.
3. The **Installation Options** screen details the software to be installed. Click the **Install** button.
4. Follow the on-screen instructions to install the software.
5. At the end of the software installation process, use the **HP Utility Setup Assistant** to configure printer options.

OS X basic installation

To install basic print drivers without running the HP full solution software from CD or hp.com download, follow these steps:

1. Connect the printer to the computer or network.
2. From **System Preferences**, and click **Printers and Scanners**.
3. Click the plus **[+]** button on the bottom left, and select **P1100** using the driver named either AirPrint or HP Printer.



8. Mobile and wireless printing (optional)

8.1 Connect the device to the wireless network

To print from a phone or tablet, connect the device to the same wireless network as the printer.

Apple iOS devices (AirPrint) Open the item to print, and select the Action icon. Select **Print**, select the printer, and then select **Print**.

Newer Android devices (4.4 or newer) Open the item to print, and select the **Menu** button. Select **Print**, select the printer, and select **Print**.

Some devices require downloading the HP Print Service plugin app from the Google Play store.

Older Android Devices (4.3 or older) Download the HP ePrint app from the Google Play store.

Windows Phone Download the HP AiO Remote app from the Windows Store.

Learn more about mobile printing

To learn more about other mobile printing options, including additional ePrint solutions, scan the QR code, or see the “Mobile printing” section of the User Guide.



8.2 HP Wireless Direct (wireless models only)

HP Wireless Direct allows Wi-Fi capable devices, such as smart phones, tablets, or computers, to make wireless network connection directly to the printer without using a wireless router or access point. Connect to the printer's HP wireless direct signal the same way you connect your Wi-Fi capable device to a new wireless network or hotspot.

Enable HP Wireless Direct

Enable HP Web Services in the HP Embedded Web Server (EWS) by following these steps:

1. Connect the printer to a network, and print a configuration page to get the printer IP address.



NOTE: To set the IP address manually or configure it automatically, see “Configure the network product” in the User Guide.

2. Open a Web browser, and enter the printer IP address into the address line. **Example IP address:** 192.168.0.1



9. Set up HP ePrint via email (optional)

Use HP ePrint via email to print documents by sending them as an email attachment to the printer's email address from any email enabled device, even from devices that are not on the same network.

To use HP ePrint via email, the printer must meet these requirements:

- The printer must be connected to wireless network and have Internet access.
- HP Web Services must be enabled on the printer, and the printer must be registered with HP Connected.

Enable HP Web Services (wireless models only)

1. After the printer is connected to the HP Embedded Web Server (EWS), print a configuration page and identify the printer IP address.
2. At the computer, open a Web browser and enter the printer IP address into the address line. The HP EWS opens.
3. Click the **HP Web Services** tab. If the network uses a proxy server do the following:
 - Select the **Proxy Settings** tab.
 - Select the **Check this box if your network uses a proxy server to access the Internet** check box.
 - In the **Proxy Server** field, enter the proxy server address and port number, and then click the **Apply** button.
4. Select the **HP Web Services** tab, and click the **Enable** button. The printer configures the connection to the Internet, and then a message appears indicating an information sheet will print
5. Click the **OK** button. An ePrint page prints out. On the ePrint page, look for the e-mail address that is automatically assigned to the printer.

Use HP ePrint

1. Go to www.hpconnected.com to create an HP ePrint account and complete the setup process.
2. Select your printer from the list, or click **+ Add printer** to add it. To add the printer, you need the printer code, which is the segment of the printer e-mail address that is before the @ symbol.



NOTE: This code is valid for only 24 hours from the time you enable HP Web Services. If it expires, follow the instructions to enable HP Web Services again, and obtain a new code.

3. Click the Setup button. The HP ePrint settings dialog box appears. Three tabs are available:
 - **Allowed Senders:** To prevent your printer from printing unexpected documents, click the **Allowed Senders** tab. Click **Allowed Senders Only**, and then add the e-mail addresses from which you want to allow ePrint jobs.
 - **Print Options:** To set up default settings for all ePrint jobs sent to this printer, click the **Print Options** tab, and then select the settings that you want to use.
 - **Advanced:** To change the printer's e-mail address, click the **Advanced** tab.

Troubleshooting

User Guide

The User Guide includes printer usage and troubleshooting information. It is available on the printer CD and on the Web:

User Guide on the Web

1. Go to www.hp.com/support/ljp1100series.
2. Select a printer or category from the list, and then click **User guides**.

User Guide from the printer CD

For Windows, the User Guide is copied to the computer during the recommended software installation.

Windows[®] XP, Windows Vista[®], and Windows[®] 7

Click **Start**, select **Programs** or **All Programs**, select **HP**, select the folder for the HP printer, and then select **Help**.

Windows[®] 8

On the **Start** screen, right-click an empty area on the screen, click **All Apps** on the app bar, click the icon with the printer's name, and then select **Help**.

Check for firmware updates

1. Go to www.hp.com/support/ljp1100series.
2. Select a printer or category from the list, and then click **Drivers**.
3. Select the operating system, and click the **Next** button.
4. Select **Firmware**, and click the **Download** button.

Additional support resources

For HP's all-inclusive help for the printer, go to www.hp.com/support/ljp1100series:

- Solve problems
- Find advanced configuration instructions
- Download software updates
- Join support forums
- Find warranty and regulatory information
- Mobile printing resources

Wireless network connection (wireless models only)

- Verify that the printer and wireless router are turned on and have power. Also make sure the wireless switch is turned on.
- Verify that the printer is within the range of the wireless network. For most networks, the printer must be within 30 m (100 ft) of the wireless access point (wireless router).
- Verify the print driver is installed on the computer.
- Verify that the computer and printer connect to the same wireless network.
- For Mac, verify that the wireless router supports Bonjour.
- Restart the wireless router.

未经事先书面许可，严禁进行任何形式的复制、改编或翻译，除非版权法另有规定。

此处包含的信息如有更改，恕不另行通知。

此类产品和服务附带的保修声明中明确规定了 HP 产品和服务的所有保修事项。不得将本文的任何内容视为构成附加保修。HP 不对本文档中的技术错误、编辑错误或遗漏承担责任。

商标说明

Windows® 是 Microsoft Corporation 在美国的注册商标。

未经事先书面许可，严禁进行任何形式的复制、改编或翻译，除非版权法另有规定。

此处包含的信息如有更改，恕不另行通知。

此类产品和服务附带的保修声明中明确规定了 HP 产品和服务的所有保修事项。不得将本文的任何内容视为构成附加保修。HP 不对本文档中的技术错误、编辑错误或遗漏承担责任。

商标说明

Windows® 是 Microsoft Corporation 在美国的注册商标。

FCC 规则

本设备经测试，确认符合 FCC 规则第 15 部分有关 B 级数字设备的限制规定。这些限制旨在为防止住宅安装中的有害干扰提供合理保护。本设备会产生、使用并可能辐射射频能量。如果不按照说明进行安装和使用，可能会对无线电通信造成有害干扰。但也不能保证在特定的安装中不会产生干扰的问题。如果本设备确实对无线电或电视接收造成干扰（可以通过开关设备来确定），可通过以下一种或多种措施排除干扰：

- 重新调整接收天线的方向或位置。
- 增加设备和接收器之间的距离。
- 将设备连接到与接收器不在同一电路上的插座。
- 咨询代理商或经验丰富的无线电/电视技术人员。

未经 HP 公司的明确同意而擅自更改或改动本产品，用户可能会失去使用此设备的权利。根据 FCC 规则第 15 部分有关 B 级数字设备的限制规定，用户必须使用屏蔽的接口电缆。有关更多管制信息，请参阅电子版《用户指南》。对于由提供或使用本信息所引起的任何直接、间接、偶然、继发性或其它损失，HP 概不负责。

Reproduction, adaptation or translation without prior written permission is prohibited, except as allowed under the copyright laws.

The information contained herein is subject to change without notice.

The only warranties for HP products and services are set forth in the express warranty statements accompanying such products and services. Nothing herein should be construed as constituting an additional warranty. HP shall not be liable for technical or editorial errors or omissions contained herein.

Trademark Credits

Windows® is a U.S. registered trademark of Microsoft Corporation.

Reproduction, adaptation or translation without prior written permission is prohibited, except as allowed under the copyright laws.

The information contained herein is subject to change without notice.

The only warranties for HP products and services are set forth in the express warranty statements accompanying such products and services. Nothing herein should be construed as constituting an additional warranty. HP shall not be liable for technical or editorial errors or omissions contained herein.

Trademark Credits

Windows® is a U.S. registered trademark of Microsoft Corporation.

FCC Regulations

This equipment has been tested and found to comply with the limits for a Class B digital device, pursuant to Part 15 of the FCC rules. These limits are designed to provide reasonable protection against harmful interference in a residential installation. This equipment generates, uses, and can radiate radio-frequency energy. If this equipment is not installed and used in accordance with the instructions, it may cause harmful interference to radio communications. However, there is no guarantee that interference will not occur in a particular installation. If this equipment does cause harmful interference to radio or television reception, which can be determined by turning the equipment off and on, correct the interference by one or more of the following measures:

- Reorient or relocate the receiving antenna.
- Increase separation between equipment and receiver.
- Connect equipment to an outlet on a circuit different from that to which the receiver is located.
- Consult your dealer or an experienced radio/TV technician.

Any changes or modifications to the product that are not expressly approved by HP could void the user's authority to operate this equipment. Use of a shielded interface cable is required to comply with the Class B limits of Part 15 of FCC rules. For more regulatory information, see the electronic user guide. HP shall not be liable for any direct, indirect, incidental, consequential, or other damage alleged in connection with the furnishing or use of this information.



CE651-91105

