



# HP 86.4 cm/34-inch Curved Monitors

User Guide

© 2015 Hewlett-Packard Development  
Company, L.P.

HDMI, the HDMI Logo and High-Definition  
Multimedia Interface are trademarks or  
registered trademarks of HDMI Licensing LLC.  
Microsoft and Windows are U.S. registered  
trademarks of the Microsoft group of  
companies.

The information contained herein is subject to  
change without notice. The only warranties for  
HP products and services are set forth in the  
express warranty statements accompanying  
such products and services. Nothing herein  
should be construed as constituting an  
additional warranty. HP shall not be liable for  
technical or editorial errors or omissions  
contained herein.

Second Edition: February 2015

First Edition: November 2014

Document part number: 797564-002

## About This Guide

This guide provides information on monitor features, setting up the monitor, using the software and technical specifications.

---

 **WARNING!** Text set off in this manner indicates that failure to follow directions could result in bodily harm or loss of life.

 **CAUTION:** Text set off in this manner indicates that failure to follow directions could result in damage to equipment or loss of information.

 **NOTE:** Text set off in this manner provides important supplemental information.

 **TIP:** Text set off in this manner provides helpful hints.

---



This product incorporates HDMI technology.



---

# Table of contents

<b>1 Product features</b>	<b>1</b>
<b>2 Safety and maintenance guidelines</b>	<b>2</b>
Important safety information	2
Maintenance guidelines	3
Cleaning the monitor	3
Shipping the monitor	3
<b>3 Setting up the monitor</b>	<b>4</b>
Use caution when setting up the monitor	4
Installing the stand	4
Identifying rear and side components	5
Connecting the cables	6
Identifying front and bottom panel controls	10
Remote control features	11
Replacing the remote control battery	12
Adjusting the monitor	13
Mounting the monitor (select models only)	14
Removing the monitor stand	14
Attaching the optional VESA mounting bracket (select models only)	14
Turning on the monitor	15
Connecting USB devices	17
Locating the rating label	18
Installing a cable lock	18
<b>4 Operating the monitor</b>	<b>19</b>
Software and utilities	19
The Information file	19
The Image Color Matching file (select models)	19
Installing the .INF and .ICM files	19
Installing from the disc	20

Downloading from the Web .....	20
Using My Display software (select models) .....	21
Installing the software .....	21
Using the software .....	21
Downloading the software .....	22
Using HP Display Assistant software (select models) .....	23
Installing the software .....	23
Using the software .....	23
Downloading the software .....	24
Using the On-Screen Display (OSD) menu .....	25
Using Picture-in-Picture (PIP) and Picture-beside-Picture (PBP) .....	26
Using Auto-Sleep Mode .....	26
<b>Appendix A Technical specifications .....</b>	<b>27</b>
Recognizing preset display resolutions .....	28
Entering user modes .....	29
Power adapter .....	29
<b>Appendix B Support and troubleshooting .....</b>	<b>30</b>
Solving common problems .....	30
Button lockouts .....	31
Product support .....	31
Preparing to call technical support .....	31
<b>Appendix C LCD monitor quality and pixel policy .....</b>	<b>32</b>
<b>Appendix D Accessibility .....</b>	<b>33</b>
Supported assistive technologies .....	33
Contacting support .....	33

---

# 1 Product features

The monitor features include:

- 86.4 cm (34-inch) diagonal viewable area display with 3440 x 1440 WQHD resolution, plus full-screen support for lower resolutions
- Light-emitting diode (LED) backlit monitor with an active matrix, PVA panel
- Wide viewing angle technology and 3000r (3000mm) curved arc to provide an immersive viewing experience with increased field of vision, enhanced peripheral readability, and improved visual perception
- One HDMI and one MHL/HDMI video input
- DisplayPort video input
- PIP functionality to enable the DisplayPort and HDMI inputs to be viewed in a small secondary window or side-by-side on the main window
- Integrated DTS 6-Watt speakers for a premium audio experience
- Audio-out (headphone) jack
- Remote control
- On-Screen Display (OSD) adjustments in several languages for easy setup and screen optimization
- My Display software or HP Display Assistant software (depending on the model) included for adjusting monitor settings
- Tilt capability
- Plug and play capability if supported by your operating system
- HDCP (High-bandwidth Digital Content Protection) used on digital inputs
- Software and documentation disc that includes monitor drivers and product documentation
- VESA mounting bracket for attaching the display to a wall mount device or swing arm (select models only)
- USB 3.0 hub with one upstream port and two downstream ports with BC1.2 (for charging of select smartphones and tablets)



**NOTE:** For safety and regulatory information, refer to the *Product Notices* provided on your media disc, if one is included, or in your documentation kit. To locate updates to the user guide for your product, go to <http://www.hp.com/support>, and select your country. Select **Drivers & Downloads**, and then follow the on-screen instructions.

---

---

## 2 Safety and maintenance guidelines

### Important safety information

A power cord is included with the monitor. If another cord is used, use only a power source and connection appropriate for this monitor. For information on the correct power cord set to use with the monitor, refer to the *Product Notices* provided on your media disc, if one is included, or in your documentation kit.

---

 **WARNING!** To reduce the risk of electric shock or damage to the equipment:

- Plug the power cord into an AC outlet that is easily accessible at all times.
- Disconnect power from the monitor by unplugging the power cord from the AC outlet.
- If provided with a 3-pin attachment plug on the power cord, plug the cord into a grounded (earthed) 3-pin outlet. Do not disable the power cord grounding pin, for example, by attaching a 2-pin adapter. The grounding pin is an important safety feature.

For your safety, do not place anything on power cords or cables. Arrange them so that no one may accidentally step on or trip over them. Do not pull on a cord or cable. When unplugging from the electrical outlet, grasp the cord by the plug.

To reduce the risk of serious injury, read the *Safety and Comfort Guide*. It describes proper workstation, setup, posture, and health and work habits for computer users, and provides important electrical and mechanical safety information. This guide is located on the Web at <http://www.hp.com/ergo>.

 **CAUTION:** For the protection of the monitor, as well as the computer, connect all power cords for the computer and its peripheral devices (such as a monitor, printer, scanner) to some form of surge protection device such as a power strip or Uninterruptible Power Supply (UPS). Not all power strips provide surge protection; the power strips must be specifically labeled as having this ability. Use a power strip whose manufacturer offers a Damage Replacement Policy so you can replace the equipment, if surge protection fails.

---

Use the appropriate and correctly sized furniture designed to properly support your HP LCD monitor.

 **WARNING!** LCD monitors that are inappropriately situated on dressers, bookcases, shelves, desks, speakers, chests, or carts may fall over and cause personal injury.

Care should be taken to route all cords and cables connected to the LCD monitor so that they cannot be pulled, grabbed, or tripped over.

 **NOTE:** This product is suitable for entertainment purposes. Consider placing the monitor in a controlled luminous environment to avoid interference from surrounding light and bright surfaces that may cause disturbing reflections from the screen.

---



# Maintenance guidelines

To enhance the performance and extend the life of the monitor:

- Do not open the monitor cabinet or attempt to service this product yourself. Adjust only those controls that are covered in the operating instructions. If the monitor is not operating properly or has been dropped or damaged, contact an authorized HP dealer, reseller, or service provider.
- Use only a power source and connection appropriate for this monitor, as indicated on the label/back plate of the monitor.
- Be sure the total ampere rating of the products connected to the outlet does not exceed the current rating of the electrical outlet, and the total ampere rating of the products connected to the cord does not exceed the rating of the cord. Look on the power label to determine the ampere rating (AMPS or A) for each device.
- Install the monitor near an outlet that you can easily reach. Disconnect the monitor by grasping the plug firmly and pulling it from the outlet. Never disconnect the monitor by pulling the cord.
- Turn the monitor off when not in use. You can substantially increase the life expectancy of the monitor by using a screen saver program and turning off the monitor when not in use.



---

**NOTE:** Monitors with a “burned-in image” are not covered under the HP warranty.

---

- Slots and openings in the cabinet are provided for ventilation. These openings must not be blocked or covered. Never push objects of any kind into cabinet slots or other openings.
- Do not drop the monitor or place it on an unstable surface.
- Do not allow anything to rest on the power cord. Do not walk on the cord.
- Keep the monitor in a well-ventilated area, away from excessive light, heat or moisture.
- When removing the monitor stand, you must lay the monitor face down on a soft area to prevent it from getting scratched, defaced, or broken.

## Cleaning the monitor

1. Turn off the monitor and unplug the power cord from the back of the unit.
2. Dust the monitor by wiping the screen and the cabinet with a soft, clean antistatic cloth.
3. For more difficult cleaning situations, use a 50/50 mix of water and Isopropyl alcohol.

---

**CAUTION:** Spray the cleaner onto a cloth and use the damp cloth to gently wipe the screen surface. Never spray the cleaner directly on the screen surface. It may run behind the bezel and damage the electronics.

**CAUTION:** Do not use cleaners that contain any petroleum based materials such as benzene, thinner, or any volatile substance to clean the monitor screen or cabinet. These chemicals may damage the monitor.

---

## Shipping the monitor

Keep the original packing box in a storage area. You may need it later if you move or ship the monitor.

---

## 3 Setting up the monitor

To set up the monitor, ensure that the power is turned off to the monitor, computer system, and other attached devices, and then follow the instructions below.

### Use caution when setting up the monitor

---

**⚠ CAUTION:** To prevent damage to the monitor, do not touch the surface of the LCD panel. Pressure on the panel may cause non-uniformity of color or disorientation of the liquid crystals. If this occurs the screen will not recover to its normal condition.

**⚠ CAUTION:** Do not lay the monitor face down when installing the stand. Stress on the curvature of the display panel may damage the panel if the monitor is placed face down.

---

### Installing the stand

---

**💡 TIP:** Consider the placement of the monitor, because the bezel might cause interfering reflections from surrounding light and bright surfaces.

---

1. Lift the monitor from its box and place it *face up* on a flat surface covered by a clean, dry cloth.

---

**⚠ CAUTION:** Do not lay the monitor face down when installing the stand. Stress on the curvature of the display panel may damage the panel if the monitor is placed face down.

---

2. Lift up the bottom of the display panel (1) and insert the stand into the slot on the back of the display panel until it clicks in place (2).

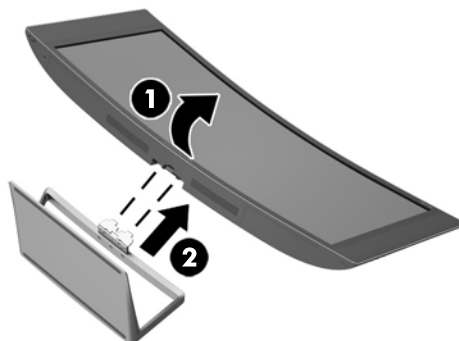

# Identifying rear and side components

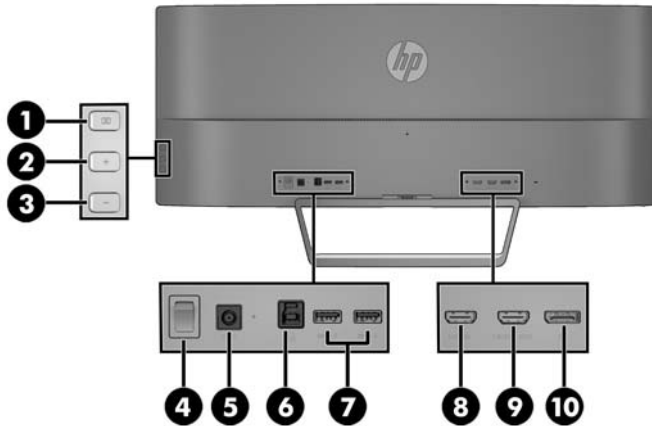

Component	Function
1	Menu button Press to open the OSD menu, select a menu item from the OSD, or close the OSD menu.
2	Plus button If the OSD menu is on, press to navigate forward through the OSD menu and increase adjustment levels.  If the OSD menu is inactive, press to open the audio menu.
3	Minus button If the OSD menu is on, press to navigate backward through the OSD menu and decrease adjustment levels.  If the OSD menu is inactive, press to advance to the next active input port (HDMI, MHL / HDMI, DisplayPort).
4	Master Power Switch Turns off all power to the monitor.  <b>NOTE:</b> Putting the switch in the Off position will yield the lowest power state for the monitor when not in use.
5	DC Power connector Connects the DC power adapter to the monitor.
6	USB 3.0 Upstream Connects the USB hub cable from the source device to the monitor.
7	USB 3.0 Downstream with Charging Connects optional USB devices to the monitor.
8	HDMI Connects the HDMI cable from the source device to the monitor.
9	HDMI MHL Connects the HDMI or MHL cable from the source device to the monitor.
10	DisplayPort Connects the DisplayPort cable from the source device to the monitor.

**NOTE:** The USB 3.0 Downstream with Charging ports also provide current to charge a device such as a smart phone or tablet even when the monitor is in Sleep mode.

## Connecting the cables

 **NOTE:** The monitor ships with select cables. Not all cables shown in this section are included with the monitor.

1. Place the monitor in a convenient, well-ventilated location near the computer or source device.
2. Connect the video cable(s).

 **NOTE:** The monitor will automatically determine which inputs have valid video signals. The inputs can be selected by pressing the **Minus** button on the side panel or through the On-Screen Display (OSD) by pressing the **Menu** button and selecting **Input Control**.

- Connect an HDMI cable to the HDMI port on the back of the monitor and the other end to the HDMI port on the source device.

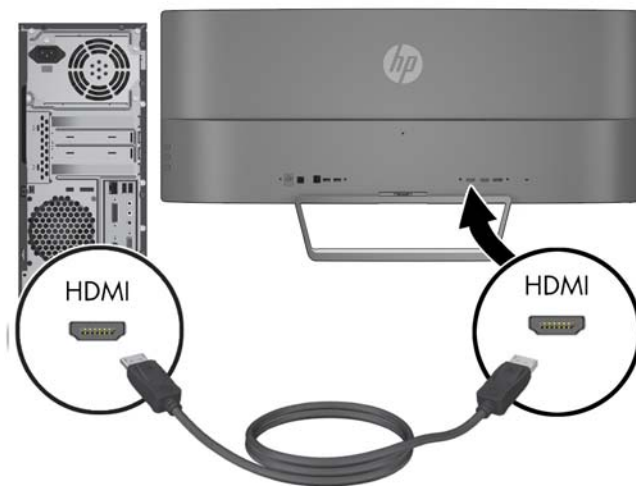

- Connect an MHL cable to the HDMI MHL port on the rear of the monitor and to the micro USB port on an MHL-enabled source device, such as a smart phone or tablet, to stream content from the mobile device to your monitor screen.

 **NOTE:** The MHL video is limited to the mobile device output resolution.

 **NOTE:** The MHL connector also charges your MHL mobile device while connected and streaming.

 **NOTE:** You can also connect an HDMI cable between the HDMI MHL port on the monitor and an HDMI source device. The port will automatically detect if the connected device is an HDMI device or an MHL 2.0 or lower device.

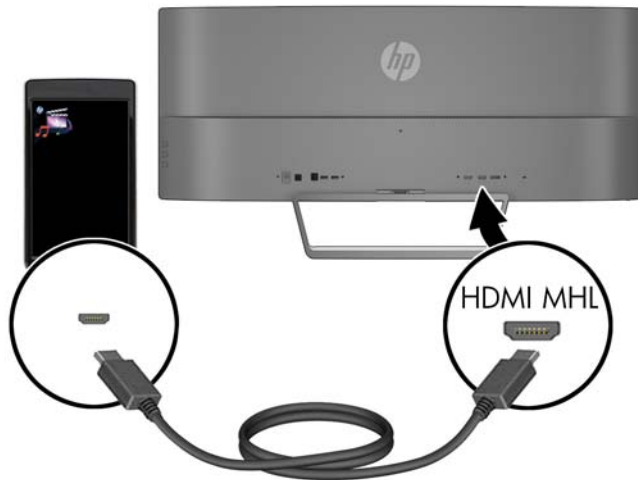

- Connect a DisplayPort cable to the DisplayPort connector on the rear of the monitor and the other end to the DisplayPort connector on the source device.

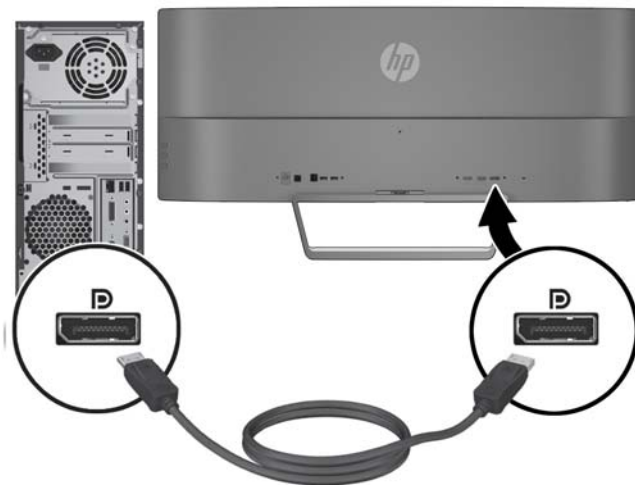

3. Connect a USB upstream cable to the USB upstream port on the rear of the monitor and the other end to a USB downstream port on the source device.

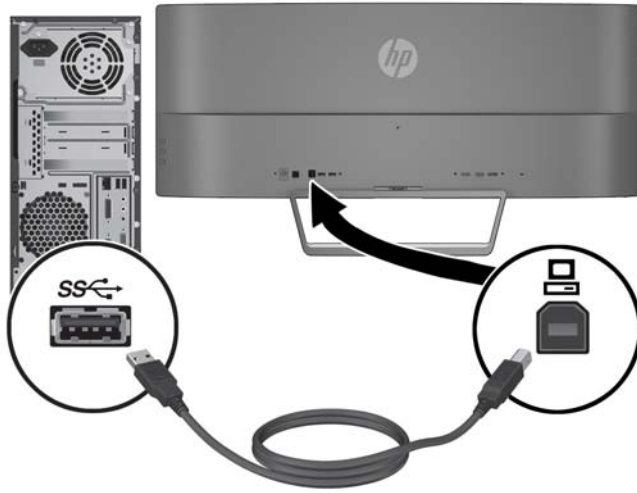

4. Connect one end of the power cord to the power supply (1) and the other end to a grounded electrical outlet (2), and then connect the round end of the power supply cord to the monitor (3).

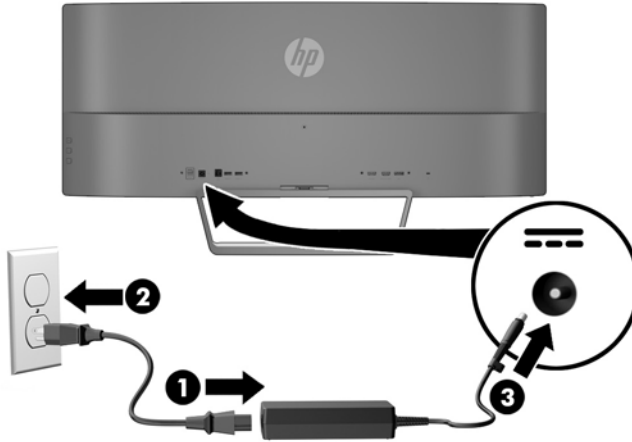

---

 **NOTE:** Ensure that the master power switch on the rear of the monitor is in the On position before pressing the power button to turn on the monitor.

 **WARNING!** To reduce the risk of electric shock or damage to the equipment:

Do not disable the power cord grounding plug. The grounding plug is an important safety feature.

Plug the power cord into a grounded (earthed) electrical outlet that is easily accessible at all times.

Disconnect power from the equipment by unplugging the power cord from the electrical outlet.

For your safety, do not place anything on power cords or cables. Arrange them so that no one may accidentally step on or trip over them. Do not pull on a cord or cable. When unplugging from the electrical outlet, grasp the cord by the plug.

---

## Identifying front and bottom panel controls

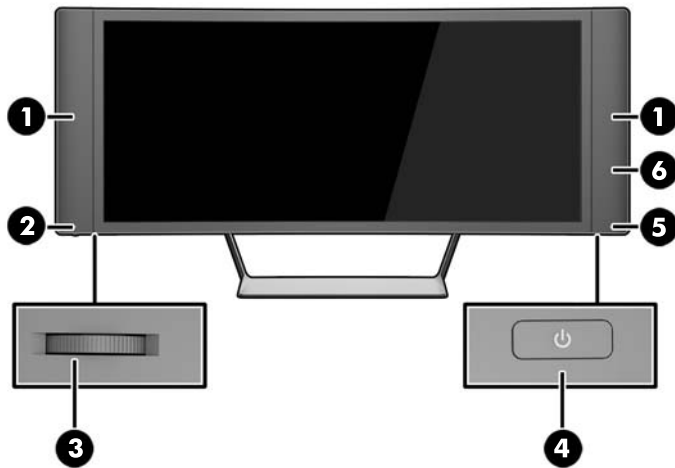

Control	Function
1	Speakers Provide premium audio sound.
2	Mute LED The LED is lit when the volume is muted, and off when the volume is not muted.
3	Volume/Mute Rotate the dial control to adjust the volume.  Press the dial upward to mute and unmute the audio.  <b>NOTE:</b> The volume control is located on the bottom of the panel
4	Power Turns the monitor on or off.  <b>NOTE:</b> The power button is located on the bottom of the panel
5	Power LED System on = white  System off = off  Sleep mode = amber  Sleep timer mode = blinking amber
6	IR Receiver Receives information from the remote control.



# Remote control features

The remote control can be used to turn the monitor on or off, open and make adjustments to the OSD, adjust the volume, and mute or unmute the speakers.

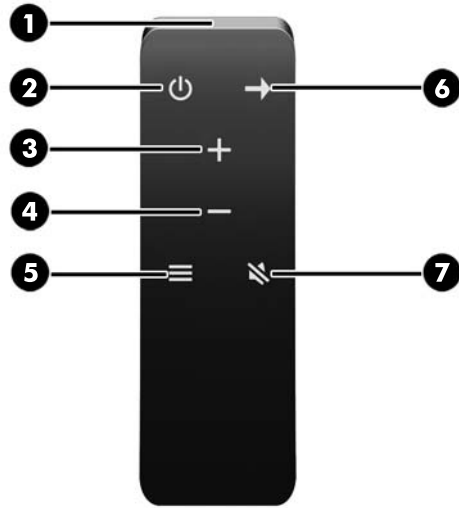

Button		Function
1	IR Transmitter	Sends information from the remote control to the monitor.
2	Power	Turns the monitor on or off.
3	Plus	If the OSD menu is on, press to navigate forward through the OSD menu and increase adjustment levels.  If the OSD menu is inactive, press to increase the speaker volume.
4	Minus	If the OSD menu is on, press to navigate backward through the OSD menu and decrease adjustment levels.  If the OSD menu is inactive, press to decrease the speaker volume.
5	Menu	Press to open the OSD menu, select a menu item from the OSD, or close the OSD menu.  <b>NOTE:</b> When using the remote control to open the OSD menu, the menu will appear in Large mode. You can return the menu to Normal mode by pressing one of the menu buttons on the side of the display head.
6	Input Source	Press to advance to the next active input port (HDMI, MHL / HDMI, DisplayPort).
7	Mute	Press to mute or unmute the audio.

## Replacing the remote control battery

The remote control uses a CR2032 button cell lithium battery.

1. Rotate the battery cover counter-clockwise and lift it off the remote control (1), and then lift the battery out of the compartment (2).



2. Install the new battery in the battery compartment with the positive side facing up (1), and then replace the battery cover (2).

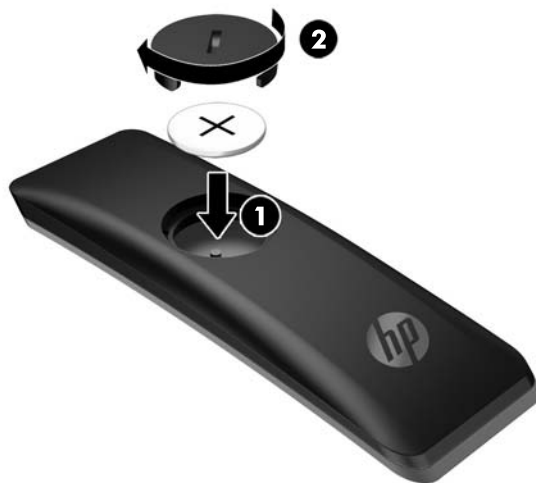

**CAUTION:** See the *Product Notices* document provided on the media disc for proper battery disposal.

## Adjusting the monitor

Tilt the monitor panel to set it to a comfortable eye level.



## Mounting the monitor (select models only)

The mounting bracket (included with select models only) can be used to attach the monitor to any standard mounting system with a standard VESA 100mm x 100mm mount pattern.

 **NOTE:** This apparatus is intended to be supported by UL or CSA Listed wall mount bracket.

 **CAUTION:** The mounting bracket supports the VESA industry standard 100 mm mounting holes. To attach a third-party mounting solution to the mounting bracket, four 4 mm, 0.7 pitch, and 10 mm long screws are required. It is important to verify that the manufacturer's mounting solution is compliant with the VESA standard and is rated to support the weight of the monitor display panel. For best performance, it is important to use the power and video cables provided with the monitor.

## Removing the monitor stand

You can remove the monitor panel from the stand to install the panel on a wall, a swing arm, or other mounting fixture.

 **CAUTION:** Before beginning to disassemble the monitor, be sure the monitor is turned off and all cables are disconnected.

1. Disconnect and remove all cables from the monitor.
2. Lay the monitor *face up* on a flat surface covered by a clean, dry cloth.

 **CAUTION:** Do not lay the monitor face down when installing the stand. Stress on the curvature of the display panel may damage the panel if the monitor is placed face down.

3. Lift up the bottom of the display panel (1), and then press the release latch (2) and slide the stand out of the slot on the display panel (3).

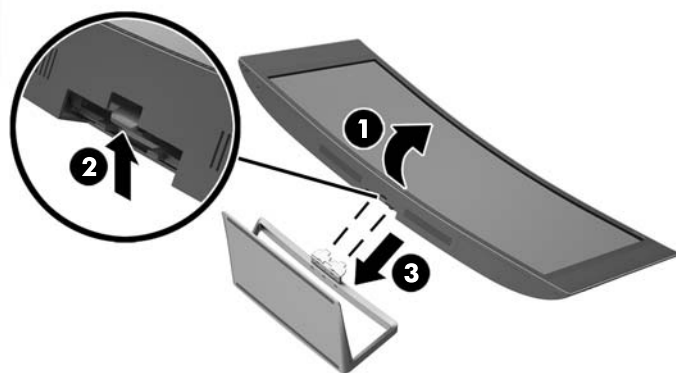

## Attaching the optional VESA mounting bracket (select models only)

1. Remove the monitor stand. Refer to [Removing the monitor stand on page 14](#).
2. Place the display head on a flat surface with the bottom of the display head facing up.

3. Press the hinge release button (1), insert the tab at the bottom of the VESA bracket into the slot on the back of the display head until the bracket clicks in place (2), and then secure the screw on top of the bracket to the display head (3).

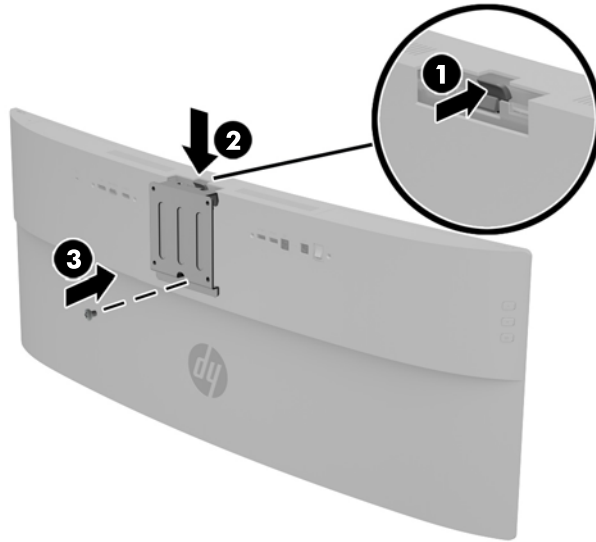

4. To attach the monitor to a swing arm or other mounting device, insert the four supplied mounting screws through the holes on the mounting device and into the screw holes on the VESA mounting bracket.

**⚠ CAUTION:** Be sure to use the supplied mounting screws when attaching the monitor to a mounting device. Installing longer screws may damage the monitor.



## Turning on the monitor

1. Set the master power switch on the rear of the monitor to the On position.
2. Press the power button on the source device to turn it on.

3. Press the power button located underneath the right speaker to turn on the monitor.

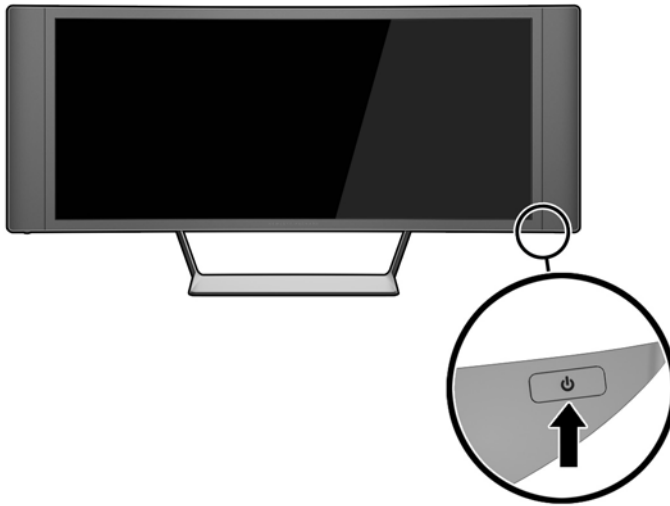

---

**CAUTION:** Burn-in image damage may occur on monitors that display the same static image on screen for a prolonged period of time.\* To avoid burn-in image damage on the monitor screen, you should always activate a screen saver application or turn off the monitor when it is not in use for a prolonged period of time. Image retention is a condition that may occur on all LCD screens. Monitors with a “burned-in image” are not covered under the HP warranty.

\* A prolonged period of time is 12 consecutive hours of non-use.

**NOTE:** If pressing the power button has no effect, the Power Button Lockout feature may be enabled. To disable this feature, press and hold the monitor power button for 10 seconds.

**NOTE:** You can disable the power LED in the OSD menu. Press the **Menu** button on the right side of the monitor, and then select **Power Control > Power LED > Off**.

---

When the monitor is powered on, a Monitor Status message is displayed for five seconds. The message shows which input is the current active signal, the status of the auto-switch source setting (On or Off; factory default is On), the current preset display resolution, and the recommended preset display resolution.

The monitor automatically scans the signal inputs for an active input and uses that input for the display.

## Connecting USB devices

There is one USB upstream port and two USB downstream ports on the rear of the monitor.

 **NOTE:** You must connect the USB upstream cable from the source computer to the monitor to enable the USB ports on the monitor. Refer to Step 4 in [Connecting the cables on page 6](#).

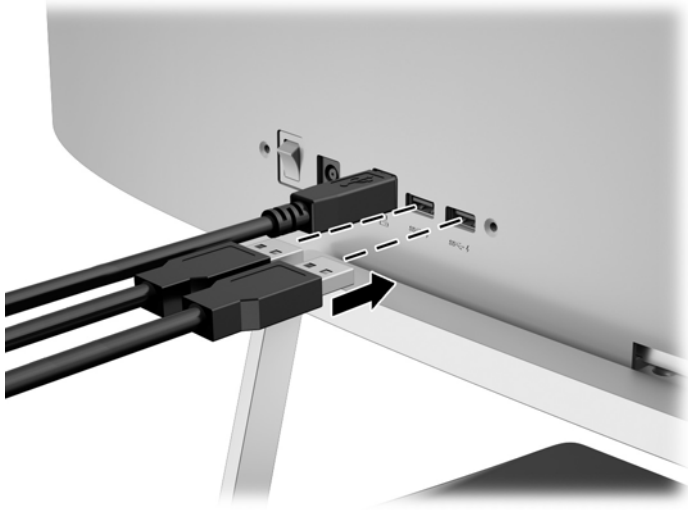

## Locating the rating label

The rating label on the monitor provides the product number and serial number. You may need these numbers when contacting HP about the monitor model. The rating label is located on the bottom of the display head.

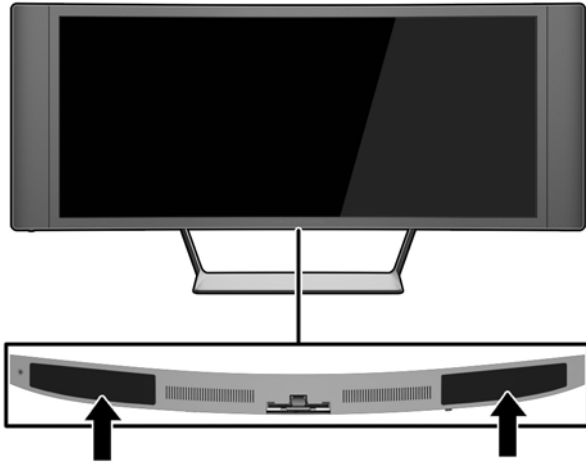

## Installing a cable lock

You can secure the monitor to a fixed object with an optional cable lock available from HP.

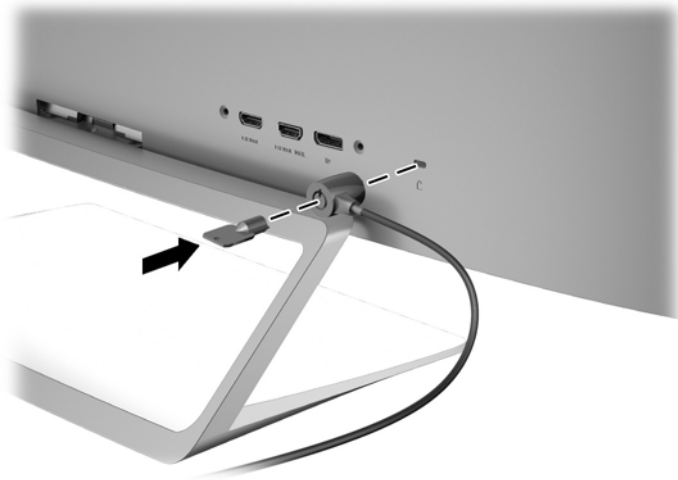



---

## 4 Operating the monitor



**NOTE:** If you do not have a computer or source device with an optical drive, you can download the latest version of software available for this product from the HP monitors support Web site, <http://www.hp.com/support>.

---

### Software and utilities

The disc that comes with the monitor contains files you can install on the computer:

- an .INF (Information) file
- ICM (Image Color Matching) files (one for each calibrated color space) (select models)
- *My Display* software (select models)
- *HP Display Assistant* software (select models)

### The Information file

The .INF file defines monitor resources used by Microsoft Windows operating systems to ensure monitor compatibility with the computer's graphics adapter.

This monitor is Microsoft Windows Plug and Play compatible and the monitor will work correctly without installing the .INF file. Monitor Plug and Play compatibility requires that the computer's graphic card is VESA DDC2-compliant and that the monitor connects directly to the graphics card. Plug and Play does not work through separate BNC type connectors or through distribution buffers/boxes.

### The Image Color Matching file (select models)

The .ICM files are data files that are used in conjunction with graphics programs to provide consistent color matching from monitor screen to printer, or from scanner to monitor screen. This file is activated from within graphics programs that support this feature.



**NOTE:** The ICM color profile is written in accordance with the International Color Consortium (ICC) Profile Format specification.

---

### Installing the .INF and .ICM files



**NOTE:** The .ICM files are available for select models only.

---

After you determine that you need to update, you can install the .INF and .ICM files from the disc or download them.

## Installing from the disc

To install the .INF and .ICM files on the computer from the disc:

1. Insert the disc in the computer optical drive. The disc menu is displayed.
2. View the **HP Monitor Software Information** file.
3. Select **Install Monitor Driver Software**.
4. Follow the on-screen instructions.
5. Ensure that the proper resolution and refresh rates appear in the Windows Display control panel.



---

**NOTE:** You may need to install the digitally signed monitor .INF and .ICM files manually from the disc in the event of an installation error. Refer to the HP Monitor Software Information file on the disc.

---

## Downloading from the Web

1. Go to <http://www.hp.com/support> and select the appropriate country and language.
2. Select **Drivers & Downloads**, type your monitor model in the **Find by product** search field, and click **Go**.
3. If necessary, select your monitor from the list.
4. Select your operating system, and then click **Next**.
5. Click **Driver - Display/Monitor** to open the list of drivers.
6. Click on the driver.
7. Click the **System Requirements** tab, and then verify that your system meets the program minimum requirements.
8. Click **Download** and follow the on-screen instructions to download the software.

## Using *My Display* software (select models)

Use *My Display* software to choose preferences for optimum viewing. You can select settings for gaming, movies, photo editing or just working on documents and spreadsheets. You can also easily adjust settings such as brightness, color, and contrast using *My Display* software.

### Installing the software

To install the software:

1. Insert the disc in your computer disc drive. The disc menu is displayed.
2. Select the language.



---

**NOTE:** This choice selects the language you will see while installing the software. The language of the software itself will be determined by the operating system language.

---

3. Click **Install My Display Software**.
4. Follow the on-screen instructions.
5. Restart the computer.

### Using the software

To open the *My Display* software:

- Click the **HP My Display** icon on the taskbar.
- Or
- Click **Windows Start**™ on the taskbar and select **All Programs > HP My Display > HP My Display**.

For additional information, refer to the on-screen **Help** within the software.

## Downloading the software

If you prefer to download the *My Display* software, follow the instructions below.

1. Go to <http://www.hp.com/support> and select the appropriate country and language.
2. Select **Drivers & Downloads**, type your monitor model in the **Find by product** search field, and click **Go**.
3. If necessary, select your monitor from the list.
4. Select your operating system.
5. Click **Utility - Tools** to open the list of utilities and tools.
6. Click **HP My Display**.
7. Click the **System Requirements** tab, and then verify that your system meets the program minimum requirements.
8. Click **Download** and follow the on-screen instructions to download *My Display*.

## Using *HP Display Assistant* software (select models)

*HP Display Assistant* is a software utility that guides you through the image tuning process with easy to understand instructions and background patterns designed for each monitor control. You can configure display settings that can be saved for each user, providing an easy way to select display characteristics in a multi-user environment, or a single user can have multiple defined presets based on content and ambient lighting.

### Installing the software

To install the software:

1. Insert the disc in your computer disc drive. The disc menu is displayed.
2. Select the language.



---

**NOTE:** This choice selects the language you will see while installing the software. The language of the software itself will be determined by the operating system language.

---

3. Click **Install HP Display Assistant Utility**.
4. Follow the on-screen instructions.
5. Restart the computer.

### Using the software

To open the *HP Display Assistant* software:

- Click the **HP Display Assistant** icon on the taskbar or desktop.  
Or
- Click **Windows Start**™ on the taskbar and select **All Programs > HP Display Assistant > HP Display Assistant**.  
Or
- Right-click on the desktop and select **Tune Display**.

For additional information, refer to the *HP Display Assistant User Guide* included on the disc with your monitor.

## Downloading the software

If you prefer to download the *HP Display Assistant* software, follow the instructions below.

1. Go to <http://www.hp.com/support> and select the appropriate country and language.
2. Select **Drivers & Downloads**, type your monitor model in the **Find by product** search field, and click **Go**.
3. If necessary, select your monitor from the list.
4. Select your operating system.
5. Click **Utility - Tools** to open the list of utilities and tools.
6. Click **HP Display Assistant Utility**.
7. Click the **System Requirements** tab, and then verify that your system meets the program minimum requirements.
8. Click **Download** and follow the on-screen instructions to download *HP Display Assistant*.

## Using the On-Screen Display (OSD) menu

Use the On-Screen Display (OSD) menu to adjust the screen image based on your viewing preferences. You can access and make adjustments in the OSD using the buttons on the right side of the monitor.

To access the OSD and make adjustments, do the following:

1. If the monitor is not already on, press the power button to turn on the monitor.
2. Press one of the three buttons on the right side of the monitor to activate the buttons.
3. To access the OSD menu, press the **Menu** button on the right side of the monitor.
4. To navigate through the OSD menu, press the **+** (Plus) button or the **-** (Minus) button on the right side of the monitor to scroll up or scroll down.
5. To select an item from the OSD menu, use the **+** or **-** buttons to scroll to and highlight your selection, and then press the **Menu** button to select that function.
6. Adjust the item using the **+** or **-** buttons to adjust the scale.
7. After adjusting the function, select **Save and Return**, or **Cancel** if you don't want to save the setting, then select **Exit** from the Main menu.

Main Menu	Description
Brightness	Adjusts the brightness level of the screen. The factory default range is 90.
Color Control	Selects and adjusts the screen color options.
Input Control	Selects and adjusts the video input signals.
Image Control	Adjusts the screen image.
Audio Control	Adjust the audio settings.
PIP Control	Enables, selects, and adjusts the Picture-In-Picture (PIP) image.
Power Control	Adjusts the power settings.
OSD Control	Adjusts the on-screen display (OSD) controls.
Management	Returns all OSD menu settings to the factory default settings and selects the language in which the OSD menu is displayed.
Information	Selects and displays important information about the monitor.
Exit	Exits the OSD menu screen.

## Using Picture-in-Picture (PIP) and Picture-beside-Picture (PBP)

The monitor supports both PIP, where one source is overlaid over another, and PBP, where one source is positioned adjacent to another.

To use PIP or PBP:

1. Connect a secondary input source to the monitor.
2. Press one of the bezel buttons on the right side of the monitor to activate the buttons, and then press the **Menu** button to open the OSD.
3. In the OSD, select **PIP Control** > **Enable PIP** and then select either **Picture-in-Picture** or **2x1 Dual Split (PBP)**.
4. The monitor will scan the secondary inputs for a valid signal input and use that input for the PIP/PBP picture. If you want to change the PIP/PBP input, select **Assign Inputs** in the OSD and select the desired input.
5. If you want to change the size of the PIP, select **PIP Size** in the OSD then select the desired size.
6. If you want to adjust the position of the PIP, select **PIP Position** in the OSD, then select the desired position.



---

**NOTE:** When using PBP or PIP, you need to select the primary video input and the secondary video input in the OSD; the audio output to the speakers defaults to the primary video input source. You can switch primary and secondary video inputs in the OSD by selecting **PIP Control** > **Assign Inputs** > **Swap Primary / Secondary**.

---

## Using Auto-Sleep Mode

The monitor supports an OSD (On-Screen Display) option called **Auto-Sleep Mode** that allows you to enable or disable a reduced power state for the monitor. When Auto-Sleep Mode is enabled (enabled by default), the monitor will enter a reduced power state when the host PC signals low power mode (absence of either horizontal or vertical sync signal).

Upon entering this reduced power state sleep mode, the monitor screen is blanked, the backlight is turned off and the power LED indicator turns amber. The monitor draws less than 0.5W of power when in this reduced power mode. The monitor will wake from the sleep mode when the host PC sends an active signal to the monitor (for example, if you activate the mouse or keyboard).

You can disable the Auto-Sleep Mode in the OSD. Press one of the three buttons on the right side of the monitor to activate the button, and then press the **Menu** button on the right side of the monitor to open the OSD. In the OSD select **Power Control** > **Auto-Sleep Mode** > **Off**.



---

**NOTE:** You can also program the monitor to enter into the reduced power state at a predetermined time in the monitor's Sleep Timer utility. Open the OSD and select **Power Control** > **Sleep Timer** > **On**, and use the adjustable clock to set the sleep time. When the monitor's Sleep Timer utility causes the monitor to enter the reduced power state, the power light blinks amber.

---



# A Technical specifications



**NOTE:** All specifications represent the typical specifications provided by HP's component manufacturers; actual performance may vary either higher or lower.

For the latest specifications or additional specifications on this product, go to <http://www.hp.com/go/quickspecs/> and search for your specific monitor model to find the model-specific QuickSpecs.

Display	86.4 cm wide screen	34 inches wide screen
Type	LCD	
Viewable Image Size	86.4 cm diagonal	34-inch diagonal
Wide Viewing Angle	178 degrees horizontal and vertical	
Improved Contrast Ratio	3000:1 CR Typical	
Tilt Range	-5 to +25 degrees	
Maximum Weight (Unpacked)	9.83 kg	21.67 lbs
Dimensions (includes base)		
Height	47.72 cm	18.79 inches
Depth	19.72 cm	7.76 inches
Width	95.09 cm	37.44 inches
Maximum Graphic Resolution	3440 x 1440 (60 Hz)	
Optimum Graphic Resolution	3440 x 1440 (60 Hz)	
Environmental Requirements Temperature		
Operating Temperature	5 to 35° C	41 to 95° F
Storage Temperature	-20 to 60° C	-4 to 140° F
Power Source	100 – 240 VAC 50/60 Hz	
Input Terminal	One HDMI connector, one HDMI/MHL connector, one DisplayPort connector (cable inclusion varies by model and region)	

## Recognizing preset display resolutions

The display resolutions listed below are the most commonly used modes and are set as factory defaults. This monitor automatically recognizes these preset modes and they will appear properly sized and centered on the screen.

Preset	Resolution	Refresh Rate
1	640 × 480	59.940
2	800 × 600	60.317
3	1024 × 768	60.004
4	1280 × 720	59.940
5	1280 × 800	59.810
6	1280 × 1024	60.020
7	1366 × 768	59.790
8	1440 × 900	59.901
9	1600 × 900	60.000
10	1680 × 1050	59.954
11	1920 × 1080	60.000
12	1920 × 1200	59.950
13	2560 × 1080	60.000
14	2560 × 1440	59.900
15	3440 × 1440	30.000
16	3440 × 1440	60.000

Preset	Timing Name	Resolution	Refresh Rate
1	480p60	720 × 480	59.940
2	720p60	1280 × 720	60.000
3	1080p24	1920 × 1080	24.000
4	1080p30	1920 × 1080	30.000
5	1080p60	1920 × 1080	60.000



**NOTE:** The host computer or source device attached to the monitor can drive the monitor to its native resolution at 60Hz refresh using only the DisplayPort interface.

If using HDMI, the monitor is limited to a refresh rate of 30Hz at native resolution, as defined in the HDMI 1.4 standard. The monitor will convert up to 60Hz refresh.

Some MHL supported devices and some HDMI Blu-Ray supported media players support full high definition resolution at 24 frames per second. The monitor supports this display resolution mode and will convert up to 60Hz refresh.

## Entering user modes

The video controller signal may occasionally call for a mode that is not preset if:

- You are not using a standard graphics adapter.
- You are not using a preset mode.

If this occurs, you may need to readjust the parameters of the monitor screen by using the on-screen display. Your changes can be made to any or all of these modes and saved in memory. The monitor automatically stores the new setting, and then recognizes the new mode just as it does a preset mode. In addition to the factory preset modes, there are at least 10 user modes that can be entered and stored.

## Power adapter

Manufacturer	Part number	Power supply rating
Delta Electronic(S) Pte Ltd	HP PN 681058-00x	150W 19.5VDC
Chicony Electronics CO, Ltd	HP PN 681058-00x	150W 19.5VDC

# B Support and troubleshooting

## Solving common problems

The following table lists possible problems, the possible cause of each problem, and the recommended solutions.

Problem	Possible Cause	Solution
Screen is blank or video is flashing.	Power cord is disconnected.	Connect the power cord.
	Power button is turned off.	Press the front panel power button.  <b>NOTE:</b> If pressing the power button has no effect, press and hold the power button for 10 seconds to disable the power button lockout feature.
	Master power switch is off.	Set the master power switch on the rear of the monitor to the On position.
	Video cable is improperly connected.	Connect the video cable properly. Refer to <a href="#">Connecting the cables on page 6</a> for more information.
	System is in sleep mode.	Press any key on the keyboard or move the mouse to inactivate the screen blanking utility.
	Video card compatibility.	Open the OSD menu and select the <b>Input Control</b> menu. Set <b>Auto-Switch Input</b> to <b>Off</b> and manually select the input.
Image appears too dark.	Brightness is too low.	Open the OSD menu and select <b>Brightness</b> to adjust the brightness scale as needed.
No speaker volume or low speaker volume.	Volume control is turned down.	Adjust the volume control on the bottom left of the front panel.
	Volume is muted.	Press up on the volume control to unmute the volume.
	Headphones are plugged in.	Unplug the headphones. The speakers are disabled when the headphones are plugged in.
<b>Check Video Cable</b> is displayed on screen.	Monitor video cable is disconnected.	Connect the appropriate video signal cable between the computer and monitor. Be sure that the computer power is off while connecting the video cable.
<b>Input Signal Out of Range</b> is displayed on screen.	Video resolution and/or refresh rate are set higher than what the monitor supports.	Change the settings to a supported setting (see <a href="#">Recognizing preset display resolutions on page 28</a> ).
The monitor is off but it did not seem to enter into a low-power sleep mode.	The monitor's power saving control is disabled.	Open the OSD menu and select <b>Power Control &gt; Auto-Sleep Mode</b> and set auto-sleep to <b>On</b>

Problem	Possible Cause	Solution
<b>OSD Lockout</b> is displayed.	The monitor's OSD Lockout function is enabled.	Press and hold the <b>Menu</b> button on the side panel for 10 seconds to disable the OSD lockout function.
<b>Power Button Lockout</b> is displayed.	The monitor's Power Button Lockout function is enabled.	Press and hold the power button for 10 seconds to unlock the power button.

## Button lockouts

Holding down the **Power** button or **Menu** button for ten seconds will lock out the functionality of the buttons. You can restore the functionality by holding the buttons down again for ten seconds. This functionality is only available when the display is powered on, displaying an active signal, and the OSD is not active.

## Product support

For additional information on using your monitor, go to <http://www.hp.com/support>. Select your country or region, select **Troubleshooting**, and then enter your model in the search window and click the **Go** button.



**NOTE:** The monitor user guide, reference material, and drivers are available at <http://www.hp.com/support>.

If the information provided in the guide does not address your questions, you can contact support. For U.S. support, go to <http://www.hp.com/go/contactHP>. For worldwide support, go to [http://welcome.hp.com/country/us/en/wwcontact\\_us.html](http://welcome.hp.com/country/us/en/wwcontact_us.html).

Here you can:

- Chat online with an HP technician



**NOTE:** When support chat is not available in a particular language, it is available in English.

- Find support telephone numbers
- Locate an HP service center

## Preparing to call technical support

If you cannot solve a problem using the troubleshooting tips in this section, you may need to call technical support. Have the following information available when you call:

- Monitor model number
- Monitor serial number
- Purchase date on invoice
- Conditions under which the problem occurred
- Error messages received
- Hardware configuration
- Name and version of the hardware and software you are using

---

## C LCD monitor quality and pixel policy

The TFT monitor uses high-precision technology, manufactured according to HP standards, to guarantee trouble-free performance. Nevertheless, the display may have cosmetic imperfections that appear as small bright or dark spots. This is common to all LCD displays used in products supplied by all vendors and is not specific to the HP LCD. These imperfections are caused by one or more defective pixels or sub-pixels.

- A pixel consists of one red, one green, and one blue sub-pixel.
- A defective whole pixel is always turned on (a bright spot on a dark background), or it is always off (a dark spot on a bright background). The first is the more visible of the two.
- A defective sub-pixel (dot defect) is less visible than a defective whole pixel and is small and only visible on a specific background.

To locate defective pixels, the monitor should be viewed under normal operating conditions, in normal operating mode at a supported resolution and refresh rate, from a distance of approximately 50 cm (20 in).

HP expects that, over time, the industry will continue to improve its ability to produce LCDs with fewer cosmetic imperfections and HP will adjust guidelines as improvements are made.

---

# D Accessibility

HP designs, produces, and markets products and services that can be used by everyone, including people with disabilities, either on a stand-alone basis or with appropriate assistive devices.

## Supported assistive technologies

HP products support a wide variety of operating system assistive technologies and can be configured to work with additional assistive technologies. Use the Search feature on your device to locate more information about assistive features.



**NOTE:** For additional information about a particular assistive technology product, contact customer support for that product.

---

## Contacting support

We are constantly refining the accessibility of our products and services and welcome feedback from users. If you have an issue with a product or would like to tell us about accessibility features that have helped you, please contact us at (888) 259-5707, Monday through Friday, 6 a.m. to 9 p.m. Mountain Time. If you are deaf or hard-of-hearing and use TRS/VRS/WebCapTel, contact us if you require technical support or have accessibility questions by calling (877) 656-7058, Monday through Friday, 6 a.m. to 9 p.m. Mountain Time.