

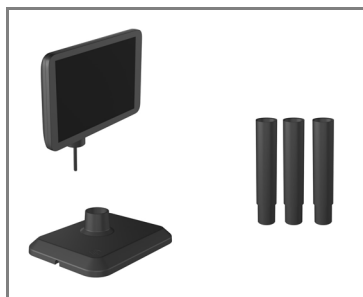

# Assembly Instructions

## HP LCD Pole Display



To configure the LCD, refer to the *HP Point of Sale Configuration Guide* (available in English only). The guide is available on the HP factory image of the system's hard drive and at [www.hp.com](http://www.hp.com). To access the guide on the factory image:

- In Windows XP or Windows Embedded POSReady 2009, select **Start > All Programs > HP Point of Sale Information**.
- In Windows 7, Windows Embedded POSReady 7, Windows 8.x, or Industry 8.1, select **Start > HP Point of Sale Information**.

Check [www.hp.com/support](http://www.hp.com/support) for updated software or documentation that became available between the time your product was manufactured and delivered to you.

For regulatory and safety notices, refer to the *Product Notices* included with your product.

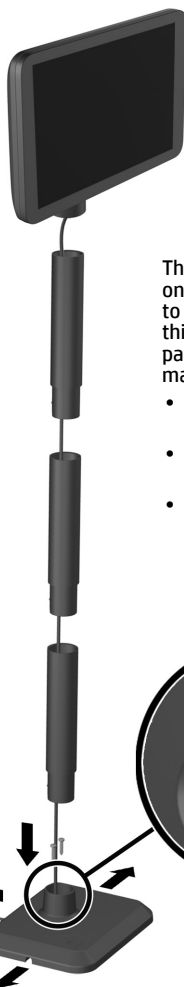

There are three small holes on the rear of the LCD used to adjust the screen. Insert a thin metal rod, such as a paper clip, into the holes to make the adjustments.

- Top hole - turns power on and off
- Middle hole - decreases brightness
- Bottom hole - increases brightness



758426-B21

First Edition: January 2014

© Copyright 2014 Hewlett-Packard Development Company, L.P.

The information contained herein is subject to change without notice.

Printed in