

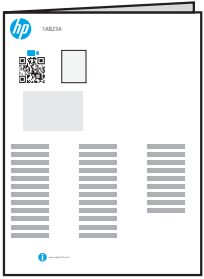

Y1G22A

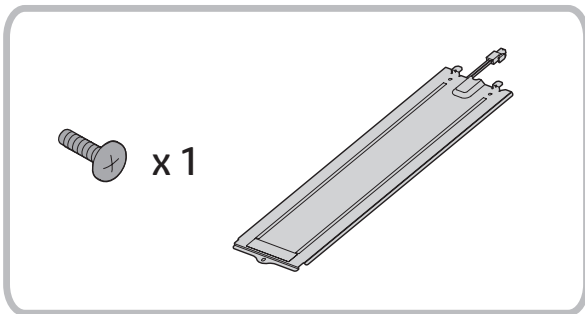

<https://www.hp.com/videos/A3install>



- EN Tray Heater
- FR Chauffe-plateaux
- DE Tray-Heizung
- IT Riscaldatore del vassoio
- ES Calentador de bandeja
- BG Подгревател за поднос
- CA Escalfador de safata
- ZHCN 托盘加热器
- HR Grijač ladice
- CS Vyhřívání zásobníku
- DA Bakkevarmer
- NL Dienbladverwarmer
- ET Salvesoojendi
- FI Lokerolämmitin
- EL Θερμαντήρας δίσκων
- HU Tálca melegítő
- ID Pemanas Tray
- JA トレイヒーター
- KK Науа жылытқышы
- KO 트레이 히터
- LV Paplātes sildītājs
- LT Dėklo šildytuvas
- NO Skuffvarmer
- PL Podgrzewacz tacy
- PT Aquecedor de Bandeja
- RO Incalzitor tava
- RU Поднос Подогреватель
- SR Гријач за носаче
- SK Ohrievač zásobníka
- SL Grelec pladnja
- SV Magasin värmare
- TH เครื่องทำถาด
- ZHTW 托盤加熱器
- TR Tepsi Isıtıcı
- UK Нагрівач лотка
- VI Khay gia nhiệt

سخان صينيّة

AR

ES Lea esto primero



[www.hp.com/support/ljm72600MFP](http://www.hp.com/support/ljm72600MFP)  
[www.hp.com/support/colorljE77422MFP](http://www.hp.com/support/colorljE77422MFP)  
[www.hp.com/support/ljE78223MFP](http://www.hp.com/support/ljE78223MFP)  
[www.hp.com/support/ljE72425MFP](http://www.hp.com/support/ljE72425MFP)  
[www.hp.com/support/ljE72725MFP](http://www.hp.com/support/ljE72725MFP)  
[www.hp.com/support/lje82500mfp](http://www.hp.com/support/lje82500mfp)

[www.hp.com/support/lje82540mfp](http://www.hp.com/support/lje82540mfp)  
[www.hp.com/support/colorlje87600mfp](http://www.hp.com/support/colorlje87600mfp)  
[www.hp.com/support/ljE77800MFP](http://www.hp.com/support/ljE77800MFP)  
[www.hp.com/support/ljE78323MFP](http://www.hp.com/support/ljE78323MFP)  
[www.hp.com/support/ljE72500MFP](http://www.hp.com/support/ljE72500MFP)  
[www.hp.com/support/ljE72825MFP](http://www.hp.com/support/ljE72825MFP)

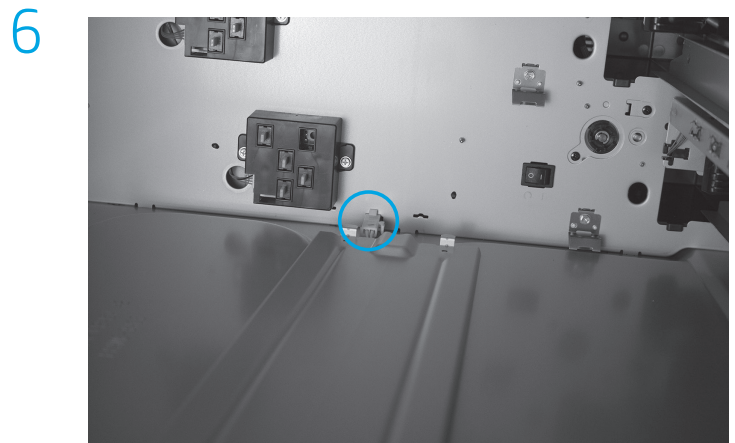
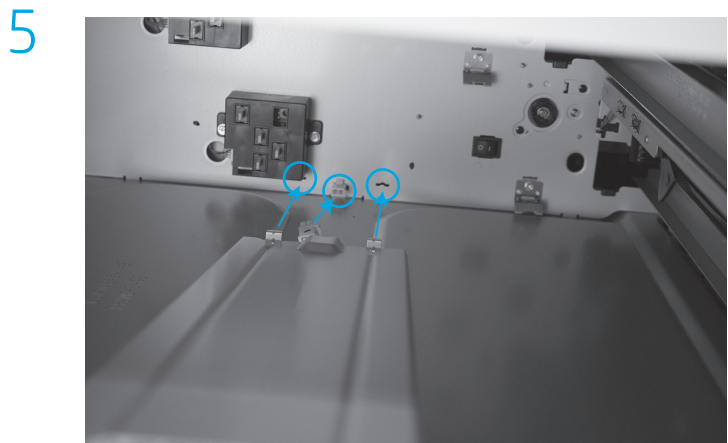
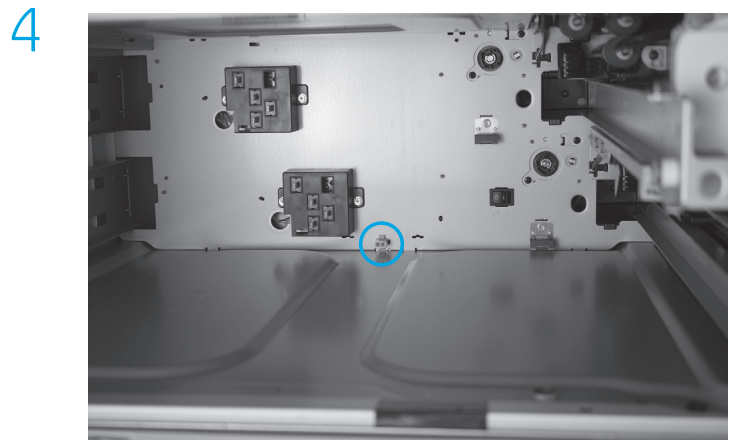
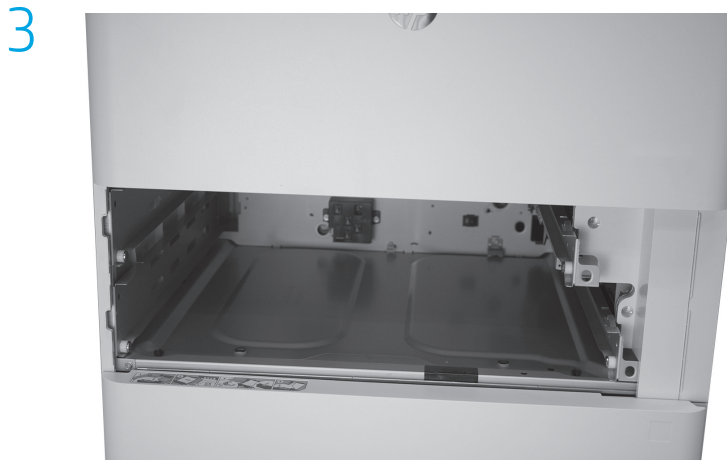
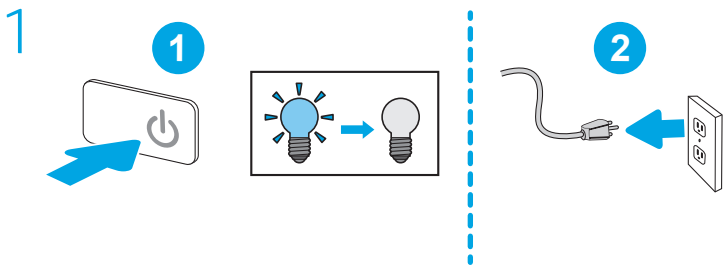

7

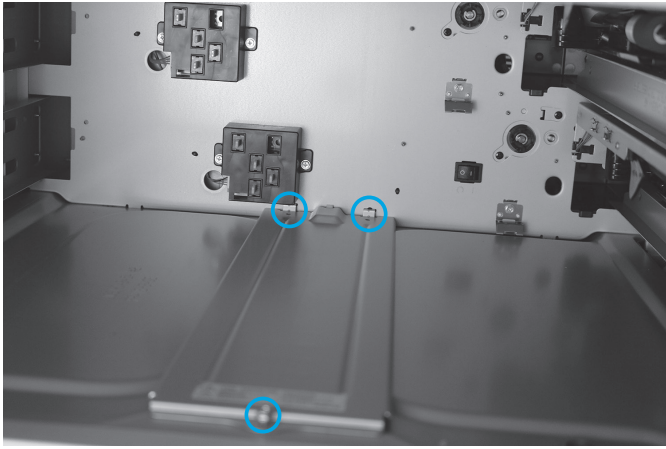

8

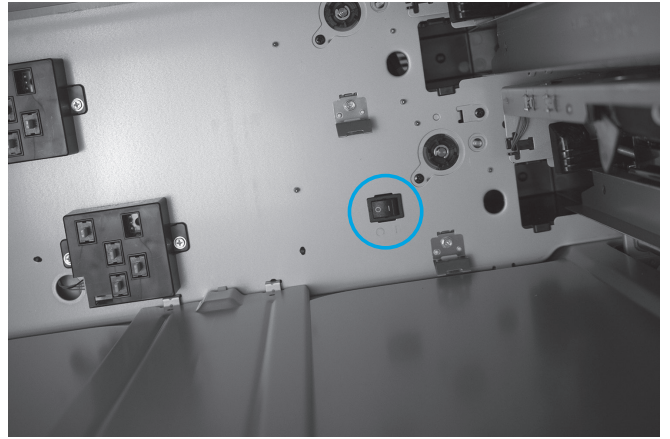

E7

9

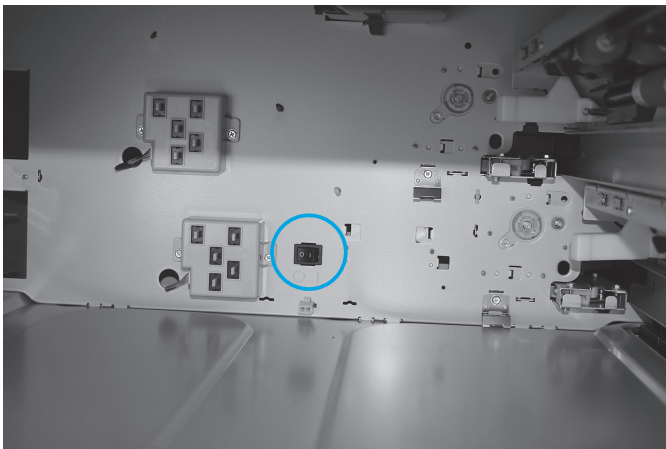

E8

10

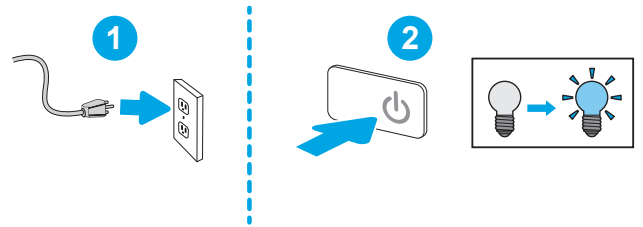

# 产品中有害物质或元素的名称及含量

根据中国《电器电子产品有害物质限制使用管理办法》



部件名称	有害物质					
	铅 (Pb)	汞 (Hg)	镉 (Cd)	六价铬 (Cr(VI))	多溴联苯 (PBB)	多溴二苯醚 (PBDE)
机械/结构部件	X	0	0	0	0	0
电气/电子部件	X	0	0	0	0	0

6751-17

本表格依据 SJ/T 11364 的规定编制。

0: 表示该有害物质在该部件所有均质材料中的含量均在 GB/T 26572 规定的限量要求以下。

X: 表示该有害物质至少在该部件的某一均质材料中的含量超出 GB/T 26572 规定的限量要求。

此表中所有名称中含“X”的部件均符合欧盟 RoHS 立法。

注: 环保使用期限的参考标识取决于产品正常工作的温度和湿度等条件

## Restriction on Hazardous Substances statement (India)

This product, as well as its related consumables and spares, complies with the reduction in hazardous substances provisions of the "India E-waste Rule 2016." It does not contain lead, mercury, hexavalent chromium, polybrominated biphenyls or polybrominated diphenyl ethers in concentrations exceeding 0.1 weight % and 0.01 weight % for cadmium, except where allowed pursuant to the exemptions set in Schedule 2 of the Rule.

## Tehlikeli Maddelere İlişkin Kısıtlama ifadesi (Türkiye)

Türkiye Cumhuriyeti: AEEE Yönetmeliğine Uygundur



Não descarte o produto eletrônico em lixo comum

Este produto eletrônico e seus componentes não devem ser descartados no lixo comum, pois embora estejam em conformidade com padrões mundiais de restrição a substâncias nocivas, podem conter, ainda que em quantidades mínimas, substâncias impactantes ao meio ambiente. Ao final da vida útil deste produto, o usuário deverá entregá-lo à HP. A não observância dessa orientação sujeitará o infrator às sanções previstas em lei.

Após o uso, as pilhas e/ou baterias dos produtos HP deverão ser entregues ao estabelecimento comercial ou rede de assistência técnica autorizada pela HP.

Para maiores informações, inclusive sobre os pontos de recebimento, acesse:

<http://www.hp.com.br/reciclar>

