

# Quick Setup

Optimum Resolution: 1920 x 1080 @ 60 Hz



1



2

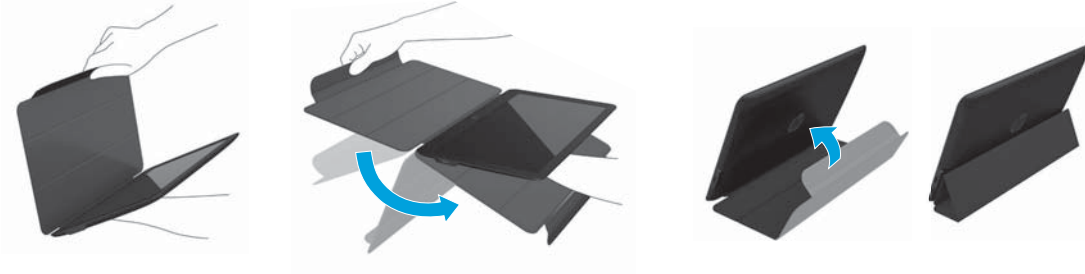

3



4



locate and download the drivers

 Note: Do not turn on power to the monitor until you have installed the drivers on your computer and connected the monitor to the computer. To setup the monitor:

1. Install the drivers from the HP website (<http://www.hp.com/support>) and follow the on-screen instructions to locate and download the drivers for the monitor.
2. Insert the single end of provided USB "Y" cable into the USB port on the monitor and connect the other end of the cable to the computer with either a USB3.0 port on the computer or two USB2.0 ports on the computer.
3. Turn on power to the monitor.
4. After installing the software and connecting the monitor, the following icon appears in the system tray:

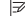

Click the icon to open the menu to select your display mode and control the attached monitor.

 Note: Brightness has been optimized for Windows 10 and cannot be adjusted.



L24505-B21

© Copyright 2018 HP Development Company, L.P. The information contained herein is subject to change without notice. HP shall not be liable for technical or editorial errors or omissions contained herein.

First Edition: July 2018

Printed in China



Q41G78S169078A



