

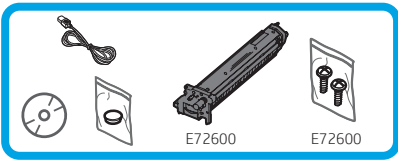

HP LaserJet MFP M72625, M72630

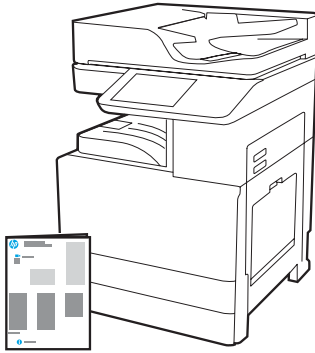

Engine Install Guide

 support.hp.com



www.hp.com/videos/A3install

HP recommends reviewing the video before performing the installation.

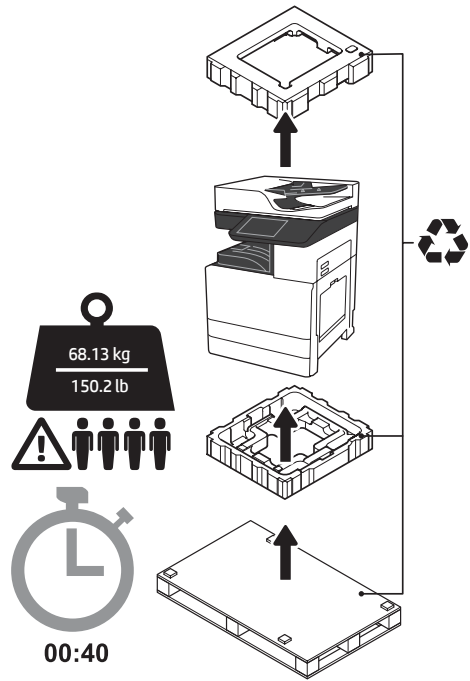

WARNING: Make sure the work area is free of debris and the floor is not slippery or wet.

CAUTION: The printer assembly is heavy. Four people must lift and install it on the dual cassette feeder (DCF) (Y1F97A), the 2000-sheet high capacity input (HCI) (Y1F99A), or the stand (Y1G17A).

1 Unpack and acclimate the printer.

CAUTION: Before the printer is powered on, make sure that the room and equipment are at least 15°C (59°F).
NOTE: Leave the printer on the shipping pallet until it is ready to install on a DCF, HCI, or stand.

1.1

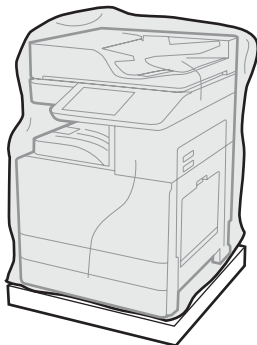

Remove the printer, imaging drum, toner collection unit (TCU), and associated hardware from the box. After unpacking the printer and supplies, allow them to acclimate for four hours.

NOTE: If the printer and hardware were stored below 0°C (32°F), it may take them longer to acclimate.

CAUTION: Do not remove the shipping tape or protective packing materials until after the printer is installed on a DCF, HCI, or stand. (Step 3.2)

NOTE: The imaging drum is stored in the output bin area below the automatic document feeder.

1.2



Pull the protective clear plastic down to the base of the printer to allow access to lifting points.

2 Prepare the DCF, 2000 sheet HCI, or stand for installation.

CAUTION: Use care when lifting. Use proper safe lifting practices.
IMPORTANT: Retain two thumbscrews for securing the HCI or stand.

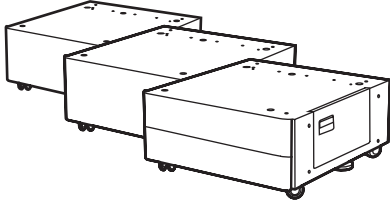

2.1

Follow the in-box directions to unpack the DCF, HCI, or stand.

2.2

Position the DCF, HCI, or stand near the printer.
WARNING: Make sure the work area is free of debris and the floor is not slippery or wet.
NOTE: If desired, lower the stabilizers to prevent the printer from moving.

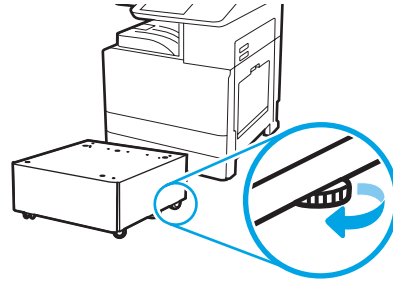

3 Install the printer on the DCF, 2000 sheet HCI, or stand.

3.1

Install the two black reusable lifting handles in the hand holds on the left side of the printer (callout 1). Open two lift bars on the right side of the printer (callout 2).
NOTE: Lifting handles are recommended, but are not shipped with the printer (handle set: JC82-00538A).

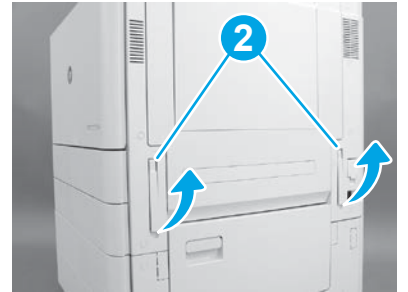
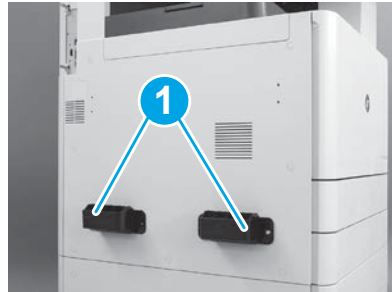

3.2

Carefully lift the printer assembly and align the printer to the alignment pins and connector on the accessory. Carefully lower the printer onto the accessory.
CAUTION: The printer assembly is heavy. Four people must lift and install it on the DCF, the HCI, or the stand.
NOTE: On the printer, open each door and all of the trays to check for shipping tape and packing materials. Remove all shipping tape and protective packing materials.



4 Remove all packing material and tape from all locations on the engine.

4

4.1

Locate the shipping label instruction tab on the right door.

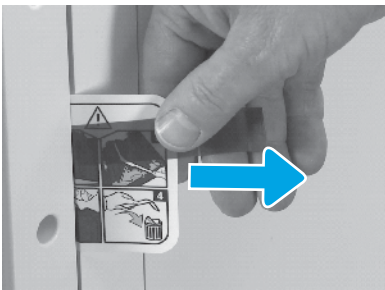

4.2

Open the right door and then remove the shipping label directing you to the transfer area.

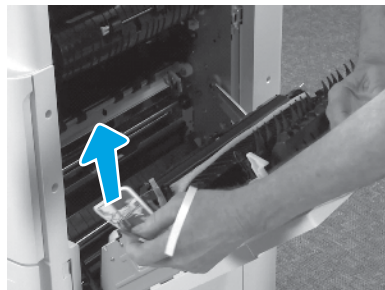

4.3

Carefully remove the strapping tape at the front of the transfer unit.

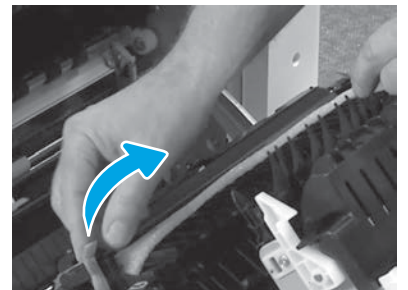

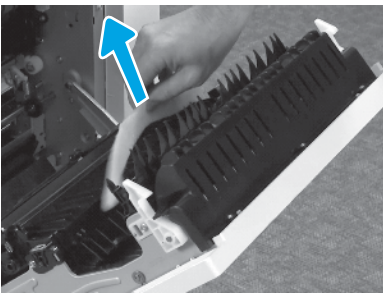

4.4
Remove the foam packaging material.



4.5
Carefully remove the strapping tape at the rear of the transfer unit.



4.6
Open Tray 1 on the right side of the printer, and then remove the foam near the pickup roller.



4.7
Open Tray 2-3 and remove all tape and foam packaging material.



4.8
Remove the scanner lock screw and red sticker on the left side of the printer.
WARNING: The scanner lock screw must be removed prior to powering on the printer.

5 Install the toner cartridge.



5.1
Open the front and right doors.
NOTE: Leave the doors open until the toner cartridge, imaging drum, and the toner collection unit (TCU) are installed.



5.2
Remove the toner cartridge packaging. Shake the cartridge side-to-side (about five times) to distribute the toner throughout the cartridge.

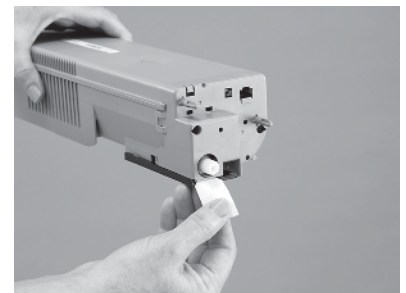

5.3
Pull the tab out to remove the seal at the rear of the cartridge.

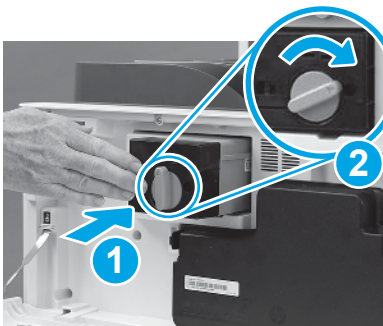

5.4
Install the toner cartridge.

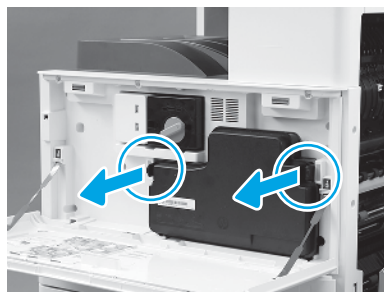

5.5
Push the latches on each side of the TCU and then remove the TCU.

6

Install the imaging unit.

CAUTION: Do not open the imaging unit package until it is ready to install. Prolonged exposure to bright light can damage the imaging drum and cause image quality problems.

6.1

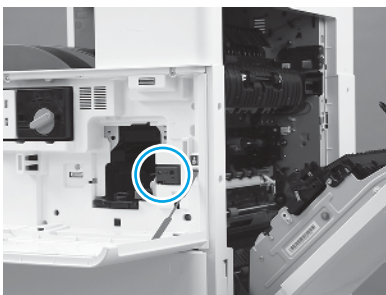

Ensure that the front and right doors are open. The right door retracts the interlock lever allowing the imaging unit to be installed.



6.2



Remove the imaging unit from the foam packaging and plastic bag.

6.3

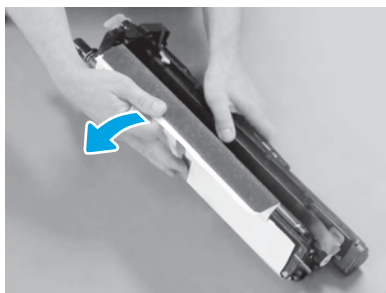

Remove white protective cover. Do not touch surface of the drum.

6.4



Pull straight out to remove the orange charge roller shipping lock.

6.5

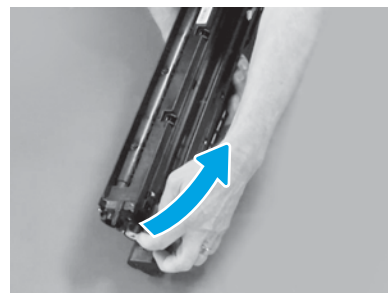

Remove the blue tab and tape from the imaging unit vent area.

6.6



Remove the orange plug from the imaging unit. Tighten one thumb screw.

6.7



Pull straight out on the red arrow tab to remove the seal at the front of the imaging unit.

6.8

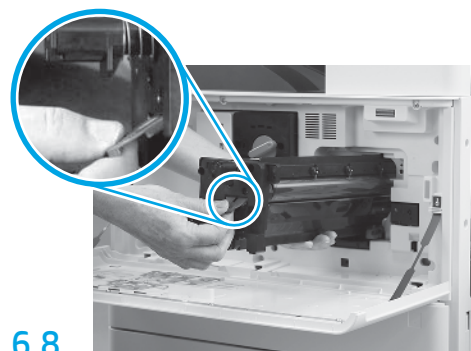

Hold the imaging unit with one hand on the bottom and the other hand on the gray handle at the front.

6.9

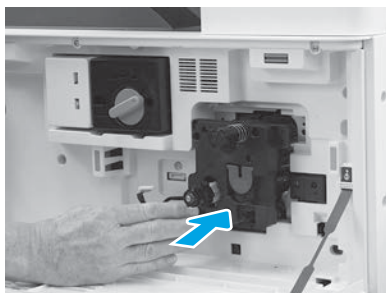

Slide the imaging unit into the device.

6.10

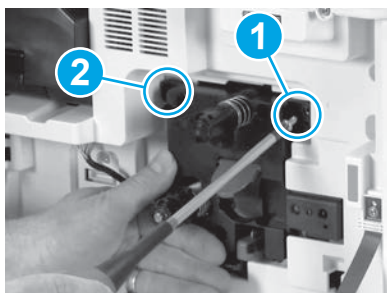

Push and hold the imaging unit in place while installing the first screw (callout 1) to secure the imaging unit. Install the second screw (callout 2).

6.11

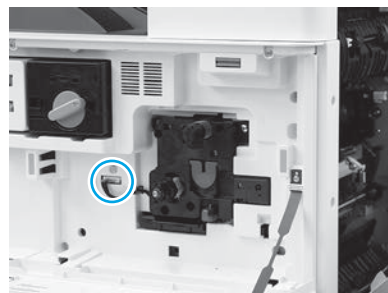

Connect the imaging unit connector to the engine connector.
NOTE: Ensure the connector is fully seated.

7 Install the toner collection unit (TCU).

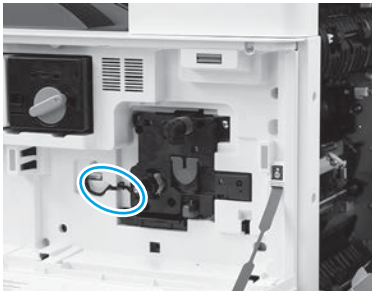

6.12

Route the cable through the channel between the imaging unit and connector, and then close the right door.

NOTE: The interlock lever slides into place to prevent removing the imaging unit when the right door is closed.

7.1



8 Install the paper settling guides.

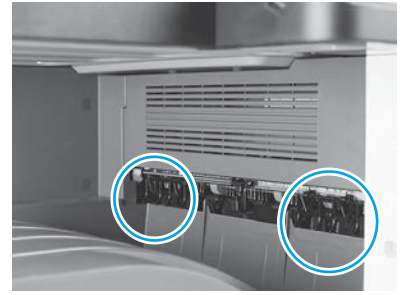

8.1

Install the paper settling guides at two locations on the first exit.

9 Load paper in Tray 2.

9

Load paper in Tray 2.

NOTE: Paper is used to print configuration sheets as needed (Letter or A4).

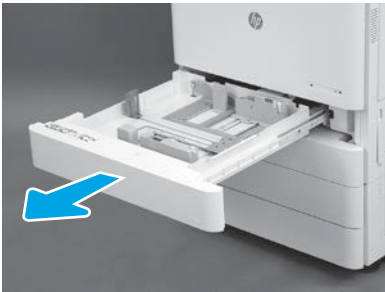

9.1

Open Tray 2.

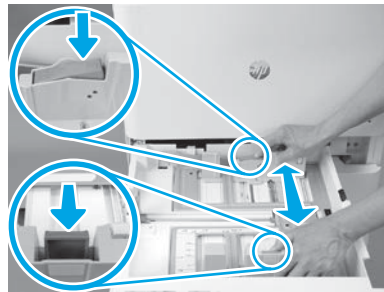

9.2

Push down on the blue tab in the back of the tray. At the same time, pinch or squeeze the blue tab in the front of the tray and slide to adjust to the proper paper length. Both tabs are spring-loaded and will lock, once released.

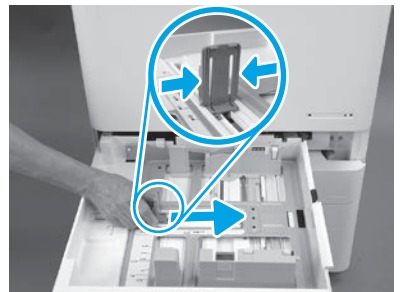

9.3

Squeeze the sides of the tab, and then slide to adjust the paper width.

9.4

Load the paper.

NOTE: A4 or Letter paper should be loaded with the long edge of the paper on the right side of the tray, as shown.



10

Initialize the printer.

CAUTION: Do not connect the network cable at this time.

10.1

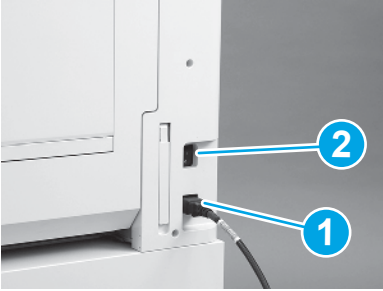

Connect the power cord to the printer and the wall receptacle (callout 1).

IMPORTANT: Use the printer power switch to turn the printer power on (callout 2).

10.2

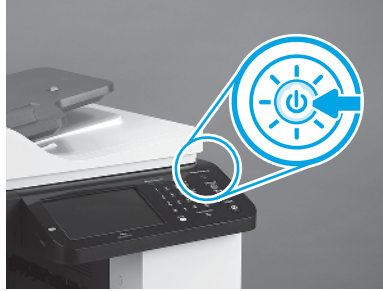

10.3



Follow the control panel prompts to set the country/region, language, date, and time settings.

NOTE: Wait 3-5 minutes for the printer to automatically complete the initialization processes.

10.4

Print a configuration page to make sure that the printer is properly working.

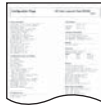

11

Install the stabilization blocks.

11.1

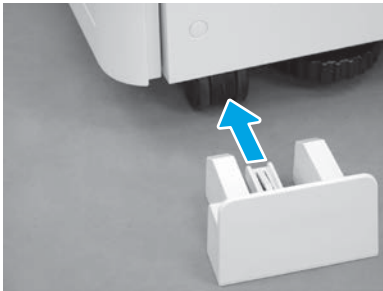

11.2



© Copyright 2019 HP Development Company, L.P.
www.hp.com

Reproduction, adaptation or translation without prior written permission is prohibited, except as allowed under the copyright laws.

The information contained herein is subject to change without notice.

The only warranties for HP products and services are set forth in the express warranty statements accompanying such products and services. Nothing herein should be construed as constituting an additional warranty. HP shall not be liable for technical or editorial errors or omissions contained herein.

Airprint and the Airprint logo are trademarks of Apple Inc.

