

jump2group

20008 Champion Forest Dr.  
Suite 1102  
Spring, TX 77379  
832-717-4331

**Color Side 1:**  
Black

**Color Side 2:**  
Black

**Flat size:**  
4.134 x 5.827 in

**Folded size:**  
4.134 x 5.827 in

**Fold 1:**  
no folds

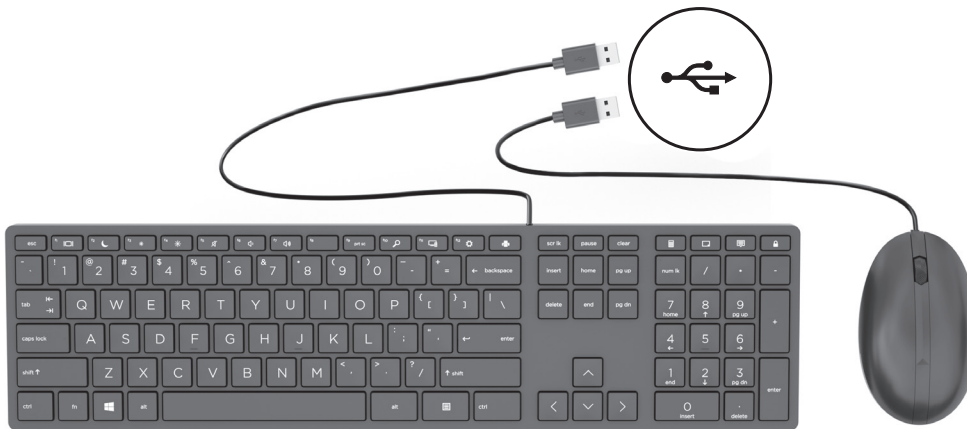



20008 Champion Forest Dr.  
Suite 1102  
Spring, TX 77379  
832-717-4331

**Color Side 1:**  
Black

**Color Side 2:**  
Black

**Flat size:**  
4.134 x 5.827 in

**Folded size:**  
4.134 x 5.827 in

**Fold 1:**  
no folds



PRINTER: Replace this box with Printed- In (PI) Statement(s) as per spec.  
NOTE: This box is simply a placeholder. PI Statement(s) do not have to fit inside the box but should be placed in this area.



M05455-B21

RMN/型號/型号: HSA-P010K + HSA-P009M

© Copyright 2020 HP Development Company, L.P.

The information contained herein is subject to change without notice. The only warranties for HP products and services are set forth in the express warranty statements accompanying such products and services. Nothing herein should be construed as constituting an additional warranty. HP shall not be liable for technical or editorial errors or omissions contained herein.

First Edition: February 2020