

HP Compaq Business Desktop dx2700/dx2708 Microtower Models

Illustrated Parts Map
Conroe, Pentium D (Presler/Smithfield), Pentium 4,
and Celeron D Processors

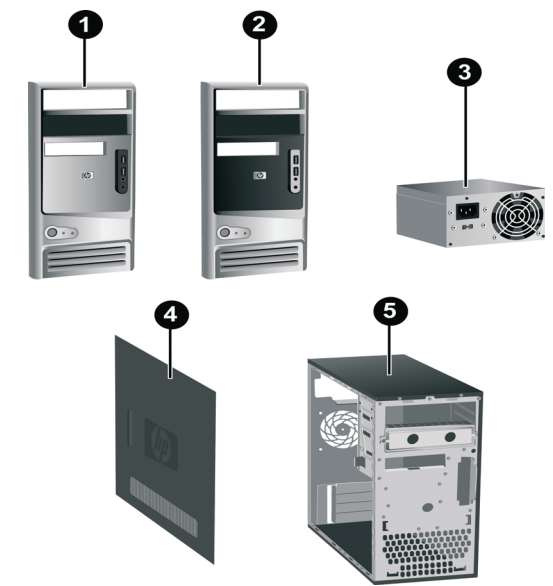

System Unit		
1	Front bezel (1 solid silver) with diskette drive bezel and 2 - 5.25" bezel. (See Miscellaneous parts for kit contents) for dx2700 MT model	435333-001
2	Front bezel (carbonite and silver) with diskette drive bezel and 2- 5.25" bezel blanks for dx2708 MT models	435334-001
3	Power supply, 250W PFC	435332-001
*	Power supply, 250W non-PFC	435303-001
*	Power supply, 300W non-PFC	435330-001
4	Access panel used on all models	435331-001
5	Chassis	not spared

* Not shown

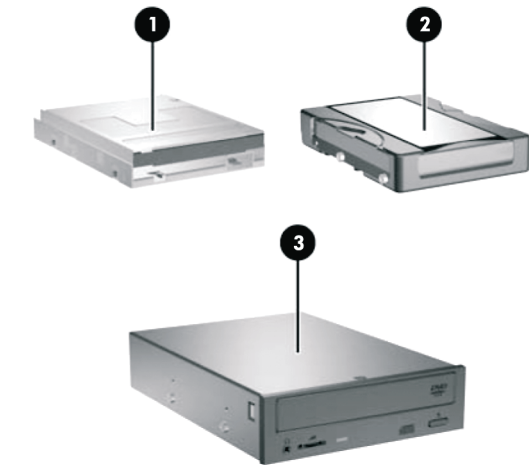

Mass Storage Devices		
1	Diskette drive, 3.5-inch	435420-001
2	40GB, SATA 1.5G	416737-001
*	80GB, SATA 3G	391945-001
*	160GB, SATA 3G	391741-001
*	250GB, SATA 3G	391937-001
*	52X CD-ROM drive	419619-001
*	16X DVD +/- RW drive (LS/DL/DF)	419498-001
*	16X/48X DVD-ROM drive	419496-001
*	48X/32X Combo Drive	419497-001

* Not shown

dx2700/dx2708 © 2006 Hewlett-Packard Development Company, L.P.

HP and the HP logo are trademarks of Hewlett-Packard Development Company, L.P.

Intel and Celeron are US registered trademarks of Intel Corporation. All other product names mentioned herein may be trademarks of their respective companies.

HP shall not be liable for technical or editorial errors or omissions contained herein. The information in this document is provided “as is” without warranty of any kind and is subject to change without notice. The warranties for HP products are set forth in the express limited warranty statements accompanying such products. **Nothing herein should be construed as constituting an additional warranty.**

September 2006

Document Part Number 431673-001

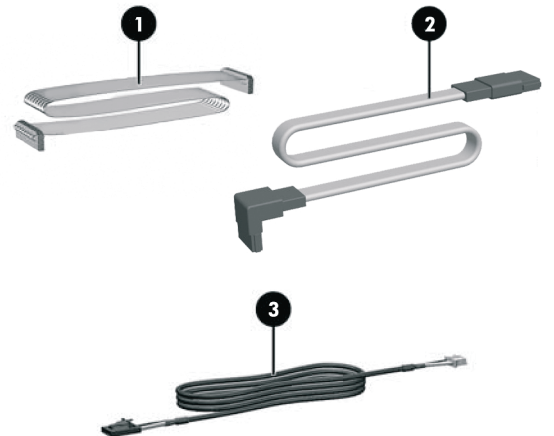

Blanks Cables	
Cable kit	
1	Diskette drive cable
2	Hard drive cable, primary SATA (1 device)
*	Optical drive cable, secondary SATA (2 devices)
3	Audio cable for Linux

* Not shown

Keyboards (not illustrated)	
Keyboard, PS2	
International	-B31
Peoples Republic of China	-AA1
Taiwanese	-AB1
Thai	-281
KOR	-AD1
Keyboard, USB	
International	-B31
Peoples Republic of China	-AA1
Taiwanese	-AB1
Thai	-281
KOR	-AD1

* Not shown

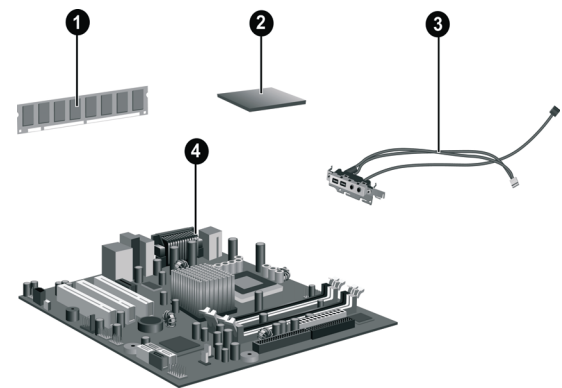

Standard and Optional Boards		
Memory modules		
1	256MB, PC2-4200	393392-001
*	512MB, PC2-4200	393393-001
*	1GB, PC2-4200	393394-001
*	256MB, PC2-5300	396519-001
*	512MB, PC2-5300	396520-001
*	1GB, PC2-5300	398038-001
Intel Processors with alcohol pad and thermal grease		
*	Celeron 3.33GHz/512K/D-0, LGA775 processor	433508-001
*	Celeron 3.46GHz/512K/D-0, LGA775 processor	434708-001
2	Celeron 3.2GHz LGA775 processor	382503-001
*	Celeron 2.8GHz LGA775 processor	391941-001
*	Celeron 3.06GHz LGA775 processor	405693-001
*	Celeron 2.66GHz LGA775 processor	391940-001
*	Celeron 2.53GHz LGA775 processor	407322-001
*	Conroe, 1.86GHz/1066, 2M, B-2	418947-001
*	Conroe, 2.13GHz/1066, 2M, B-2	418948-001
*	Conroe, 2.4GHz/1066, 4M, B-2	418949-001
*	Conroe, 2.66GHz/1066, 4M, B-2	418950-001
*	Presler-915, Mnstm, 2.8GHz, 4M, C-1	433843-001
*	Presler-945, Mnstm, 3.4GHz, 4M, C-1	433890-001
*	Presler-925, Mnstm, 3.0GHz, 4M, C-1	433510-001
*	Smthfld-820, Mnstm, 2.8G, 2M, B-0	432623-001
*	Smthfld-805, Mnstm, 2.66G,2M, B-0	433912-001
*	P4-541, Mstrm, 3.2G, 1M, G-1	433860-001
*	P4-531, Mstrm, 3.0G, 1M, G-1	394642-001
*	P4-524, Mstrm, 3.06G/533MHz	360734-413
3	Front I/O PCA with cable for MT	435304-001
System board with alcohol and thermal grease		
*	System board	435316-001
Other boards		
*	Intel Gb NIC PCIe, FH	430654-001
*	Broadcom Gb NIC PCIe, FH	398754-001
*	MDM, PCI modem, V92, FH	398661-001

* Not shown

Spared with alcohol wipe and thermal grease

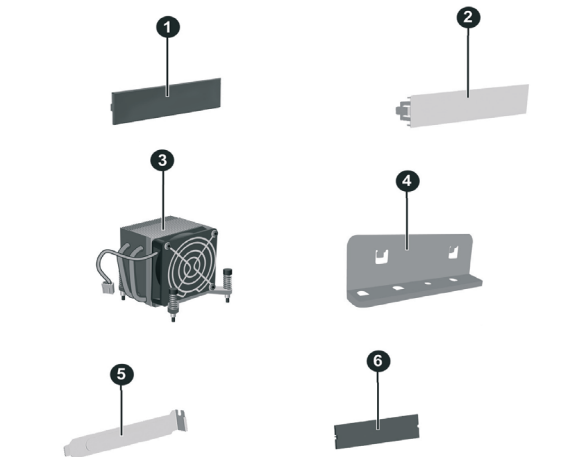

Miscellaneous Parts		
Miscellaneous hardware kit. Includes:		
1	5.25" drive bezel blank without metal shield (1 ea)	435308-001
2	Diskette drive bezel without metal shield, silver (1 ea)	
6	3.5" diskette drive bezel without metal shield (carbonite) (1 ea)	
5	Cover slot (2 ea)	
4	Cover slot lock (1 ea)	
3	Heatsink with alcohol pad and thermal grease	435313-001
*	System Fan	435307-001
*	USB scroll mouse carbonite	390939-001
*	USB optical mouse carbonite	390938-001
*	PS/2 scroll mouse	390937-001
*	PS/2 optical Mouse	417966-001
*	Sensor, intrusion	435312-001
*	Internal speaker	435327-001
*	Battery, real-time clock	153099-001

Miscellaneous screw kit, includes :		435305-001
*	#6-32 x 0.25 lg pan head (11 ea, for power supply, cover slot lock and motherboard.)	
*	#6-32 x 0.187 lg hi top (10 ea, 2 for I/O bracket, 4 for Hard Disk Drive, 2 for Optical drive, 2 for Hard disk drive bracket)	
*	#6-32 x 0.312 lg hi top (1 ea, for Access panel)	
*	#6-32 flat screw (1 ea, for Power supply bracket)	
*	M3 x 0.5 screw for Diskette Drive (3 ea)	
*	Screw for system fan (4 ea)	

Miscellaneous cable kit	435309-001
*	1. Hard Disk Drive cable - 280mm (SATA connector) x 1
*	2. Optical drive cable x 1, 380mm - SATA
*	3. Diskette drive cable x 1, 200mm
*	RJ11 cable
	198220-005

* *Not shown*

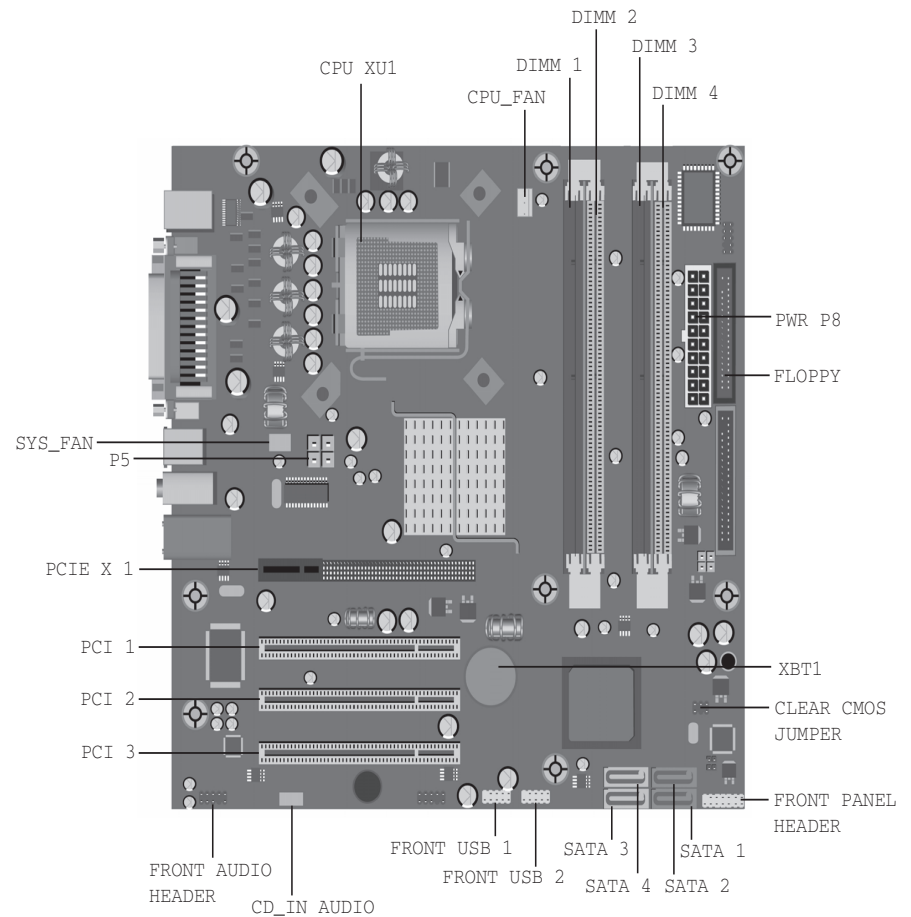

System Board Connectors and Jumpers (position of some untitled components may vary in location)			
Label	Component	Label	Component
XU1	Processor socket	Clear_CMOS	Clear CMOS header
CPU_FAN	CPU fan	J94	Front panel header
DIMM1	Memory socket 1	XBT1	Real-time-clock battery
DIMM2	Memory socket 2	Front_Audio	Front audio header
DIMM3	Memory socket 3	CD_in	CD in audio
DIMM4	Memory socket 4	PCI 1	PCI 1 connector
FLOPPY	Diskette drive connector	PCI 2	PCI 2 connector
Power	ATX main power	PCI 3	PCI 3 connector
SATA1	SATA connector 1	PCIE X 1	PCI-E x1 connector
SATA2	SATA connector 2	SYS_FAN	System fan
SATA3	SATA connector 3	P5	CPU 4 pin power connector
SATA4	SATA connector 4		
#See table below AGP socket not shown in this drawing			

Clear_CMOS	CMOS
Clear CMOS	1-2
Normal (Default)	2-3

System Hardware Interrupts			
IRQ	System Function	IRQ	System Function
1	Keyboard	10	VGA controller
3	USB OHCI (DID:F02)	10	USB OHCI (DIA:F00)
4	Serial Port	10	USB OHCI (DID:F00)
6	FDC controller	10	Lan controller
7	Parallel Port (LPT 1)	11	SATA controller
9	USB OHCI (DIA:F01)	12	Mouse
9	USB OHCI (DID:F01)		

Establishing a Password	
1.	Turn on or restart the computer. If you are in Windows, click Start > Shut Down > Restart the computer.
2.	When the F10 Setup message appears in the lower-right corner of the screen, press the F10 key. Press Enter to bypass the title screen, if necessary. If you do not press F10 when prompted, a restart will be necessary.
3.	Select supervisor password and press enter key, and follow the instructions on the screen. You may also want to establish the Password check at this time. This will allow you to specify when the password will be required.
4.	Before exiting, click Save Settings and Exit.

Changing a Password	
1.	Turn on or restart the computer. If you are in Windows, click Start > Shut Down > Restart the Computer. To change the setup password, run Computer Setup.
2.	When the key icon appears, type your current password, a slash (/) or alternate de-limiter character, your new password, another slash (/) or alternate delimiter character, and your new password again as shown: current password/new password/new password. NOTE: Type the new password carefully since the actual characters do not appear on the screen.
3.	Press the enter key.
4.	The new password will take effect the next time the computer is restarted.

Deleting a Password	
1.	Turn on or restart the computer. If you are in Windows, click Start > Shut Down > Restart the Computer. To delete the setup password, run Computer Setup (F10).
2.	When the key icon appears, type your current password followed by a slash (/) or alternate delimiter character as shown. Example: currentpassword/
3.	Press the Enter key.

Clearing CMOS*	
The computer's configuration (CMOS) may occasionally be corrupted. If it is, it is necessary to clear the CMOS memory using by performing the following procedure:	
<div><div></div><div>CAUTION: The power cord must be disconnected from the power source before changing the jumper setting. (NOTE: All LEDs on the board should be OFF). Failure to do so may damage the system board</div></div>	
1.	Turn off the computer and any external devices, then disconnect the power cord from the power outlet.
2.	Remove the access panel.
3.	Clear CMOS with header J1.
4.	Replace the access panel.
5.	Connect the power cord to the power outlet.
6.	Turn on the computer, allow it to start.
NOTE: Clearing CMOS clears all passwords.	

Diagnostic LEDs			
LED	Color	LED Activity	State/Message
Power	Green	On	(S0) Computer on
Power	Green	1 blink every 2 seconds	(S1) Normal Suspend Mode
Power	Green	1 blink every 2 seconds	(S3) Suspend to RAM
Power	Clear	Off	(S4) Suspend to Disk (if applicable)
Power	Clear	Off	(S5) Computer off
Power	Green	Green when flashing ROM	Boot block recovery w/Embedded Video
Power	Red	Power LED turns into green and start to blink two times every second, followed by two second pause.	CPU thermal shutdown (Weak CPU fan speed or not running)
Power	Red	Power LED flashes 5 seconds every 1 second, followed by 2 seconds pause, and meanwhile, 5 beeps are heard.	No memory installed / Pre-Video memory error
Power	Red	Power LED flashes 6 seconds every 1 second, followed by 2 seconds pause, and meanwhile, 6 beeps are heard.	Graphics card error (Pre-Video graphics error)
Power	Red	Power LED flashes 8 seconds every 1 second, followed by 2 seconds pause, and meanwhile, 8 beeps are heard.	System board failure or invalid ROM basing on checksum.
Hard Drive	Green	Blinking	Hard drive activity

Computer Setup (F10) Utility Features (not all features may be available)		
System Information	System S/N Product Name OwnerShip TAG BIOS Version BIOS Release Date System Chipset Type Processor Type Processor Speed CPU ID Cache Size	Memory DIMM1 Memory DIMM2 Memory DIMM3 Memory DIMM4 DDR2 Memory Size UUID Chassis Serial Number Asset TAG Number Integrated MAC
	System Date System Time Floppy Drive A SATA Port 0 SATA Port 1 SATA Port 2 SATA Port 3 SATA Port 0/1 Working Mode	Halt On
Standard CMOS Features		
Advanced BIOS Features	Quick Power On Self Test POST Delay Time (seconds) Hard Disk Boot Priority First Boot Device Second Boot Device Third Boot Device Fourth Boot Device Boot Other Device	Load Boot Menu Selectable APIC Mode System Keyboard Boot Up NumLock Status Security Option
Advanced Chipset Features	PEG/Onchip VGA Control On-Chip Frame Buffer Size DVMT Mode DVMT/FIXED Memory Size Init Display First	
Integrated Peripherals	USB Controller USB Legacy support HD Audio Onboard Lan Onboard Lan Boot ROM Onboard FDC Controller	Serial Port Parallel Port Parallel Port Mode ECP Mode Use DMA
Power Management Setup	ACPI Function ACPI Suspend Type Restore On AC/Power Loss Resume On PME Resume On Ring Resume On Alarm Date(of Month) Alarm Time(hh:mm:ss) Alarm	
PnP/PCI Configurations	Reset Configuration Data Resources Controlled By IRQ Resources	
Hardware Monitor Setup	Reset Case Open Status CPU Temperature CPU Fan Speed System Fan Speed CPU Fan Fault Detect SYS Fan Fault Detect	
Load Optimized Defaults		
Set Supervisor Password		
Set User Password		
Save Setting and Exit		
Exit Without Saving		

Note: See Computer Setup (F10) Utility Guide on the Library CD.