

# **HP Personal Media Drive User's Guide**

The only warranties for HP products and services are set forth in the express warranty statements accompanying such products and services. Nothing herein should be construed as constituting an additional warranty. HP shall not be liable for technical or editorial errors or omissions contained herein.

HP assumes no responsibility for the use or reliability of its software on equipment that is not furnished by HP.

This document contains proprietary information that is protected by copyright. No part of this document may be photocopied, reproduced, or translated to another language without the prior written consent of HP.

Hewlett-Packard Company  
P.O. Box 4010  
Cupertino, CA 95015-4010  
USA

Copyright © 2004–2009 Hewlett-Packard Development Company, L.P.

HP supports lawful use of technology and does not endorse or encourage the use of our products for purposes other than those permitted by copyright law.

The information in this document is subject to change without notice.

# Table of Contents

- Introduction..... 1**
  - Safe Handling Information ..... 1
  - Care and Handling of Your HP Personal Media Drive ..... 1
  - Contents ..... 2
  - HP Personal Media Drive Features..... 3
- System Requirements..... 4**
- Getting Started with Your HP Personal Media Drive ..... 4**
  - Inserting the HP Personal Media Drive into HP Computers with Integrated Drive Bay ..... 4
  - Drive Indicators and Connectors ..... 5
  - Connecting the Drive to a Computer without a Drive Bay ..... 5
  - Locating the Drive ..... 6
  - Disconnecting the Drive Safely..... 6
- Formatting the Drive for Windows ..... 7**
  - Reformatting the Drive with a FAT32 File System..... 7
- Using Your HP Personal Media Drive..... 8**
  - About HP SureStore Backup Software ..... 8
  - Transferring Files to Another Computer Manually ..... 8
  - Playing Games ..... 8
  - Using Your HP Personal Media Drive with an HP Computer and Personal Media Drive Bay..... 8
  - Using the Security Lock..... 8
- Troubleshooting..... 9**
- Getting Help ..... 9**
- HP Personal Media Drive Specifications..... 10**
  - FCC Regulatory and Safety Information (USA Only) ..... 10
  - DOC Statement (Canada Only) ..... 11
  - Disposal of Waste Equipment by Users in Private Households in the European Union (European Union Only)..... 11
  - EMI statement (European Union only) ..... 11
  - RoHS statement (China only) ..... 11

## Introduction

Thank you for selecting the HP Personal Media Drive. This drive is an external hard disk drive with a large capacity designed to quickly and easily store and transfer media files such as digital photos, music, video, and other important files.

The HP Personal Media Drive connects and disconnects easily from a USB 2.0 connector on the front or back of most computers.

For some HP Computers, the HP Personal Media Drive is designed to fit inside a horizontal or vertical drive bay.

Your HP Personal Media Drive comes with backup software (select models only) that is compatible with most Microsoft® Windows® Operating systems.

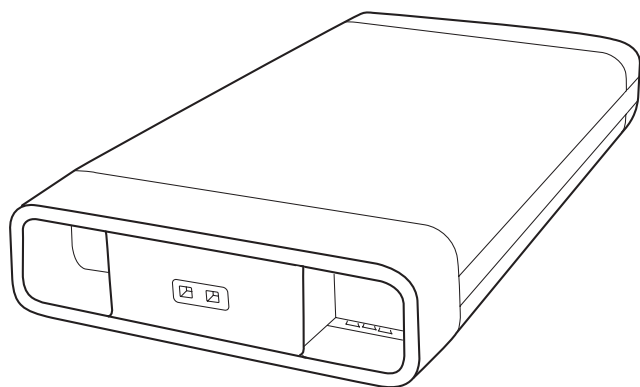

## Safe Handling Information

The HP Personal Media Drive is designed to be used as a stationary unit. It is very important that you handle this drive carefully to avoid hardware damage and data loss. Please read the following warnings before attempting to install, use, or move your HP Personal Media Drive.

## Care and Handling of Your HP Personal Media Drive



**WARNING:** The warnings for the care and handling of the HP Personal Media Drive are listed below.

- Do not move the drive while it is operating to avoid hardware damage and potential data loss. You can safely move your drive only when you have properly disconnected and powered off the drive through the operating system.
- When running for long periods of time, the aluminum case of the Personal Media Drive may become very warm. This is part of the HP Personal Media Drive's advanced design and is completely normal.
- The built-in, low-noise fan is designed to automatically turn on at pre-set temperatures. If you are using the HP Personal Media Drive connected externally to your computer, please place the drive in a well-ventilated area.
- Do not move the computer with the HP Personal Media Drive attached to a USB port, or while inserted into specially designed Hewlett-Packard computer drive bays.
- Incorrect handling, such as dropping the drive, can cause data loss and invalidates the warranty.
- Do not attempt to open the drive's case. This action voids the warranty.
- Do not set the drive on its side, as it may fall over and cause damage.
- Do not remove any cables or power cords without properly disconnecting the drive through the operating system.
- Do not set any liquids or drinks on the drive. Liquids can damage the internal electronics.
- Do not block airflow around the drive while the drive is turned on.
- Do not stack anything on top of the drive; this can overheat and damage your drive.

## Contents

HP Personal Media Drive:

- A** Pre-formatted USB 2.0 external hard disk drive
- B** Quick setup document
- C** 1.8 meter (6 foot) USB 2.0 cable
- D** Power adapter
- E** Power cable

*Limited Warranty and Support Guide*  
(not shown)

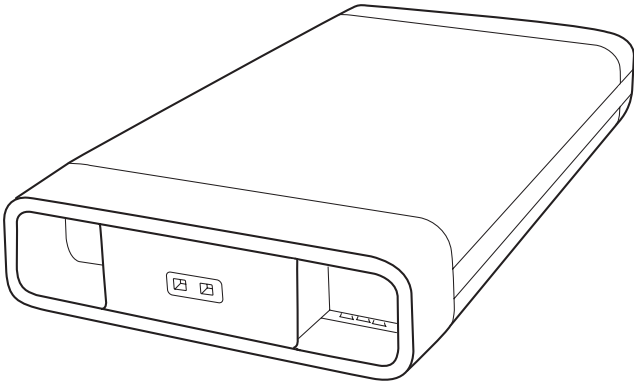

**A**

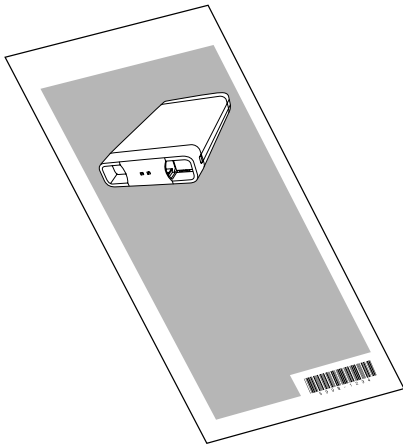

**B**



**C**



**D**

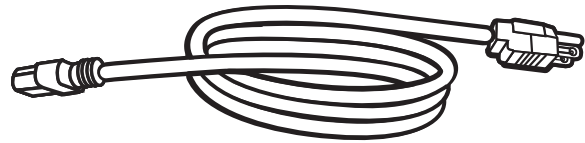

**E**

## HP Personal Media Drive Features

---



**WARNING:** To avoid hardware damage and data loss, please read “Safe Handling Information” at the beginning of this document before attempting to install or use the HP Personal Media Drive.

---

Your HP Personal Media Drive is a portable, external hard disk drive that allows you to quickly and easily store a large number of digital music, photo, video, recorded TV, gaming, or other data files.

Some HP computers include a specially designed drive bay where you can install and remove the HP Personal Media Drive without turning off the computer and without using any external USB or power cables.

The HP Personal Media Drive has the following features:

**Plug and Play installation with most computers**

Uses USB 2.0 for high-speed transfer of data, with backward compatibility to USB 1.1.

**Large storage capacity**

The large storage capacity allows you to easily store files from your digital cameras, digital video camcorders, and MP3 players.

**HP SureStore™ Backup Software**

Quickly and easily back up your digital music, photo, video, recorded TV, gaming or other data files.

**Compatibility**

Works with most computers, notebooks, and any Plug and Play ready port so you may easily share files between computers. Compatible with Kensington® and other brand security locking cables (not included).

**Compact design**

The HP Personal Media Drive is lightweight and small.

**Warm swappable convenience**

When disconnecting the drive, you do not need to turn off the computer.

**Pre-formatted**

This drive is pre-formatted in NTFS.

---

**NOTE:** To disconnect your drive, see “Disconnecting the Drive Safely” on page 6.

---

---

**NOTE:** Your drive displays a drive capacity that is slightly less than the capacity stated on the box. This is normal.

---

## System Requirements

The following are the system minimum requirements:

- Windows® XP, or Vista®
- Available USB port

## Getting Started with Your HP Personal Media Drive

To use your HP Personal Media Drive, simply connect the power cable and USB cable.

### Inserting the HP Personal Media Drive into HP Computers with Integrated Drive Bay

The HP Personal Media Drive is designed to work with most computers as an external drive that is connected using a USB cable, but it also can be inserted into specially designed HP computers. These computers have a special drive bay that includes an internal USB port and power cable that connects to the HP Personal Media Drive. The HP Personal Media Drive can be easily inserted and removed from the hard drive bay without turning off the computer, sometimes referred to as warm swappable.

Some HP computers have vertically oriented drive bays and some have horizontally oriented drive bays; both accommodate your HP Personal Media Drive.



**WARNING:** Do not move the computer with the HP Personal Media Drive inserted in the bay or connected to a USB port on the computer. This can cause damage to the drive and data loss.

Before moving the computer, it should be turned off and the HP Personal Media Drive should be removed or disconnected safely.

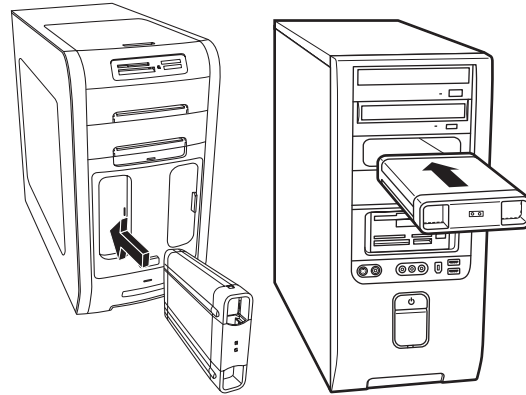

To insert the HP Personal Media Drive into a specially designed HP computer:

- 1** Line up the ridges on the bottom of the drive with the two slots on the correct side of the computer drive bay. Do not force the drive into the bay; it should slide easily into the bay.
- 2** Slide the drive all the way into the drive bay until the drive is firmly connected to the internal power and USB cables. When the computer is turned on, and the drive is inserted correctly, the power LED on the front of the drive is lit.

## Drive Indicators and Connectors

The HP Personal Media Drive comes with two LED indicators, a USB connector, a power connector, and a security lock connector.

### Front of HP Personal Media Drive

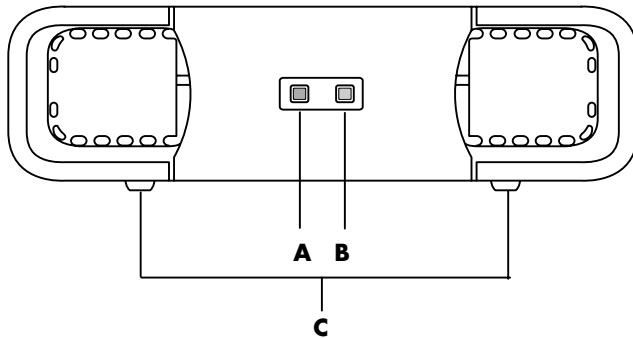

### Back of HP Personal Media Drive

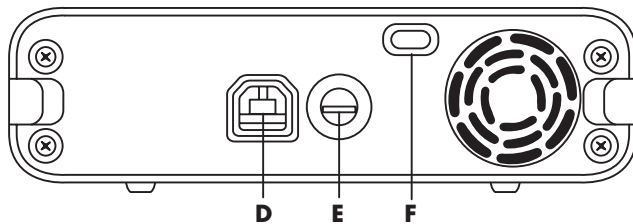

- A** Drive activity LED indicator
- B** Power on LED
- C** HP Personal Media Drive guide rails/feet
- D** USB 2.0 connector (USB 1.1 backward compatible)
- E** DC power connector
- F** Kensington security locking slot

---

**NOTE:** The Kensington security lock is sold separately.

---

## Connecting the Drive to a Computer without a Drive Bay

The HP Personal Media Drive is designed to work with most computers as an external hard disk drive that you connect using a USB cable.

To connect the drive:

- 1** Plug the round power cable from the power adapter into the back of the HP Personal Media Drive (**L**).
- 2** Plug power adapter into the power cable (**J**), and then plug the power cable into the wall (**K**).
- 3** Turn on the computer.

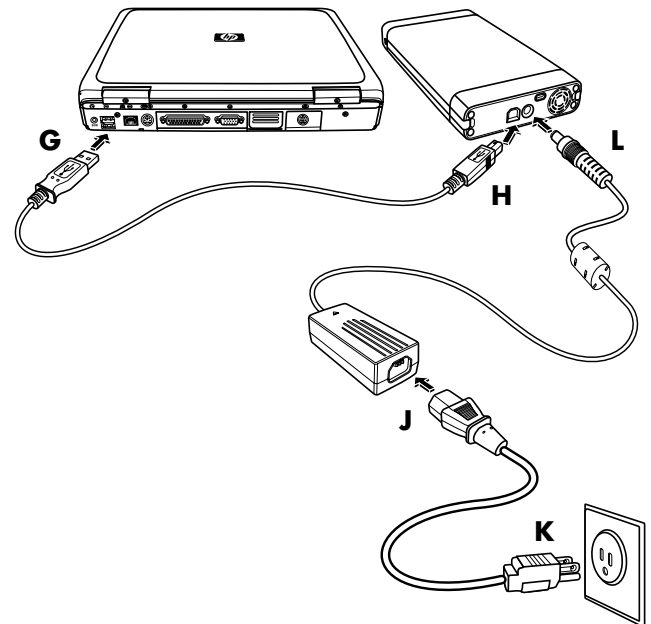

- 4** Plug the rectangular end of the USB cable (**G**) into an available USB port on your computer. Plug the square end of the USB cable (**H**) into the USB connector on the back of the drive.

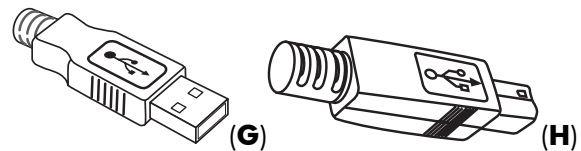

---

**NOTE:** The computer may take several seconds to recognize the HP Personal Media Drive.

---



## Locating the Drive

When you plug the drive into a USB 2.0 connector, the operating system automatically assigns a hard disk drive letter to it. The assigned letter depends on other storage devices connected to your computer.

The default volume label of this drive is *HP Personal Media Drive*. You can rename the drive in the Computer window by right-clicking the drive, selecting **Rename**, and then typing in a new name. HP recommends renaming a drive if you have more than one HP Personal Media Drive.

To locate your HP Personal Media Drive, click the **Windows Vista start button**  then click **Computer** for a list of all of the internal and external drives. On Windows XP, open **My Computer**.

## Disconnecting the Drive Safely



**CAUTION: To avoid hardware damage and data loss, always disconnect your HP Personal Media Drive safely when it is not saving or transferring data.**

- 1 Double-click the *Safely Remove Hardware* icon in the system tray at the bottom of the desktop. The Safely Remove Hardware window opens.



**NOTE:** For some computers, this may be called the Unplug Hardware or Eject Hardware icon.

- 2 Double-click **USB Mass Storage Device**. This name may appear differently for some computers.

---

**NOTE:** USB Mass Storage Device may be listed twice. One may contain a memory card reader or other mass storage drives. Look for the label of this drive, which is *HP Personal Media Drive*.

---

- 3 Select your device, and then click **OK**. A *Safe to Remove Hardware* message appears in the System tray at the bottom of your desktop letting you know that the device is safe to disconnect.
- 4 Disconnect the drive from the computer.

---

**NOTE:** If your computer does not allow you to disconnect the drive safely, you may need to close all applications and documents, and then try again to disconnect the drive.

---

# Formatting the Drive for Windows



**CAUTION: Reformatting a hard disk drive destroys all data on the drive. If you have data that you want to keep, back up the data before reformatting the drive. If the drive is reformatted, you will also lose the included HP SureStore Backup Software. To obtain a replacement copy, visit [www.hp.com/support](http://www.hp.com/support).**

Your HP Personal Media Drive was formatted at the factory for NTFS. This file system supports large media files that are larger than 4 GB.

Some computers use the FAT32 file system to organize files on the computer. This system is supported under Windows XP.

With FAT32, a single file is limited in size to 4 GB. This may create a problem when you are creating backup files. If you need to use this disk drive on a computer that requires FAT32, you need to reformat the drive.

If your computer has been upgraded to Windows XP, your computer was automatically reformatted to use NTFS.

## Reformatting the Drive with a FAT32 File System

If you have an older operating system such as Windows ME, you may need to reformat the HP Personal Media Drive with a FAT32 file system.

If your BIOS is older, it only supports 4 to 16 gigabyte partitions. If you do not want your drive partitioned, go to the BIOS manufacturer's Web site to download a BIOS upgrade.

To reformat the drive with FAT32 on a Windows ME system:

- 1 Make sure the HP Personal Media Drive is NOT connected to the computer.
- 2 Click **Start** on the taskbar.
- 3 Choose **Settings** and click **Control Panel**.
- 4 Double-click **System**.

- 5 Click the **Device Manager** tab.
- 6 Double-click **Disk drives** to open the list of drives connected to your system.
- 7 Write down the drive(s) listed so you'll be able to correctly identify the new drive when it appears.
- 8 Close the System Properties window and the Control Panel window.
- 9 Connect the HP Personal Media Drive to the computer. See "Connecting the Drive to a Computer without a Drive Bay" on page 5.
- 10 Click **Start** on the taskbar.
- 11 Choose **Settings** and click **Control Panel**.
- 12 Double-click **System**.
- 13 Click the **Device Manager** tab.
- 14 Double-click **Disk drives** to open the list of drives connected to your system.
- 15 Select the new drive from the *Disk drive* list. The new drive is the drive that was not listed before in step 6.
- 16 Click **Properties**.
- 17 Click the **Settings** tab.
- 18 Make sure that the **Removable** check box has a check mark next to it. Click it if it does not.
- 19 Click **OK**.
- 20 Click **Close**.
- 21 Restart your system.

To format your HP Personal Media Drive disk:

- 1 Double-click the **My Computer** icon.
- 2 Click the **Removable Disk** icon. A message appears asking you if you want to format the disk.
- 3 Click **Yes**.
- 4 In the Format window, in the Format type area, click **Full**. You can also type a label for the drive at this time if you choose.
- 5 Click **Start**.
- 6 Click **OK**. Formatting can take longer than 60 minutes. Do not disconnect the drive during the procedure.
- 7 When formatting is complete, click **Close** and then click **OK**.

## Using Your HP Personal Media Drive

Once installed, you can use the HP Personal Media Drive the same way you use the other drives on your computer. You can move or copy files or folders from one drive to another. Because of the capacity of this drive, you can save large media files such as video clips, digital images, and hard disk drive backup files.

### About HP SureStore Backup Software

- No software installation required. HP SureStore runs directly from your HP Personal Media Drive.
- Easily back up all of your digital music, photo, video, recorded TV, gaming, or other data files.
- Easily restore any or all of your backed up files.
- Automatically backs up changes whenever the computer is idle for 5 minutes.
- Can be used to back up multiple computers.

### Transferring Files to Another Computer Manually

You can transfer your computer profile information, which includes how your computer looks and feels as well as the personal files such as photos, music, or video you have created.

To transfer your files manually:

- 1** Connect your HP Personal Media Drive to the computer.
- 2** Select your files and then drag and drop them to your HP Personal Media Drive in the Computer window.
- 3** Disconnect your HP Personal Media Drive and then connect it to another computer.
- 4** Select your files and then drag and drop them to the other hard disk drive.

### Playing Games

CD-ROM games typically run faster when they are installed on a hard disk drive than when they run on a CD. You can use your HP Personal Media Drive to store and play CD-ROM games.

## Using Your HP Personal Media Drive with an HP Computer and Personal Media Drive Bay

Some HP computers have a dedicated drive bay for your HP Personal Media Drive. For more information, refer to the documentation that came with your computer. For information on using your HP Personal Media Drive with an older version of HP Media Center PC, go to <http://www.hp.com/support> and enter the model number of your computer or HP Personal Media Drive.

### Using the Security Lock

Your drive includes a security locking slot on the back of the drive. The security locking slot is compatible with most security locking cables, including those offered by Kensington.

These security cables are designed to prevent unauthorized removal of the drive by locking it to an unmovable object.

For more information about Kensington locking cables, you can go to:  
<http://www.kensington.com>

# Troubleshooting

## Microsoft updates

Make sure you have the latest Microsoft operating system service packs and other Windows updates installed on your system before you try to troubleshoot a drive problem. These service packs are issued to fix bugs, add drivers, and enhance the security features of your system. See <http://support.microsoft.com> for details about how to install service packs and Windows updates in your system. Contact Microsoft Customer Service for information about obtaining these system enhancements if you don't have Internet access.

## Drive does not appear on my computer

Try the following solutions in the order listed:

- 1 Check to see if the drive is on. The power LED on the front of the drive and the light on the power adapter should be lit.
- 2 Make sure the power adapter is securely plugged into the drive and into a power outlet. If the drive is plugged into a power strip, try plugging it directly into the wall outlet.
- 3 Check that the USB cable is securely and properly connected to the drive and the USB connector on the computer.
- 4 While the computer is turned on, unplug the USB cable. Wait 10 seconds and then reconnect the USB cable.
- 5 See if the computer is recognizing the USB port you are using by checking in the Device Manager window. See the documentation that came with your computer for more information.

## I got a message that I have a high-speed device connected to a low-speed port (Windows XP)

This is normal. Windows XP displays a message that you have connected your USB 2.0 drive to a USB 1.1 port. You will not have the high-speed capabilities that you would have using a USB 2.0 port.

## I'm having data transfer performance problems with my USB 2.0 adapter card

Your HP Personal Media Drive runs as fast as the host adapter card allows (up to the maximum burst rate of 480 Mb/s). If you are having performance issues, make sure that the USB 2.0 card drivers are the most current available and are installed properly.

## HP SureStore backup software is not working

Please see the HP SureStore Backup Software User Manual located on the drive.

## Write Cache Enable Does Not Stay Enabled

For protection of your data, Write Cache Enable is turned off with the HP Personal Media Drive. For more information, go to: <http://www.hp.com/support>

## Administrator privilege for installing software

Depending on your operating system, you may need to be logged on as the Administrator to install software. See the Windows Help files or the documentation that came with your computer.

## Getting Help

For additional help with your drive, its installation, and the software, contact one of the following:

### HP Customer Care Web Support

For the latest updates and information about your HP Personal Media Drive, go to: <http://www.hp.com/support>

### Other Support

- For technical support numbers and warranty information, refer to the *Limited Warranty and Support Guide* that came with this drive.

# HP Personal Media Drive Specifications

Category	Specifications
Supported operating systems	Windows XP and Vista
USB format	USB 2.0 (USB 1.1 backward compatible)
Storage capacity	Varies depending on model
Special features	<ul style="list-style-type: none"> <li>• Warm swappable</li> <li>• High speed USB 2.0 data transfer</li> <li>• Power and drive activity LED indicators</li> <li>• Kensington security lock ready</li> <li>• HP SureStore backup software</li> </ul>
Data transfer rate	USB 1.1 = up to 12 Mb/s (megabits per second) USB 2.0 = up to 480 Mb/s
Physical dimensions	Length: 207 mm (8.0 inches) Width: 118 mm (4.5 inches) Depth: 36 mm (1.4 inches) Weight: 1 to 1.5 lbs, depending on capacity
Power adapter	AC input voltage: 100–240 V <sub>~</sub> AC input frequency: 50/60 Hz AC input current: 1A DC output voltage: 12 VDC DC output current: 2A Output connector: <ul style="list-style-type: none"> <li>• Outer barrel diameter: 5.5 mm (0.2 inches)</li> <li>• Inner pin diameter: 2 mm (0.1 inches)</li> </ul>
Operating temperature	+5 to +35 °C
Non-operating temperature	–30 to +70 °C

## FCC Regulatory and Safety Information (USA Only)

Federal Communications Commission (FCC) Radio Frequency Interference Statement

---

**This equipment has been tested and found to comply with the limits for a Class B digital device, pursuant to Part 15 of the FCC Rules. These limits are designed to provide reasonable protection against harmful interference in a residential installation. This equipment generates, uses, and can radiate radio frequency energy and, if not installed and used in accordance with the instructions, may cause harmful interference to radio communications. However, there is no guarantee that interference will not occur in a particular installation. If this equipment does cause harmful interference to radio or television reception, which can be determined by turning the equipment off and on, the user is encouraged to correct the interference by one or more of the following measures:**

- Reorient or relocate the receiving antenna.
- Increase the separation between the equipment and the receiver.
- Connect the equipment into an outlet that is on a circuit different from the receiver.
- Consult the dealer or an experienced radio/TV technician for help.

**Hewlett-Packard's peripheral RFI and Radiated Immunity tests were conducted with an HP computer and HP-shielded cables, such as those you receive with your system. Changes or modifications not expressly approved by Hewlett-Packard could void the user's authority to operate the equipment. To comply with the limits for an FCC Class B computing device, always use shielded signal cables and the power cord supplied with this unit.**

---

## DOC Statement (Canada Only)

This Class B digital apparatus complies with Canadian ICES-003.

## Disposal of Waste Equipment by Users in Private Households in the European Union (European Union Only)

This symbol on the product or on its packaging indicates that this product must not be disposed of with your other household waste. Instead, it is your responsibility to dispose of your waste equipment by handing it over to a designated collection point for the recycling of waste electrical and electronic equipment. The separate collection and recycling of your waste equipment at the time of disposal will help to conserve natural resources and ensure that it is recycled in a manner that protects human health and the environment. For more information about where you can drop off your waste equipment for recycling, please contact your local city office, your household waste disposal service, or the shop where you purchased the product.



## EMI statement (European Union only)

This is a Class B product. In a domestic environment, this product may cause radio interference, in which case the user may be required to take adequate measures.

## RoHS statement (China only)

产品中有毒有害物质或元素的名称及含量  
根据中国《电子信息产品污染控制管理办法》

部件名称	有毒有害物质或元素					
	铅 (Pb)	汞 (Hg)	镉 (Cd)	六价铬 (Cr(VI))	多溴联苯 (PBB)	多溴二苯醚 (PBDE)
主板 处理器和散热器	X	○	○	○	○	○
硬盘	X	○	○	○	○	○
光驱	X	○	○	○	○	○
内存条	X	○	○	○	○	○
I/O PCAs	X	○	○	○	○	○
电源	X	○	○	○	○	○
键盘	X	○	○	○	○	○
鼠标	X	○	○	○	○	○
机箱/其他	X	○	○	○	○	○
闪存读卡器	X	○	○	○	○	○
遥控器	X	○	○	○	○	○

○: 表示该有毒有害物质在该部件所有均质材料中的含量均在SJ/T11363-2006标准规定的限量要求以下。  
X: 表示该有毒有害物质至少在该部件的某一均质材料中的含量超出SJ/T11363-2006标准规定的限量要求。

表中标有“X”的所有部件都符合欧盟 RoHS 法规  
“欧洲议会和欧盟理事会 2002 年 1 月 27 日关于电子电气设备中限制使用某些有害物质的 2002/95/EC 号指令”  
注: 环保使用期限的参考标识取决于产品正常工作的温度和湿度等条件

4779-705022-A00